

# El Paso Natural Gas Company

El Paso, Texas 79999

August 13, 1971

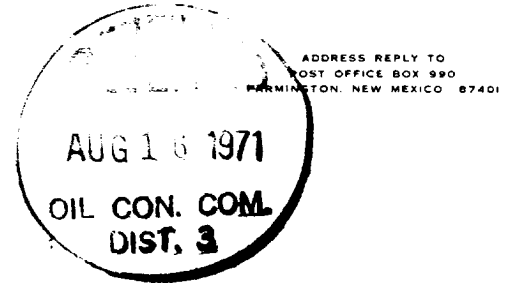

Mr. A. L. Porter, Secretary and Director  
New Mexico Oil Conservation Commission  
Box 2088  
Santa Fe, New Mexico 87501

Dear Mr. Porter:

This is a request for administrative approval for an unorthodox gas well location in the Blanco Mesa Verde Pool.

It is intended to locate the El Paso Natural Gas Company well San Juan 30-6 Unit No. 83-Y, 1911' from the North line and 1290' from the East line of Section 15, T-30-N, R-7-W, N. M. P. M., Rio Arriba County, New Mexico. The east half of Section 15, consisting of 320.00 acres, is dedicated to this well.

This well will be drilled as a replacement for the San Juan 30-6 Unit No. 83, located 700' from the North line and 950' from the East line of the above section. An attempt to workover the No. 83 well in June, 1970, was abandoned due to mechanical difficulty in the well.

As evidenced by the enclosed Well Location Plat, a segment of Navajo Lake occupies a large portion of the NE/4 of Section 15. The lake is surrounded by steep, rocky bluffs. The No. 83 well was drilled on an unorthodox location, with it being only 700' from the North line of Section 15. The No. 83 location is shown on the Well Location Plat. Due to the lake and adjacent bluffs, there is not a site available in the NE/4 of Section 15 on which an orthodox location could be built without entailing excessive expenses in building the location and access road.

All offset properties, both direct and diagonal, are either within the San Juan 30-6 Unit operated by El Paso, or the Northeast Blanco Unit operated by the Blackwood and Nichols Company, Box 1237, Durango, Colorado, 81301. The distance from the requested location to the nearest lease line of a lease operated by Blackwood and Nichols Company is 1911'. Blackwood and Nichols was notified by registered mail

A. L. Porter

-2-

August 13, 1971

on August 13, 1971, of El Paso's request for authority to build this unorthodox location.

A Well Location Plat showing topography and a Well Ownership Plat are attached.

Yours very truly,

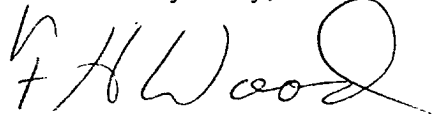
A handwritten signature in black ink, appearing to read "F. H. Wood". The signature is fluid and cursive, with a large loop at the end of the last name.

F. H. Wood,  
Division Petroleum Engineer

WDD:FHW:dgb

cc: Emery Arnold w/Attch.

Chas. Higgins w/Attch.

J. Permenter w/Attch.

Jerry Long, U. S. G. S. w/Attch.

Blackwood and Nichols Company w/Attch.

NEW MEXICO OIL CONSERVATION COMMISSION  
WELL LOCATION AND ACREAGE DEDICATION PLAT

Survey No. 11  
Date 8/13/71

EL PASO NATURAL GAS COMPANY

SAN JUAN 30-6 UNIT (NEI-012694)

83-Y

H 15 30-N 7-W RIO ARriba

1911 NORTH 1290 EAST

6220 MESA VERDE BLANCO-MESA VERDE 320.00

- Outline the acreage dedicated to the subject well by colored pencil or by line marks on the plat.
- If more than one lease is dedicated to the well, outline each and identify the interest in each lease, interest and royalty.
- If more than one lease of different ownership is dedicated to the well, have the interests in all leases memorialized dated by communitization, unitization, or pooling.

**X** Yes

**X**

Answers "Yes" type of consolidation

**Unitization**

If answer is "No" list the owners and tract descriptions which have actually been consolidated in some sense on this form if necessary.

All wells will be assigned to the well until all interests have been consolidated by communitization, unitization, pooling, or otherwise, so that a demonstrated unit combination of such later interests need not be shown.

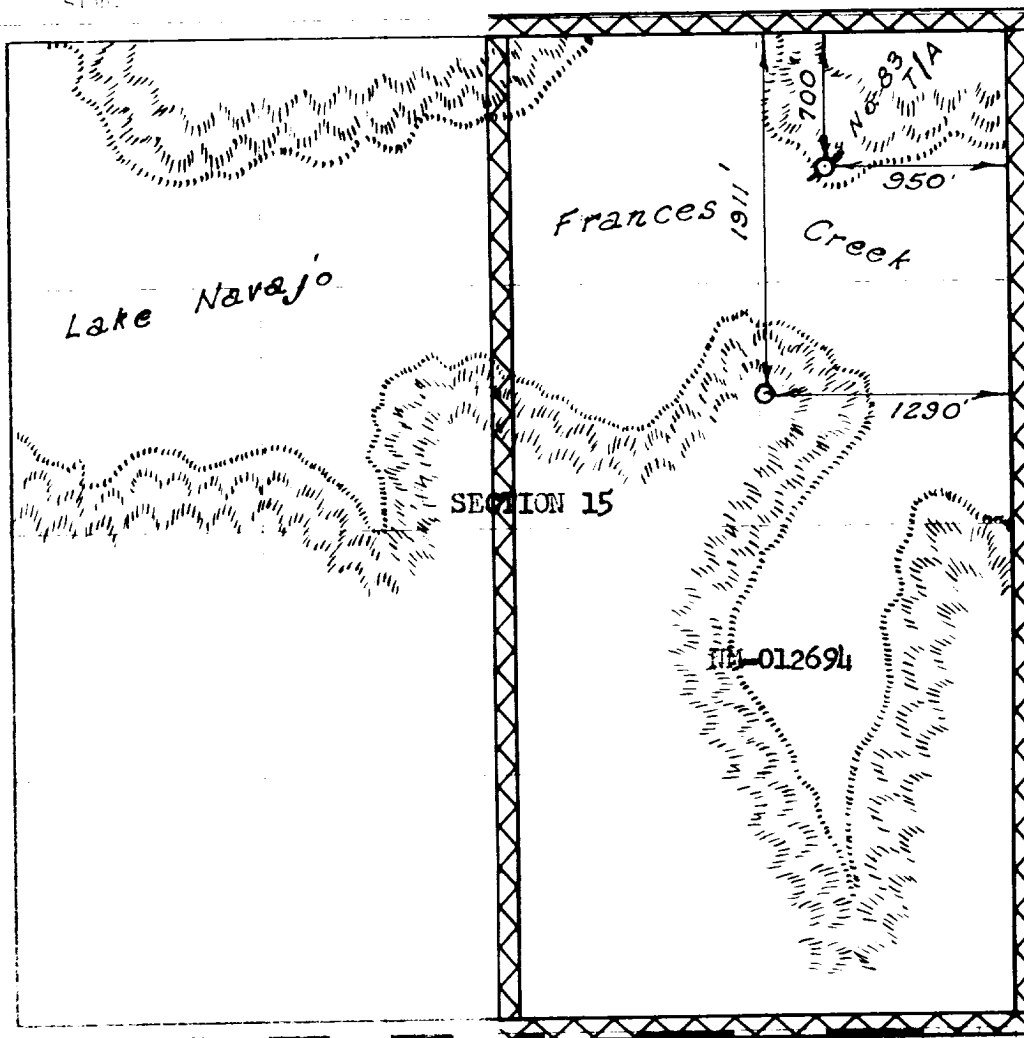

Original Signed F. H. WOOD

**Petroleum Engineer**

**El Paso Natural Gas Company**

**August 13, 1971**

**JULY 30, 1971**

*Paul Kilmer*  
1760

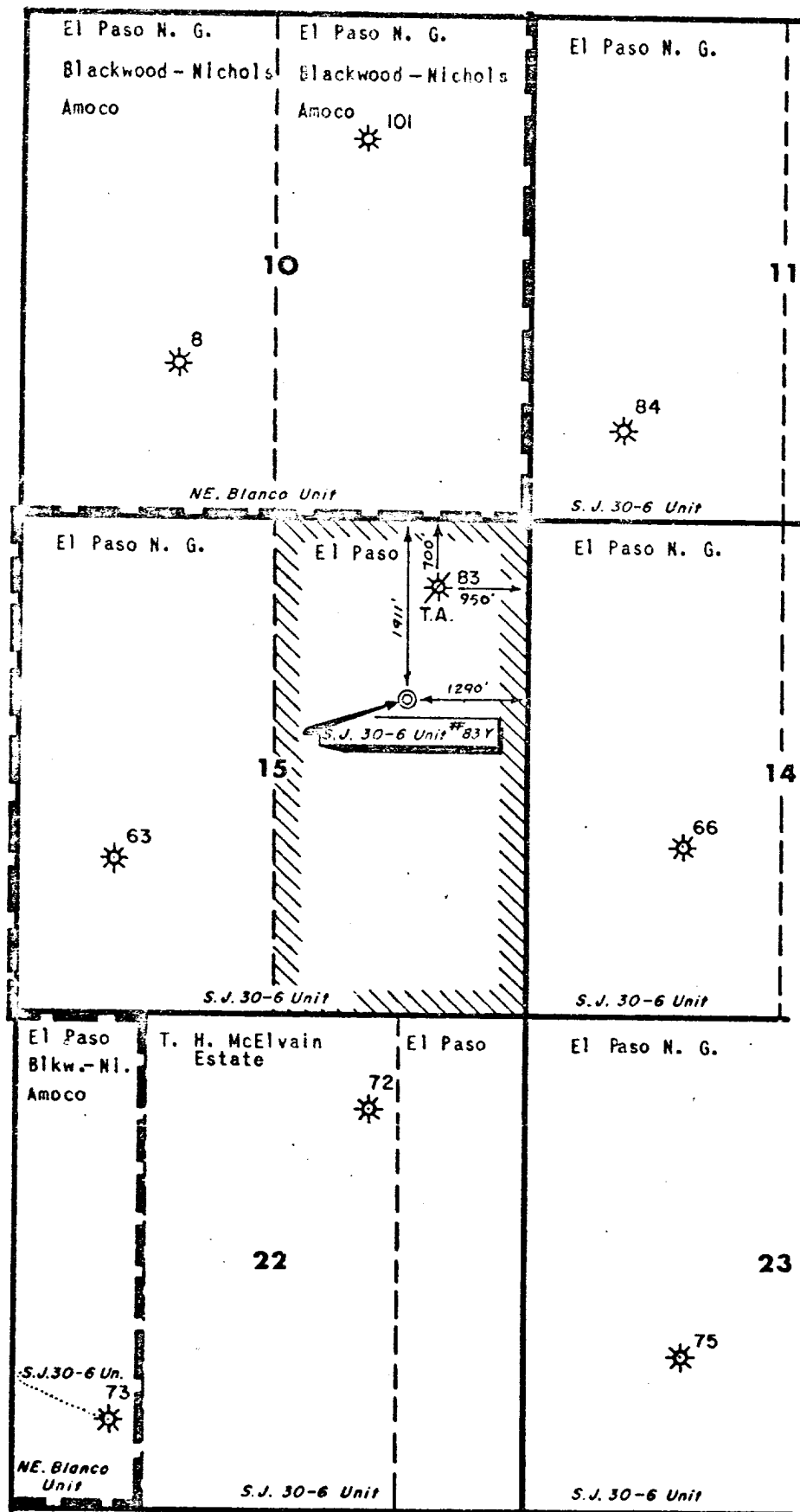

MESAVERDE OWNERSHIP		
Offsetting S.J. 30-6 Unit # 83-Y Well (MV.) Located in Rio Arriba County, New Mexico		
SCALE 3" = 1 mile	DATE 8/6/71	No.