

UNITED STATES
DEPARTMENT OF THE INTERIOR
GEOLOGICAL SURVEY

30-039-20525

APPLICATION FOR PERMIT TO DRILL, DEEPEN, OR PLUG BACK

1. TYPE OF WORK DRILL <input checked="" type="checkbox"/> DEEPEN <input type="checkbox"/> PLUG BACK <input type="checkbox"/>		5. LEASE DESIGNATION AND SERIAL NO. SF 078741	
2. NAME OF OPERATOR El Paso Natural Gas Company		6. IF INDIAN, ALLOTTEE OR TRIBE NAME	
3. ADDRESS OF OPERATOR PO Box 990, Farmington, NM 87401		7. UNIT AGREEMENT NAME San Juan 30-6 Unit	
4. LOCATION OF WELL (Report location clearly and in accordance with any State requirements.)* At surface 1520'N, 1060'E At proposed prod. zone		8. PERM OR LEASE NAME San Juan 30-6 Unit	
14. DISTANCE IN MILES AND DIRECTION FROM NEAREST TOWN OR VILLAGE OIL CON. COM. DIST. 3		9. WELL NO. 103	
10. DISTANCE FROM PROPOSED* LOCATION TO NEAREST PROPERTY OR LEASE LINE, FT. (Also to nearest drilg. unit line, if any)		10. FIELD AND POOL, OR WELDCAT Blanco Mesa Verde	
11. DISTANCE FROM PROPOSED* LOCATION TO NEAREST WELL, DRILLING COMPLETED, OR APPLIED FOR, ON THIS LEASE, FT.		11. SEC., T., R., M., OR B.L.E. AND SURVEY OR AREA Sec. 25, T-30-N, R-6-W NMPM	
12. COUNTY OR PARISH Rio Arriba		13. STATE New Mexico	
16. NO. OF ACRES IN LEASE		17. NO. OF ACRES ASSIGNED TO THIS WELL 229.56	
19. PROPOSED DEPTH 6150'		20. ROTARY OR CABLE TOOLS Rotary	
21. ELEVATIONS (Show whether DN, RT, GR, etc.) 6649'GR		22. APPROX. DATE WORK WILL START*	

PROPOSED CASING AND CEMENTING PROGRAM

SIZE OF HOLE	SIZE OF CASING	WEIGHT PER FOOT	SETTING DEPTH	QUANTITY OF CEMENT
13 3/4"	9 5/8"	32.3#	120'	130 cu. ft. to circulate
8 3/4"	7"	20.0#	3970'	300 cu. ft. to cover Ojo Alamo
6 1/4"	4 1/2" liner	10.5#	3820'-6150'	410 cu. ft. to circulate liner.

Selectively perforate and sand-water fracture the Mesa Verde formation.

The E/2 of Section 25 is dedicated to this well.

RECEIVED

JUL 11 1972

U. S. GEOLOGICAL SURVEY
DURANGO, COLO.

IN ABOVE SPACE DESCRIBE PROPOSED PROGRAM: If proposal is to deepen or plug back, give data on present productive zone and proposed new productive zone. If proposal is to drill or deepen directionally, give pertinent data on subsurface locations and measured and true vertical depths. Give blowout preventer program, if any.

24. HH Wood SIGNED Petroleum Engineer TITLE July 7, 1972 DATE

(This space for Federal or State office use)

PERMIT NO. _____ APPROVAL DATE _____

APPROVED BY GA TITLE _____ DATE _____

CONDITIONS OF APPROVAL, IF ANY:

NEW MEXICO OIL CONSERVATION COMMISSION
WELL LOCATION AND ACREAGE DEDICATION PLAT

Form O-101
Superseries 6-128
Effective 12-1-71

All distances must be from the outer boundaries of the Section.

EL PASO NATURAL GAS COMPANY		SAN JUAN 30-6 UNIT (SF-078741)		103
G	25	30-N	6-W	RIO ARriba
1520	NORTH	1060	EAST	
6649	MESA VERDE	BLANCO MESA VERDE	229.56	

1. Outline the acreage dedicated to the subject well by colored pencil or hatchure marks on the plat.
2. If more than one lease is dedicated to the well, outline each and identify the ownership thereof (both as to working interest and royalty).
3. If more than one lease of different ownership is dedicated to the well, have the interests of all owners been consolidated by communitization, unitization, force-pooling, etc?

☒ Yes ☐ No If answer is "yes" type of consolidation

Unitization

If answer is "no" list the owners and tract descriptions which have actually been consolidated. (Use reverse side of this form if necessary.)

No allowable will be assigned to the well until all interests have been consolidated (by communitization, unitization, forced-pooling, or otherwise) or until a non-standard unit, eliminating such interests, has been approved by the Commission.

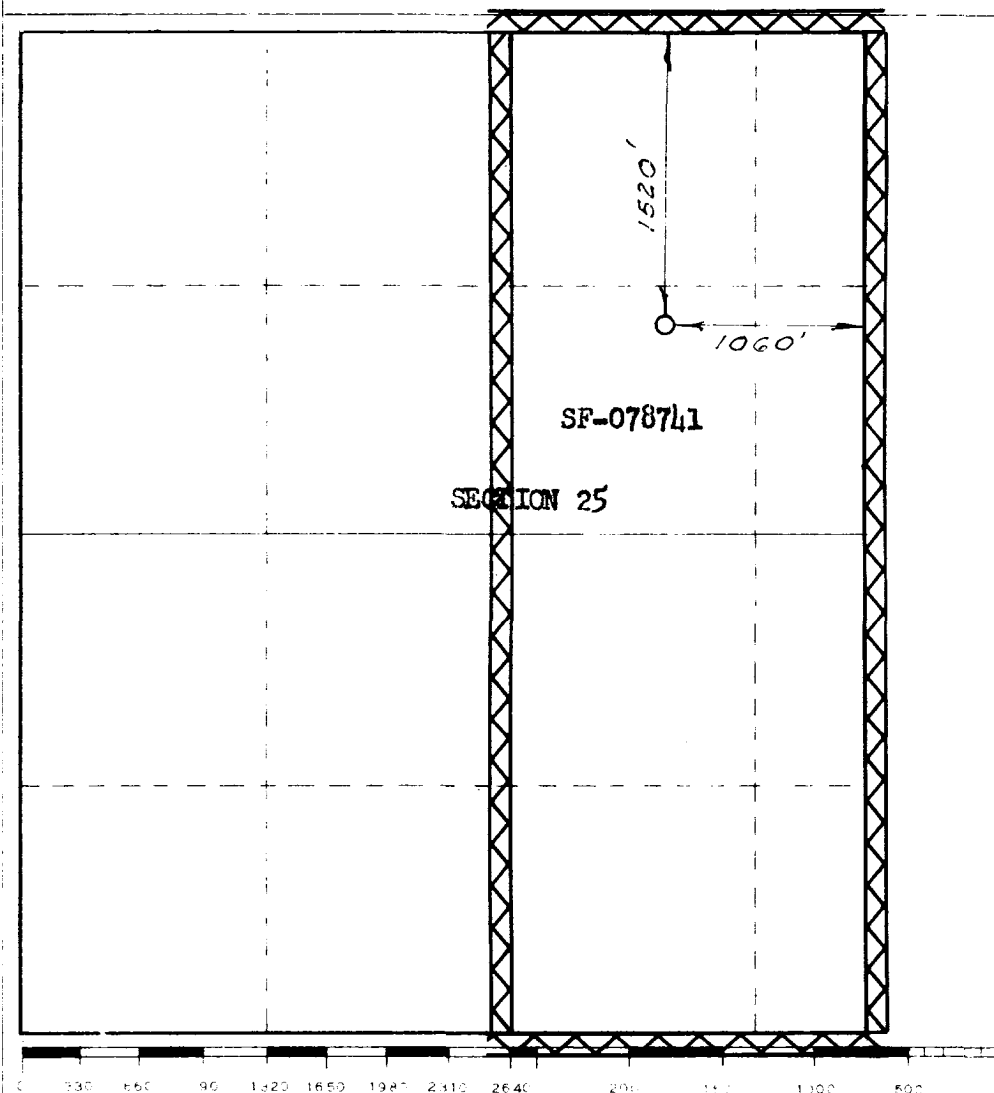
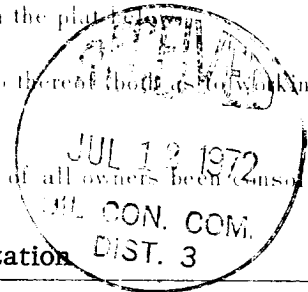

CERTIFICATION

I hereby certify that the information contained herein is true and complete to the best of my knowledge and belief.

Original Signed F. H. WOOD

Petroleum Engineer

El Paso Natural Gas Co.

July 7, 1972

I hereby certify that the well location shown on this plat was plotted from field notes of actual surveys made by me or under my supervision, and that the same is true and correct to the best of my knowledge and belief.

MAY 19, 1972

David Wilson
1760

San Juan 30-6 Unit # 103



50,111,112

U. S. OFFICE OF SLAVE
FRANCO, COLO.

LOCATION AND EQUIPMENT LAY-OUT

San Juan 30-6 Unit # 103

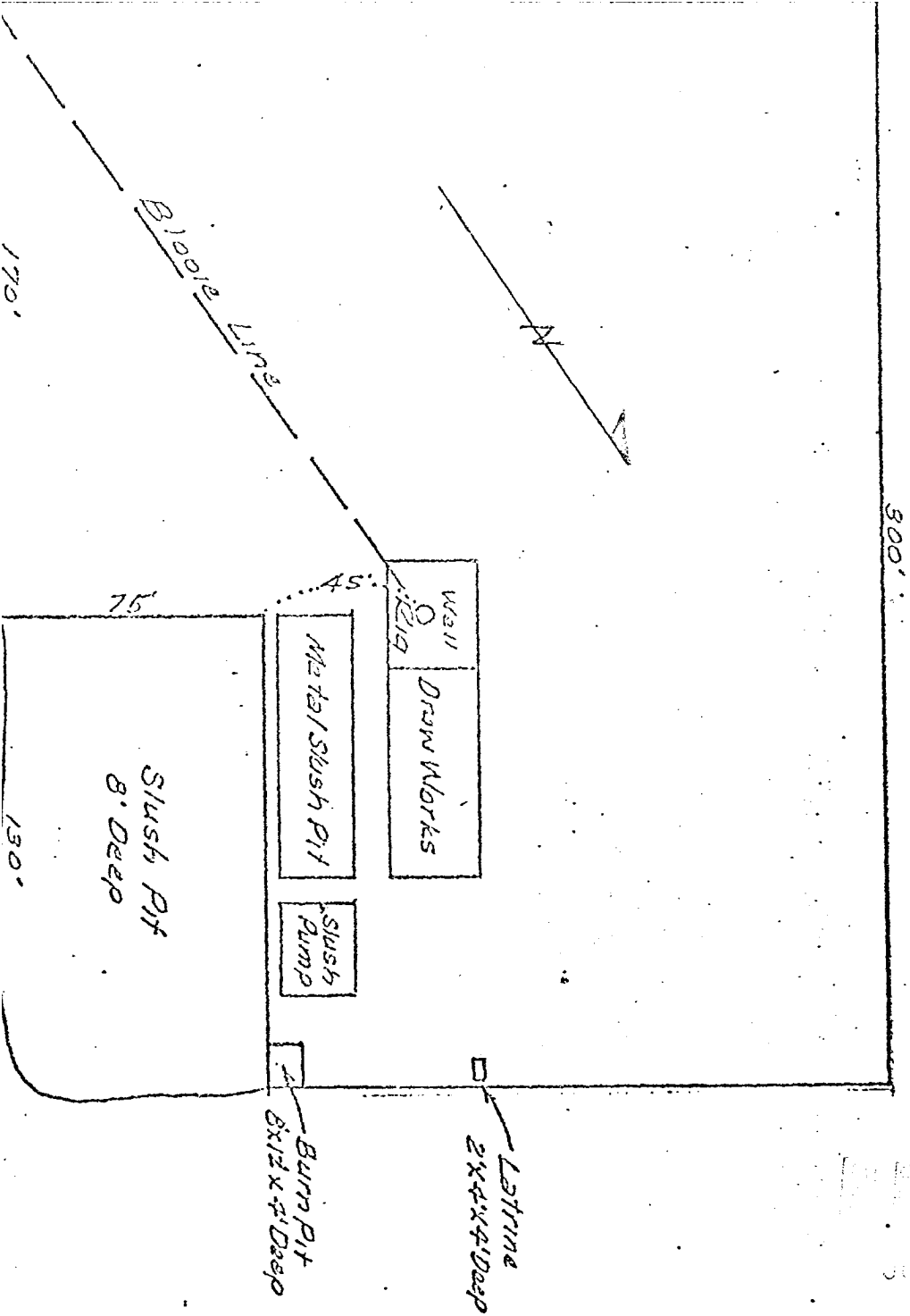

RECEIVED

JUL 11 1964

U. S. GEOLOGICAL SURVEY
FEDERAL BUREAU OF INVESTIGATION