

NEW MEXICO OIL CONSERVATION COMMISSION

WELL LOCATION AND ACERAGE DEDICATION PLAT

All distances must be from the outer boundaries of the Section

Operator LONE STAR INDUSTRIES-XXXXXX		Lease SCHALK 76		Well No. 1
Unit Letter E	Section 25	Township 30 NORTH	Range 4 WEST	County RIO ARriba
Actual Footage Location of Well: 1850 feet from the NORTH line and 1230 m feet from the WEST line				
Ground Level Elev. 7360.0	Producing Formation DAKOTA	Pool BASIN DAKOTA	Dedicated Acreage: 320	Acres

- Outline the acreage dedicated to the subject well by colored pencil or hachure marks on the plat below.
- If more than one lease is dedicated to the well, outline each and identify the ownership thereof (both as to working interest and royalty),
- If more than one lease of different ownership is dedicated to the well, have the interests of all owners been consolidated by communitization, unitization, force-pooling, etc?

() Yes () No If answer is "yes," type of consolidation

If answer is "no," list the owners and tract descriptions which have actually consolidated. (Use reverse side of this form if necessary.)

No allowable will be assigned to the well until all interests have been consolidated (by communitization, unitization, forced-pooling, or otherwise) or until a non standard unit, eliminating such interests, has been approved by the Commission.

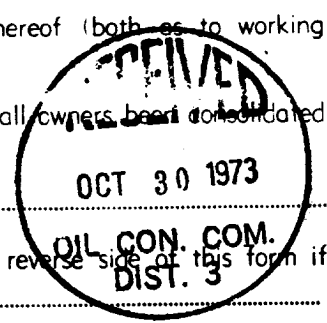

RECEIVED

OCT 29 1973

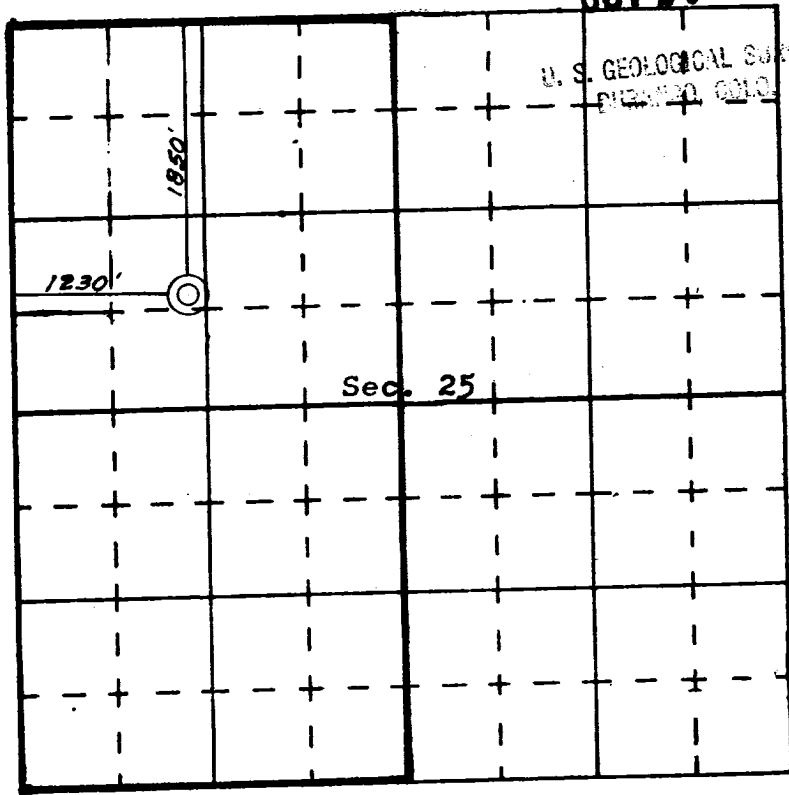

CERTIFICATION

I hereby certify that the information contained herein is true and complete to the best of my knowledge and belief.

John E. Schalk
Name
JOHN E. SCHALK, AGENT
Position

Company
OCTOBER 24, 1973
Date

I hereby certify that the well location shown on this plat was plotted from field notes of actual surveys made by me or under my supervision, and that the same is true and correct to the best of my knowledge and belief.

Date
September, 1973
James P. Leese
Registered Professional Engineer
and a Land Surveyor
JAMES P. LEESE
NEW MEXICO
Certificate No. **4678**

st

Approved subject to State
approval of methodology
location (Moved by request
of Forest Service)

June