

NO. OF COPIES RECEIVED	6
DISTRIBUTION	
SANTA FE	1
FILE	1
U.S.G.S.	2
LAND OFFICE	1
OPERATOR	1

NEW MEXICO OIL CONSERVATION COMMISSION

30-039-21277
Form C-101
Revised 1-1-65

5A. Indicate Type of Lease	
STATE <input checked="" type="checkbox"/>	FEE <input type="checkbox"/>
5. State Oil & Gas Lease No. E-347-25	

APPLICATION FOR PERMIT TO DRILL, DEEPEN, OR PLUG BACK

1a. Type of Work		7. Unit Agreement Name	
DRILL <input checked="" type="checkbox"/> DEEPEN <input type="checkbox"/> PLUG BACK <input type="checkbox"/>		San Juan 30-5 Unit	
b. Type of Well		8. Farm or Lease Name	
OIL WELL <input type="checkbox"/> GAS WELL <input checked="" type="checkbox"/> OTHER <input type="checkbox"/>		San Juan 30-5 Unit	
2. Name of Operator		9. Well No.	
Northwest Pipeline Corporation		58	
3. Address of Operator		10. Field and Pool, or Wildcat	
P.O. Box 90, Farmington, New Mexico 87401		Blanco Mesa Verde	
4. Location of Well		12. County	
UNIT LETTER M LOCATED 870 FEET FROM THE South LINE		Rio Arriba	
AND 950 FEET FROM THE West LINE OF SEC. 36 TWP. 30N RGE. 5W NMPM			
		19. Proposed Depth	
		6752'	
		19A. Formation	
		Mesa Verde	
		20. Rotary or C.T.	
		Rotary	
21. Elevations (Show whether D.P., R.T., etc.)		22. Approx. Date Work will start	
7492' GR		Sept. 1, 1976	

23.

PROPOSED CASING AND CEMENT PROGRAM

SIZE OF HOLE	SIZE OF CASING	WEIGHT PER FOOT	SETTING DEPTH	SACKS OF CEMENT	EST. TOP
13-3/4"	9-5/8"	36#	200'	180	
8-3/4"	7"	20#	4721'	160	
6-1/4"	4-1/2" Liner	10.5#	4571 - 6752'	215	

Selectively perforate and stimulate the Mesa Verde formation.

A BOP will be installed after the surface casing has been run and cemented. All subsequent work will be conducted through the BOP.

The w/2 of section 36 is dedicated to this well.

Gas is dedicated.

APPROVED FOR 90 DAYS UNLESS
DRILLING COMMENCED,

AUG 8 1976

EXPIRES 11/16/76

IN ABOVE SPACE DESCRIBE PROPOSED PROGRAM; IF PROPOSAL IS TO DEEPEN OR PLUG BACK, GIVE DATA ON PRESENT PRODUCTIVE ZONE AND PROPOSED NEW PRODUCTIVE ZONE. GIVE BLOWOUT PREVENTER PROGRAM, IF ANY.

I hereby certify that the information above is true and complete to the best of my knowledge and belief.

Signed D.H. Masonelle Title Production Engineer Date 8-18-76
(This space for State Use)

APPROVED BY AL Bendrick TITLE SUPERVISOR DIST. #3 DATE 8-18-76
CONDITIONS OF APPROVAL, IF ANY:

DHM/ks

**NEW MEXICO OIL CONSERVATION COMMISSION
WELL LOCATION AND ACREAGE DEDICATION PLAT**

Form C-102
Supersedes C-128
Effective 1-1-65

All distances must be from the outer boundaries of the Section.

Operator Northwest Pipeline Corporation			Lease San Juan 30-5 Unit		Well No. 58
Unit Letter M	Section 36	Township 30N	Range 5W	County Rio Arriba	
Actual Footage Location of Well: 870 feet from the South line and 950 feet from the West line					
Ground Level Elev. 7492	Producing Formation Mesa Verde		Pool Blanco		Dedicated Acreage: 320 Acres

1. Outline the acreage dedicated to the subject well by colored pencil or hachure marks on the plat below.
2. If more than one lease is dedicated to the well, outline each and identify the ownership thereof (both as to working interest and royalty).
3. If more than one lease of different ownership is dedicated to the well, have the interests of all owners been consolidated by communitization, unitization, force-pooling, etc?

☐ Yes ☐ No If answer is "yes," type of consolidation _____

If answer is "no," list the owners and tract descriptions which have actually been consolidated. (Use reverse side of this form if necessary.) _____

No allowable will be assigned to the well until all interests have been consolidated (by communitization, unitization, forced-pooling, or otherwise) or until a non-standard unit, eliminating such interests, has been approved by the Commission.

AUG 18 1976

**OIL CON. COM
DIST. 3**

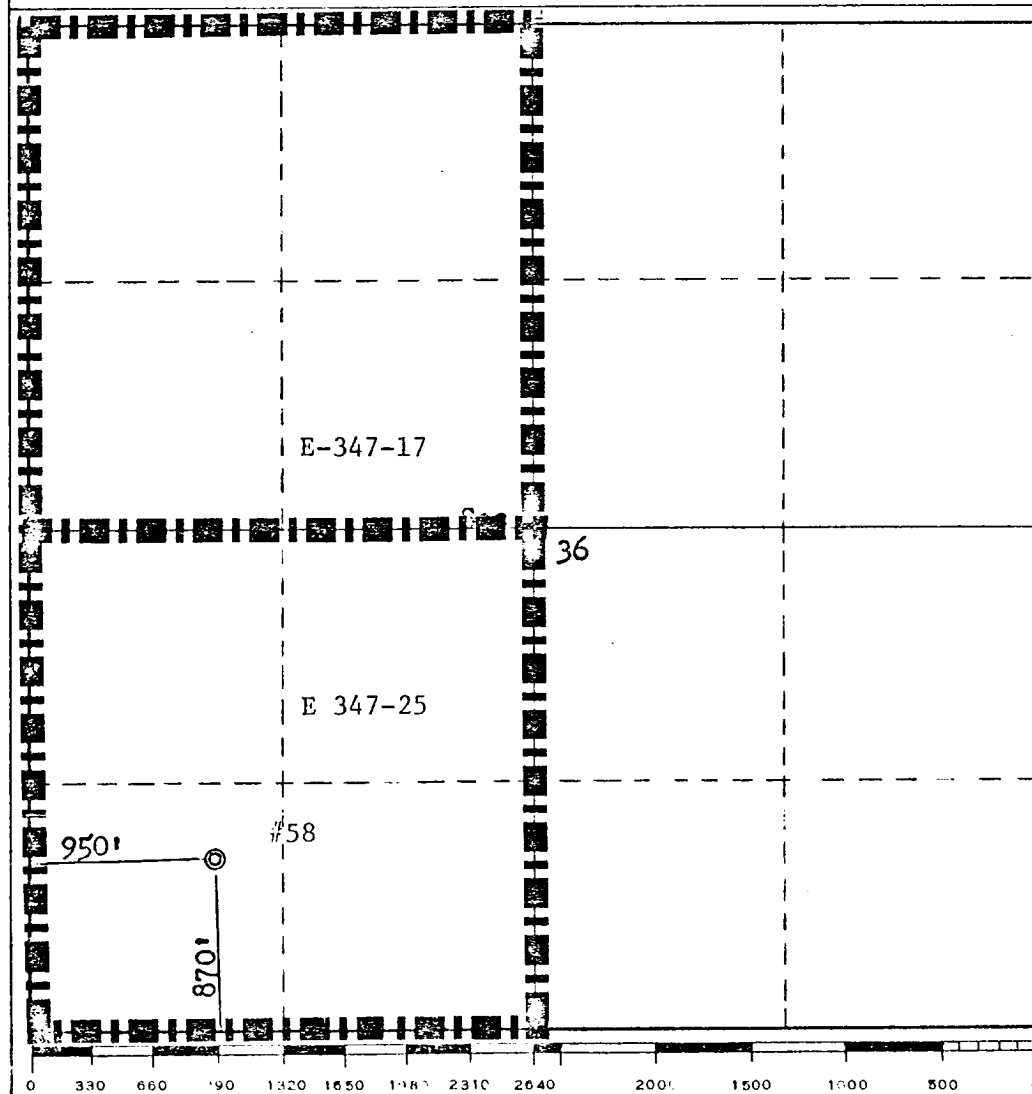

CERTIFICATION

I hereby certify that the information contained herein is true and complete to the best of my knowledge and belief.

D. H. Maroncelli

Name
D.H. Maroncelli

Position
Production Engineer

Company
Northwest Pipeline Corp.

Date
August 2, 1976

I hereby certify that the well location shown on this plat was plotted from field notes of actual surveys made by me or under my supervision, and that the same is true and correct to the best of my knowledge and belief.

Date Surveyed
July 30, 1976

Registered Professional Engineer and/or Land Surveyor

Fred B. Kerr Jr.
Fred B. Kerr Jr.

Certificate No.
3950