

(June 1990)

DEPARTMENT OF THE INTERIOR
BUREAU OF LAND MANAGEMENT

Budget Bureau No. 1004-0135

Expires: March 31, 1993

5. Lease Designation and Serial No.
E 178-1

6. If Indian, Allottee or Tribe Name

7. If Unit or CA, Agreement Designation
Northeast Blanco Unit

8. Well Name and No.
NEBU # 10A

9. API Well No.
30-039-21748

10. Field and Pool, or Exploratory Area
Mesaverde

11. County or Parish, State
Rio Arriba, NM

SUNDRY NOTICES AND REPORTS ON WELLS

Do not use this form for proposals to drill or to deepen or reentry to a different reservoir.
Use "APPLICATION FOR PERMIT-" for such proposals

SUBMIT IN TRIPLICATE

1. Type of Well

☐ Oil Well ☒ Gas Well ☐ Other

2. Name of Operator

Blackwood & Nichols Co., A Limited Partnership

3. Address and Telephone No.

P.O. Box 1237, Durango, CO 81302

4. Location of Well (Footage, Sec., T., R., M., or Survey Description)

250' FNL - 1060' FWL - Sec.16 - T30N - R7W

12. CHECK APPROPRIATE BOX(s) TO INDICATE NATURE OF NOTICE, REPORT, OR OTHER DATA

TYPE OF SUBMISSION

- ☐ Notice of Intent
☒ Subsequent Report
☐ Final Abandonment Notice

TYPE OF ACTION

- ☐ Abandonment
☐ Recompletion
☐ Plugging Back
☐ Casing Repair
☐ Altering Casing
☒ Other Pit Closure Acceptance

- ☐ Change of Plans
☐ New Construction
☐ Non-Routine Fracturing
☐ Water Shut-Off
☐ Conversion to Injection
☐ Dispose Water

(Note: Report results of multiple completion on Well Completion or Recompletion Report and Log form.)

13. Describe Proposed or Completed Operations (Clearly state all pertinent details, and give pertinent dates, including estimated date of starting any proposed work. If well is directionally drilled, give subsurface locations and measured and true vertical depths for all markers and zones pertinent to this work.)*

Blackwood & Nichols requests pit closure approval on the NEBU # 10A

An approved below grade double-lined fiberglass containment tank was installed in excavation.

Excavated soils will be landfarmed on location and monitored periodically to determine when TPH & OVM concentrations are below closure standards. Remediated soils will remain on lease.

Attachments: NMOCD Pit Remediation Closure Report, Field diagram, TPH analysis (EPA Method 418.1) on two soil samples.

14. I hereby certify that the foregoing is true and correct

Signed

James K. Ahl

Title: **Operations Engineer**

Date **2-7-95**

(This space for Federal or State office use)

Approved by

Title

Conditions of approval, if any:

Denny E. Faust
DEPUTY OIL & GAS INSPECTOR

Title 18 U.S.C. Section 1001, makes it a crime for any person knowingly and willfully to make to any department or agency of the United States any false, fictitious or fraudulent statements or representations as to any matter within its jurisdiction.

JUL 13 1995

Approved

SUBMIT 1 COPY TO
APPROPRIATE
DISTRICT OFFICE
AND 1 COPY TO
SANTA FE OFFICE

(Revised 3/9/94)

RANKING SCORE (TOTAL POINTS) : 10

Date Remediation Started: 08/25/94 Date Completed: 08/25/94Remediation Method: Excavation XApprox. cubic yards 29

(Check all appropriate sections)

Landfarmed X

Insitu Bioremediation _____

Other _____

Remediation Location: Onsite X Offsite _____(ie. landfarmed onsite,
name and location of
offsite facility)General Description Of Remedial Action: Excavate contaminated soils inimmediate area of prior unlined pit using a backhoe. Excavated to bedrockrefusal. Spoil material thin spread for landfarm treatment. Closure samplestaken and tested by PID and TPH. Place double lined fiberglass pit inexcavation and backfill flush to tank. Pit Closed.Ground Water Encountered: No X Yes _____ Depth _____

Final Pit:

Sample location See attached diagram

Closure Sampling:

Assessment following tank installation(if multiple samples,
attach sample results
and diagram of sample
locations and depths)Sample depth Bedrock (Sandstone)Sample date 08/25/94 Sample time _____

Sample Results

Benzene (ppm) N/ATotal BTEX (ppm) N/AField headspace (ppm) >2500TPH 2172 mg/kgGround Water Sample: Yes _____ No X (If yes, attach sample results)I HEREBY CERTIFY THAT THE INFORMATION ABOVE IS TRUE AND COMPLETE TO THE BEST
OF MY KNOWLEDGE AND BELIEFDATE 2-7-95

SIGNATURE

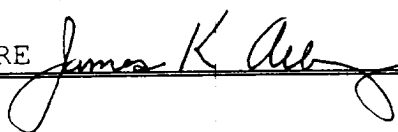
PRINTED NAME
AND TITLEJim Abbey
Operations Engineer

FIELD DIAGRAM

Buckwood & Nichols Co 4-1116
 8/25/94 PIT ASSESSMENT & CLOSURE
 NEDU #10A
 200' FHL & 1000' FWL - 516 - 730V - R7W
 Rio Arroya Co, NM

DEHY / SEP / TR PIT @ 70'E & 30'S OF WELL

SOIL: 0-6' SILTY SAND TO SANDY SILT
 6'-8' FRAGILE SHALE
 8'-9'+ SANDSTONE

OVH
 CTR @ 9'+ SANDSTONE 72500

ORIGINAL PIT: 400 cf
 EXCAVATION: 1101 cf
 EXCAVATED: 781 cf (29 cy)
 LAND FARMED ON SITE.

No.

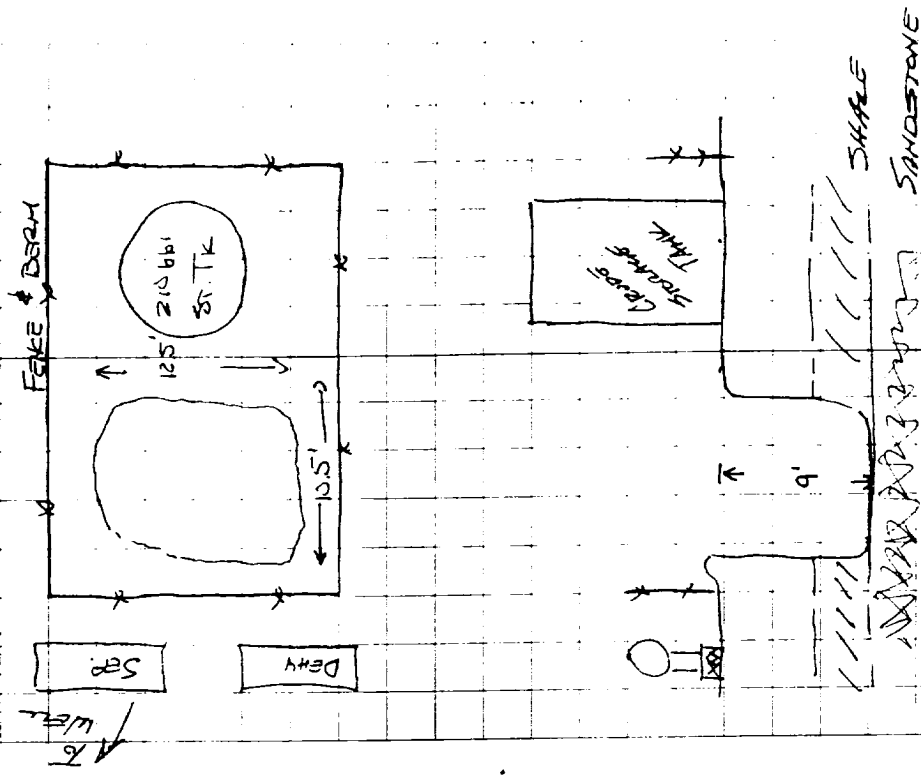



TOTAL PETROLEUM HYDROCARBONS

Attn: *Michael Lane*
Company: *On Site Technologies, Ltd.*
Address: *657 W. Maple*
City, State: *Farmington, NM 87401*

Date: *8/19/94*
Lab ID: *1854*
Sample No. *2551*
Job No. *4-1116*

Project Name: *Blackwood and Nichols Co., Durango, CO*
Project Location: *NEBU #10A, Dhy/Tk Pit Composite @ Sandstone*
Sampled by: *MKL* Date: *8/17/94* Time: *12:15*
Analyzed by: *DLA* Date: *8/19/94*
Type of Sample: *Soil*

Laboratory Analysis

Laboratory Identification	Sample Identification	Total Petroleum Hydrocarbons
<i>2551-1854</i>	<i>Blackwood and Nichols Co., Durango, CO</i> <i>NEBU #10A, Dhy/Tk Pit Composite @ Sandstone</i>	<i>781 mg/kg</i>

Method - EPA Method 418.1 Total Petroleum Hydrocarbons

Approved by: *[Signature]*

Date: *8/19/94*



TOTAL PETROLEUM HYDROCARBONS

Attn: *Myke Lane*
Company: *On Site Technologies, Ltd.*
Address: *657 W. Maple*
City, State: *Farmington, NM 87401*

Date: 8/26/94
Lab ID: *FIELD*
Sample No. *TEST*
Job No. *4-1116*

Project Name: *Blackwood & Nichols Company*
Project Location: *NEBU No. 10A Dehy./Tank Pit; Comp. @ 9' Sandstone*
Sampled by: *MKL* Date: 8/25/94 Time: *NR*
Analyzed by: *MKL* Date: 8/25/94
Type of Sample: *Soil*

Mobil Laboratory Analysis

Laboratory Identification	Sample Identification	Total Petroleum Hydrocarbons
FIELD TEST	<i>Blackwood & Nichols Company</i> <i>NEBU No. 10A Dehy./Tank Pit; Comp. @ 9' Sandstone</i>	2,172 mg/kg

Method - EPA Method 418.1 Total Petroleum Hydrocarbons

Approved by: *Ja L*

Date: *8/26/94*