

District I

P.O. Box 1980, Hobbs, NM

District II

P.O. Drawer DD, Artesia, NM 88211

District III

1000 Rio Brazos Rd, Aztec, NM 87410

State of New Mexico

Energy, Minerals and Natural Resources Department

OIL CONSERVATION DIVISION

P.O. Box 2088

Santa Fe, New Mexico 87504-2088

SUBMIT 1 COPY TO

APPROPRIATE

DISTRICT OFFICE

AND 1 COPY TO

SANTA FE OFFICE

## PIT REMEDIATION AND CLOSURE REPORT

Operator: Phillips Petroleum Company 017654 Telephone: 505-599-3454

Address: 5525 Hwy. 64, NBU 3004, Farmington, NM 87401

Facility Or: San Juan 30-5 Unit #64

Well Name

Location: Unit or Qtr/Qtr Sec N W S W Sec 31 T 30 N R 5 W County Rio Arriba

Pit Type: Separator ☒ Dehydrator ☐ Other ☐

Land Type: BLM ☒ State ☐ Fee ☐ Other ☐

Pit Location: (Attach diagram) Pit dimensions: Length 15', width 15', depth 2 ft  
Reference: wellhead ☒ other ☐  
Footage from reference: 57'  
Direction from reference: 90 Degrees ☐ East ☒ North  
☒ West ☐ South

Depth to Ground Water: 160  
(vertical distance from  
contaminants to seasonal  
highwater elevation of  
ground water)  
☐ Less than 50 feet (20 points)  
☐ 50 ft to 99 feet (10 points)  
☒ Greater than 100 feet (0 points) 0

Wellhead Protection Area:  
(less than 200 feet from a private  
domestic water source, or: less than  
1000 feet from all other water sources).  
☒ Yes (20 points)  
☒ No (0 points) 0

Distance to Surface Water:  
(Horizontal distance to perennial  
lakes, ponds, rivers, streams, creeks,  
irrigation canals and ditches.)  
☒ Less than 200 feet (20 points)  
☐ 200 feet to 1000 feet (10 points)  
☐ Greater than 1000 feet (0 points) 0

PITCFRM WK3

RANKING SCORE (TOTAL POINTS): 0

Date Remediation Started: N/A Dated Completed: \_\_\_\_\_

Excavation \_\_\_\_\_ Approx. cubic yards \_\_\_\_\_

Landfarmed \_\_\_\_\_ Insitu Bioremediation \_\_\_\_\_

Other \_\_\_\_\_

Remediation Method: Onsite \_\_\_\_\_ Offsite \_\_\_\_\_  
(Check all appropriate sections)

General Description of Remedial Action: N/A

Initial assessment showed the soils to be clean at the surface  
and at 2 ft below pit bottom (bedrock).

Ground Water Encountered: No X Yes \_\_\_\_\_ Depth \_\_\_\_\_

Final Pit:

Closure Sampling  
(if multiple samples,  
attach sample results  
and diagram of sample  
locations and depths)

Sample location Deepest part of pit. Sampled with a backhoe.

Sample depth 2 ft Bedrock

Sample date 9/13/96 Sample time \_\_\_\_\_

Sample Results

Benzene (ppm) -

Total BTEX (PPM) -

Field Headspace (ppm) 0.0

TPH 18

Ground Water Sample: Yes \_\_\_\_\_ No X (If yes, attach sample results)

I HEREBY CERTIFY THAT THE INFORMATION ABOVE IS TRUE AND COMPLETED TO THE BEST OF MY KNOWLEDGE AND BELIEF.

DATE 9-20-96

PRINTED NAME Ed Hasely

SIGNATURE

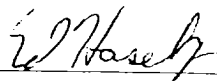

and TITLE Environmental Engineer

C.O.C. NO: *None*

# FIELD REPORT: SITE ASSESSMENT

JOB No: 93167  
PAGE No: 1 of 1

PROJECT: PIT ASSESSMENT  
CLIENT: Phillips Petroleum  
CONTRACTOR: ENVIROTECH, INC.  
EQUIPMENT USED:

DATE STARTED: 9/13/96  
DATE FINISHED: 9/13/96  
ENVIRO. SPCLT: 022  
OPERATOR: \_\_\_\_\_  
ASSISTANT: \_\_\_\_\_

LOCATION: LEASE: Say Juan 30-5 WELL: #64 PC QD: NMD 12335  
SEC: 31 TWP: 30N RNG: 5W PM: NM CNTY: Robt ST: NM PIT: Sap  
LAND USE: Range  
SURFACE CONDITIONS:

PIT CENTER IS LOCATED APPROXIMATELY 57 FEET W OF WELLHEAD.  
Pit is 2' deep BGS

## FIELD 418.1 CALCULATIONS

FIELD 418.1 CALCULATIONS						
SAMPLE I.D.	LAB No:	WEIGHT (g)	mL. FREON	DILUTION	READING	CALC. ppm
T1021	1220	10.166	20	1	10	18

DEPTH TO GROUNDWATER: 160'  
NEAREST WATER SOURCE/TYPE: >1000'  
NEAREST SURFACE WATER: >1000'  
NMOCD RANKING SCORE: 0  
NMOCD TPH CLOSURE STD: 5000ppm

## SAMPLE INVENTORY

[illegible]

SCALE



FEET  $1'' \approx 40'$

# SITE DIAGRAM

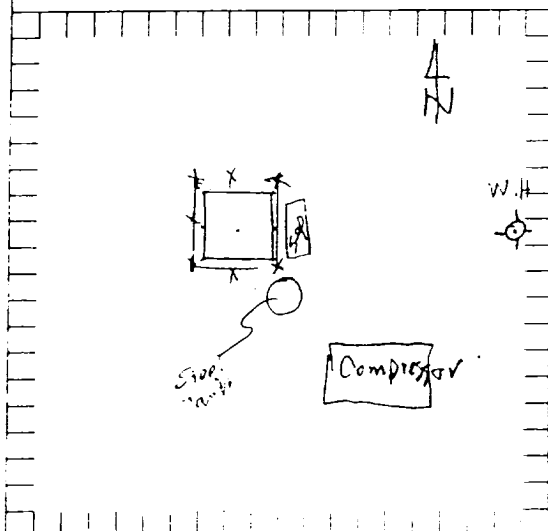

TH#:

TH#:

TH#:

TH#:

[illegible]

SOIL TYPE: C - Clay, M - Silt, S - Sand, G - Gravel      Plasticity: L - None, H - Plastic      Grading: P - Poorly, W - Well

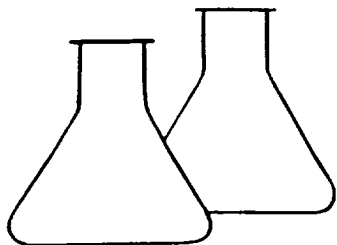

# ENVIROTECH LABS

5796 US HIGHWAY 64-3014 • FARMINGTON, NEW MEXICO 87401  
PHONE: (505) 632-0615 • FAX: (505) 632-1865

## FIELD MODIFIED EPA METHOD 418.1 TOTAL PETROLEUM HYDROCARBONS

Client:	Phillips Petroleum	Project #:	93163
Sample ID:	T1 @ 2.0'	Date Analyzed:	09/13/96
Project Location:	San Juan 30-5 # 64 PC	Date Reported:	09/16/96
Laboratory Number:	GAC1220	Sample Matrix:	Soil

<u>Parameter</u>	<u>Result, mg/kg</u>	<u>Detection Limit, mg/kg</u>
Total Recoverable Petroleum Hydrocarbons	19	10

ND = Not Detectable at stated detection limits.

QA/QC:	QA/QC Sample	Duplicate	%
	_____TPH mg/kg	_____TPH mg/kg	*Diff.
	100	104	4

\*Administrative Acceptance limits set at 30%.

Method: Modified Method 418.1, Petroleum Hydrocarbons, Total Recoverable, Chemical Analysis of Water and Waste, USEPA Storet No.4551, 1978

**Comments:** Pit # PA262

M. J. Collins  
Analyst

A. Chapalang  
Review