

OIL CONSERVATION COMMISSION
Cuyler DISTRICT

OIL CONSERVATION COMMISSION
BOX 2088
SANTA FE, NEW MEXICO

DATE 10-17-78

RE: Proposed MC _____
Proposed DHC _____
Proposed NSL ✓ _____
Proposed SWD _____
Proposed WFX _____
Proposed PMX _____

R. L. Stanets

Gentlemen:

I have examined the application dated 10-2-78
for the C&E Operators, Inc. State Perm #1-A P-16-30N-7W
Operator Lease and Well No. Unit, S-T-R

and my recommendations are as follows:

Approve
Date township's correction

Yours very truly,

AR Spedick

C AND E OPERATORS, INC.

ONE ENERGY SQUARE
SUITE 170
DALLAS, TEXAS 75206
(214) 363-6993

October 2, 1978

Mr. Joe D. Ramey, Director
Oil Conservation Division
P. O. Box 2088
Santa Fe, New Mexico 87501

Dear Mr. Ramey:

We are enclosing three copies of an amended location for the State Comm #1A, Section 16, Township 30 North, Range 6 West, Rio Arriba County, New Mexico with the request that you approve a nonstandard location due to topography as provided in Rule 104, f.

Will you please notify us when it has been approved.
Thank you for your consideration in this matter.

Sincerely yours,

W. Plack Carr, Jr.

WPCjr/nsf

Enc.

cc: Mr. A. R. Kendrick, District Supervisor
Energy and Minerals Department
Oil Conservation Division
1000 Rio Brazos Road
Aztec, New Mexico 87410

Certified Mail No. 836776



| | | | | |
|---|--|-----------------------------|------------------------|--|
| Operator C & E OPERATORS, INC. | | Lease STATE COMM. | | Well No. 3-A |
| Unit Letter 16 | Section 16 | Township 30 NORTH | Range 6 WEST | County RIO ARriba |
| Actual Footage Location of Well: 1140 feet from the SOUTH line and 600 feet from the EAST line | | | | |
| Ground Level Elev. 6258 | Producing Formation Mesa Verde | | Pool Blanco | Dedicated Acreage: 5/320 Acres |

1. Outline the acreage dedicated to the subject well by colored pencil or hachure marks on the plat below.

2. If more than one lease is dedicated to the well, outline each and identify the ownership thereof (both as to working interest and royalty).

3. If more than one lease of different ownership is dedicated to the well, have the interests of all owners been consolidated by communitization, unitization, force-pooling, etc?

☐ Yes ☐ No If answer is "yes," type of consolidation

If answer is "no," list the owners and tract descriptions which have actually been consolidated. (Use reverse side of this form if necessary.)

No allowable will be assigned to the well until all interests have been consolidated (by communitization, unitization, forced-pooling, or otherwise) or until a non-standard unit, eliminating such interests, has been approved by the Commission.

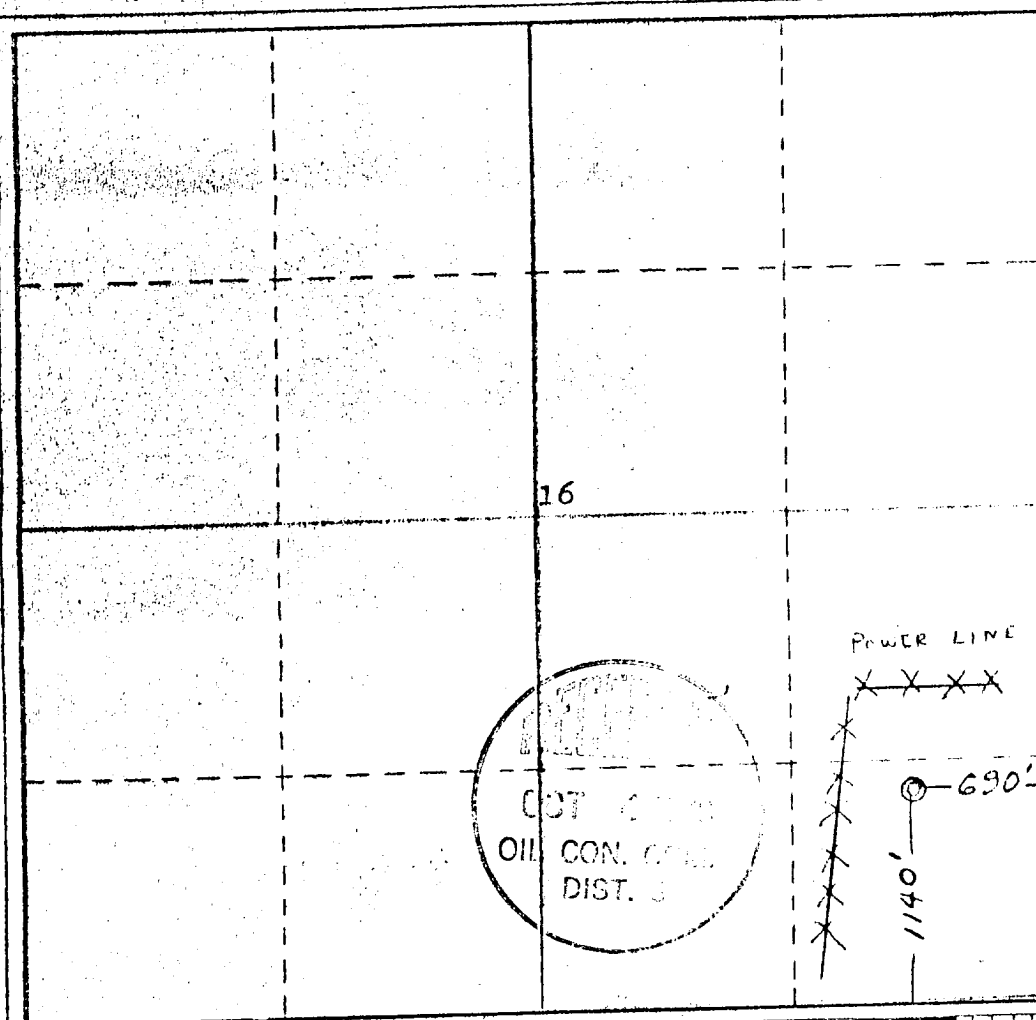

CERTIFICATION

I hereby certify that the information contained herein is true and complete to the best of my knowledge and belief.

James P. Leese
Name

Position

Company

Date

I hereby certify that the well location shown on this plat was plotted from field notes of actual surveys made by me or under my supervision and that the same is true and correct to the best of my knowledge and belief.

Date Surveyed

12 September 1978

Registered Professional Engineer
Survey and Land Surveyor

James P. Leese
James P. Leese

Certificate No.

1463

0 330 660 990 1320 1650 1980 2310 2640 2000 1500 1000 500 0

Section 16, R-7 W.

Northwest Corner, Thoit

Owner of
Land, Thoit.

C&E Operating, Inc.

El Paso Nat. Gas Co.

1

16

1

POWER LINE

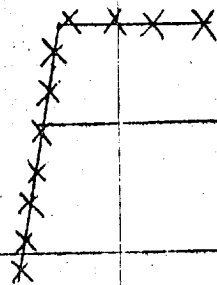

15

1

Northwest Corner, Thoit

State Power

Wichmond & Nichols, Ltd.

El Paso Nat. Gas Co.