

NO. OF COPIES RECEIVED	
DISTRIBUTION	
SANTA FE	
FILE	
U.S.G.S.	
LAND OFFICE	
OPERATOR	

NEW MEXICO OIL CONSERVATION COMMISSION

30-039-22678

Form C-101
Revised 1-1-65

5A. Indicate Type of Lease STATE <input checked="" type="checkbox"/> FEE <input type="checkbox"/>
5. State Oil & Gas Lease No. E-347-26
7. Unit Agreement Name San Juan 30-5 Unit
8. Farm or Lease Name San Juan 30-5 Unit
9. Well No. #41A
10. Field and Pool, or Wildcat Blanco Mesa Verde
10. County Rio Arriba
13. Proposed Depth 5820'
19A. Formation Mesa Verde
20. Rotary or C.T. Rotary
21. Elevations (Show whether DE, RT, etc.) 6449' GR
21A. Kind & Status Plug. Bond
21B. Drilling Contractor Unknown
22. Approx. Date Work will start April 1981

APPLICATION FOR PERMIT TO DRILL, DEEPEN, OR PLUG BACK					
1a. Type of Work b. Type of Well DRILL <input checked="" type="checkbox"/> DEEPEN <input type="checkbox"/> PLUG BACK <input type="checkbox"/> OIL WELL <input type="checkbox"/> GAS WELL <input checked="" type="checkbox"/> OTHER <input type="checkbox"/> SINGLE ZONE <input checked="" type="checkbox"/> MULTIPLE ZONE <input type="checkbox"/>					
2. Name of Operator Northwest Pipeline Corporation					
3. Address of Operator P.O. Box 90, Farmington, N.M. 87401					
4. Location of Well UNIT LETTER I LOCATED 1570' FEET FROM THE South LINE AND 1000' FEET FROM THE East LINE OF SEC. 32 TWP. 30N RGE. 5W NMPM					
23. PROPOSED CASING AND CEMENT PROGRAM					
SIZE OF HOLE	SIZE OF CASING	WEIGHT PER FOOT	SETTING DEPTH	SACKS OF CEMENT	EST. TOP
12-1/4"	9-5/8"	36#	200'	140 cu.ft	Surface
8-3/4"	7"	20#	3733'	300 cu.ft	2550'
6-1/4"	4-1/2"	10.5#	5820'	350 cu.ft	3500'

Selectively perforate and stimulate the Mesa Verde Formation.
Completion plans will be determined at Total Depth.

A BOP will be installed after the surface casing is set and cemented. All subsequent work will be conducted through the BOP's.

The East half of Section 32 is dedicated to this well.

Gas is dedicated.

APPROVED AND
FOR OIL FIELD USE
DRILLING CONTRACTOR

EXPIRES 9-11-81



IN ABOVE SPACE DESCRIBE PROPOSED PROGRAM: IF PROPOSAL IS TO DEEPEN OR PLUG BACK, GIVE DATA ON PRESENT PRODUCTIVE ZONE AND PROPOSED NEW PRODUCTIVE ZONE. GIVE BLOWOUT PREVENTER PROGRAM, IF ANY.

I hereby certify that the information above is true and complete to the best of my knowledge and belief.

Signed Paul C. Thompson Title Drilling Engineer Date March 9, 1981
Paul C. Thompson
(This space for State Use)

APPROVED BY Frank J. Chang TITLE SUPERVISOR DISTRICT #3 DATE MAR 11 1981

CONDITIONS OF APPROVAL, IF ANY:

OIL CONSERVATION DIVISION

STATE OF NEW MEXICO

P. O. BOX 2088

Form C-107

Revised 10-1-77

ENERGY AND MINERALS DEPARTMENT

SANTA FE, NEW MEXICO 87501

All distances must be from the outer boundaries of the Section.

Operator NORTHWEST PIPELINE CORPORATION			Lease SAN JUAN 30-5 UNIT		Well No. 41A
Unit Letter I	Section 32	Township 30N	Range 5W	County Rio Arriba	
Actual Footage Location of Well: 1570 feet from the South line and 1000 feet from the East line					
Ground Level Elev. 6449	Producing Formation Mesa Verde		Pool Blanco Mesa Verde	Dedicated Acreage: 320 Acres	

1. Outline the acreage dedicated to the subject well by colored pencil or hachure marks on the plat below.
2. If more than one lease is dedicated to the well, outline each and identify the ownership thereof (both as to working interest and royalty).
3. If more than one lease of different ownership is dedicated to the well, have the interests of all owners been consolidated by communitization, unitization, force-pooling, etc?

☒ Yes ☐ No If answer is "yes," type of consolidation Unitization

If answer is "no," list the owners and tract descriptions which have actually been consolidated. (Use reverse side of this form if necessary.)

No allowable will be assigned to the well until all interests have been consolidated (by communitization, unitization, forced-pooling, or otherwise) or until a non-standard unit, eliminating such interests, has been approved by the Commission.

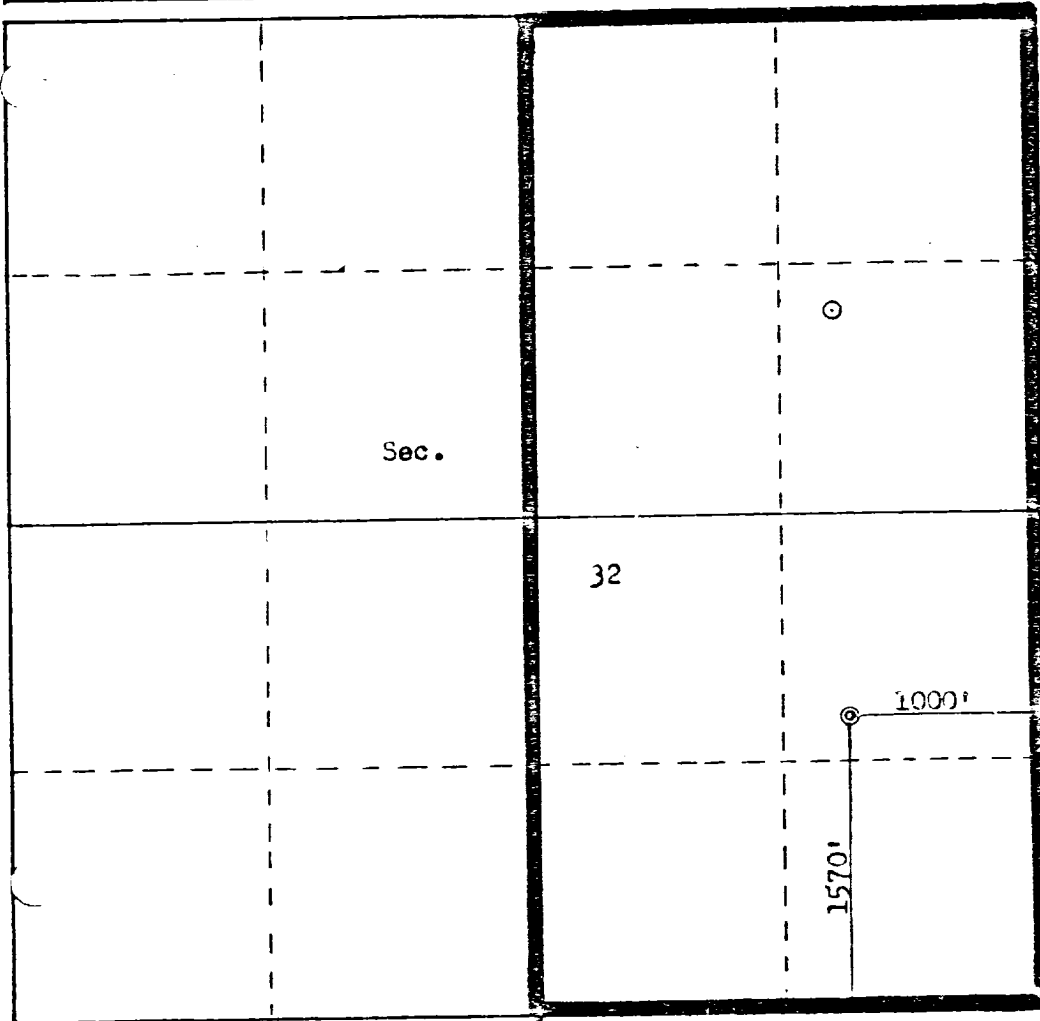

Scale: 1"=1000'

CERTIFICATION

I hereby certify that the information contained herein is true and complete to the best of my knowledge and belief.

Paul C. Thompson

Name

Paul C. Thompson

Position

Drilling Engineer

Company

Northwest Pipeline Corp

Date

March 6, 1981

I hereby certify that the well location shown on this plat was plotted from field notes of actual surveys made by me or under my supervision, and that the same is true and correct to the best of my knowledge and belief.

Date Surveyed

March 4, 1981

Registered Professional Engineer and Land Surveyor

Fred B. Kerr Jr.

Certificate No.

3950