

NO. OF COPIES RECEIVED	
DISTRIBUTION	
SANTA FE	
FILE	
U.S.G.S.	
LAND OFFICE	
OPERATOR	

NEW MEXICO OIL CONSERVATION COMMISSION

20-039-22679

Form C-101
Revised 1-1-65

5A. Indicate Type of Lease	
STATE <input checked="" type="checkbox"/>	FEE <input type="checkbox"/>
5. State Oil & Gas Lease No.	
E-347-26	

APPLICATION FOR PERMIT TO DRILL, DEEPEN, OR PLUG BACK

1a. Type of Work		DRILL <input checked="" type="checkbox"/> DEEPEN <input type="checkbox"/> PLUG BACK <input type="checkbox"/>	
b. Type of Well		OIL WELL <input type="checkbox"/> GAS WELL <input checked="" type="checkbox"/> OTHER <input type="checkbox"/>	
2. Name of Operator		Northwest Pipeline Corporation	
3. Address of Operator		P.O. Box 90, Farmington, N.M. 87401	
4. Location of Well		UNIT LETTER <u>G</u> LOCATED <u>1640'</u> FEET FROM THE <u>North</u> LINE	
AND <u>870'</u> FEET FROM THE <u>East</u> LINE OF SEC. <u>36</u> TWP <u>30N</u> RGE. <u>5W</u> NMPM		10. Field and Pool, or Wildcat	
		Basin Dakota	
		12. County	
		Rio Arriba	
21. Elevations (Show whether DF, RT, etc.)		19. Proposed Depth	
7364' GR		8790'	
21A. Kind & Status Plug. Bond		19A. Formation	
		Dakota	
21B. Drilling Contractor		20. Rotary or C.T.	
Unknown		Rotary	
		22. Approx. Date Work will start	
		April 1981	

23. PROPOSED CASING AND CEMENT PROGRAM

SIZE OF HOLE	SIZE OF CASING	WEIGHT PER FOOT	SETTING DEPTH	SACKS OF CEMENT	EST. TOP
12-1/4"	9-5/8"	36#	350'	220 cu.ft	Surface
8-3/4"	7"	20#	4611'	375 cu.ft	3309'
6-1/4"	4-1/2"	10.5# & 11.6#	8790'	675 cu.ft	4411'

Selectively perforate and stimulate the Dakota Formation.
Completion plans will be determined at Total Depth.

A BOP will be installed after the surface casing is set and cemented. All subsequent work will be conducted through the BOP's.

The East half of Section 36 is dedicated to this well.

Gas is dedicated.

APPROVAL VALID
FOR 60 DAYS UNLESS
DRILLING COMMENCED

EXPIRES 9-11-81



IN ABOVE SPACE DESCRIBE PROPOSED PROGRAM: IF PROPOSAL IS TO DEEPEN OR PLUG BACK, GIVE DATA ON PRESENT PRODUCTIVE ZONE AND PROPOSED NEW PRODUCTIVE ZONE. GIVE BLOWOUT PREVENTER PROGRAM, IF ANY.

I hereby certify that the information above is true and complete to the best of my knowledge and belief.

Signed Paul C. Thompson Title Drilling Engineer Date March 9, 1981

Paul C. Thompson
(This space for State Use)

SUPERVISOR DISTRICT # 3

MAR 11 1981

APPROVED BY

CONDITIONS OF APPROVAL, IF ANY:

with 120 day delay

OIL CONSERVATION DIVISION PIPELINE CORPORATION

STATE OF NEW MEXICO
ENERGY AND MINERALS DEPARTMENT

P. O. BOX 2088

SANTA FE, NEW MEXICO 87501

Form C-107
Revised 10-1-

All distances must be from the outer boundaries of the Section.

Operator NORTHWEST PIPELINE CORPORATION			Lease SAN JUAN 30-5 UNIT PRODUCTION AND DRILLING		Well No. 77
Unit Letter G	Section 36	Township 30N	Range 5W	County RIO ARriba	
Actual Footage Location of Well:					
1640 feet from the North		line and 870 feet from the East		line	
Ground Level Elev. 7364	Producing Formation Dakota		Pool Basin Dakota	Dedicated Acreage: 220.76 Acres	

1. Outline the acreage dedicated to the subject well by colored pencil or hachure marks on the plat below.
2. If more than one lease is dedicated to the well, outline each and identify the ownership thereof (both as to working interest and royalty).
3. If more than one lease of different ownership is dedicated to the well, have the interests of all owners been consolidated by communitization, unitization, force-pooling, etc?

☒ Yes ☐ No If answer is "yes," type of consolidation Unitization

If answer is "no," list the owners and tract descriptions which have actually been consolidated. (Use reverse side of this form if necessary.)

No allowable will be assigned to the well until all interests have been consolidated (by communitization, unitization, forced-pooling, or otherwise) or until a non-standard unit, eliminating such interests, has been approved by the Commission.

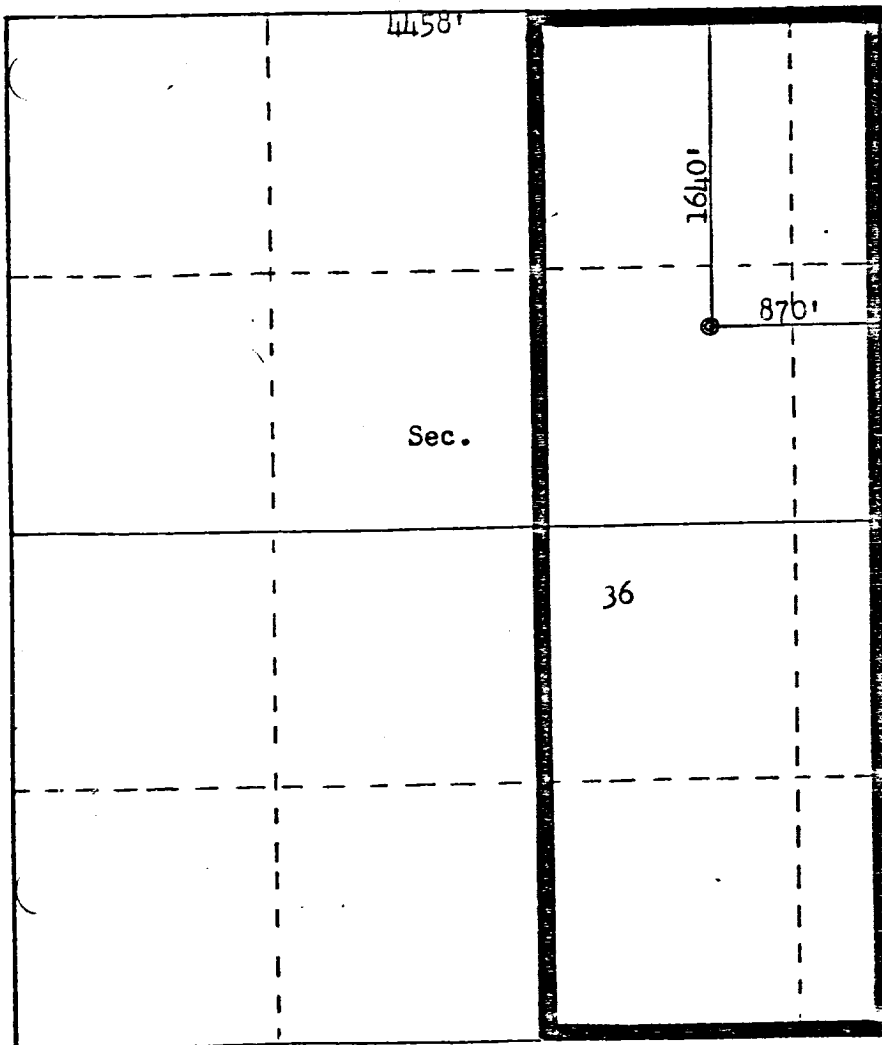

Scale: 1"=1000'

CERTIFICATION

I hereby certify that the information contained herein is true and complete to the best of my knowledge and belief.

Paul C. Thompson

Name

Paul C. Thompson

Position

Drilling Engineer

Company

Northwest Pipeline Corp

Date

March 6, 1981

I hereby certify that the well location shown on this plat was plotted from field notes of actual surveys made by me or under my supervision, and that the same is true and correct to the best of my knowledge and belief.

DIST. 3

Date Surveyed

March 2, 1981

Registered Professional Engineer and Land Surveyor

Fred B. Kerr, Jr.

Certificate No. 3950
FRED B. KERR, JR.

FORM 24-11