

UNITED STATES
DEPARTMENT OF THE INTERIOR
GEOLOGICAL SURVEY

30-039-22707

5. LEASE DESIGNATION AND SERIAL NO.

SF 078997

6. IF INDIAN, ALLOTTEE OR TRIBE NAME

7. UNIT AGREEMENT NAME

San Juan 30-5 Unit

8. FARM OR LEASE NAME

San Juan 30-5 Unit

9. WELL NO.

#78

10. FIELD AND POOL, OR WILDCAT

Basin Dakota

11. SEC. T., R., M., OR BLK.
AND SURVEY OR AREA

Sec 7 T30N R5W

12. COUNTY OR PARISH 13. STATE

Rio Arriba

New Mexico

APPLICATION FOR PERMIT TO DRILL, DEEPEN, OR PLUG BACK

1a. TYPE OF WORK

DRILL ☒DEEPEN ☐PLUG BACK ☐

b. TYPE OF WELL

OIL
WELL ☐GAS
WELL ☒

OTHER

SINGLE
ZONE ☒MULTIPLE
ZONE ☐

2. NAME OF OPERATOR

Northwest Pipeline Corporation

3. ADDRESS OF OPERATOR

P.O. Box 90, Farmington, N.M. 87401

4. LOCATION OF WELL (Report location clearly and in accordance with any State requirements.)*

At surface

1070' FWL & 1800' FSL Sec 7, T30N, R5W

At proposed prod. zone

Same as above

1700' FSL & 1010' FWL

14. DISTANCE IN MILES AND DIRECTION FROM NEAREST TOWN OR POST OFFICE*

25 Miles East of Navajo Dam

15. DISTANCE FROM PROPOSED*

LOCATION TO NEAREST
PROPERTY OR LEASE LINE, FT.
(Also to nearest drlg. unit line, if any)

1070'

16. NO. OF ACRES IN LEASE

N/A

17. NO. OF ACRES ASSIGNED
TO THIS WELL

5/320

18. DISTANCE FROM PROPOSED LOCATION*
TO NEAREST WELL, DRILLING COMPLETED,
OR APPLIED FOR, ON THIS LEASE, FT.

500'

19. PROPOSED DEPTH

7685'

20. ROTARY OR CABLE TOOLS

Rotary

21. ELEVATIONS (Show whether DF, RT, GR, etc.)

6197' GR

DRILLING OPERATIONS AUTHORIZED ARE
SUBJECT TO REGULATIONS WITH ATTACHED23. PROPOSED CEMENTING PROGRAM
"GENERAL REQUIREMENTS"

22. APPROX. DATE WORK WILL START*

April 1, 1981

This action is subject to administrative
appeal pursuant to 30 CFR 290.

SIZE OF HOLE	SIZE OF CASING	WEIGHT PER FOOT	SETTING DEPTH	
12-1/4"	9-5/8"	36#	350'	220 cu.ft
8-3/4"	7"	20#	3490'	350 cu.ft
6-1/4"	4-1/2"	10.5# & 11.6#	7685'	660 cu.ft

Selectively perforate and stimulate the Dakota Formation.
Completion plans will be determined at Total Depth

A BOP will be installed after the surface casing is set and cemented. All subsequent work will be conducted through the BOP's

The South half of Section 7 is dedicated to this well.

Gas is dedicated



IN ABOVE SPACE DESCRIBE PROPOSED PROGRAM: If proposal is to deepen or plug back, give data on present productive zone and proposed new productive zone. If proposal is to drill or deepen directionally, give pertinent data on subsurface locations and measured and true vertical depths. Give blowout preventer program, if any.

24. SIGNED Paul C. Thompson TITLE Drilling Engineer DATE 2-19-81
Paul C. Thompson

(This space for Federal or State office use)

PERMIT NO. _____ APPROVAL DATE _____

APPROVED BY _____ TITLE _____

CONDITIONS OF APPROVAL, IF ANY:

ok 3m

*See Instructions On Reverse Side

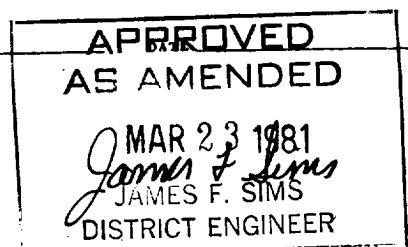

OIL CONSERVATION DIVISION

STATE OF NEW MEXICO

P. O. BOX 2088

Form C-107

ENERGY AND MINERALS DEPARTMENT

SANTA FE, NEW MEXICO 87501

Revised 10-1-78

All distances must be from the outer boundaries of the Section.

Operator NORTHWEST PIPELINE CORPORATION			Lease SAN JUAN 30-5 UNIT		Well No. 78
Unit Letter L	Section 7	Township 30N	Range 5W	County Rio Arriba	
Actual Footage Location of Well: 1700 feet from the South line and 1010 feet from the West line					
Ground Level Elev. 6197'	Producing Formation Dakota		Pool Basin Dakota	Dedicated Acreage: 320 Acres	

1. Outline the acreage dedicated to the subject well by colored pencil or hatchure marks on the plat below.
2. If more than one lease is dedicated to the well, outline each and identify the ownership thereof (both as to working interest and royalty).
3. If more than one lease of different ownership is dedicated to the well, have the interests of all owners been consolidated by communitization, unitization, force-pooling, etc?

☒ Yes ☐ No If answer is "yes," type of consolidation Unitization

If answer is "no," list the owners and tract descriptions which have actually been consolidated. (Use reverse side of this form if necessary.)

No allowable will be assigned to the well until all interests have been consolidated (by communitization, unitization, forced-pooling, or otherwise) or until a non-standard unit, eliminating such interests, has been approved by the Commission.

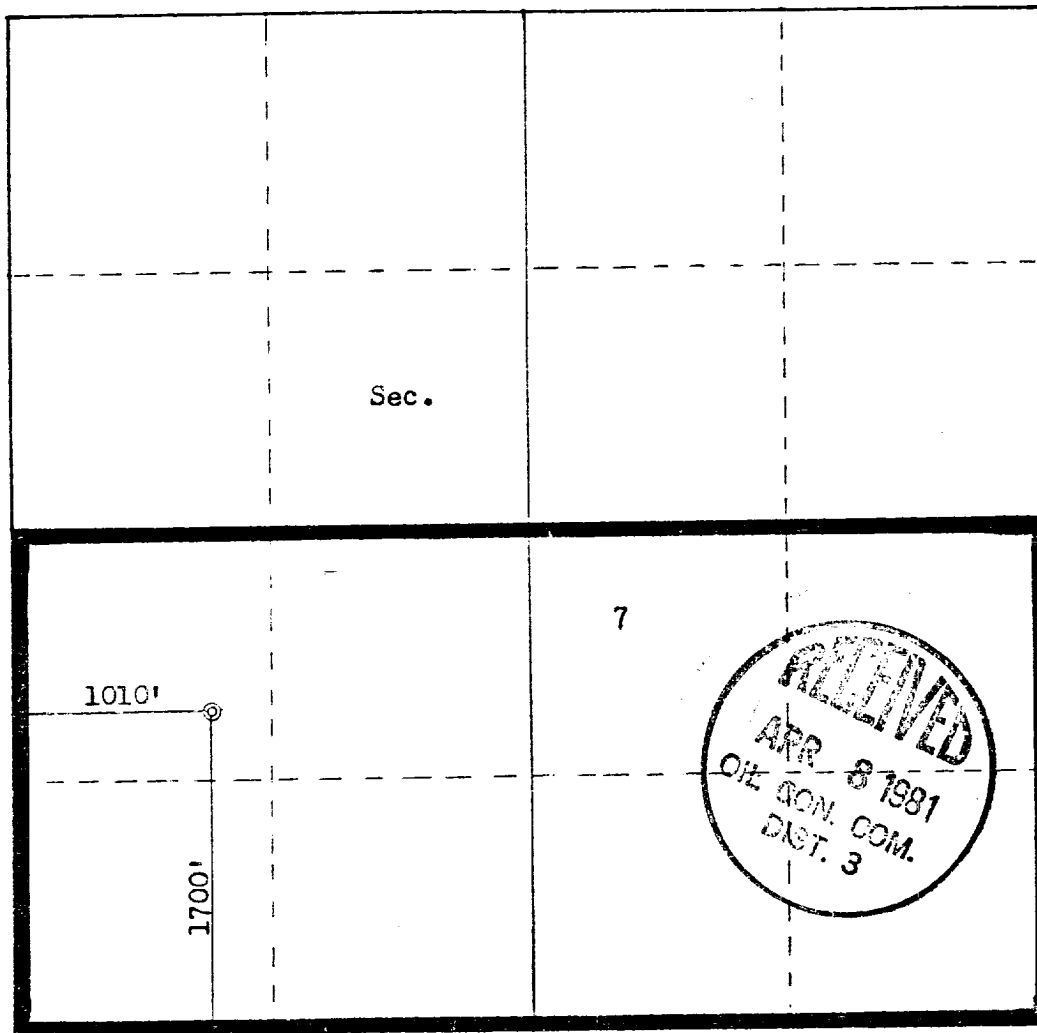

Scale: 1"=1000'

CERTIFICATION

I hereby certify that the information contained herein is true and complete to the best of my knowledge and belief.

Paul C. Thompson
Name

Paul C. Thompson
Position

Drilling Engineer
Company

Northwest Pipeline Corp
Date

March 5, 1981

I hereby certify that the well location shown on this plat was plotted from field notes of actual surveys made by me or under my supervision, and that the same is true and correct to the best of my knowledge and belief.

REGISTERED LAND
DATE SURVEYED
February 26, 1981

Registered Professional Engineer
and Land Surveyor

Fred B. Kerc Jr.
Fred B. Kerc Jr.

Certificate No.

3950

NORTHWEST PIPELINE CORP.

DAKOTA & MESA VERDE LOCATION LAYOUT

SAN JUAN 30-S CLUIT # 78

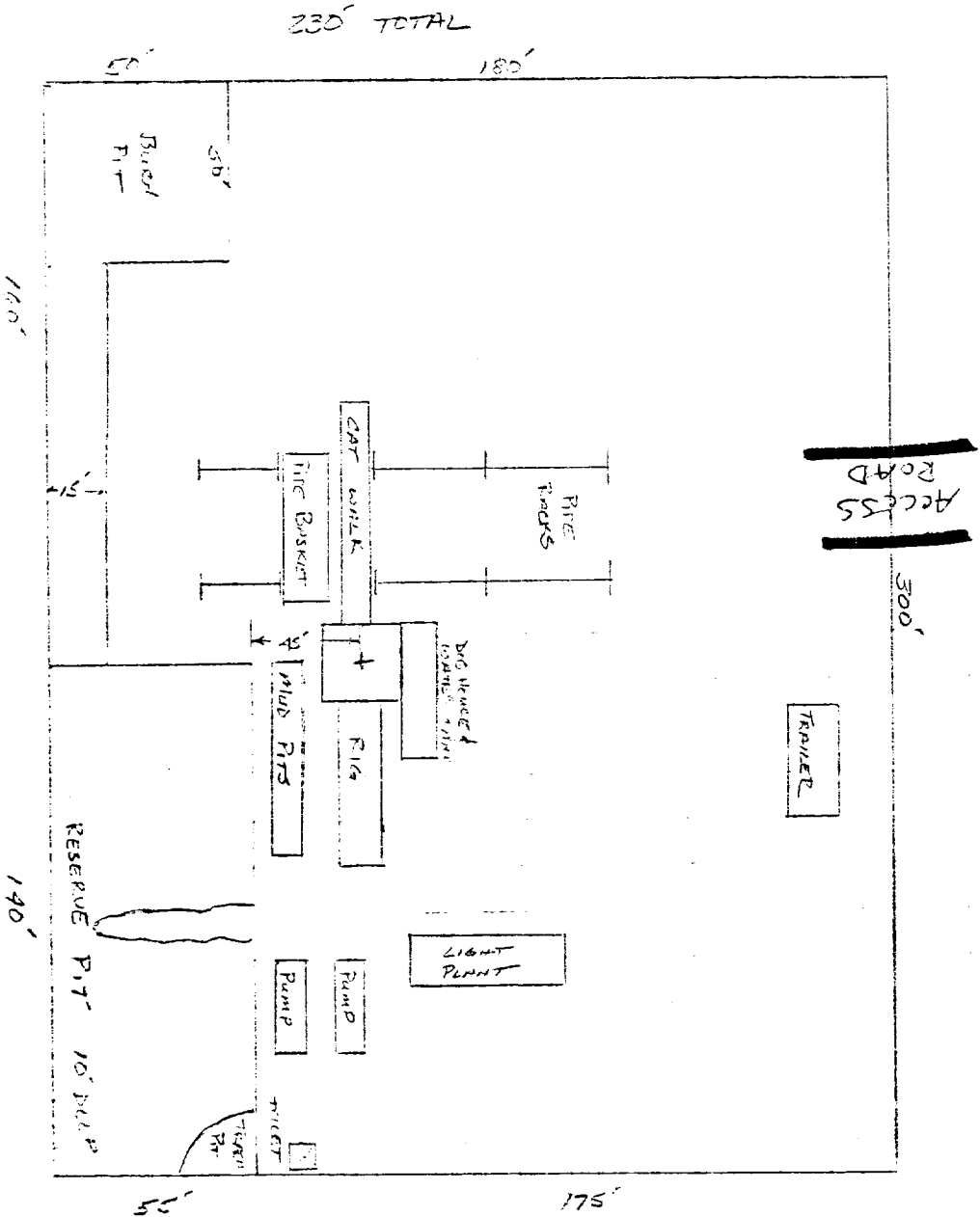

0' CUT & FILL
0' NEW ROAD

SCALE: 1 cm = 20 ft

124