

NO. OF COPIES RECEIVED	
DISTRIBUTION	
SANTA FE	
FILE	
U.S.G.S.	
LAND OFFICE	
OPERATOR	

# NEW MEXICO OIL CONSERVATION COMMISSION

30-039-22756  
Form C-101  
Revised 1-1-65

5A. Indicate Type of Lease
STATE <input type="checkbox"/> FEE <input checked="" type="checkbox"/>

5. State Oil & Gas Lease No.

## APPLICATION FOR PERMIT TO DRILL, DEEPEN, OR PLUG BACK

1a. Type of Work		7. Unit Agreement Name	
b. Type of Well DRILL <input checked="" type="checkbox"/> DEEPEN <input type="checkbox"/> PLUG BACK <input type="checkbox"/> OIL WELL <input type="checkbox"/> GAS WELL <input checked="" type="checkbox"/> OTHER <input type="checkbox"/> SINGLE ZONE <input type="checkbox"/> MULTIPLE ZONE <input checked="" type="checkbox"/>		8. Farm or Lease Name Simms Federal	
2. Name of Operator Southland Royalty Company		9. Well No. 1 EAST BLANCO	
3. Address of Operator P. O. Drawer 570, Farmington, New Mexico 87401		10. Field and Pool, or Wildcat Undesignated Pictured Cliffs Basin Dakota	
4. Location of Well UNIT LETTER J LOCATED 1730 FEET FROM THE South LINE AND 1820 FEET FROM THE East LINE OF SEC. 13 TWP. 30N RGE. 4W NMPM		12. County Rio Arriba	
21. Elevations (Show whether DF, RT, etc.) 7035' KB 7023' GL		19. Proposed Depth 8720'	
21A. Kind & Status Plug, Bond		19A. Formation Dakota Pictured Cliffs	
21B. Drilling Contractor Four Corners Drilling		20. Rotary or C.T. Rotary	
22. Approx. Date Work will start June 30, 1981			

## PROPOSED CASING AND CEMENT PROGRAM

SIZE OF HOLE	SIZE OF CASING	WEIGHT PER FOOT	SETTING DEPTH	SACKS OF CEMENT	EST. TOP
12-1/4"	9-5/8"	32.30#	240'	153 cu.ft. (Circ to surface)	
8-3/4"	5-1/2"	15.50#	8720'	372 cu.ft. (Stage One - Cover Gallup)	
				230 cu.ft. (Stage Two - Cover Cliff House)	
				305 cu.ft. (Stage Three - Cover Ojo Alamo)	

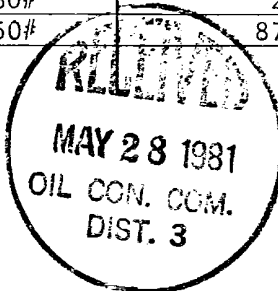

APPROVAL FOR 8 DAYS UNLESS DRILLING COMMENCED, EXPIRES 12-28-81

Surface formation is San Jose.

Top of Ojo Alamo sand is at 3408'.

Top of Pictured Cliffs sand is at 3790'.

Fresh water mud will be used to drill from surface to total depth. It is anticipated that an IEL will be run from surface to 7900', GR-CNL/FDC from 3400' to Total Depth and GR-BHC/Sonic from 3400' to 7900'..

No abnormal pressures or poisonous gases are anticipated in this well.

It is expected that this well will be drilled before September 1, 1981. This depends on time required for approvals, rig availability and the weather.

Gas is not dedicated.

IN ABOVE SPACE DESCRIBE PROPOSED PROGRAM: IF PROPOSAL IS TO DEEPEN OR PLUG BACK, GIVE DATA ON PRESENT PRODUCTIVE ZONE AND PROPOSED NEW PRODUCTIVE ZONE. GIVE BLOWOUT PREVENTER PROGRAM, IF ANY.

I hereby certify that the information above is true and complete to the best of my knowledge and belief.

Signed R. E. Fielder Title District Engineer Date May 26, 1981

(This space for State Use)

APPROVED BY Frank J. Chang TITLE SUPERVISOR DISTRICT # 3

DATE MAY 28 1981

CONDITIONS OF APPROVAL, IF ANY:

All distances must be from the outer boundaries of the Section.

Operator <b>SOUTHLAND ROYALTY COMPANY</b>		Lease <b>Simms Federal</b>		FARMINGTON DISTRICT Well No. <b>1</b>	
Unit <b>J</b>	Section <b>13</b>	Township <b>30N</b>	Range <b>4W</b>	County <b>RIO ARRIBA</b>	
Actual Well Location of Well: <b>1730</b> feet from the <b>South</b> line and <b>1820</b> feet from the <b>East</b> line					
Ground Level Elev. <b>7023</b>	Producing Formation <b>Dakota/Pictured Cliffs</b>	Pool <b>Basin/Undesignated</b>	Dedicated Acreage: <b>320/160</b> Acres		

1. Outline the acreage dedicated to the subject well by colored pencil or hatchure marks on the plat below.

2. If more than one lease is dedicated to the well, outline each and identify the ownership thereof (both as to working interest and royalty).

3. If more than one lease of different ownership is dedicated to the well, have the interests of all owners been consolidated by communitization, unitization, force-pooling, etc?

☒ Yes ☐ No If answer is "yes," type of consolidation Communitization

If answer is "no," list the owners and tract descriptions which have actually been consolidated. (Use reverse side of this form if necessary.) \_\_\_\_\_

No allowable will be assigned to the well until all interests have been consolidated (by communitization, unitization, force-pooling, or otherwise) or until a non-standard unit, eliminating such interests, has been approved by the Commission.

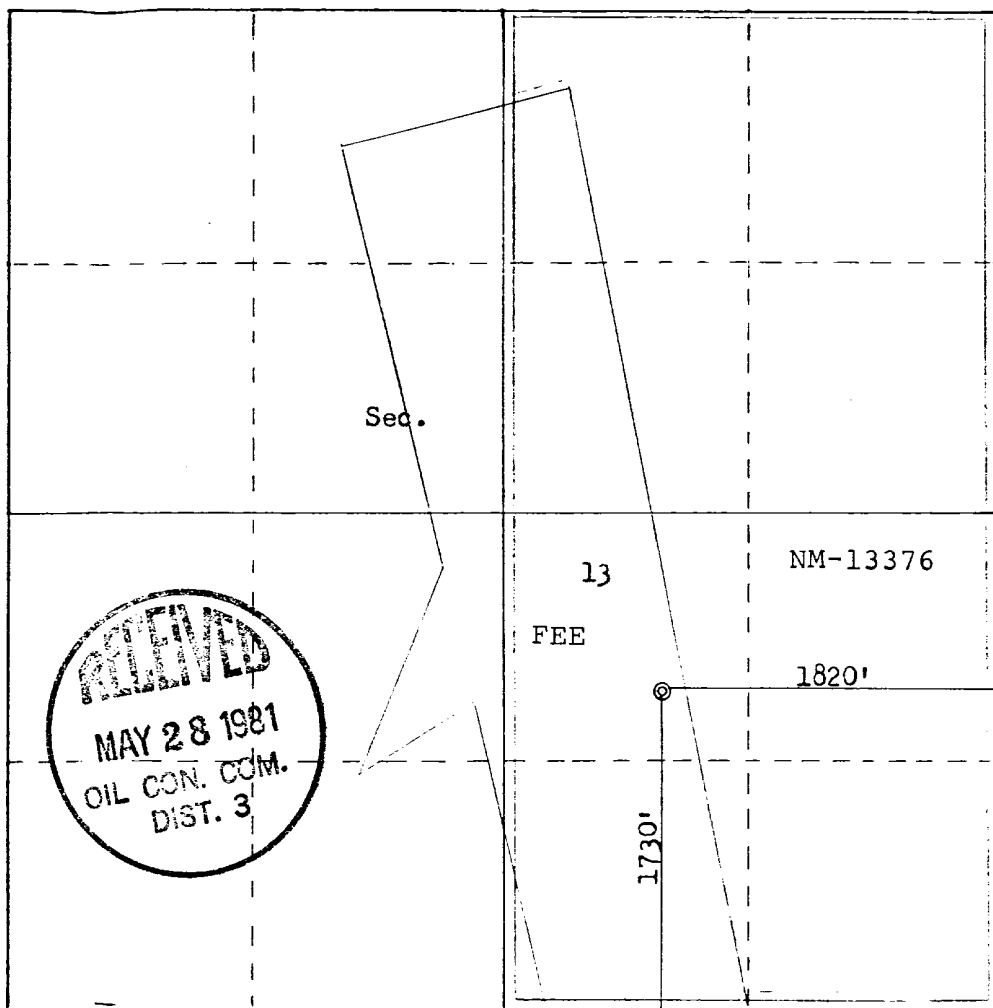

Scale: 1"=1000'

CERTIFICATION	
I hereby certify that the information contained herein is true and complete to the best of my knowledge and belief.	
<i>R.E. Fielder</i>	
Name	Robert E. Fielder
Position	District Engineer
Company	Southland Royalty Company
Date	May 26, 1981
I hereby certify that the well location shown on this plat was plotted from field notes of actual surveys made by me or under my supervision, and that the same is true and correct to the best of my knowledge and belief.	
Date Surveyed	February 1, 1981
Registered Professional Engineer and Land Surveyor	<i>Fred B. Kerr Jr.</i>
Certificate No.	3950

SOUTHLAND ROYALTY COMPANY - DRILLING SCHEDULE

SIMMS FEDERAL #1

1730' FSL & 1820' FEL  
Section 13, T30N, R4W  
Rio Arriba County, New Mexico

Field: Basin Dakota Elevation: 7035' KB  
Undesignated Pictured Cliffs 7023' GL

Geology:

Formation Tops:	Ojo Alamo	3408'	Gallup	7340'
	Fruitland	3448'	Intermediate Log Depth*	7900'
	Pictured Cliffs	3790'	Graneros	8298'
	Cliff House	6016'	Dakota	8470'
	Point Lookout	6192'	Total Depth	8720'

\*NOTE: An 8-3/4" hole will be drilled to below the Gallup (7900'). Logs will be run and a decision then made whether any dual possibilities would necessitate the 8-3/4" hole to Total Depth to facilitate running of 7" production casing. If decision to run 7" is made this program will be adjusted accordingly.

Logging Program: Intermediate Log Depth (7900')  
Run IEL from 7900' to surface casing.  
Run GR-CNL/FDC and GR-BHC/Sonic from 7900'-5800',  
from 4100'-3400' and across any other resistivity highs.  
Total Depth (8720')  
Run IEL and GR-CNL/FDC from total depth to 7800'.  
Run Mud Logger from 3000' to Total Depth

Drilling

Contractor: Tool Pusher:  
SRC Rep: SRC Answering Service: 325-1841  
Dispatch Number: 325-7391  
Mud Program: Fresh water mud from surface to Total Depth.

Materials:

<u>Casing Program:</u>	<u>Hole Size</u>	<u>Depth Set</u>	<u>Casing Size</u>	<u>Weight &amp; Grade</u>
	12-1/4"	240'	9-5/8"	32.30# H-40
	8-3/4"	0'-7900'*	5-1/2"	15.50# K-55
	7-7/8"	7900'-8720'	5-1/2"	15.50# K-55

\*All 5-1/2" casing to be LT&C thread.

Float Equipment:

9-5/8" Surface Casing: B & W Guide Shoe (FC01)

5-1/2" Production Casing: B & W Guide Shoe (FC01). B & W self-fill flapper float collar (FP01) one joint off bottom. Five B & W standard centralizers (AA02) every other joint above shoe. Stage tools run at  $\pm 6600'$  and  $\pm 4200'$  with a cement basket below and five B & W standard centralizers (AA02) above each tool.

Wellhead Equipment: 9-5/8" X 10", 2000 psi bradenhead  
10", 2000 psi X 6", 3000 psi tubinghead.

Cementing:

9-5/8" Surface casing: 130 sacks (153 cu.ft.) of Class "B" with 1/4# gel flake per sack and 3%  $\text{CaCl}_2$ . WOC 12 hours. Test to 600# prior to drilling out. (100% excess.)

5-1/2" Production Casing: STAGE ONE

210 sacks (313 cu.ft.) of Class "B" 50/50 Poz with 6% gel and 1/4# gel flake per sack, followed by 50 sacks (59 cu.ft.) of Class "B" neat with 2%  $\text{CaCl}_2$ . (Volume is 25% excess to cover Gallup.)

STAGE TWO

115 sacks (171 cu.ft.) of Class "B" 50/50 Poz with 6% gel and 1/4# gel flake per sack, followed by 50 sacks (59 cu.ft.) of Class "B" neat with 2%  $\text{CaCl}_2$ . (Volume is 50% excess to cover Cliff House.)

STAGE THREE

165 sacks (246 cu.ft.) of Class "B" 50/50 Poz with 6% gel and 1/4# gel flake per sack, followed by 50 sacks (59 cu.ft.) of Class "B" neat with 2%  $\text{CaCl}_2$ . (50% excess to cover the Ojo Alamo.)

WOC and circulate 4 hours between stages.

---

L. O. Van Ryan  
District Production Manager

5/26/81

JAC/eg



**Southland Royalty Company**

May 26, 1981

Oil Conservation Division  
Mr. Frank Chavez  
1000 Rio Brazos Road  
Aztec, New Mexico 87410

RE: Blowout Preventer Plan

Dear Mr. Chavez:

All drilling and completion rigs will be equipped with 6" or larger double gate hydraulic blowout preventers and a hydraulic operated closing unit with steel lines.

The preventer is 3000# working pressure and 6000# test pressure. All crews will be thoroughly trained in the operation of this preventer. The preventer will be tested frequently enough to ensure proper operation.

Sincerely,

SOUTHLAND ROYALTY COMPANY

R. E. Fielder  
District Engineer

REF/eg

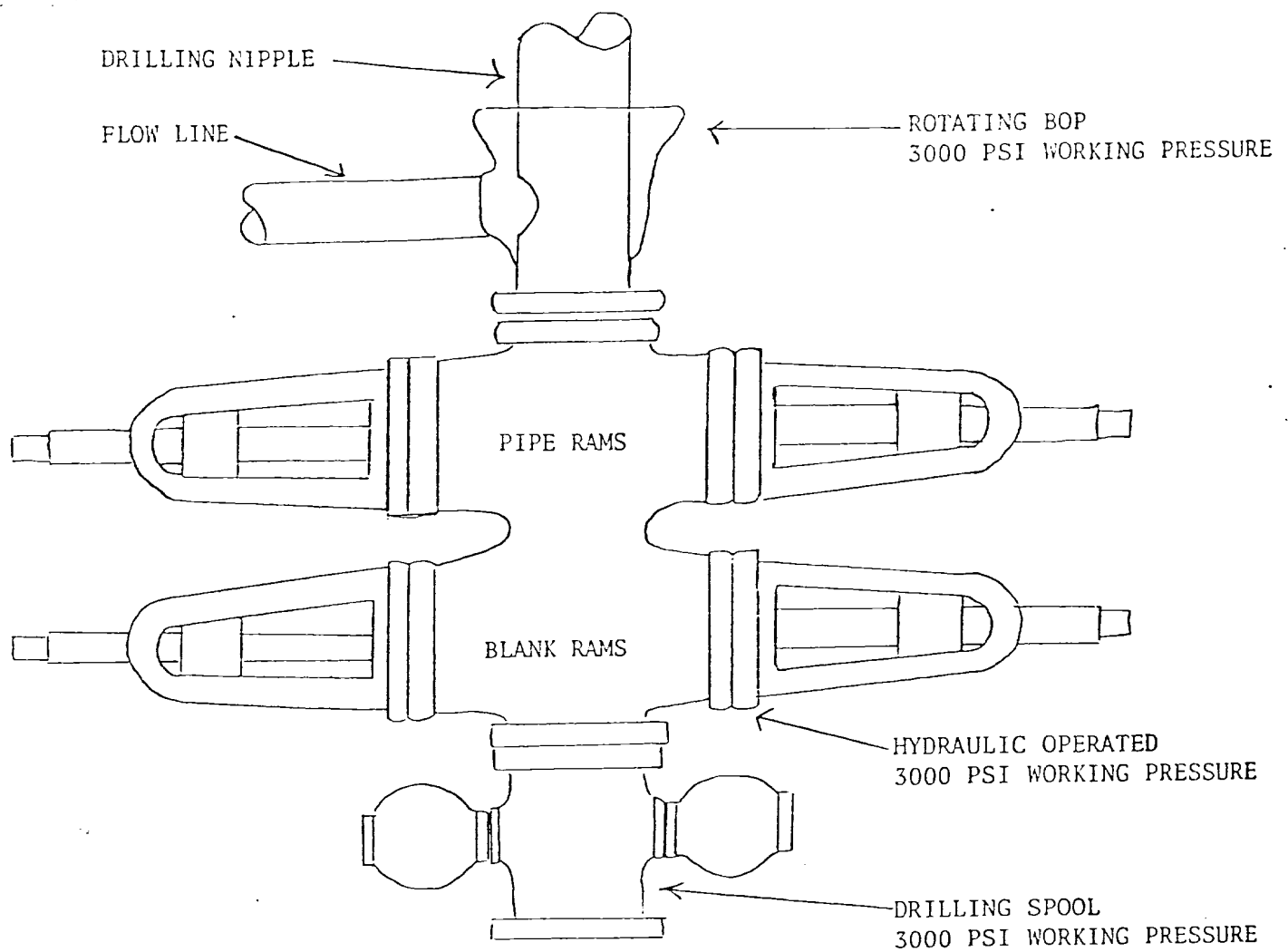

PREVENTERS AND SPOOLS ARE TO HAVE  
THROUGH BORE OF 6" - 3000 PSI OR LARGER



Profile Map for  
 SOUTHLAND ROYALTY COMPANY #1 SIMMS FEDERAL  
 1730' FSL 1820' FEL Sec. 13-T30N-R1W  
 RIO ARRIBA COUNTY, NEW MEXICO

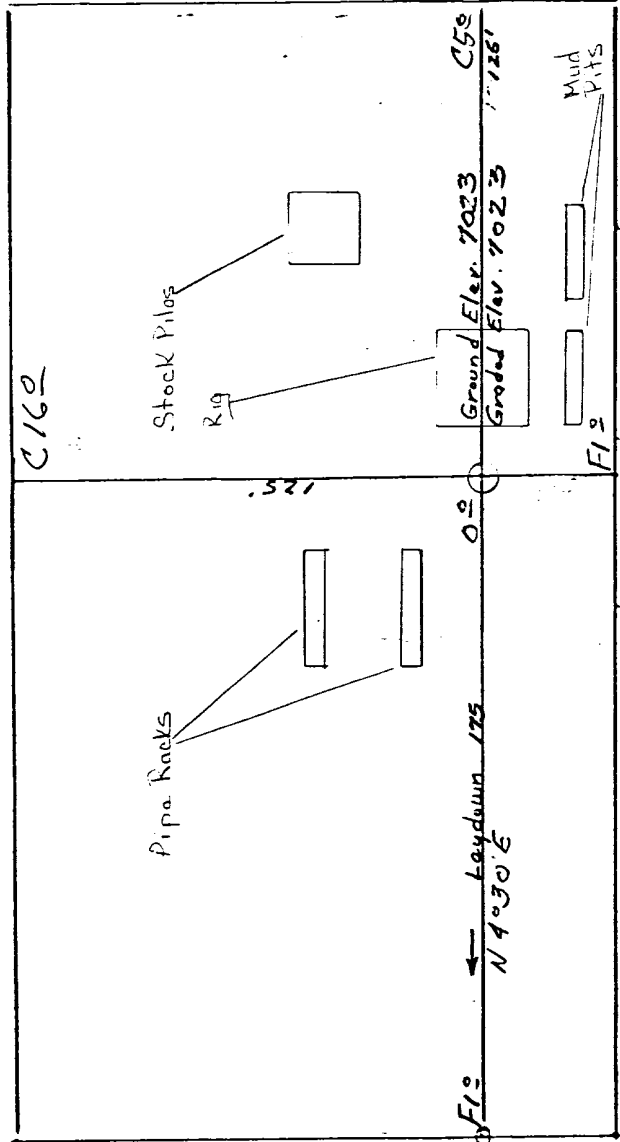

Vert. 1" = 40' Horiz. 1" = 100'

7040				
7030				
7020				

Vert. 1" = 40' Horiz. 1" = 100'

7040				
7030				
7020				

Vert. 1" = 40' Horiz. 1" = 100'

Vert. 1" = 40' Horiz. 1" = 100'

KERR LAND SURVEYING  
 Date: \_\_\_\_\_