

blm
M
of
C



GARREY CARRUTHERS
GOVERNOR

STATE OF NEW MEXICO
ENERGY, MINERALS AND NATURAL RESOURCES DEPARTMENT
OIL CONSERVATION DIVISION

POST OFFICE BOX 2088
STATE LAND OFFICE BUILDING
SANTA FE, NEW MEXICO 87504
(505) 827-5800

September 14, 1990

Meridian Oil, Inc.
P.O. Box 4289
Farmington, NM 87499-4289

Attention: Peggy Bradfield

RECEIVED
SEP 21 1990
OIL CON. DIV.
DIST. 3

Administrative Order NSL-2862

Dear Ms. Bradfield:

Reference is made to your application dated August 9, 1990 for a non-standard Basin-Fruitland coal gas well location for your existing **Simms Federal Well No. 3** which was drilled in September 1982 and completed in the East Blanco Pictured Cliffs Pool at a standard gas well location 1540 feet from the North line and 1100 feet from the West line (Unit E) of Section 11, Township 30 North, Range 4 West, NMPM, Rio Arriba County, New Mexico.

It is my understanding that the Pictured Cliffs zone will be properly plugged back and said well will be recompleted to the Basin-Fruitland Coal Gas Pool, which pursuant to the Special Rules and Regulations for the Basin-Fruitland Coal Gas Pool as promulgated by Division Order No. R-8768, is unorthodox. Further, the W/2 equivalent of said Section 11 shall be dedicated to the well forming a standard 320-acre, more or less, gas spacing and proration unit for said pool.

By the authority granted me under the provisions of Rule 8 of said Division Order No. R-8768, the above-described unorthodox coal gas well location is hereby approved.

Sincerely,

William J. LeMay
Director

WJL/MES/ag

cc: Oil Conservation Division - Aztec



STATE OF NEW MEXICO
ENERGY AND MINERALS DEPARTMENT
OIL CONSERVATION DIVISION
AZTEC DISTRICT OFFICE

GARREY CARRUTHERS
GOVERNOR

1000 RIO HUAZOS ROAD
AZTEC, NEW MEXICO 87410
(505) 334-8178

Date: 8-29-50

Mike Stogner

Oil Conservation Division
P.O. Box 2088
Santa Fe, NM 87504-2088

Re: Proposed MC _____
Proposed DHC _____
Proposed NSL X _____
Proposed SWD _____
Proposed WFX _____
Proposed PMX _____

Gentlemen:

I have examined the application dated 8-10-50
for the Mendocino Oil Inc. Suns Federal #3
Operator Lease & Well No.

E-11-30N-4W and my recommendations are as follows:
Unit, S-T-R

Approve after if orderly off pattern
development

Yours truly,

Ernest Grupe

MERIDIAN OIL

August 9, 1990

Federal Express

Mr. William LeMay
New Mexico Oil Conservation Division
Post Office Box 2088
Santa Fe, New Mexico 87503

RE: Simms Federal #3
1540'FNL, 1100'FWL
Section 11, T-30-N, R-04-W
Rio Arriba, New Mexico

Dear Mr. LeMay:

This is a request for administrative approval for a non-standard gas well location in the Basin Fruitland Pool.

Meridian Oil intends to plugback and recomplete the Simms Federal #3 well from the Pictured Cliffs pool to the Basin Fruitland Coal Pool. The current location of this well is 1540'FNL, 1100'FWL, Section 11, T-30-N, R-04-W, Rio Arriba, New Mexico. The well is considered non-standard due to the NE-SW dedicated pattern established for the Basin Fruitland Coal Pool. To comply with the New Mexico Oil Conservation Division rules, Meridian is submitting the following for your approval of this non-standard location:

1. C-102 plat showing location of the well;
2. Plat showing offset owners/operators;
3. Copy of Well Completion Log for original completion.

All surrounding lands are operated and owned by Meridian Oil Inc.

Sincerely yours,

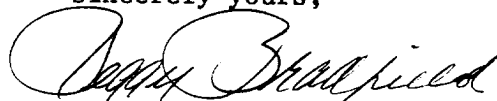

Peggy Bradfield
encl.

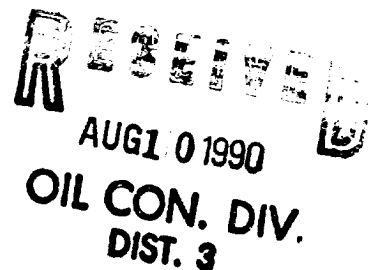

EL PASO NATURAL GAS COMPANY

Well Name Simms Federal #3

Footage 1540' FNL; 1100' FWL

APPLICATION FOR NON-STANDARD LOCATION

County Rio Arriba State New Mexico Section 11 Township 30N Range 4W

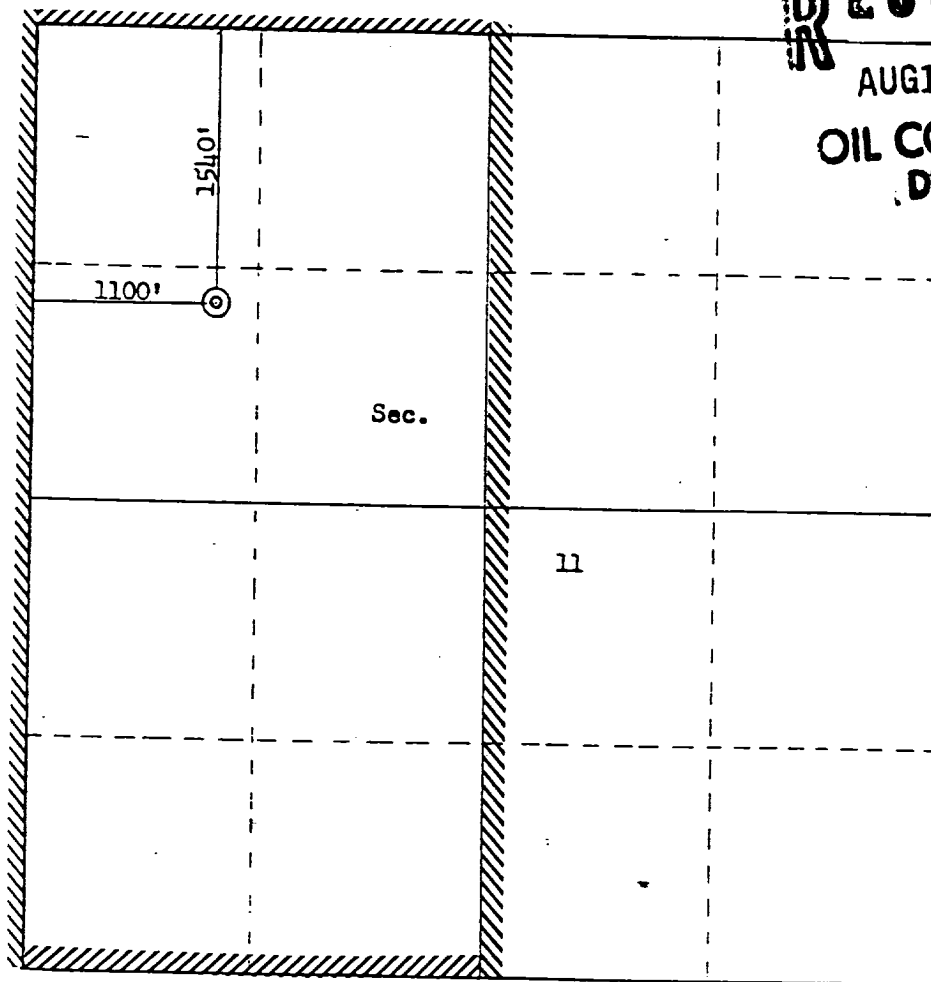

RECEIVED
AUG 10 1990
OIL CON. DIV.
DIST. 3

Remarks All surrounding lands are operated and owned by Meridian Oil Inc

All distances must be from the outer boundaries of the Section.

Operator SOUTHLAND ROYALTY COMPANY			Lease SIMMS-FEDERAL (Fee)		Well No. 3
Unit Letter E	Section 11	Township 30N	Range 4W	County Rio Arriba	
Actual Footage Location of Well: 1540 feet from the North line and 1100 feet from the West line					
Ground Level Elev: 6853	Producing Formation Fruitland Coal		Pool Basin		Dedicated Acreage: 320.16 Acres

1. Outline the acreage dedicated to the subject well by colored pencil or hachure marks on the plat below.
2. If more than one lease is dedicated to the well, outline each and identify the ownership thereof (both as to working interest and royalty).
3. If more than one lease of different ownership is dedicated to the well, have the interests of all owners been consolidated by communitization, unitization, force-pooling, etc?

☐ Yes ☐ No If answer is "yes," type of consolidation communitization agreement will be obtained

If answer is "no," list the owners and tract descriptions which have actually been consolidated. (Use reverse side of this form if necessary.) _____

No allowable will be assigned to the well until all interests have been consolidated (by communitization, unitization, forced-pooling, or otherwise) or until a non-standard unit, eliminating such interests, has been approved by the Commission.

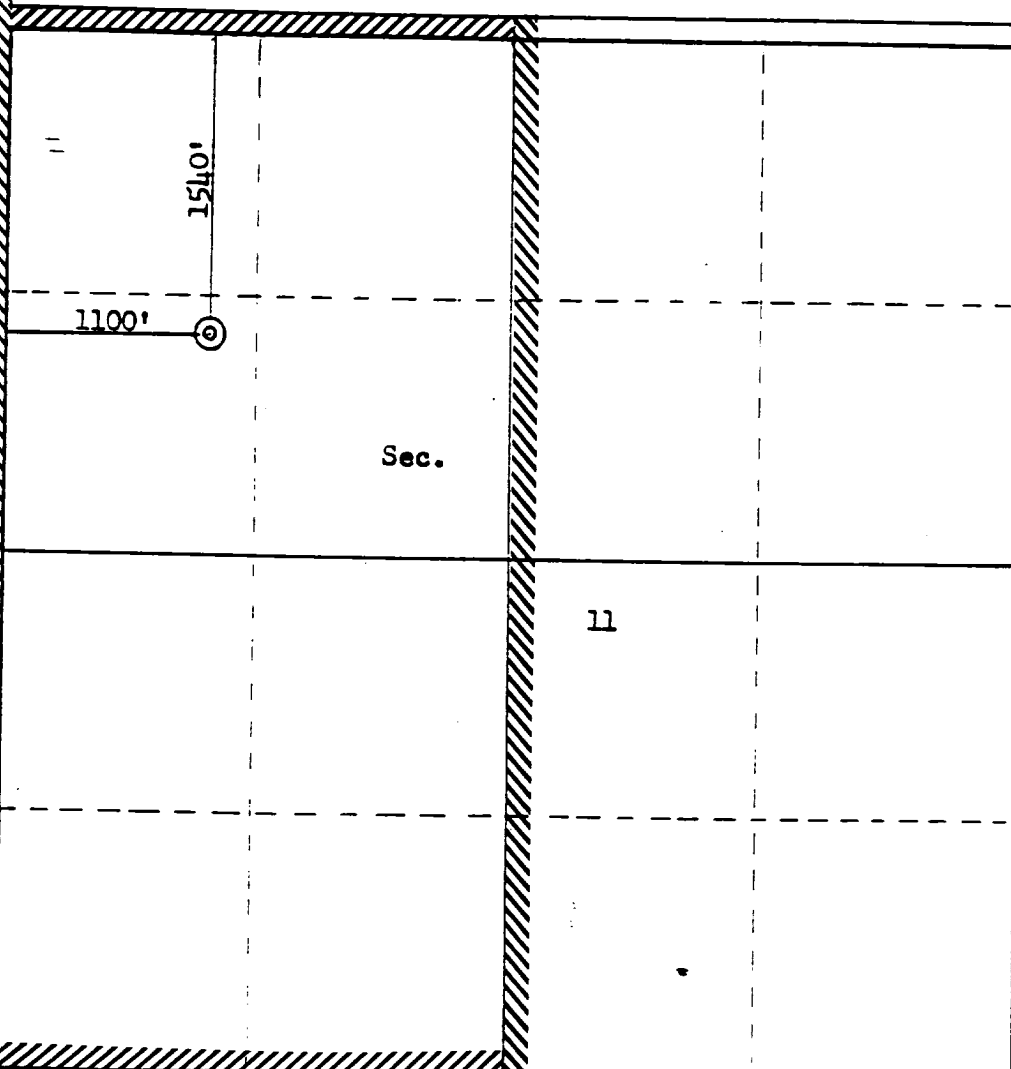

CERTIFICATION

I hereby certify that the information contained herein is true and complete to the best of my knowledge and belief.

Name
Peggy Bradfield
Position
Regulatory Affairs
Company
Southland Royalty Co

Date
7-13-90

I hereby certify that the well location shown on this plat was plotted from field notes of actual surveys made by me or under my supervision, and that the same is true and correct to the best of my knowledge and belief.

Date Surveyed
August 6, 1982

Registered Professional Engineer
and Land Surveyor

Fred B. Kerr Jr.

NO. OF COPIES RECEIVED	
DISTRIBUTION	
SANTA FE	
FILE	
U.S.G.S.	
LAND OFFICE	
OPERATOR	

**FAR NEW MEXICO OIL CONSERVATION COMMISSION
WELL COMPLETION AND RECOMPLETION REPORT AND LOG**

DIST. 3

Form C-105
Revised 1-1-65

5a. Indicate Type of Lease
State ☐ Fee ☒
5. State Oil & Gas Lease No.

1a. TYPE OF WELL
OIL WELL ☐ GAS WELL ☒ DRY ☐ OTHER ☐
b. TYPE OF COMPLETION
NEW WELL ☒ WORK OVER ☐ DEEPEN ☐ PLUG BACK ☐ DIFF. RESVR. ☐ OTHER ☐
2. Name of Operator
Southland Royalty Company
3. Address of Operator
P.O. Drawer 570, Farmington, New Mexico 87499
4. Location of Well

7. Unit Agreement Name
8. Farm or Lease Name
Simms Federal
9. Well No.
3
10. Field and Pool, or Wildcat
E. Blanco P.C. Extension

UNIT LETTER **E** LOCATED **1540** FEET FROM THE **North** LINE AND **1100** FEET FROM
West LINE OF SEC. **11** TWP. **30N** RGE. **4W** 4MPM

12. County
Rio Arriba

15. Date Spudded **9-19-82** 16. Date T.D. Reached **9-25-82** 17. Date Compl. (Ready to Prod.) **11-09-82** 18. Elevations (DF, RKB, RT, GR, etc.) **6872' KB** 19. Elev. Casinghead **6853' GL**

20. Total Depth **4000'** 21. Plug Back T.D. **3945'** 22. If Multiple Compl., How Many
23. Intervals Drilled By Rotary Tools **0-4000'** Cable Tools **---**

24. Producing Interval(s), of this completion - Top, Bottom, Name
3654'-3912' (Pictured Cliffs) 25. Was Directional Survey Made
Deviation

26. Type Electric and Other Logs Run
IEL, CDL and GR-CBL/CCL 27. Was Well Cored
No

28. CASING RECORD (Report all strings set in well)					
CASING SIZE	WEIGHT LB./FT.	DEPTH SET	HOLE SIZE	CEMENTING RECORD	AMOUNT PULLED
8-5/8"	24#	224'	12-1/4"	324 cu.ft. (Circ to surface)	
4-1/2"	10.5#	3985'	7-7/8"	371 cu.ft. (Good circ)	

29. LINER RECORD					30. TUBING RECORD		
SIZE	TOP	BOTTOM	SACKS CEMENT	SCREEN	SIZE	DEPTH SET	PACKER SET
----	----	---	---		1-1/2"	3874'	---

31. Perforation Record (Interval, size and number).
Pictured Cliffs: (17 holes)
3654', 3660', 3666', 3672', 3678', 3684', 3690', 3696', 3702', 3708', 3713', 3718', 3724', 3729', 3882', 3894', 3912'.

32. ACID, SHOT, FRACTURE, CEMENT SQUEEZE, ETC.	
DEPTH INTERVAL	AMOUNT AND KIND MATERIAL USED
3654'-3912'	Frac'd with 134,960 gals of fresh water and 120,000# of 20/40 sand

33. PRODUCTION

Date First Production 12-29-82	Production Method (Flowing, gas lift, pumping - Size and type pump) Flowing	Well Status (Prod. or Shut-in) Shut-In
Date of Test 12-29-82	Hours Tested 3	Choke Size 5/8"
Flow Tubing Press. 241	Casing Pressure 601	Calculated 24-Hour Rate ---
Prod'n. For Test Period ---	Oil - Bbl. ---	Gas - MCF 250
Water - Bbl. ---	Gas - Oil Ratio ---	
Oil - Bbl. ---	Gas - MCF 2002	Water - Bbl. ---
Oil Gravity - API (Corr.) ---		

34. Disposition of Gas (Sold, used for fuel, vented, etc.)
To be sold Test Witnessed By
Ode11 Farley

35. List of Attachments

36. I hereby certify that the information shown on both sides of this form is true and complete to the best of my knowledge and belief.

SIGNED *Catherine Greff* TITLE Secretary DATE 1-5-83