

UNITED STATES
DEPARTMENT OF THE INTERIOR
GEOLOGICAL SURVEY

30-039-23173

APPLICATION FOR PERMIT TO DRILL, DEEPEN, OR PLUG BACK

1a. TYPE OF WORK DRILL <input checked="" type="checkbox"/> DEEPEN <input type="checkbox"/> PLUG BACK <input type="checkbox"/>		5. LEASE DESIGNATION AND SERIAL NO. SF 078739
b. TYPE OF WELL OIL WELL <input type="checkbox"/> GAS WELL <input checked="" type="checkbox"/> OTHER <input type="checkbox"/>		6. IF INDIAN, ALLOTTEE OR TRIBE NAME
2. NAME OF OPERATOR Northwest Pipeline Corporation		7. UNIT AGREEMENT NAME San Juan 30-5 Unit
3. ADDRESS OF OPERATOR P.O. Box 90, Farmington, N.M. 87499		8. FARM OR LEASE NAME San Juan 30-5 Unit
4. LOCATION OF WELL (Report location clearly and in accordance with any State requirements.) At surface 1535 FNL & 1120 FEL SE/NE At proposed prod. zone 1535 FNL & 1120 FEL SE/NE		9. WELL NO. #90
14. DISTANCE IN MILES AND DIRECTION FROM NEAREST TOWN OR POST OFFICE* 20 Miles East of Navajo Dam Post Office		10. FIELD AND POOL, OR WILDCAT Basin Dakota
15. DISTANCE FROM PROPOSED* LOCATION TO NEAREST PROPERTY OR LEASE LINE, FT. (Also to nearest drlg. unit line, if any) 1120'		11. SEC., T., R., M., OR BLK. AND SURVEY OR AREA H Sec 22, T30N, R5W
16. NO. OF ACRES IN LEASE N/A		12. COUNTY OR PARISH Rio Arriba
17. NO. OF ACRES ASSIGNED TO THIS WELL E 320		13. STATE N.M.
18. DISTANCE FROM PROPOSED* LOCATION TO NEAREST WELL, DRILLING COMPLETED, OR APPLIED FOR, ON THIS LEASE, FT. 500'		19. PROPOSED DEPTH 8095'
20. ROTARY OR CABLE TOOLS Rotary		21. APPROX. DATE WORK WILL START* December 1982
21. ELEVATIONS (Show whether DF, RT, GR, etc.) 6670' GR		

PROPOSED CASING AND CEMENTING PROGRAM

SIZE OF HOLE	SIZE OF CASING	WEIGHT PER FOOT	SETTING DEPTH	QUANTITY OF CEMENT
12-1/4"	9-5/8"	32.3#	350'	220 cu.ft
8-3/4"	7"	20#	3800'	265 cu.ft
6-1/4"	4-1/2"	10.5# & 11.6#	8095'	675 cu.ft

Selectively perforate and stimulate the Dakota Formation. Completion plans will be determined at Total Depth.

A BOP will be installed after the surface casing is set and cemented. All subsequent work will be conducted through the BOP's.

The East half of Section 22 is dedicated to this well.

Gas is dedicated.

IN ABOVE SPACE DESCRIBE PROPOSED PROGRAM: If proposal is to deepen or plug back, give data on present productive zone and proposed new productive zone. If proposal is to drill or deepen directionally, give pertinent data on subsurface locations and measured and true vertical depths. Give blowout preventer program, if any.

24. SIGNED <u>Paul C. Thompson</u> TITLE <u>Drilling Engineer</u> DATE <u>11-16-82</u>	
(This space for Federal or State office use)	
PERMIT NO. _____	APPROVAL DATE _____
APPROVED BY _____	TITLE _____
CONDITIONS OF APPROVAL, IF ANY:	

PCT:djb

*See Instructions On Reverse Side

NMOCC

APPROVED
AS AMENDED

DATE

FEB 28 1983

For JAMES F. SIMS
DISTRICT ENGINEER

OIL CONSERVATION DIVISION

STATE OF NEW MEXICO
ENERGY AND MINERALS DEPARTMENTP. O. BOX 2088
SANTA FE, NEW MEXICO 87501Form C-107
Revised 10-1-78

All distances must be from the outer boundaries of the Section.

Operator NORTHWEST PIPELINE CORPORATION			Lease SAN JUAN 30-5 UNIT		Well No. 90
Unit Letter H	Section 22	Township 30N	Range 5W	County Rio Arriba	
Actual Footage Location of Well: 1535 feet from the North line and 1120 feet from the East line					
Ground Level Elev. 6670	Producing Formation Dakota		Pool Basin Dakota		Dedicated Acreage: E 320 Acres

1. Outline the acreage dedicated to the subject well by colored pencil or hatchure marks on the plat below.
2. If more than one lease is dedicated to the well, outline each and identify the ownership thereof (both as to working interest and royalty).
3. If more than one lease of different ownership is dedicated to the well, have the interests of all owners been consolidated by communitization, unitization, force-pooling, etc?

☒ Yes ☐ No If answer is "yes," type of consolidation Unitization

If answer is "no," list the owners and tract descriptions which have actually been consolidated. (Use reverse side of this form if necessary.) _____

No allowable will be assigned to the well until all interests have been consolidated (by communitization, unitization, forced-pooling, or otherwise) or until a non-standard unit, eliminating such interests, has been approved by the Commission.

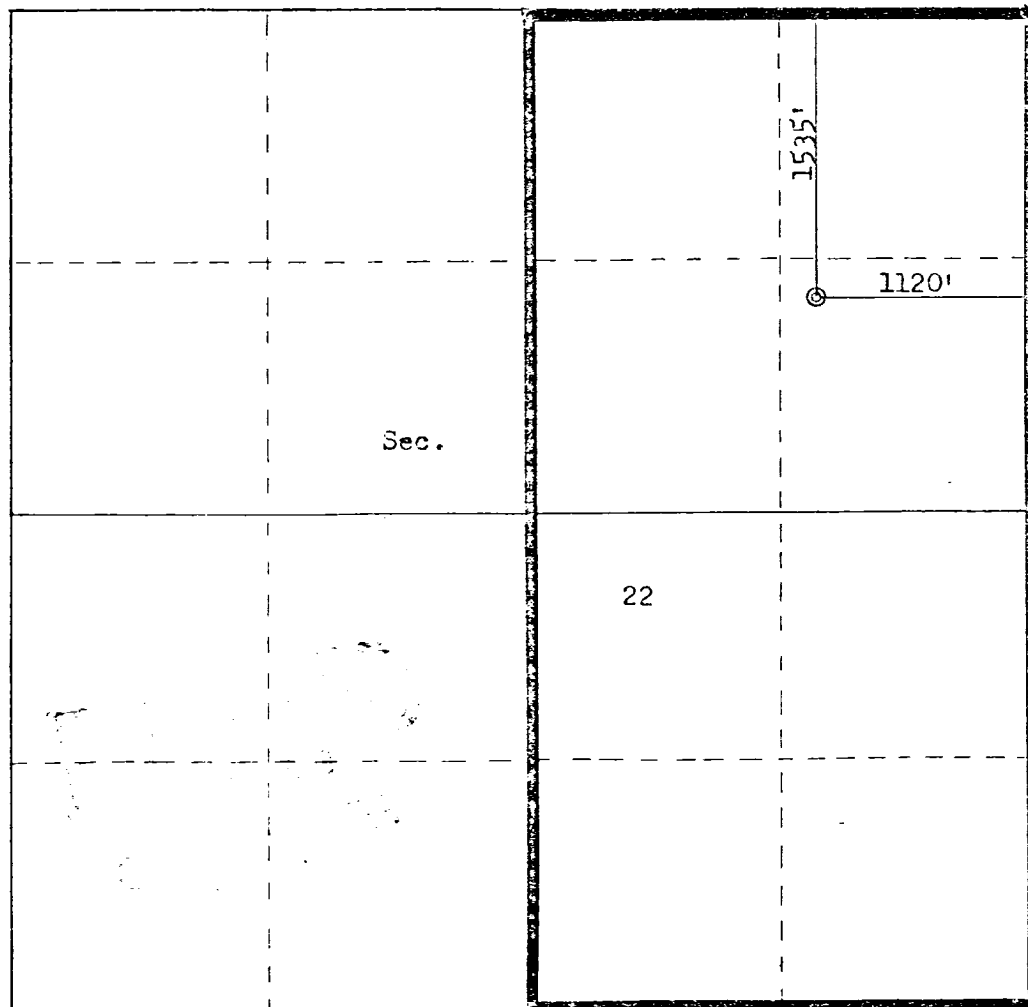

Scale: 1"=1000'

CERTIFICATION

I hereby certify that the information contained herein is true and complete to the best of my knowledge and belief.

Paul C. Thompson

Name

Paul C. Thompson

Position

Drilling Engineer

Company

Northwest Pipeline Corp

Date

November 12, 1982

I hereby certify that the well location shown on this plat was plotted from field notes of actual surveys made by me or under my supervision, and that the same is true and correct to the best of my knowledge and belief.

Date Surveyed

November 8, 1982

Registered Professional Engineer
and Land Surveyor

Fred B. Kerr Jr.
Fred B. Kerr Jr.

Certificate No. **3950**

