

UNITED STATES  
DEPARTMENT OF THE INTERIOR  
GEOLOGICAL SURVEY

## APPLICATION FOR PERMIT TO DRILL, DEEPEN, OR PLUG BACK

1a. TYPE OF WORK DRILL <input checked="" type="checkbox"/> DEEPEN <input type="checkbox"/> PLUG BACK <input type="checkbox"/>		5. LEASE DESIGNATION AND SERIAL NO. SF 079401		
b. TYPE OF WELL OIL WELL <input type="checkbox"/> GAS WELL <input checked="" type="checkbox"/> OTHER <input type="checkbox"/>		6. IF INDIAN, ALLOTTEE OR TRIBE NAME		
2. NAME OF OPERATOR Northwest Pipeline Corporation		7. UNIT AGREEMENT NAME San Juan 31-6 Unit		
3. ADDRESS OF OPERATOR P.O. Box 90, Farmington, N.M. 87499		8. FARM OR LEASE NAME San Juan 31-6 Unit		
4. LOCATION OF WELL (Report location clearly and in accordance with any State regulations) At surface 970 FNL & 950 FWL Sec 1, T30N, R6W At proposed prod. zone 970 FNL & 950 FWL		9. WELL NO. #40		
14. DISTANCE IN MILES AND DIRECTION FROM NEAREST TOWN OR POST OFFICE* 15 miles east of Navajo Dam Post Office		10. FIELD AND POOL, OR WILDCAT Basin Dakota		
15. DISTANCE FROM PROPOSED* LOCATION TO NEAREST PROPERTY OR LEASE LINE, FT. (Also to nearest drlg. unit line, if any) 950'		11. SEC. T., R., M., OR BLK. AND SURVEY OR AREA Sec 1, T30N, R6W		
16. NO. OF ACRES IN LEASE 159.69		12. COUNTY OR PARISH Rio Arriba		
17. NO. OF ACRES ASSIGNED TO THIS WELL N/ 320		13. STATE N.M.		
18. DISTANCE FROM PROPOSED LOCATION* TO NEAREST WELL, DRILLING COMPLETED, OR APPLIED FOR, ON THIS LEASE, FT. 2200'		20. ROTARY OR CABLE TOOLS Rotary		
21. ELEVATIONS (Show whether DF, RT, GR, etc.) 6421' GR		22. APPROX. DATE WORK WILL START* October 1, 1983		
23. PROPOSED CASING AND CEMENTING PROGRAM		This action is subject to administrative appeal pursuant to 30 CFR 290.		
SIZE OF HOLE	SIZE OF CASING	WEIGHT PER FOOT	SETTING DEPTH	QUANTITY OF CEMENT
12-1/4"	9-5/8"	36#	350'	185 cu. ft
8-3/4"	7"	20#	3770'	300 cu. ft
6-1/4"	4-1/2"	10.5# 11.6#	7970'	665 cu. ft

Selectively perforate and stimulate the Dakota Formation.  
Completion plans will be determined at Total Depth.

A BOP will be installed after the surface casing is set and cemented. All subsequent work will be conducted through the BOP's.

The North Half of Section 1 is dedicated to this well.

Gas is dedicated.

RESUBMITTED APD

RECEIVED  
AUG 31 1983  
OIL CON. DIV.  
DIST. 3

IN ABOVE SPACE DESCRIBE PROPOSED PROGRAM: If proposal is to deepen or plug back, give data on present productive zone and proposed new productive zone. If proposal is to drill or deepen directionally, give pertinent data on subsurface locations and measured and true vertical depths. Give blowout preventer program, if any.

24. SIGNED Paul C. Thompson TITLE Sr. Drilling Engineer DATE 8-3-83  
(This space for Federal or State office use)

PERMIT NO. \_\_\_\_\_ APPROVAL DATE \_\_\_\_\_

APPROVED BY \_\_\_\_\_ TITLE \_\_\_\_\_  
CONDITIONS OF APPROVAL, IF ANY:

PCT:djb

\*See Instructions On Reverse Side

APPROVED  
AS AMENDED  
DATE  
AUG 29 1983  
AREA MANAGER  
FARMINGTON RESOURCE AREA

All distances must be from the outer boundaries of the Section.

Operator <b>NORTHWEST PIPELINE CORPORATION</b>			Lease <b>SAN JUAN 31-6 UNIT</b>		Well No. <b>40</b>
Unit Letter <b>D</b>	Section <b>1</b>	Township <b>30N</b>	Range <b>6W</b>	County <b>Rio Arriba</b>	
Actual Footage Location of Well: <b>970</b> feet from the <b>North</b> line and <b>950</b> feet from the <b>West</b> line					
Ground Level Elev. <b>6421</b>	Producing Formation <b>Dakota</b>		Pool <b>Basin Dakota</b>		Dedicated Acreage: <b>320</b> Acres

1. Outline the acreage dedicated to the subject well by colored pencil or hatchure marks on the plat below.
2. If more than one lease is dedicated to the well, outline each and identify the ownership thereof (both as to working interest and royalty).
3. If more than one lease of different ownership is dedicated to the well, have the interests of all owners been consolidated by communitization, unitization, force-pooling, etc?

☒ Yes ☐ No If answer is "yes," type of consolidation Unitization

If answer is "no," list the owners and tract descriptions which have actually been consolidated. (Use reverse side of this form if necessary.)

No allowable will be assigned to the well until all interests have been consolidated (by communitization, unitization, forced-pooling, or otherwise) or until a non-standard unit, eliminating such interests, has been approved by the Commission.

970'

950'

Sec.

1

RECEIVED

AUG 2 1983

U. S. GEOLOGICAL SURVEY

FARMINGTON, N. M.

RECEIVED

AUG 3 1983

OIL CON. DIV.

DIST. 3

RECEIVED

APR 10 1981

U. S. GEOLOGICAL SURVEY

FARMINGTON, N. M.

Scale: 1"=1000'

## CERTIFICATION

I hereby certify that the information contained herein is true and complete to the best of my knowledge and belief.

*Paul C. Thompson*

Name

Paul C. Thompson

Position

Drilling Engineer

Company

Northwest Pipeline Corp

Date

2-19-81

I hereby certify that the well location shown on this plat was plotted from field notes of actual surveys made by me or under my supervision, and that the same is true and correct to the best of my knowledge and belief.

Date Surveyed

February 19, 1981

Registered Professional Engineer and Land Surveyor

*Fred B. Kerker*  
Fred B. Kerker

Certificate No.

3959

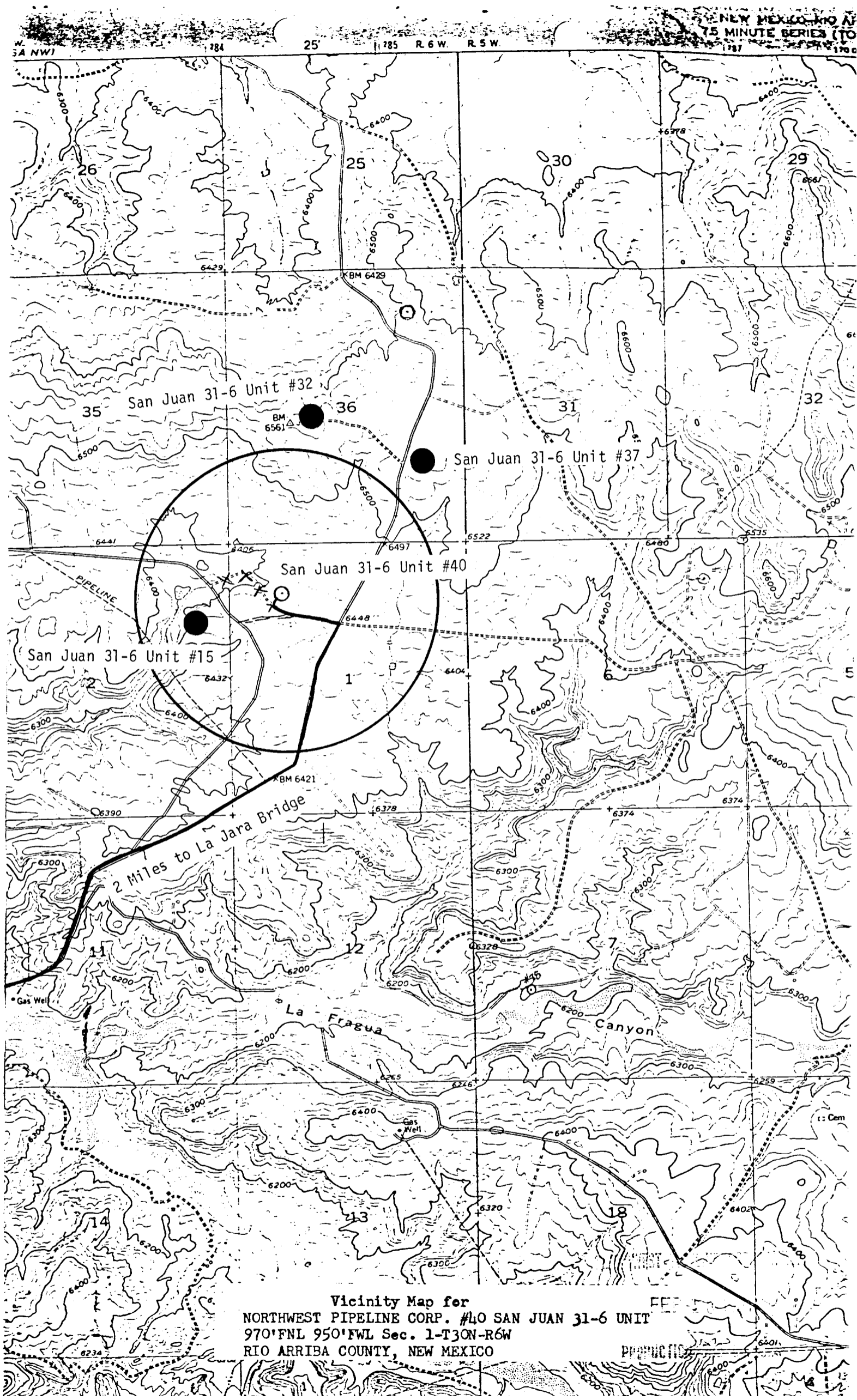

Vicinity Map for  
NORTHWEST PIPELINE CORP. #40 SAN JUAN 31-6 UNIT  
970'FNL 950'FWL Sec. 1-T30N-R6W  
RIO ARRIBA COUNTY, NEW MEXICO

PRODUCTS

F

30-039-22747

5-4-81

F. Loc 970/N;950/W Elev. 6421 GL Spd. \_\_\_\_\_ Comp. \_\_\_\_\_ TD \_\_\_\_\_ PB \_\_\_\_\_Casing S. \_\_\_\_\_ @ \_\_\_\_\_ W \_\_\_\_\_ Sx. Int. \_\_\_\_\_ @ \_\_\_\_\_ W \_\_\_\_\_ Sx. Pr. \_\_\_\_\_ @ \_\_\_\_\_ W \_\_\_\_\_ Sx. T. \_\_\_\_\_ @ \_\_\_\_\_  
Csg. Perf. \_\_\_\_\_ Prod. Stim. \_\_\_\_\_T  
R  
A  
N  
S

I.P. \_\_\_\_\_ BO/D \_\_\_\_\_ MCF/D After \_\_\_\_\_ Hrs. SICP \_\_\_\_\_ PSI After \_\_\_\_\_ Days GOR \_\_\_\_\_ Grav. \_\_\_\_\_ 1st Del. \_\_\_\_\_ s

TOPS		NiTD <input checked="" type="checkbox"/>	Well Log	TEST DATA						
Kirtland		C-103	Plat <input checked="" type="checkbox"/>	Schd.	PC	Q	PW	PD	D	Ref.No.
Fruitland		C-104	Electric Log							
Pictured Cliffs			C-122							
Cliff House		Ditr	Dfa							
Menefee		Datr	Dac							
Point Lookout		W/319.69								
Mancos										
Gallup										
Sanostee										
Greenhorn										
Dakota										
Morrison										
Entrada										

P

O

O

Basin Dak. Co. RA S 1 T 30N R 6W U D Oper. Northwest Pipeline Corp. San Juan 31-6 Unit No. 40

San Juan 31-6 Unit #40

D-1-30N-6W

Northwest Pipeline Corp.