

All distances must be from the outer boundaries of the Section.

Operator CINCO LIMITED			Lease STATE PAT		Well No. 1
Unit Letter D	Section 32	Township 30 North	Range 7 West	County Rio Arriba	
Actual Footage Location of Well: (cardinal) 960 feet from the North line and 1100 feet from the West line					
Ground Level Elev. 6187	Producing Formation Mesa Verde	Pool Blanco		Dedicated Acreage: 160* Acres	

1. Outline the acreage dedicated to the subject well, by colored pencil or hatchure marks on the plat below.
2. If more than one lease is dedicated to the well, outline each and identify the ownership thereof (both as to working interest and royalty). **NA**
3. If more than one lease of different ownership is dedicated to the well, have the interests of all owners been consolidated by communitization, unitization, force-pooling, etc?

☐ Yes ☐ No If answer is "yes," type of consolidation **NA**

If answer is "no," list the owners and tract descriptions which have actually been consolidated. (Use reverse side of this form if necessary.)

No allowable will be assigned to the well until all interests have been consolidated (by communitization, unitization, forced-pooling, or otherwise) or until a non-standard unit, eliminating such interests, has been approved by the Division.

* Record GLO plat 1915

* NSPU applied for - NMOCD case 8971

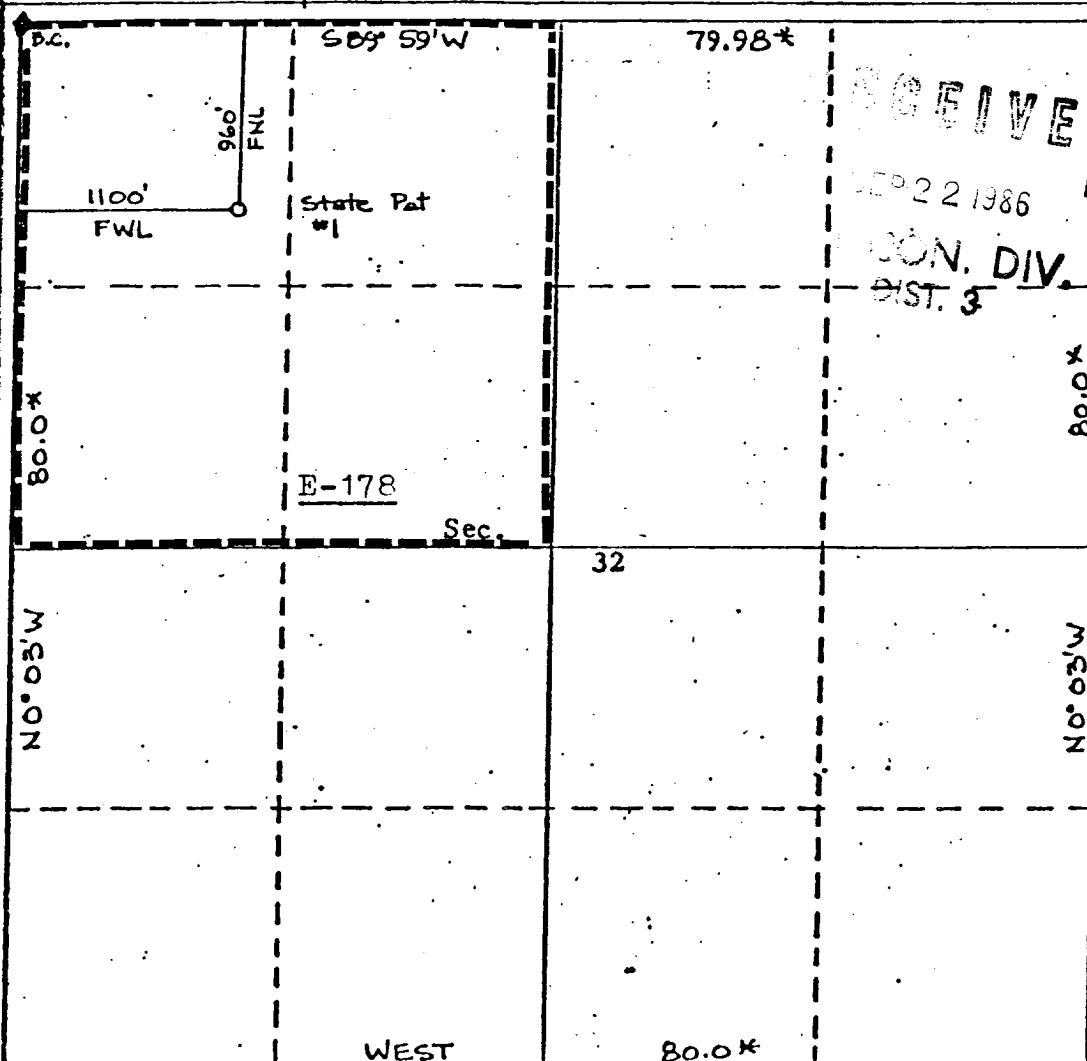

CERTIFICATION

I hereby certify that the information contained herein is true and complete to the best of my knowledge and belief.

Frank D. Gorham, Jr.
Name **Frank D. Gorham, Jr.**
General Partner

Position
Cinco Ltd.

Company

Date **9/12/86**

I hereby certify that the well location shown on this plat was plotted from field notes of actual surveys made by me or under my supervision, and that the same is true and correct to the best of my knowledge and belief.

Date Surveyed
Sept 3, 1986
Registered Professional Engineer and/or Land Surveyor

Certificate No. **8894**