

CONSERVATION DIVISION

P. O. BOX 2088

SANTA FE, NEW MEXICO 87501

STATE OF NEW MEXICO

ENERGY AND MINERALS DEPARTMENT

Form C-102
Revised 10-1-79

All distances must be from the outer boundaries of the Section.

Operator ROBERT L. BAYLESS		Lease JICARILLA 457		Well No. 1
Unit Letter L	Section 9	Township 30 North	Range 3 West	County Rio Arriba
Actual Postage Location of Well: (cardinal) 1450 feet from the South line and 1190 feet from the West line				
Ground Level Elev. 7154	Producing Formation Pictured Cliffs	Pool East Blanco Pictured Cliffs	Dedicated Acreage: 160 Acres	

- Outline the acreage dedicated to the subject well by colored pencil or hatchure marks on the plat below.
- If more than one lease is dedicated to the well, outline each and identify the ownership thereof (both as to working interest and royalty).
- If more than one lease of different ownership is dedicated to the well, have the interests of all owners been consolidated by communitization, unitization, force-pooling, etc?

☐ Yes ☐ No If answer is "yes," type of consolidation _____

If answer is "no," list the owners and tract descriptions which have actually been consolidated. (Use reverse side of this form if necessary.) _____

No allowable will be assigned to the well until all interests have been consolidated (by communitization, unitization, forced-pooling, or otherwise) or until a non-standard unit, eliminating such interests, has been approved by the Division.

Record GLO plat 1922

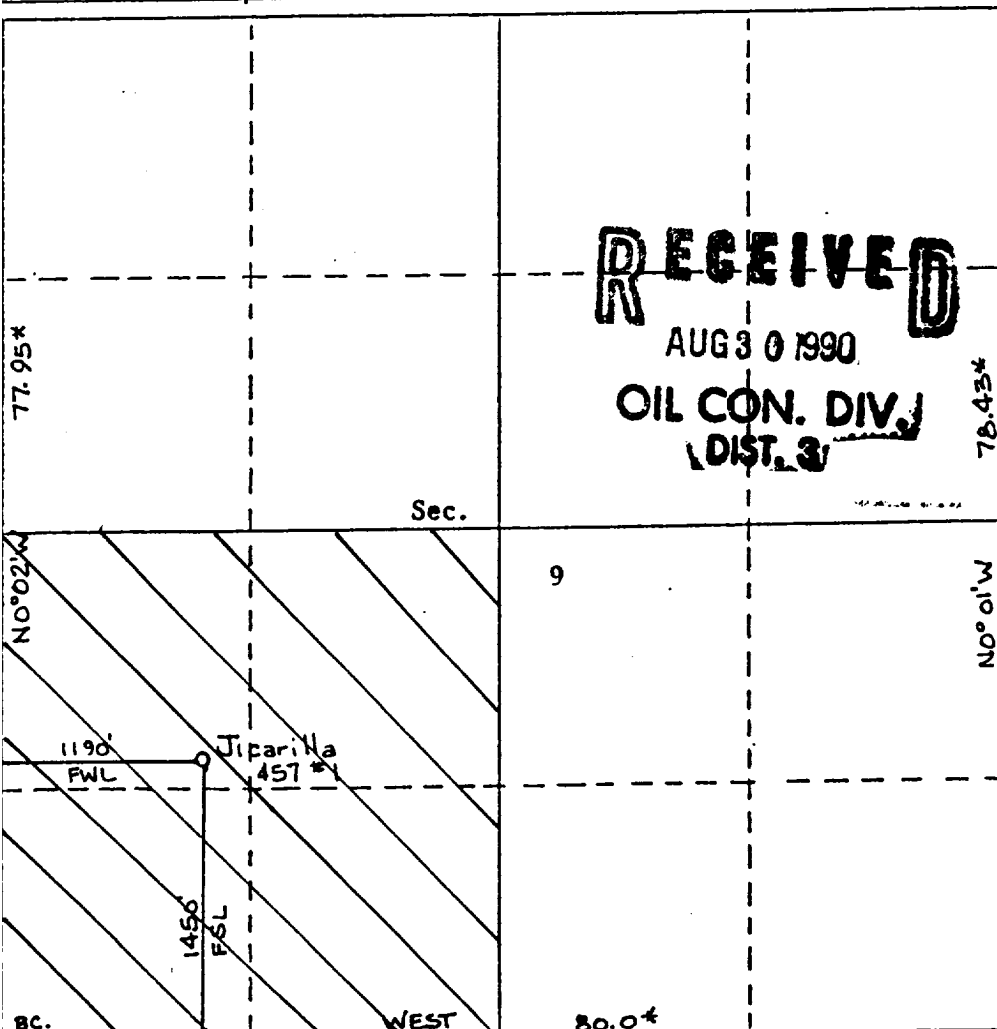

CERTIFICATION

I hereby certify that the information contained herein is true and complete to the best of my knowledge and belief.

Kevin H. McCord

Name

Kevin H. McCord

Position

Petroleum Engineer

Company

Robert L. Bayless, Producer

Date

August 29, 1990

I hereby certify that the well location shown on this plat was plotted from field notes of actual surveys made by me or under my supervision, and that the same is true and correct to the best of my knowledge and belief.

Date Surveyed

Sept. 18, 1988

Registered Professional Engineer

and/or Licensed Surveyor

Certificate No.

9894