

UNITED STATES
DEPARTMENT OF THE INTERIOR
BUREAU OF LAND MANAGEMENT
OIL CON. DIV.

APPLICATION FOR PERMIT TO DRILL, DEEPEN, OR PLUG BACK

1a. TYPE OF WORK
DRILL ☒ DEEPEN ☐ PLUG BACK ☐
b. TYPE OF WELL
OIL WELL ☐ GAS WELL ☒ OTHER ☐ SINGLE ZONE ☐ MULTIPLE ZONE ☒
2. NAME OF OPERATOR
Robert L. Bayless
3. ADDRESS OF OPERATOR
P.O. Box 168, Farmington, NM 87499
4. LOCATION OF WELL (Report location clearly and in accordance with any State requirements.)
At surface 1850' FNL & 790' FWL
At proposed prod. zone same
14. DISTANCE IN MILES AND DIRECTION FROM NEAREST TOWN OR POST
BUREAU OF LAND MANAGEMENT
FARMINGTON RESOURCE AREA

5. LEASE DESIGNATION AND SERIAL NO.
Jicarilla Contract 463
6. IF INDIAN, ALLOTTEE OR TRIBE NAME
Jicarilla Apache Tribe
7. UNIT AGREEMENT NAME
8. FARM OR LEASE NAME
Jicarilla 463
9. WELL NO.
#1
10. FIELD AND POOL, OR WILDCAT
Wildcat- Frt/PC
11. SEC. T. R. M. OR BLE. AND SURVEY OR AREA
E-25, Sec. 25
T30N, R3W, Sec. 25
12. COUNTY OR PARISH
Rio Arriba
13. STATE
NM

15. DISTANCE FROM PROPOSED LOCATION TO NEAREST PROPERTY OR LEASE LINE, FT. (Also to nearest drig. unit line, if any)
16. NO. OF ACRES IN LEASE
1920'
17. NO. OF ACRES ASSIGNED TO THIS WELL
160
18. DISTANCE FROM PROPOSED LOCATION TO NEAREST WELL, DRILLING, COMPLETED, OR APPLIED FOR, ON THIS LEASE, FT.
19. PROPOSED DEPTH
4195'
20. ROTARY OR CABLE TOOLS
0 - T.D.
21. ELEVATIONS (Show whether DF, RT, GR, etc.)
7195' GL 7208' RKB
22. APPROX. DATE WORK WILL START*

23. PROPOSED CASING AND CEMENTING PROGRAM

SIZE OF HOLE	SIZE OF CASING	WEIGHT PER FOOT	SETTING DEPTH	QUANTITY OF CEMENT
9"	7"	23#/ft	125	30 ft ³ Class B
6½"	4½"	11.6#/ft	4195'	206 ft ³ Class B w/2% econofil
				89 ft ³ 50-50 pozmix

Will drill 9" hole to 125' and set 125 feet 23#/ft J-55 casing cementing with 30 ft³ Class B cement, circulated to surface. Will drill 6½" hole to 4195' and run 4195' 4½" 11.6#/ft J-55 casing and cement with 206 ft³ Class B with 2% econofil tailed by 89 ft³ 50-50 pozmix with 2% gel and 10% salt. Circulating medium will be clear water, natural mud and water loss control additives. No abnormal pressures or temperatures are anticipated. Will run Induction and Density Logs. Blowout preventer schematic is attached. The gas from this formation is not dedicated to a gas contract.

ESTIMATED TOPS: Ojo Alamo - 3280'
Kirtland - 3520'
Fruitland - 3765'
Pictured Cliffs - 3878'
T.D. - 4195'

File lamp survey +/or bond log to determine cement top.

IN ABOVE SPACE DESCRIBE PROPOSED PROGRAM: If proposal is to deepen or plug back, give data on present productive zone and proposed new productive zone. If proposal is to drill or deepen directionally, give pertinent data on subsurface locations and measured and true vertical depths. Give blowout preventer program, if any.

24. SIGNED Kim H. McGoul TITLE Petroleum Engineer DATE Dec. 8, 1986
(This space for Federal or State office use)
PERMIT NO. _____ APPROVAL DATE _____
APPROVED BY _____ TITLE _____ DATE DEC 23 1986
CONDITIONS OF APPROVAL, IF ANY: _____

APPROVED
AS AMENDED

NMOC

Robert Moore
AREA MANAGER

OIL CONSERVATION DIVISION

STATE OF NEW MEXICO
ENERGY AND MINERALS DEPARTMENTP. O. BOX 2088
SANTA FE, NEW MEXICO 87501Form C-102
Revised 10-1-79

All distances must be from the outer boundaries of the Section.

Operator ROBERT L. BAYLESS		Lease JICARILLA 463		Well No. 1
Unit Letter E	Section 25	Township 30 North	Range 3 West	County Rio Arriba
Actual Footage Location of Well: (cardinal) 1850 feet from the North line and 790 feet from the West line				
Ground Level Elev. 7195	Producing Formation Fruitland/Pictured Cliffs	Pool Wildcat	Dedicated Acreage: 160 Acres	

1. Outline the acreage dedicated to the subject well by colored pencil or hatchure marks on the plat below.
2. If more than one lease is dedicated to the well, outline each and identify the ownership thereof (both as to working interest and royalty).
3. If more than one lease of different ownership is dedicated to the well, have the interests of all owners been consolidated by communitization, unitization, force-pooling, etc?

☐ Yes ☐ No If answer is "yes," type of consolidation _____

If answer is "no," list the owners and tract descriptions which have actually been consolidated. (Use reverse side of this form if necessary.) _____

No allowable will be assigned to the well until all interests have been consolidated (by communitization, unitization, forced-pooling, or otherwise) or until a non-standard unit, eliminating such interests, has been approved by the Division.

* Record GLO plat 1895

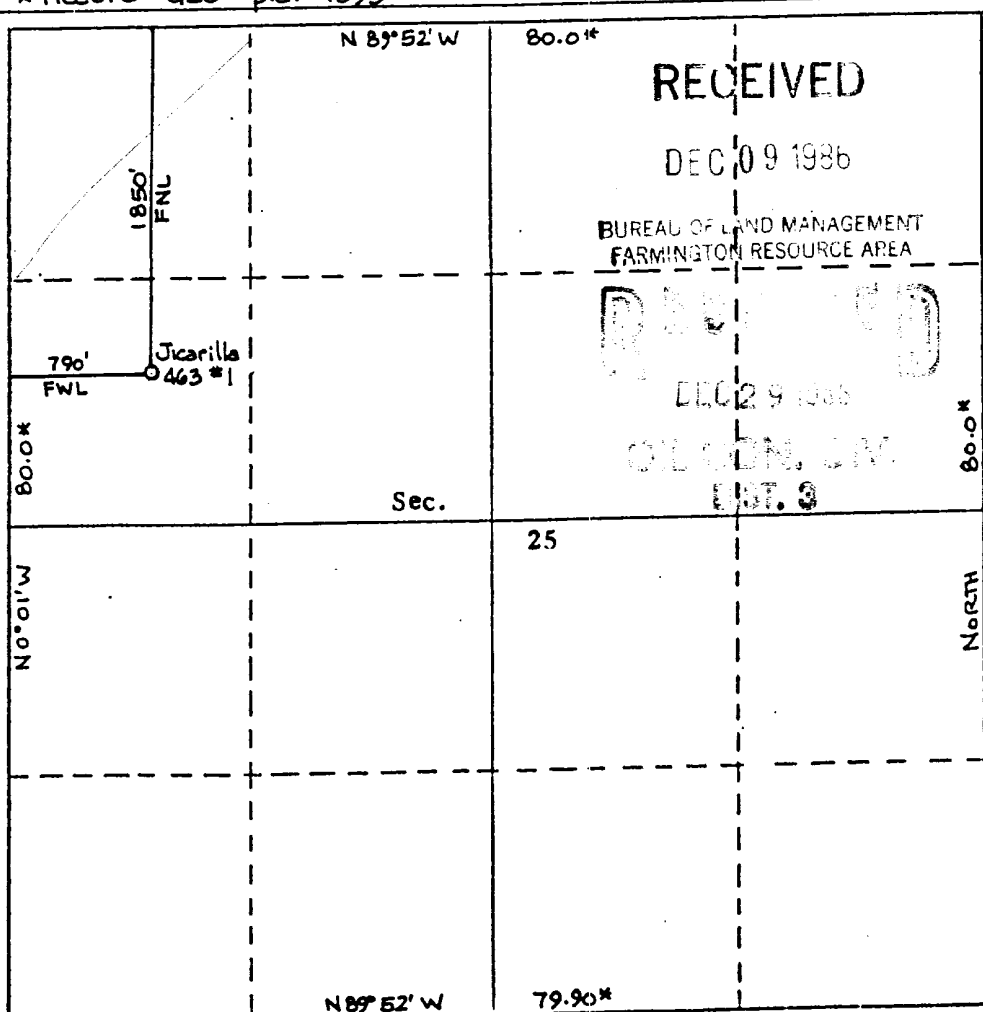

CERTIFICATION

I hereby certify that the information contained herein is true and complete to the best of my knowledge and belief.

Kevin H. McCord

Name

Kevin H. McCord

Position

Petroleum Engineer

Company

Robert L. Bayless, Producer

Date

December 8, 1986

I hereby certify that the well location shown on this plat was plotted from field notes of actual surveys made by me or under my supervision, and that the same is true and correct to the best of my knowledge and belief.

Date Surveyed

Sept. 5, 1986

Registered Professional Engineer
and/or Licensed Surveyor

Certificate No.

8894

