



STATE OF NEW MEXICO

ENERGY, MINERALS AND NATURAL RESOURCES DEPARTMENT

OIL CONSERVATION DIVISION

ok  
69

GARREY CARRUTHERS  
GOVERNOR

POST OFFICE BOX 2000  
STATE LAND OFFICE BUILDING  
SANTA FE, NEW MEXICO 87504  
(505) 827-5800

August 20, 1987

Robert L. Bayless  
P.O. Box 168  
Farmington, NM 87499

Attention: Kevin H. McCord  
Petroleum Engineer

Amended Administrative Order NSL-2377

Gentlemen:

Reference is made to your application for a non-standard location for your Jicarilla 458 Well No. 3 to be located 1815 feet from the North line and 230 feet from the East line of Section 7, Township 30 North, Range 3 West, NMPM Undesignated Pictured Cliffs Pool, Rio Arriba County, New Mexico. The NE/4 of said Section 7 shall be dedicated to the well.

By authority granted me under the provisions of Rule 104 F(I), the above-described unorthodox location is hereby approved.

Sincerely,

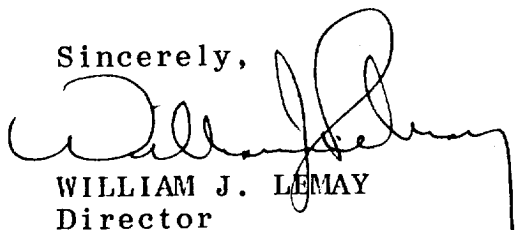

WILLIAM J. LEMAY  
Director

cc: Oil Conservation Division - Aztec

RECEIVED  
AUG 26 1987  
OIL CON. DIV.  
DIST. 3

ENERGY AND MINERALS DEPARTMENT

OIL CONSERVATION DIVISION



GARREY CARRUTHERS  
GOVERNOR

POST OFFICE BOX 2088  
STATE LAND OFFICE BUILDING  
SANTA FE, NEW MEXICO 87501  
(505) 827-5800

August 12, 1987

Robert L. Bayless  
P.O. Box 168  
Farmington, NM 87499

Attention: Kevin H. McCord  
Petroleum Engineer

Administrative Order NSL-2377

Gentlemen:

Reference is made to your application for a non-standard location for your Jicarilla 458 Well No. 3 to be located 1815 feet from the North line and 230 feet from the East line of Section 7, Township 30 North, Range 3 West, NMPM Undesignated Pictured Cliffs Pool, Rio Arriba County, New Mexico. The NE/4 of said Section 7 shall be dedicated to the well.

By authority granted me under the provisions of Rule 104 F(I), the above-described unorthodox location is hereby approved.

Sincerely,

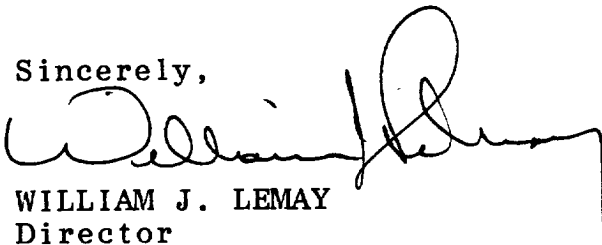
  
WILLIAM J. LEMAY  
Director

cc: Oil Conservation Division - Aztec

*Should be  
amended order  
coming  
E/O*

**RECEIVED**  
AUG 14 1987  
OIL CON. DIV  
DIST. 3



STATE OF NEW MEXICO  
ENERGY AND MINERALS DEPARTMENT  
OIL CONSERVATION DIVISION  
AZTEC DISTRICT OFFICE

1000 RIO BRAZOS ROAD  
AZTEC, NEW MEXICO 87410  
(505) 334-6178

OIL CONSERVATION DIVISION  
BOX 2088  
SANTA FE, NEW MEXICO 87501

DATE 8-7-87

RE: Proposed MC \_\_\_\_\_  
Proposed DHC \_\_\_\_\_  
Proposed NSL X \_\_\_\_\_  
Proposed SWD \_\_\_\_\_  
Proposed WFX \_\_\_\_\_  
Proposed PMX \_\_\_\_\_

Gentlemen:

I have examined the application dated 8-6-87  
for the Robert L. Bayless Tic. 458 #3 H-7-30N-3W  
Operator Lease and Well No. Unit, S-T-R

and my recommendations are as follows:

Approve  
\_\_\_\_\_  
\_\_\_\_\_  
\_\_\_\_\_  
\_\_\_\_\_

Yours truly,

E. B. B.

ROBERT L. BAYLESS

PETROLEUM PLAZA BUILDING  
P. O. BOX 168  
FARMINGTON, NEW MEXICO 87499  
(505) 326-2659

July 29, 1987

Mr. William J. LeMay  
New Mexico Oil Conservation Division  
P.O. Box 2088  
Santa Fe, NM 87501

RE: Request for Administrative  
Approval of an Unorthodox  
Location  
Jicarilla 458 #3  
1815'FNL & 230'FEL  
Section 7-T30N-R2W 3W  
Rio Arriba County, New Mexico

Gentlemen:

We request administrative approval of an unorthodox location for our Jicarilla 458 #3 Pictured Cliffs formation gas well, located 1815'FNL and 230'FEL, Section 7-T30N-R3W, Rio Arriba County, New Mexico. This well staking is 560 feet too close to the section line separating Section 7 and Section 8. You will note from the enclosed topographic map that there is no other area for an economically buildable location in this quarter section due to the rough topography. Also enclosed is a lease map indicating that Robert L. Bayless is the operator of all surrounding 160 acre tracts to this well.

If you need any further information on this well, please advise.

Yours truly,

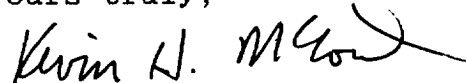

Kevin H. McCord  
Petroleum Engineer

KHM/blk  
Enclosures  
cc: NMOCD, Aztec

**RECEIVED**  
JUL 31 1987  
OIL CON. DIV.  
DIST. 3

**NEW MEXICO OIL CONSERVATION COMMISSION  
WELL LOCATION AND ACREAGE DEDICATION PLAT**

Form C-102  
Supersedes C-128  
Effective 1-1-65

All distances must be from the outer boundaries of the Section.

Operator <b>ROBERT L. BAYLESS</b>			Lease <b>JICARILLA 458</b>		Well No. <b>3</b>
Unit Letter <b>H</b>	Section <b>7</b>	Township <b>30 N</b>	Range <b>3 W</b>	County <b>Rio Arriba</b>	
Actual Footage Location of Well: <b>1815</b> feet from the <b>North</b> line and <b>230</b> feet from the <b>East</b> line					
Ground Level Elev. <b>7089</b>	Producing Formation <b>Pictured Cliffs</b>		Pool <b>Wildcat</b>		Dedicated Acreage <b>160</b> Acres

1. Outline the acreage dedicated to the subject well by colored pencil or hatchure marks on the plat below.
2. If more than one lease is dedicated to the well, outline each and identify the ownership thereof (both as to working interest and royalty).
3. If more than one lease of different ownership is dedicated to the well, have the interests of all owners been consolidated by communitization, unitization, force-pooling, etc?

☐ Yes ☐ No If answer is "yes," type of consolidation \_\_\_\_\_

If answer is "no," list the owners and tract descriptions which have actually been consolidated. (Use reverse side of this form if necessary.) \_\_\_\_\_

No allowable will be assigned to the well until all interests have been consolidated (by communitization, unitization, forced-pooling, or otherwise) or until a non-standard unit, eliminating such interests, has been approved by the Commission.

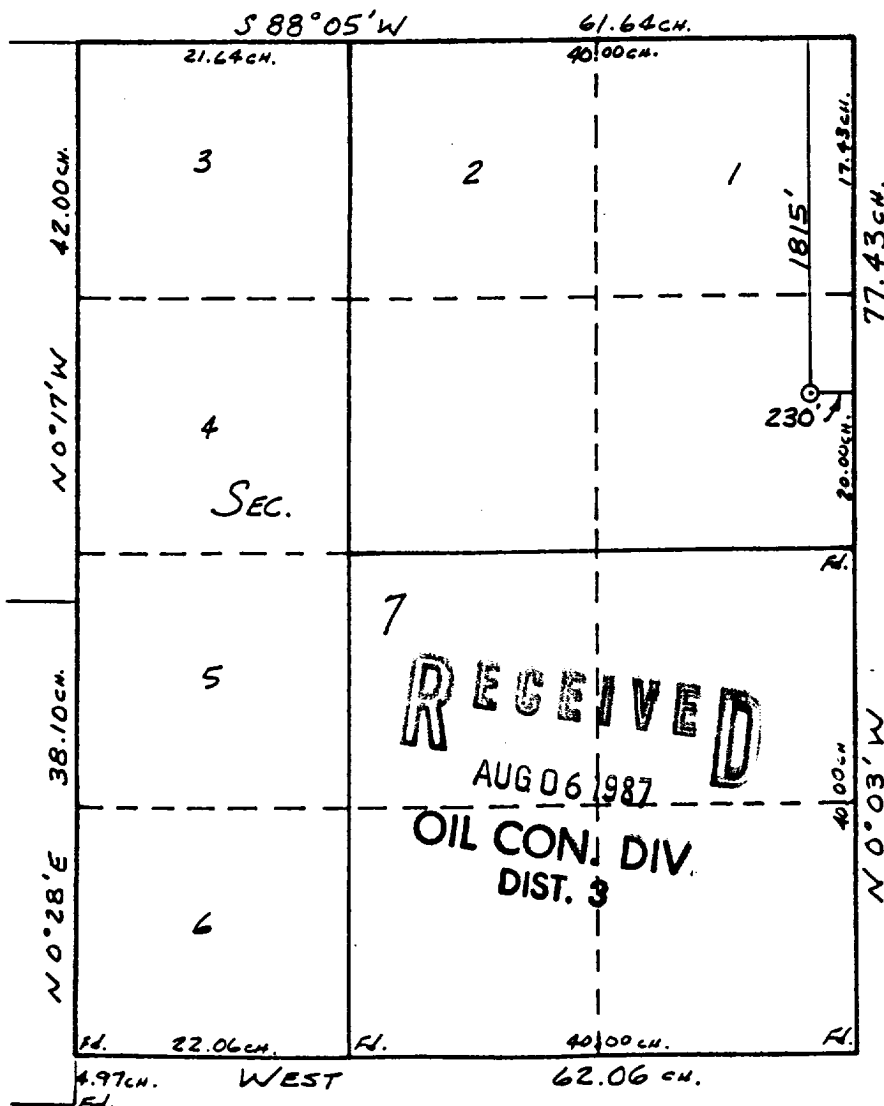

**CERTIFICATION**

I hereby certify that the information contained herein is true and complete to the best of my knowledge and belief.

*Kevin H. McCord*

Name  
Kevin H. McCord  
Position  
Petroleum Engineer  
Company  
Robert L. Bayless, Producer  
Date  
July 29, 1987

I hereby certify that the well location shown on this plat was plotted from field notes of actual surveys made by me or under my supervision, and that the same is true and correct to the best of my knowledge and belief.

Date Surveyed  
Willam E. Mahoney  
Registered Professional Engineer and Land Surveyor  
Certificate No. 9466



ROBERT L. BAYLESS  
#3 JICARILLA 458  
1815'FNL & 230'FEL  
Sec.7, T30N, R3W  
Rio Arriba Co., N.M.

T30N R4W

T30N R3W

6

ROBERT L. BAYLESS  
JIC CONT # 458

JIC 458 #3  
O

7

8

APACHE INDIAN RESERVATION BOUNDARY

A  
58

9

25  
Kpc & D.A. 58