

All distances must be from the outer boundaries of the Section.

Operator <i>El Paso Natural Gas Co.</i>		Lease San Juan 30-6 unit		Well No. 452
Unit Letter N	Section 8	Township T30N	Range R6W	County Rio Arriba County
Actual Footage Location of Well 1190 feet from the South line and 1820 feet from the West line				
Ground Level Elev. 6275	Producing Formation Fruitland Coal	Pool Basin	Dedicated Acreage 320 Acres	

- Outline the acreage dedicated to the subject well by colored pencil or hatchure marks on the plat below.
- If more than one lease is dedicated to the well, outline each and identify the ownership thereof (both as to working interest and royalty).
- If more than one lease of different ownership is dedicated to the well, have the interests of all owners been consolidated by communitization, unitization, force-pooling, etc?
☐ Yes ☐ No If answer is "yes," type of consolidation _____

If answer is "no," list the owners and tract descriptions which have actually been consolidated. (Use reverse side of this form if necessary.) _____

No allowable will be assigned to the well until all interests have been consolidated (by communitization, unitization, forced-pooling, or otherwise) or until a non-standard unit, eliminating such interests, has been approved by the Division.

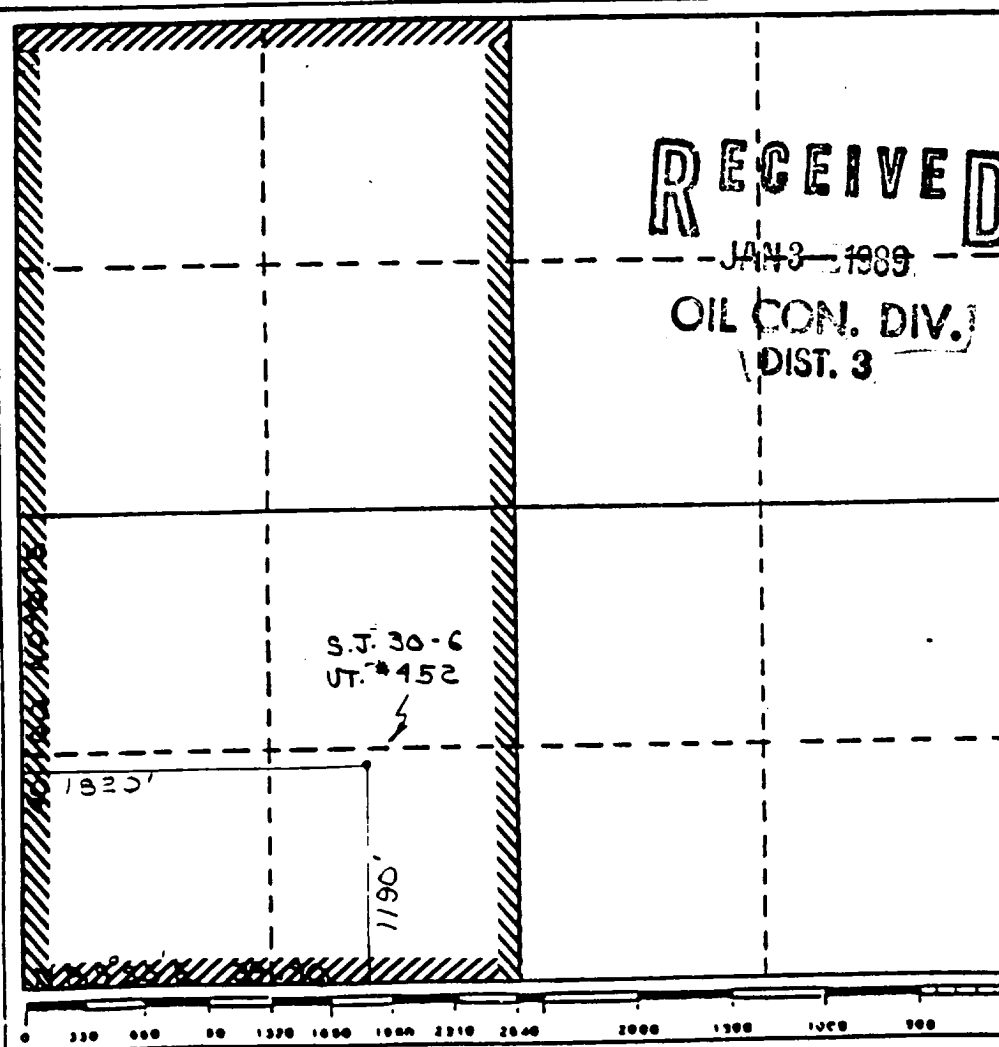

CERTIFICATION	
I hereby certify that the information contained herein is true and complete to the best of my knowledge and belief.	
Name <i>R. Howard Daggett</i>	Regulatory Affairs
Position El Paso Natural Gas Co.	Company
Date 12-22-88	
<p>I hereby certify that the well location shown on this plat is correct for field notes. (Actual surveys made by me or under my supervision, and that the same is true and correct to the best of my knowledge and belief.)</p> <p>HOWARD DAGGETT REGISTERED LAND SURVEYOR 9679</p>	
Date Surveyed June 15, 1988	Registered Land Surveyor R. Howard Daggett
Certificate No. 9679	