

NO. OF COPIES RECEIVED	
DISTRIBUTION	
SANTA FE	
FILE	
U.S.G.S.	
LAND OFFICE	
OPERATOR	

NEW MEXICO OIL CONSERVATION COMMISSION

Form C-101
Revised 1-4-65

5A. Indicate Type of Lease
STATE FEE

5. State Oil & Gas Lease No.
E-347-20

APPLICATION FOR PERMIT TO DRILL, DEEPEN, OR PLUG BACK

1a. Type of Work
 DRILL DEEPEN PLUG BACK

b. Type of Well
 OIL WELL GAS WELL OTHER SINGLE ZONE MULTIPLE ZONE

2. Name of Operator
Meridian Oil Inc.

3. Address of Operator
PO Box 4289, Farmington, NM 87499

4. Location of Well
 UNIT LETTER G LOCATED 2200 FEET FROM THE North LINE
 AND 1360 FEET FROM THE East LINE OF SEC. 36 TWP. 30N RGE. 6W NMPM

7. Unit Agreement Name
San Juan 30-6 Unit

8. Farm or Lease Name
San Juan 30-6 Unit

9. Well No.
443

10. Field and Pool, or Wildcat
Undes. Fruitland Coal

12. County
Rio Arriba

19. Proposed Depth
3741'

19A. Formation
Fruitland

20. Rotary or C.T.
Rotary

21. Elevations (Show whether DF, RT, etc.)
6807' GL

21A. Kind & Status Plug. Bond
statewide

21B. Drilling Contractor

22. Approx. Date Work will start

23. PROPOSED CASING AND CEMENT PROGRAM

SIZE OF HOLE	SIZE OF CASING	WEIGHT PER FOOT	SETTING DEPTH	SACKS OF CEMENT	EST. TOP
12 1/4"	9 5/8"	32.3#	200'	130 cu. ft.	circ. surface
8 3/4"	7"	20.0#	3523'	214 cu. ft.	cover Ojo Alamo
6 1/4"	5 1/2"	23.0#	3741'	do not cement	

The Fruitland Coal formation will be completed.

A 3000 psi WP and 6000 psi test double gate preventer equipped with blind and pipe rams will be used for blow out prevention on this well.

This gas is dedicated.

The NE/4 of Section 36 is dedicated to this well.

IN ABOVE SPACE DESCRIBE PROPOSED PROGRAM: IF PROPOSAL IS TO DEEPEN OR PLUG BACK, GIVE DATA ON PRESENT PRODUCTIVE ZONE AND PROPOSED NEW PRODUCTIVE ZONE. GIVE BLOWOUT PREVENTER PROGRAM, IF ANY.

I hereby certify that the information above is true and complete to the best of my knowledge and belief.

Signed [Signature] Title Regulatory Affairs Date 10-06-88

(This space for State Use)

APPROVED BY [Signature] TITLE DEPUTY OIL & GAS INSPECTOR, DIST. #3 DATE OCT 06 1988

CONDITIONS OF APPROVAL, IF ANY:

HOLD C-104 FOR NSL & NSP APPROVAL

OCT 06 1988

All distances must be from the outer boundaries of the Section.

Operator Meridian Oil Inc.		Lease San Juan 30-6 Unit		Well No. 443
Unit Letter G	Section 36	Township 30 North	Range 6 West	County Rio Arriba
Actual Footage Location of Well: 2200 feet from the North line and 1360 feet from the East line				
Ground Level Elev. 6807	Producing Formation Fruitland Coal	Pool Undesignated		Dedicated Acreage: 115.04 Acres

- Outline the acreage dedicated to the subject well by colored pencil or hachure marks on the plat below.
- If more than one lease is dedicated to the well, outline each and identify the ownership thereof (both as to working interest and royalty).
- If more than one lease of different ownership is dedicated to the well, have the interests of all owners been consolidated by communitization, unitization, force-pooling, etc?

Yes No If answer is "yes," type of consolidation unitization

If answer is "no," list the owners and tract descriptions which have actually been consolidated. (Use reverse side of this form if necessary.) _____

No allowable will be assigned to the well until all interests have been consolidated (by communitization, unitization, forced-pooling, or otherwise) or until a non-standard unit, eliminating such interests, has been approved by the Division

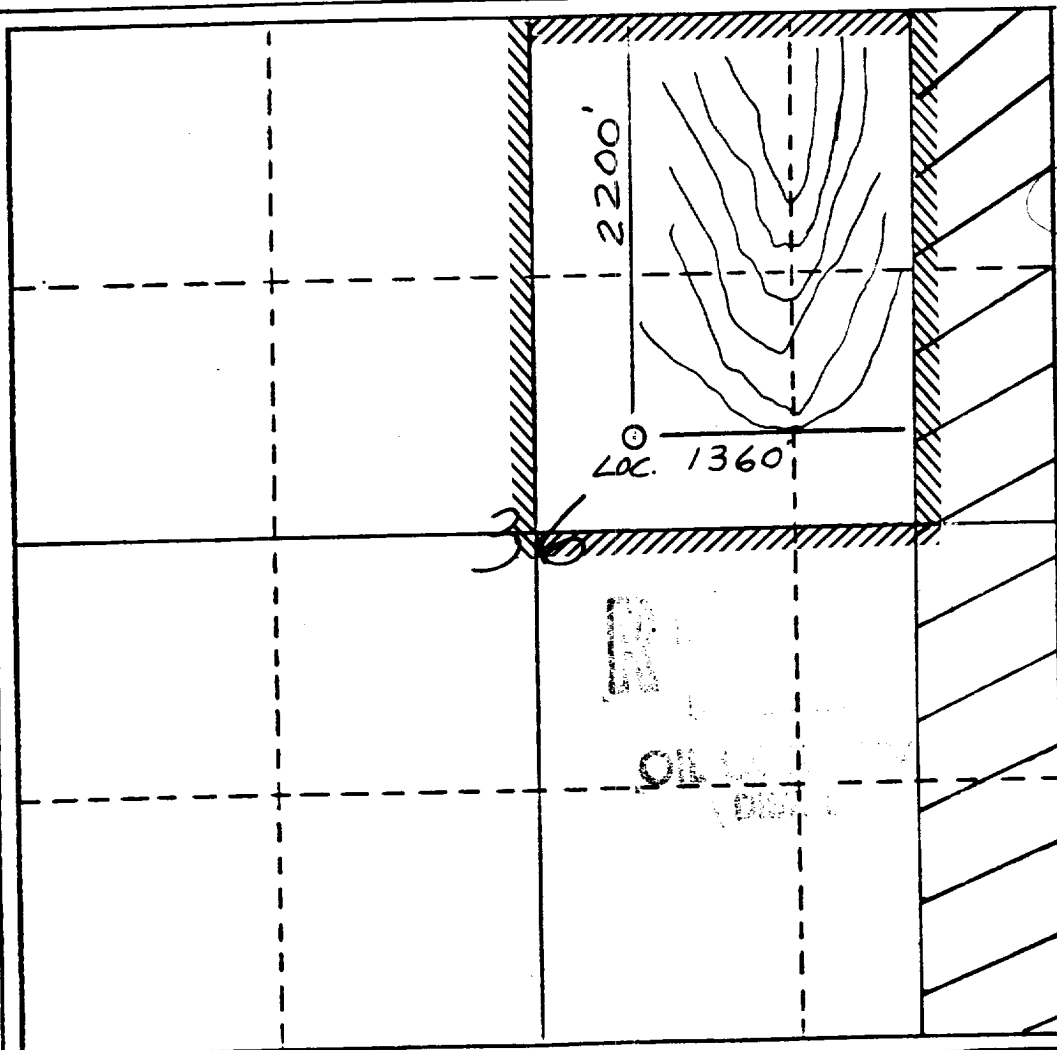

CERTIFICATION

I hereby certify that the information contained herein is true and complete to the best of my knowledge and belief.

Neale C. Edwards
Name

Regulatory Affairs

Position
Meridian Oil Inc.

Company
10-6-88

Date

I hereby certify that the location shown on this plat was plotted from field notes of actual surveys made by me or under my supervision, and that the same is true and correct to the best of my knowledge and belief.

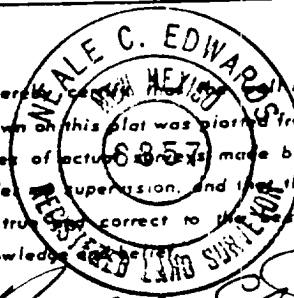

Neale C. Edwards
Date Surveyed

8-29-88

Registered Professional Engineer and/or Land Surveyor

Neale C. Edwards

Certificate No.
6057

