

STATE OF NEW MEXICO  
ENERGY AND MINERALS DEPARTMENT

OIL CONSERVATION DIVISION  
P. O. BOX 2088  
SANTA FE, NEW MEXICO 87501

Form C-102  
Revised 10-1-78

All distances must be from the outer boundaries of the Section.

Operator Meridian Oil Inc.		Lease San Juan 30-6 Unit		Well No. 443
Unit Letter G	Section 36	Township 30 North	Range 6 West	County Rio Arriba
Actual Postage Location of Wells 2200 feet from the North line and 1360 feet from the East line				
Ground Level Elev. 6807	Producing Formation Fruitland Coal	Pool Basin	Dedicated Acreage: 115.04 Acres	

1. Outline the acreage dedicated to the subject well by colored pencil or hachure marks on the plat below.
2. If more than one lease is dedicated to the well, outline each and identify the ownership thereof (both as to working interest and royalty).
3. If more than one lease of different ownership is dedicated to the well, have the interests of all owners been consolidated by communitization, unitization, force-pooling, etc?

☒ Yes ☐ No If answer is "yes," type of consolidation unitization

If answer is "no," list the owners and tract descriptions which have actually been consolidated. (Use reverse side of this form if necessary.)

No allowable will be assigned to the well until all interests have been consolidated (by communitization, unitization, forced-pooling, or otherwise) or until a non-standard unit, eliminating such interests, has been approved by the Division

\* NOTE: Non-standard due to terrain, pipelines, power lines & well.

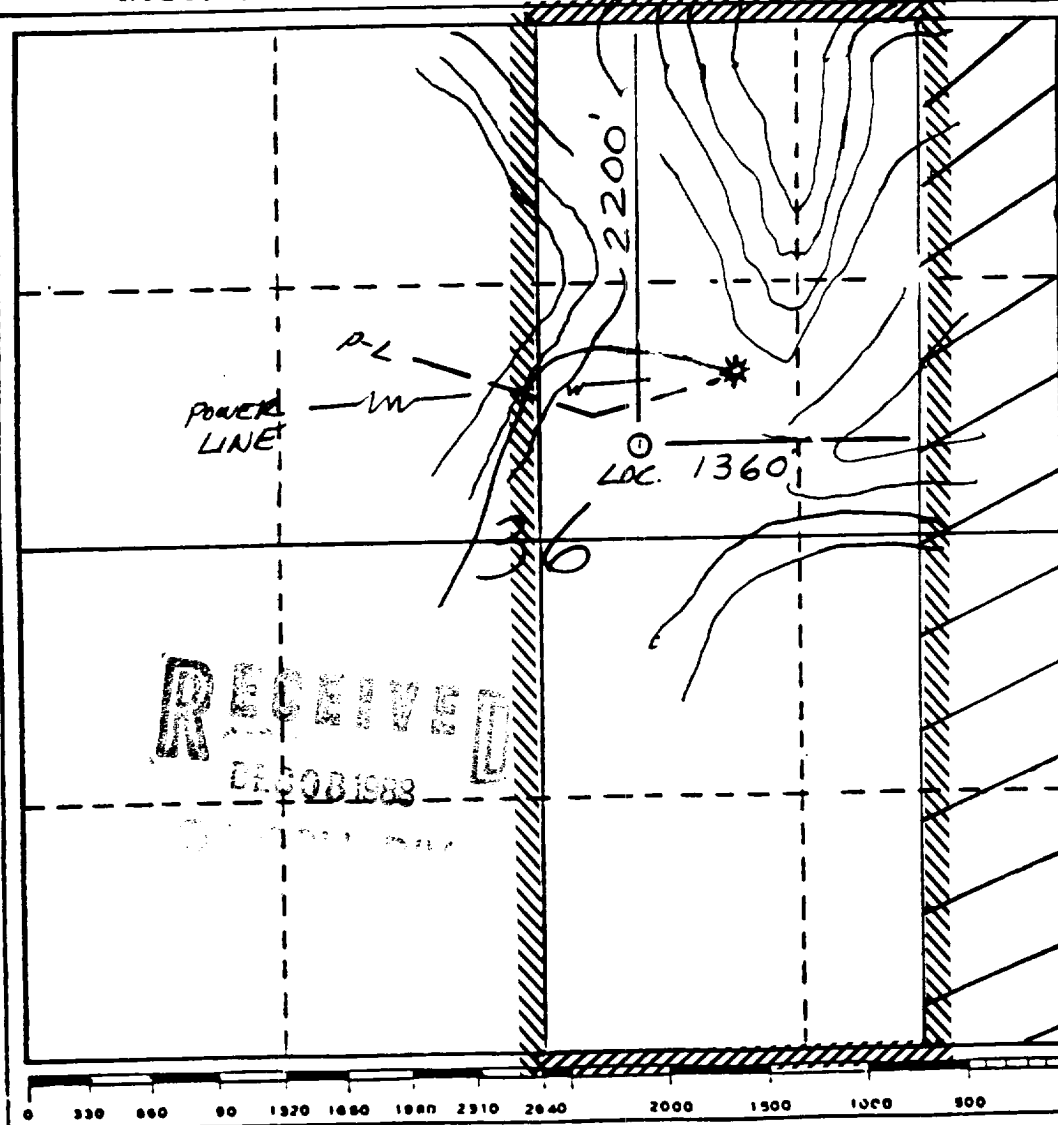

CERTIFICATION

I hereby certify that the information contained herein is true and complete to the best of my knowledge and belief.

Name  
Regulatory Affairs  
Position  
Meridian Oil Inc.

Company  
12-7-88

Date

I hereby certify that the location shown on this plat was plotted from field notes of actual surveys made by me or under my supervision, and that the same is true and correct to the best of my knowledge and belief.

Date Surveyed

8-29-8

Registered Professional Engineer and/or Land Surveyor

Neale C. Edwards

Certificate No.

6057