



STATE OF NEW MEXICO

ENERGY, MINERALS AND NATURAL RESOURCES DEPARTMENT

OIL CONSERVATION DIVISION

GARREY CARRUTHERS  
GOVERNOR

POST OFFICE BOX 2088  
STATE LAND OFFICE BUILDING  
SANTA FE, NEW MEXICO 87504  
(505) 827-5800

November 8, 1988

Blackwood & Nichols Co., Ltd.  
P.O. Box 1237  
Durango, CO 81302

Attention: William F. Clark  
Operations Manager

RECEIVED  
NOV 15 1988  
OIL CON. DIV.  
DIST. 3

Administrative Order NSL-2601

Dear Mr. Clark:

Reference is made to your application of October 31, 1988 for a non-standard coal gas well location for your Northeast Blanco Unit Well No. 429 to be located 160 feet from the North line and 1555 feet from the East line (Unit B) of Section 17, Township 30 North, Range 7 West, NMPM, Basin Fruitland Coal Gas Pool, Rio Arriba County, New Mexico. The N/2 of said Section 17 shall be dedicated to the well forming a standard 320-acre, more or less, gas spacing and proration unit.

By the authority granted me under the provisions of Rule 8 of Division Order No. R-8768, the above-described unorthodox coal gas well location is hereby approved.

Sincerely,

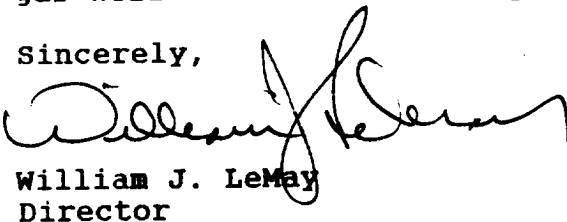
  
William J. Lemay  
Director

WJL/MES/ag

cc: Oil Conservation Division - Aztec  
New Mexico Oil & Gas Engineering Committee - Hobbs  
US Bureau of Land Management - Farmington



STATE OF NEW MEXICO  
ENERGY AND MINERALS DEPARTMENT  
OIL CONSERVATION DIVISION  
AZTEC DISTRICT OFFICE

1000 RIO BRAZOS ROAD  
AZTEC, NEW MEXICO 87410  
(505) 334-6178

OIL CONSERVATION DIVISION  
BOX 2088  
SANTA FE, NEW MEXICO 87501

DATE 11-1-88

RE: Proposed MC \_\_\_\_\_  
Proposed DHC \_\_\_\_\_  
Proposed NSL X \_\_\_\_\_  
Proposed SWD \_\_\_\_\_  
Proposed WFX \_\_\_\_\_  
Proposed PMX \_\_\_\_\_

Gentlemen:

I have examined the application dated 10-31-88  
for the Blackwood + Nichols NE 30 #425 B-17-30N-7W  
Operator Lease and Well No. Unit, S-T-R

and my recommendations are as follows:

APPROVE  
\_\_\_\_\_  
\_\_\_\_\_  
\_\_\_\_\_  
\_\_\_\_\_  
\_\_\_\_\_

Yours truly,

Earl Burch

OK

**BLACKWOOD & NICHOLS CO., LTD.**

P.O. BOX 1237  
DURANGO, COLORADO 81302-1237

(303) 247-0728

October 27, 1988

Mr. William LeMay  
New Mexico Oil Conservation Division  
P.O. Box 2088  
Santa Fe, New Mexico 87501

REL.  
OCT 31 1988  
OIL CON. DIV.  
DIST. 2

Re: Unorthodox Gas Well Location  
Northeast Blanco Unit No. 429  
160' FNL - 1555' FEL, Sec. 17, T30N, R7W  
Rio Arriba Co., New Mexico

Dear Mr. LeMay;

Blackwood & Nichols Co., Ltd. requests administrative approval of an exception to the footage requirements of Rule 7, R -8768 for the subject well, located in the Basin Fruitland Coal Pool.

This request is for exception due to topography. A Vicinity Map and C-102 are attached for your reference. As evidenced by the Vicinity Map, the standard locations would be located on the sandstone ledge immediately above the Navajo Reservoir. This area is inaccessible due the steep cliffs between the proposed location and a standard location.

The north half of Section 17 will be dedicated to this well. All offset proration units are within the boundaries of the Northeast Blanco Unit.

Your prompt consideration of this request is appreciated.

Sincerely,

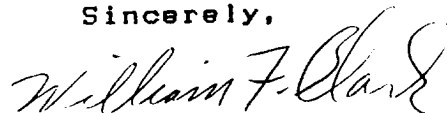

William F. Clark  
Operations Manager  
Blackwood & Nichols  
Co., Ltd.

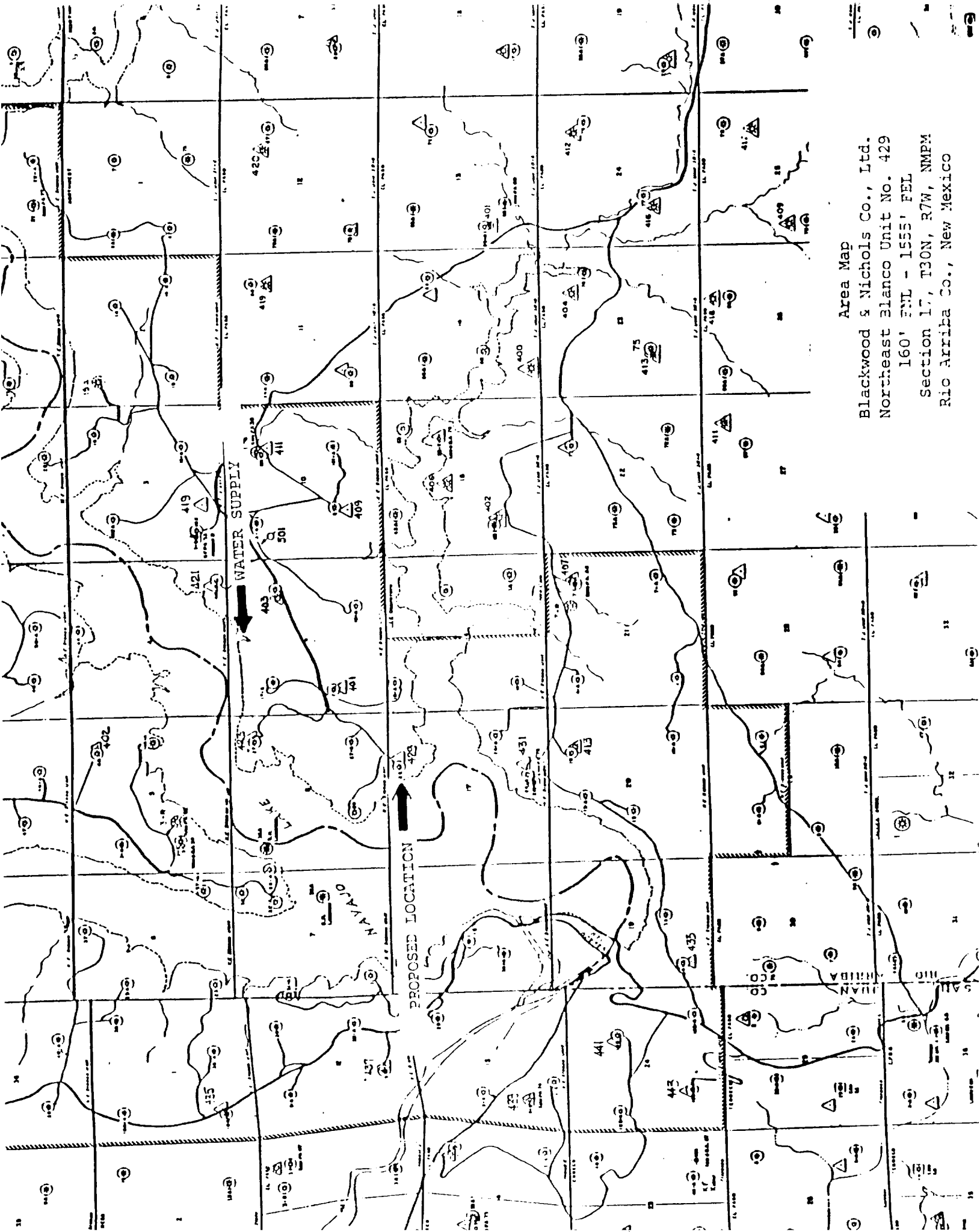

Area Map  
Blackwood & Nichols Co., Ltd.  
Northeast Blanco Unit No. 429  
160' FNL - 1555' FEL  
Section 17, T30N, R7W, NMPM  
Rio Arriba Co., New Mexico

SANTA FE, NEW MEXICO 8. 1

P O BOX 2000

Form C-102  
Revised 10-1

All distances must be from the outer boundaries of the Section.

1. Outline the acreage dedicated to the subject well by colored pencil or hachure marks on the plat below.
2. If more than one lease is dedicated to the well, outline each and identify the ownership thereof (both as to working interest and royalty).
3. If more than one lease of different ownership is dedicated to the well, have the interests of all owners been consolidated by communitization, unitization, force-pooling, etc?

If answer is "no," list the owners and tract descriptions which have actually been consolidated. (Use reverse side of this form if necessary.) \_\_\_\_\_

No allowable will be assigned to the well until all interests have been consolidated (by communitization, unitization, forced-pooling, or otherwise) or until a non-standard unit, eliminating such interests, has been approved by the Division.

\* Note: Non-standard due to terrain.

## CERTIFICATION

I hereby certify that the information contained herein is true and complete to the best of my knowledge and belief.

Name \_\_\_\_\_

**Position**

Operations Manager

Company

Blackwood & Nichols Co.,

Date \_\_\_\_\_

Date Oct 18, 1980

shown in this plot was obtained from notes of activities made by [redacted] under supervision, and [redacted] is true and correct to the best knowledge of [redacted]

Date Surveyed \_\_\_\_\_

9-11-88

Registered Professional Engineer  
and/or Land Surveyor

Neale C. Edward

Certificate No.

6857

Vicinity Map  
Blackwood & Nichols Co., Ltd.  
Northeast Blanco Unit No. 429  
160' FNL - 1555' FEL  
Section 17, T30N, R7W, NMPM  
Rio Arriba Co., New Mexico

