



STATE OF NEW MEXICO

ENERGY, MINERALS AND NATURAL RESOURCES DEPARTMENT

OIL CONSERVATION DIVISION

GARREY CARRUTHERS
GOVERNOR

POST OFFICE BOX 2088
STATE LAND OFFICE BUILDING
SANTA FE, NEW MEXICO 87504
(505) 827-5800

December 7, 1988

Blackwood & Nichols Co.
P.O. Box 1237
Durango, CO 81302

Attention: William F. Clark,
Operations Manager

Amended Administrative Order NSL-2604

Dear Mr. Clark:

The location of the Northeast Blanco Unit Well No. 423 as described in Division Administrative Order NSL-2604 is in error and should therefore be corrected as follows:

635
"...625 feet from the North line and 740 feet from the East line (Unit A) of Section 8, Township 30 North, Range 7 West, NMPM, Basin Fruitland Coal (Gas) Pool, Rio Arriba County, New Mexico."

All other provisions contained in said Order NSL-2604 dated November 15, 1988 shall remain in full force and effect.

Sincerely,

Michael E. Stogner
Petroleum Engineer

MES/ag

cc: Oil Conservation Division - Aztec
U.S. Bureau of Land Management - Farmington
File: NSL-2604

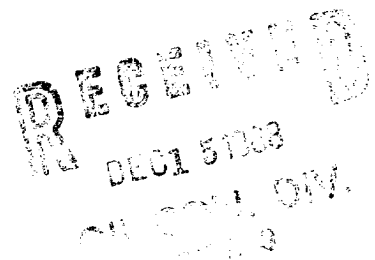

ENERGY, MINERALS AND NATURAL RESOURCES DEPARTMENT

OIL CONSERVATION DIVISION



GARREY CARRUTHERS
GOVERNOR

RECEIVED

NOV 17 1988

OIL CON. DIV.

POST OFFICE BOX 2088
STATE LAND OFFICE BUILDING
SANTA FE, NEW MEXICO 87504
(505) 827-5800

November 15, 1988

Blackwood & Nichols Co.
P.O. Box 1237
Durango, CO 81302

Attention: William F. Clark
Operations Manager

Administrative Order NSL-2604

Dear Mr. Clark:

Reference is made to your application of November 9, 1988 for a non-standard coal gas well location for your Northeast Blanco Unit Well No. 423 to be located 625 feet from the south line and 740 feet from the East line (Unit A) of Section 8, Township 30 North, Range 7 West, NMPM, Basin Fruitland Coal (Gas) Pool, Rio Arriba County, New Mexico. The E/2 of said Section 8 shall be dedicated to the well forming a standard 320-acre, more or less, gas spacing and proration unit.

By the authority granted me under the provisions of Rule 8 of Division Order No. R-8768, the above-described unorthodox coal gas well location is hereby approved.

Sincerely,

A handwritten signature in cursive script, appearing to read "William J. LeMay".
William J. LeMay
Director

WJL/MES/ag

cc: Oil Conservation Division - Aztec
New Mexico Oil & Gas Engineering Committee - Hobbs
US Bureau of Land Management - Farmington



STATE OF NEW MEXICO
ENERGY AND MINERALS DEPARTMENT
OIL CONSERVATION DIVISION
AZTEC DISTRICT OFFICE

1000 RIO BRAZOS ROAD
AZTEC, NEW MEXICO 87410
(505) 334-6178

OIL CONSERVATION DIVISION
BOX 2088
SANTA FE, NEW MEXICO 87501

DATE 11-7-88

RE: Proposed MC _____
Proposed DHC _____
Proposed NSL A _____
Proposed SWD _____
Proposed WFX _____
Proposed PMX _____

Gentlemen:

I have examined the application dated 11-7-88
for the Blackwood & Nichols Co., LTD. NEBU#423 A-8-30N-763
Operator Lease and Well No. Unit, S-T-R

and my recommendations are as follows:

Approve

Yours truly,

Em. Busch

a-10c

BLACKWOOD & NICHOLS CO., LTD.

P.O. BOX 1237
DURANGO, COLORADO 81302-1237

(303) 247-0728

October 31, 1988

Mr. William LeMay
New Mexico Oil Conservation Division
P.O. Box 2088
Santa Fe, New Mexico 87501

Re: Unorthodox Gas Well Location
Northeast Blanco Unit No. 423
625' FSL - 740' FEL, Sec. 8, T30N, R7W
Rio Arriba Co., New Mexico

Dear Mr. LeMay;

Blackwood & Nichols Co., Ltd. requests administrative approval of an exception to the footage requirements of Rule 7, R -8768 for the subject well, located in the Basin Fruitland Coal Pool.

This request is for exception due to topography. A Vicinity Map and C-102 are attached for your reference. As evidenced by the Vicinity Map, there are no standard locations that do not encroach on the camping facilities of Simms Mesa State Park or the existing location. This well was staked as close as possible to the existing location to utilize as much of the existing pad as possible, without interfering with the work area necessary for the existing well.

The east half of Section 8 will be dedicated to this well. All offset proration units are operated by Blackwood & Nichols Co., Ltd.

Your prompt consideration of this request is appreciated.

Sincerely,

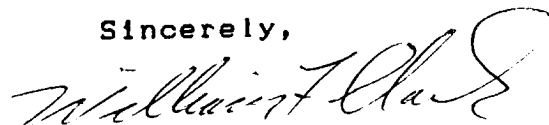

William F. Clark
Operations Manager
Blackwood & Nichols
Co., Ltd.

RECEIVED
OCT 31 1988
OIL CON. DIV.
D-1

STATE OF NEW MEXICO
ENERGY AND MINERALS DEPARTMENT

OIL CONSERVATION DIVISION
P. O. BOX 2088
SANTA FE, NEW MEXICO 87501

Form C-102
Revised 10-1-78

All distances must be from the outer boundaries of the Section.

Operator Blackwood & Nichols Co., LTD.			Lease Northeast Blanco Unit		Well No. 423
Unit Letter A	Section 8	Township 30 North	Range 7 West	County Rio Arriba	
Actual Footage Location of Well: 625 feet from the North line and 740 feet from the East line					
Ground Level Elev. 6136	Producing Formation Fruitland Coal		Pool Basin Fruitland Coal		Dedicated Acreage: 320 Acres

1. Outline the acreage dedicated to the subject well by colored pencil or hatchure marks on the plat below.
2. If more than one lease is dedicated to the well, outline each and identify the ownership thereof (both as to working interest and royalty).
3. If more than one lease of different ownership is dedicated to the well, have the interests of all owners been consolidated by communitization, unitization, force-pooling, etc?

☐ Yes ☐ No If answer is "yes," type of consolidation NA

If answer is "no," list the owners and tract descriptions which have actually been consolidated. (Use reverse side of this form if necessary.)

No allowable will be assigned to the well until all interests have been consolidated (by communitization, unitization, forced-pooling, or otherwise) or until a non-standard unit, eliminating such interests, has been approved by the Division.

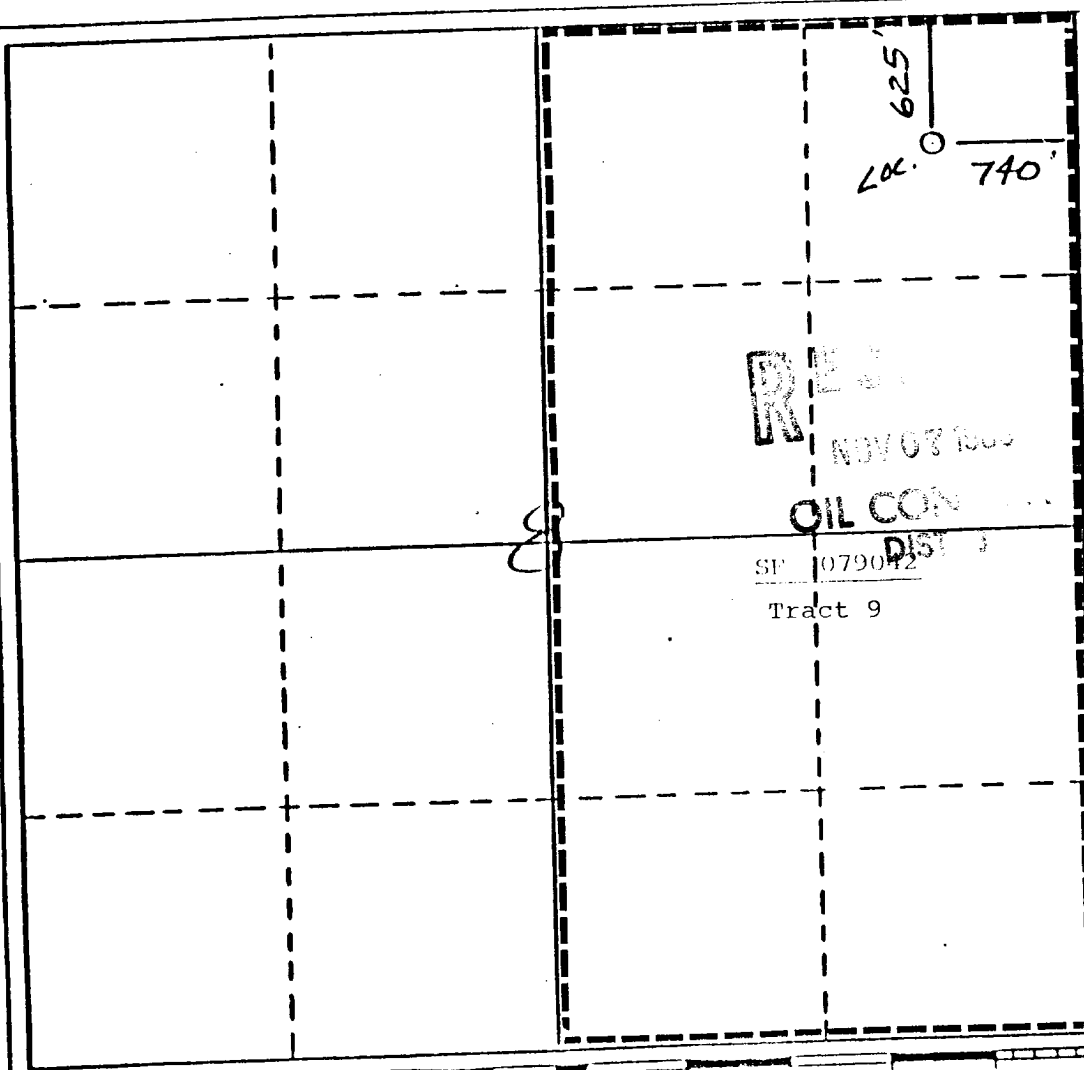

CERTIFICATION

I hereby certify that the information contained herein is true and complete to the best of my knowledge and belief.

Name William F. [Signature]
Position Operations Manager
Company Blackwood & Nichols Co., Lt
Date Oct 24, 1988

I hereby certify that the location shown on this plat was plotted from field notes of actual survey made by me or under my supervision, and that the same is true, correct to the best of my knowledge.

Date Surveyed 10-19-88
Registered Professional Engineer and/or Land Surveyor

Neale C. Edwards
Certificate No. 6857

