

30-039-24381

UNITED STATES  
DEPARTMENT OF THE INTERIOR  
BUREAU OF LAND MANAGEMENT

APPLICATION FOR PERMIT TO DRILL, DEEPEN, OR PLUG BACK

1a. TYPE OF WORK  
 DRILL  DEEPEN  PLUG BACK

b. TYPE OF WELL  
 OIL WELL  GAS WELL  OTHER  SINGLE ZONE  MULTIPLE ZONE

2. NAME OF OPERATOR  
~~El Paso Natural Gas Company~~  
*Wilmington Oil Inc -*

3. ADDRESS OF OPERATOR  
 PO Box 4289, Farmington, NM 87499

4. LOCATION OF WELL (Report location clearly and in accordance with any State requirements.)  
 At surface  
 1190'S, 1600'W  
 At proposed prod. zone

5. LEASE DESIGNATION AND SERIAL NO.  
 NM-02151A

6. IF INDIAN, ALLOTTEE OR TRIBE NAME

7. UNIT AGREEMENT NAME  
 San Juan 30-6 Unit

8. FARM OR LEASE NAME  
 San Juan 30-6 Unit

9. WELL NO.  
 428

10. FIELD AND POOL, OR WILDCAT  
 Basin  
 Under Fruitland Coal

11. SEC., T., R., M., OR BLK. AND SURVEY OR AREA  
 Sec. 28, T-30-N, R-7 -W  
 NMPM

12. COUNTY OR PARISH 13. STATE  
 Rio Arriba NM

14. DISTANCE IN MILES AND DIRECTION FROM NEAREST TOWN OR POST OFFICE\*  
 12 miles from Aztec, NM

15. DISTANCE FROM PROPOSED\* LOCATION TO NEAREST PROPERTY OR LEASE LINE, FT. (Also to nearest drlg. unit line, if any)  
 1190

16. NO. OF ACRES IN LEASE

17. NO. OF ACRES ASSIGNED TO THIS WELL  
 160.00 w/320

18. DISTANCE FROM PROPOSED LOCATION\* TO NEAREST WELL, DRILLING, COMPLETED, OR APPLIED FOR, ON THIS LEASE, FT.  
 400'

19. PROPOSED DEPTH  
 3122'

20. ROTARY OR CABLE TOOLS  
 Rotary

21. ELEVATIONS (Show whether DF, RT, GR, etc.)  
 6271' GL 6269'

22. APPROX. DATE WORK WILL START\*

23. DRILLING OPERATIONS AUTHORIZED ARE SUBJECT TO COMPLIANCE WITH ATTACHED "GENERAL REQUIREMENTS"  
 PROPOSED CASING AND CEMENTING PROGRAM

This action is subject to technical and procedural review pursuant to 43 CFR 3165.3 and appeal pursuant to 43 CFR 3165.4.

SIZE OF HOLE	SIZE OF CASING	WEIGHT PER FOOT	SETTING DEPTH	QUANTITY OF CEMENT
12 1/4"	9 5/8"	32.3#	200'	130 cf. circulated
8 3/4"	7"	20.0#	3000'	950 cf circ. surface
6 1/4"	5 1/2" liner	23.0#	3122'	do not cement

The Fruitland coal formation will be completed.

A 3000 psi WP and 6000 psi test double gate preventer equipped with blind and pipe rams will be used for blow out prevention on this well.

This gas is dedicated.

The SW/4 of Section 28 is dedicated to this well.

**RECEIVED**

APR 07 1989

OIL CON. DIV

IN ABOVE SPACE DESCRIBE PROPOSED PROGRAM: If proposal is to deepen or plug back, give data on present productive zone and proposed new productive zone. If proposal is to drill or deepen directionally, give pertinent data on subsurface locations and measured and true vertical depths. Give blowout preventer program, if any.

24. SIGNED *Wendy Bradford* TITLE Regulatory Affairs DATE 08-15-88

(This space for Federal or State office use)

PERMIT NO. \_\_\_\_\_ APPROVAL DATE \_\_\_\_\_

APPROVED BY \_\_\_\_\_ TITLE \_\_\_\_\_ DATE \_\_\_\_\_

CONDITIONS OF APPROVAL, IF ANY:

*ok*  
*CE*

NMOC

\*See Instructions On Reverse Side

All distances must be from the outer boundaries of the Section.

Operator <i>MERIDIAN OIL INC.</i> <del>El Paso Natural Gas</del>		Lease San Juan 30-6 Unit(NM-02151A)		Well No. 428
Unit Letter N	Section 28	Township 30 North	Range 7 West	County Rio Arriba
Actual Footage Location of Wells 1190 feet from the South line and 1600 feet from the West line				
Ground Level Elev. 6269	Producing Formation Fruitland Coal	Pool Basin	Dedicated Acreage: 320 Ac	

1. Outline the acreage dedicated to the subject well by colored pencil or hachure marks on the plat below.
2. If more than one lease is dedicated to the well, outline each and identify the ownership thereof (both as to working interest and royalty).
3. If more than one lease of different ownership is dedicated to the well, have the interests of all owners been consolidated by communitization, unitization, force-pooling, etc?

Yes  No If answer is "yes," type of consolidation unitization

If answer is "no," list the owners and tract descriptions which have actually been consolidated. (Use reverse side of this form if necessary.) \_\_\_\_\_

No allowable will be assigned to the well until all interests have been consolidated (by communitization, unitization, forced-pooling, or otherwise) or until a non-standard unit, eliminating such interests, has been approved by the Division

NOTE: reissued to show moved location.

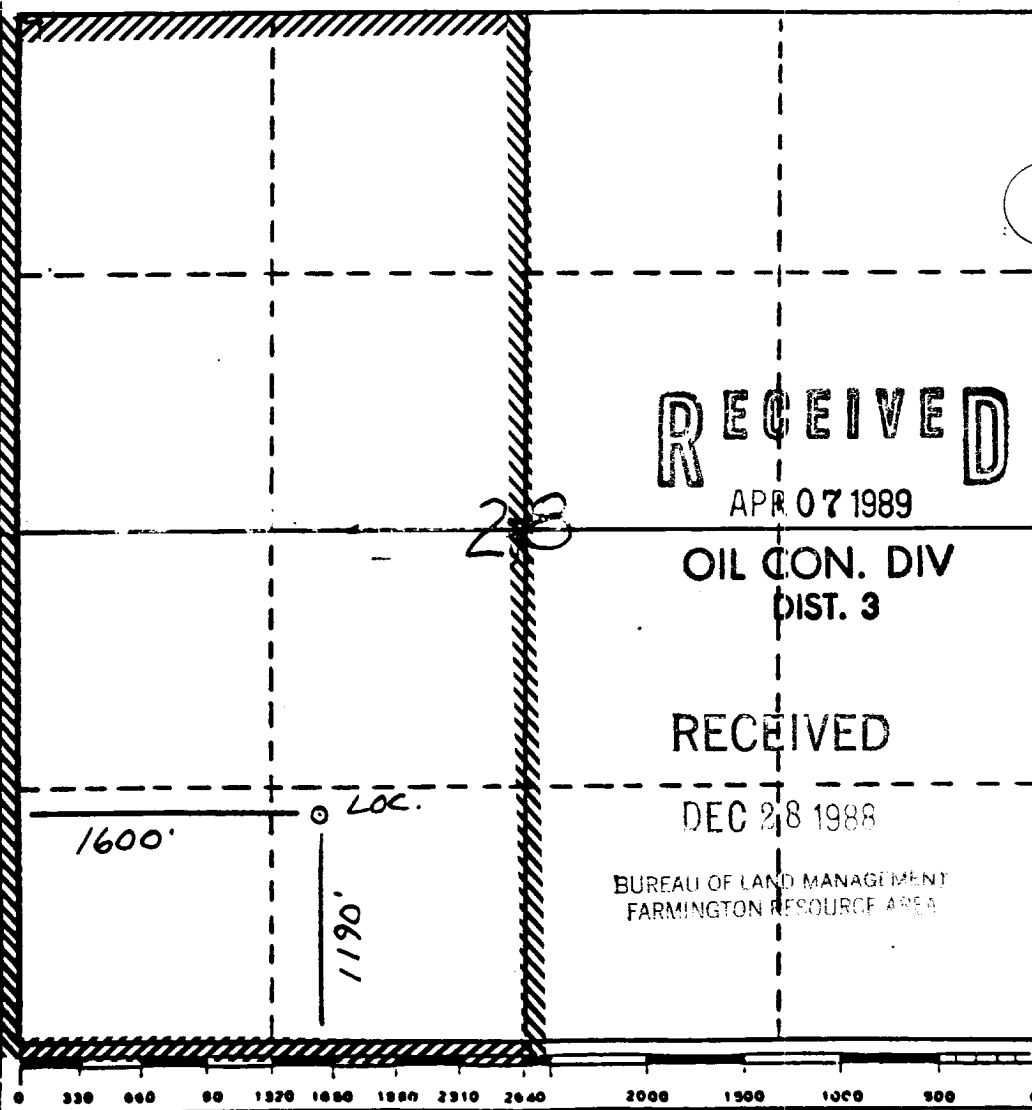

RECEIVED  
APR 07 1989

OIL CON. DIV  
DIST. 3

RECEIVED  
DEC 28 1988

BUREAU OF LAND MANAGEMENT  
FARMINGTON RESOURCE AREA

CERTIFICATION

I hereby certify that the information contained herein is true and complete to the best of my knowledge and belief.

*[Signature]*  
Name

Regulatory Affairs

Position

El Paso Natural Gas

Company

*12-22-88*

Date

I hereby certify that the location shown on this plat was plotted from field notes of actual *6857* made by me or under my supervision, and that the same is true and correct to the best of my knowledge.

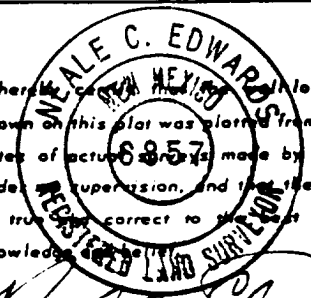

Date Surveyed

*8-9-88*

Registered Professional Engineer and/or Land Surveyor

Neale C. Edwards

Certificate No.

6857

