

State of New Mexico
Energy, Minerals and Natural Resources Department

Form C-101

OIL CONSERVATION DIVISION
P.O. Box 2088
Santa Fe, New Mexico 87504-2088

APPLICATION FOR PERMIT TO DRILL, DEEPEN,
OR PLUG BACK

RECEIVED
AUG 1 6 1989
OIL CON. DIV.
DIST. 3
SINGLE ZONE

1a. Type of Work
DRILL

b. Type of Well
GAS SINGLE ZONE

2. Name of Operator
MERIDIAN OIL INC.

3. Address of Operator
PO Box 4289, Farmington, NM 87499

4. Well Location
Unit letter L 1660'S 1275'W
Section 16 T30N R06W NMPM RIO ARRIBA COUNTY

5. Indicate Type of Lease
STATE

6. State Oil & Gas Lease No.
E-347-26

7. Lease Name or Unit Agreement Name
SAN JUAN 30-6 UNIT

8. Well No.
408

9. Pool Name or Wildcat
BASIN FRUITLAND COAL

10. Proposed Depth
3379'

11. Formation
FRUITLAND COAL

12. Rotary or C.T.
Rotary

13. Elevation
6560'GL

14. Bond Type
statewide

15. Drill. Contractor

16. Est. Start Date
upon approval

17. PROPOSED CASING AND CEMENT PROGRAM

SIZE HOLE	SIZE CASING	WT. PER FT.	SET. DEPTH	SKS OF CEMENT	EST. TOP
12 1/4"	9 5/8"	32.3#	200 ft.	125 cu.ft.	circ surfac
8 3/4"	7"	20.0#	3275 ft.	204 cu.ft.	cover O.A.
6 1/4"	5 1/2"	15.5#	3379 ft.	do not cmt.	

The Fruitland Coal formation will be completed.
A 3000 psi WP and 6000 psi test double gate preventer equipped with
blind and pipe rams will be used for blow out prevention on this well.
This gas is dedicated.
The W/2 of Sec 16 is dedicated to this well.

I hereby certify that the information above is true and complete to the best
of my knowledge and belief.

SIGNATURE [Signature] TITLE Regulatory Affairs DATE 8-15-89

(This space for State Use)

APPROVED BY [Signature] TITLE _____ DATE AUG 17 1989

Conditions of approval, if any:
APPROVAL EXPRESSES 2-17-90
UNLESS OTHERWISE SPECIFIED
SOUTH OF THE STATE LINE
WITHIN THE STATE

Submit to Appropriate
District Office
Data Lease - 4 copies
Fee Lease - 3 copies

State of New Mexico
Energy, Minerals and Natural Resources Department

Form C-102
Revised 1-1-89

OIL CONSERVATION DIVISION

P.O. Box 2088
Santa Fe, New Mexico 87504-2088

DISTRICT I
P.O. Box 1980, Hobbs, NM 88240

DISTRICT II
P.O. Drawer DD, Arama, NM 88210

DISTRICT III
1000 Rio Brazos Rd., Aztec, NM 87410

WELL LOCATION AND ACREAGE DEDICATION PLAT

All Distances must be from the outer boundaries of the section

Operator <i>MCG</i> El Paso Natural Gas		Lease San Juan (E-347-26) 30-0 Unit		Well No. 408
Unit Letter L	Section 16	Township 30 North	Range 6 West	County NMPM Rio Arriba
Actual Footage Location of Well: 1660 feet from the South line and 1275 feet from the West line				
Ground level Elev. 6560'	Producing Formation Fruitland Coal		Pool Basin	Dedicated Acreage: 320 Acres

1. Outline the acreage dedicated to the subject well by colored pencil or ballpoint marker on the plat below.
2. If more than one lease is dedicated to the well, outline each and identify the ownership thereof (both as to working interest and royalty).
3. If more than one lease of different ownership is dedicated to the well, have the interest of all owners been consolidated by communitization, unitization, force-pooling, etc.?

Yes No If answer is "yes" type of consolidation unitization

If answer is "no" list the owners and tract descriptions which have actually been consolidated. (Use reverse side of this form if necessary.)

No allowable will be assigned to the well until all interests have been consolidated (by communitization, unitization, force-pooling, or otherwise) or until a non-standard unit, eliminating such interest, has been approved by the Division.

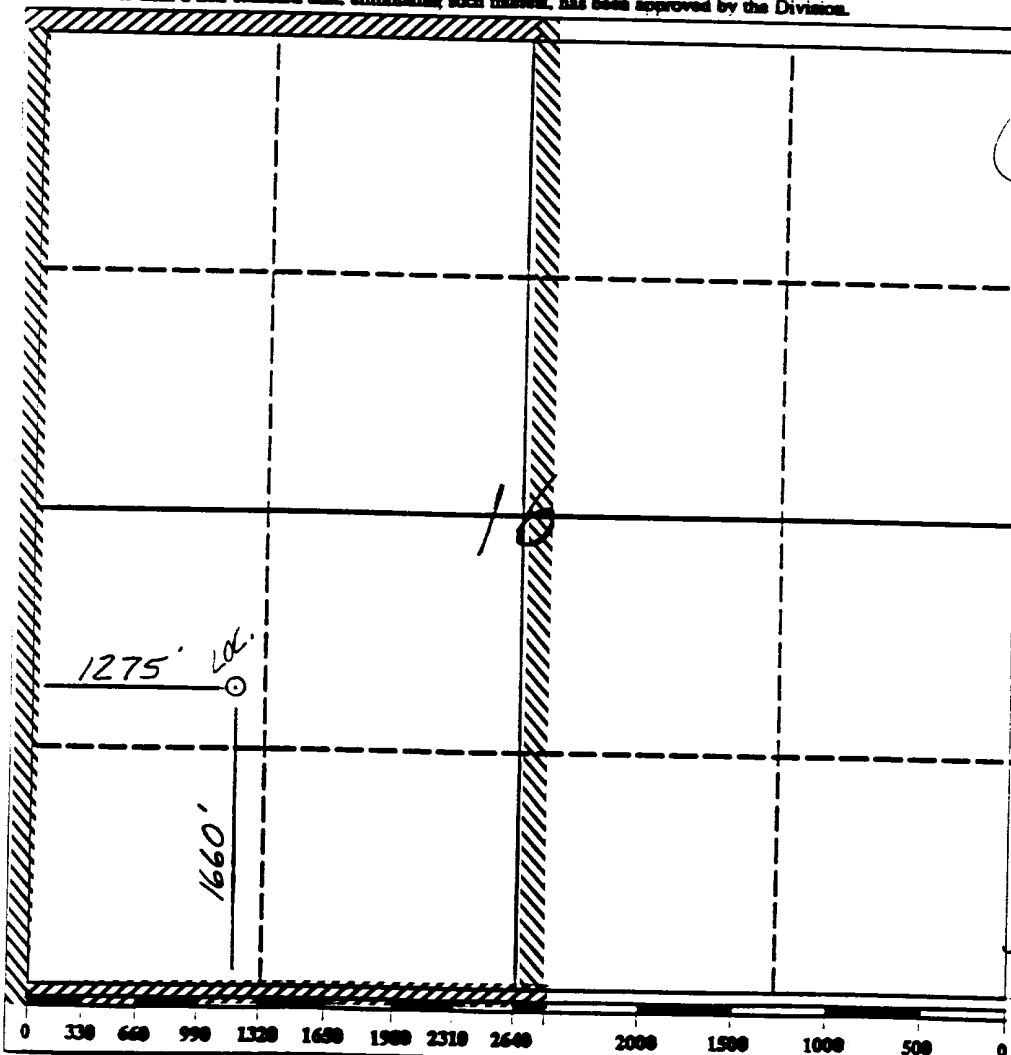

OPERATOR CERTIFICATION

I hereby certify that the information contained herein is true and complete to the best of my knowledge and belief.

Peggy Bradfield
Signature

Peggy Bradfield
Printed Name

Regulatory Affairs
Position

El Paso Natural Gas
Company

8-15-89
Date

Date

SURVEYOR CERTIFICATION

I hereby certify that the well location shown on this plat was plotted from field notes actual surveys made by me or under supervision, and that the same is true and correct to the best of my knowledge and belief.

8-7-88
Date Surveyed

NEALE C. EDWARDS
Signature of Seeker of Professional Surveyor

857
Professional Surveyor

REGISTERED LAND SURVEYOR

Neale C. Edwards
Signature

857
Certificate No.

6857