

Submit to Appropriate  
District Office  
State Lease - 6 copies  
Fee Lease - 5 copies

State of New Mexico  
Energy, Minerals and Natural Resources Department

Form C-101  
Revised 1-1-89

OIL CONSERVATION DIVISION

P.O. Box 2088  
Santa Fe, New Mexico 87504-2088

DISTRICT I  
P.O. Box 1980, Hobbs, NM 88240

DISTRICT II  
P.O. Drawer DD, Artesia, NM 88210

DISTRICT III  
1000 Rio Brazos Rd., Aztec, NM 87410

API NO. (assigned by OCD on New Wells)
30-039-24637
5. Indicate Type of Lease STATE <input type="checkbox"/> FEE <input checked="" type="checkbox"/>
6. State Oil & Gas Lease No.

APPLICATION FOR PERMIT TO DRILL, DEEPEN, OR PLUG BACK

1a. Type of Work: DRILL <input checked="" type="checkbox"/> RE-ENTER <input type="checkbox"/> DEEPEN <input type="checkbox"/> PLUG BACK <input type="checkbox"/>	7. Lease Name or Unit Agreement Name San Juan 30-5 Unit 9258				
b. Type of Well: OIL WELL <input type="checkbox"/> GAS WELL <input checked="" type="checkbox"/> OTHER <input type="checkbox"/> SINGLE ZONE <input checked="" type="checkbox"/> MULTIPLE ZONE <input type="checkbox"/>	8. Well No. 205				
2. Name of Operator Phillips Petroleum Co. 17654	9. Pool name or Wildcat 71629				
3. Address of Operator 300 W. Arrington, Suite 200, Farmington, N.M. 87401	Basin Fruitland Coal Gas				
4. Well Location Unit Letter K : 2010 Feet From The South Line and 1481 Feet From The West Line Section 7 Township 30N Range 5W NMPM Rio Arriba County					
10. Proposed Depth 3013(±)	11. Formation Fruitland				
12. Rotary or C.T. Rotary					
13. Elevations (Show whether DF, RT, GR, etc.) 6206' (GL Unprepared)	14. Kind & Status Plug. Bond Blanket				
15. Drilling Contractor Advise Later	16. Approx. Date Work will start Upon Approval				
17. PROPOSED CASING AND CEMENT PROGRAM W/2 320 Acres					
SIZE OF HOLE	SIZE OF CASING	WEIGHT PER FOOT	SETTING DEPTH	SACKS OF CEMENT	EST. TOP
12-1/4"	9-5/8"	36#, K-55 ST&C	250'	250 sxs	Circ to Surface
8-1/8"	7"	23#, K-55 LT&C	2868'	600 sxs	Circ to Surface
*6-1/8"	5-1/2" Liner	15.5# or 23#	3013'		*

\*If the coal is cleated a 5-1/2", 23#, P-110, LT&C liner will be run in the open hole without being cemented.

\*If the coal is not cleated a 5-1/2", 15.5#, J-55, LT&C liner will be run and cemented W/100 sxs of cement and the well fractured.

Use mud additives as required for control.

BOP equipment: (See attached schematic - Fig. 7-9 or 7-10).

APPROVAL EXPIRES 9-6-90  
UNLESS DRILLING IS COMMENCED.  
SPUD NOTICE MUST BE SUBMITTED  
WITHIN 10 DAYS

RECEIVED  
MAR 06 1990  
OIL CON. DIV  
DIST. 3

IN ABOVE SPACE DESCRIBE PROPOSED PROGRAM. IF PROPOSAL IS TO DEEPEN OR PLUG BACK, GIVE DATA ON PRESENT PRODUCTIVE ZONE AND PROPOSED NEW PRODUCTIVE ZONE. GIVE BLOWOUT PREVENTER PROGRAM, IF ANY.

I hereby certify that the information above is true and complete to the best of my knowledge and belief.

SIGNATURE L. M. Sanders TITLE Supv. Regulatory Affairs DATE 3-5-90  
TYPE OR PRINT NAME L. M. Sanders TELEPHONE NO. (505) 599-3431

(This space for State Use)

APPROVED BY Ernie Bunch TITLE DEPUTY OIL & GAS INSPECTOR, DIST. #3 DATE MAR 06 1990  
CONDITIONS OF APPROVAL, IF ANY:

RECEIVED  
JAN 10 1950  
U.S. AIR FORCE  
HEADQUARTERS  
WASHINGTON, D.C.

MAR 10 1950

# FIELD PRACTICES AND STANDARDS

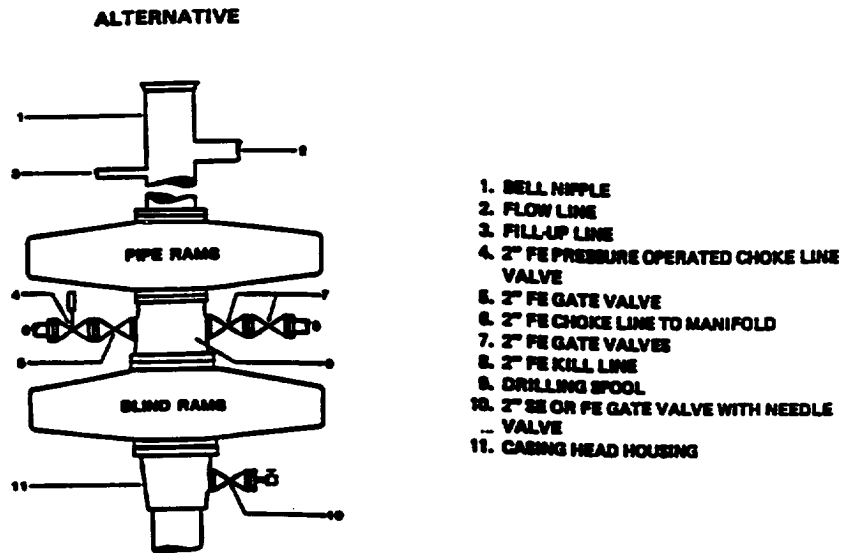

NOTE: THE DRILLING SPOOL MAY BE LOCATED BELOW BOTH SETS OF RAMS IF A DOUBLE PREVENTER IS USED AND IT DOES NOT HAVE SUITABLE OUTLETS BETWEEN RAMS

**Figure 7-9. Standard Hydraulic Blowout Preventer Assembly  
3 M Working Pressure Alternative 1**

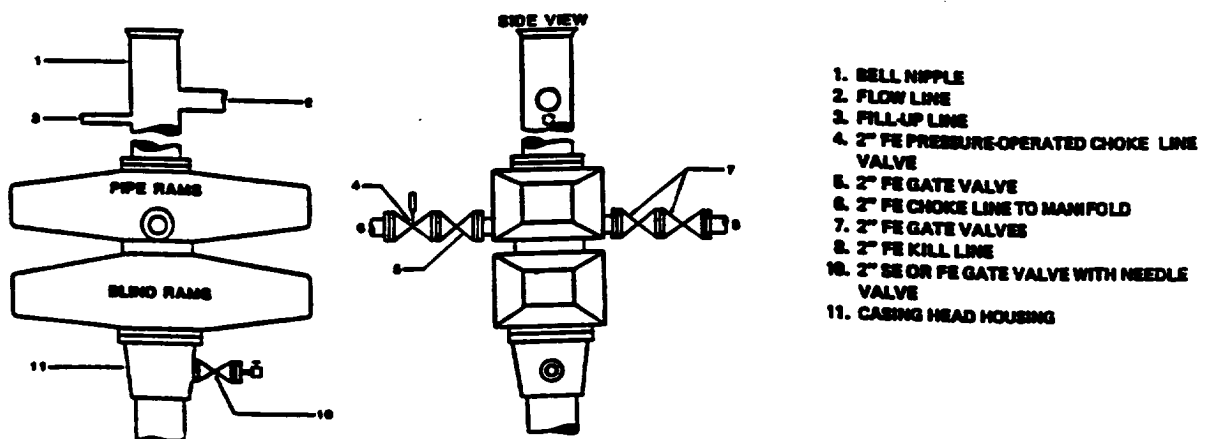

**Figure 7-10. Standard Hydraulic Blowout Preventer Assembly  
3 M Working Pressure Alternative 3 (without Drilling Spool)**

Submit to Appropriate  
District Office  
State Lease - 4 copies  
Fee Lease - 3 copies

State of New Mexico  
Energy, Minerals and Natural Resources Department

Form C-102  
Revised 1-1-89

OIL CONSERVATION DIVISION

P.O. Box 2088  
Santa Fe, New Mexico 87504-2088

DISTRICT I  
P.O. Box 1980, Hobbs, NM 88240

DISTRICT II  
P.O. Drawer DD, Artesia, NM 88210

DISTRICT III  
1000 Rio Brazos Rd., Aztec, NM 87410

WELL LOCATION AND ACREAGE DEDICATION PLAT

All Distances must be from the outer boundaries of the section

Operator <b>PHILLIPS PETROLEUM</b>			Lease <b>SAN JUAN 30-5</b>		Well No. <b>205</b>
Unit Letter <b>K</b>	Section <b>7</b>	Township <b>T.30 N.</b>	Range <b>R.5 W.</b>	County <b>RIO ARriba COUNTY</b>	
Actual Footage Location of Well: <b>2010</b> feet from the <b>SOUTH</b> line and <b>1481</b> feet from the <b>WEST</b> line					
Ground level Elev. <b>6206</b>	Producing Formation <b>Fruitland</b>		Pool <b>Basin Fruitland Coal Gas</b>		Dedicated Acreage: <b>320</b> Acres

1. Outline the acreage dedicated to the subject well by colored pencil or hatchure marks on the plat below.
2. If more than one lease is dedicated to the well, outline each and identify the ownership thereof (both as to working interest and royalty).
3. If more than one lease of different ownership is dedicated to the well, have the interest of all owners been consolidated by communitization, unitization, force-pooling, etc.?

☒ Yes ☐ No If answer is "yes" type of consolidation Unitization

If answer is "no" list the owners and tract descriptions which have actually been consolidated. (Use reverse side of this form if necessary.)

No allowable will be assigned to the well until all interests have been consolidated (by communitization, unitization, forced-pooling, or otherwise) or until a non-standard unit, eliminating such interest, has been approved by the Division.

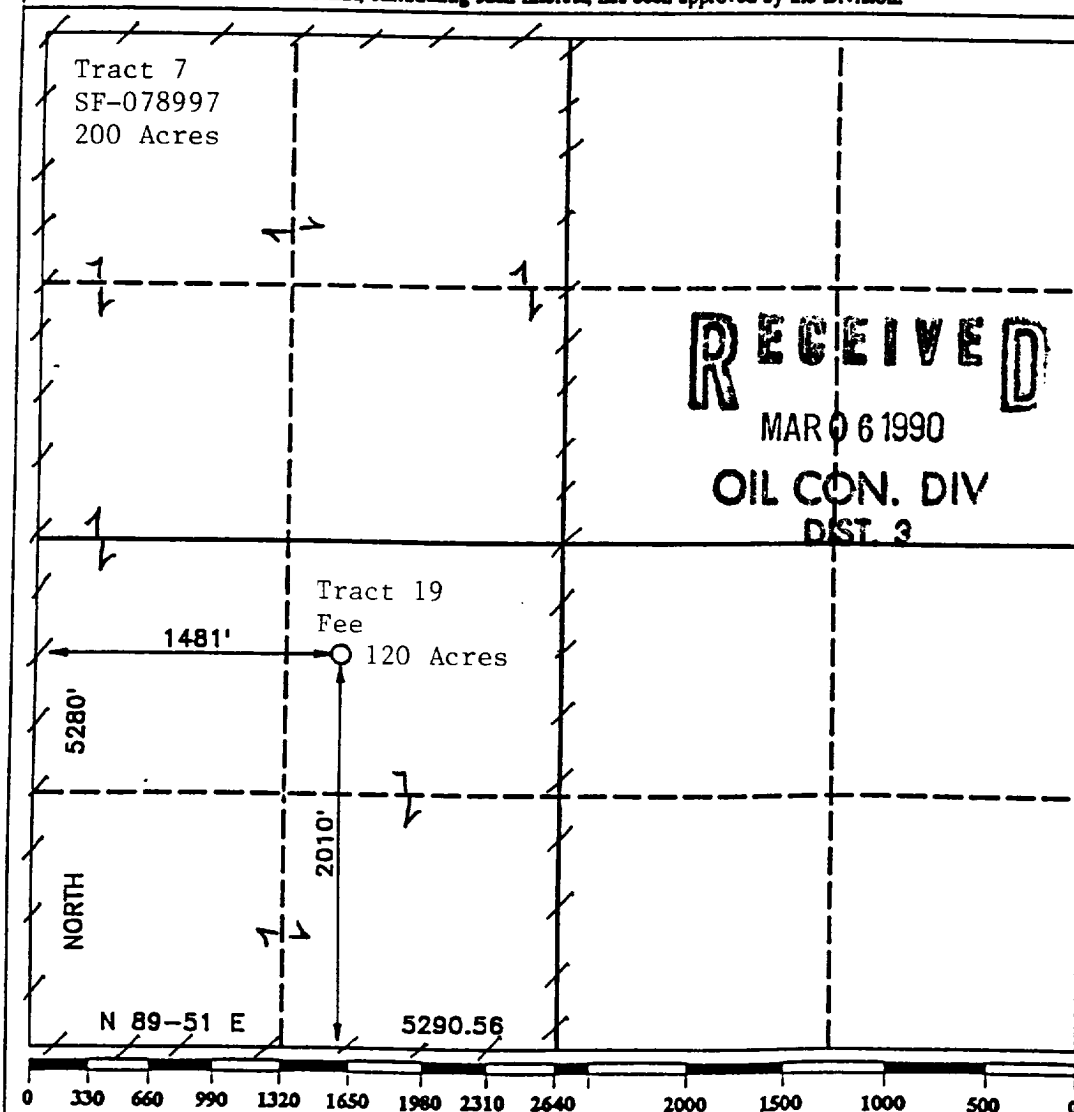

OPERATOR CERTIFICATION

I hereby certify that the information contained herein is true and complete to the best of my knowledge and belief.

Signature  
*L. M. Sanders*  
Printed Name  
**L. M. Sanders**  
Position  
**Supv. Regulatory Affairs**  
Company  
**Phillips Petroleum Co.**  
Date  
**March 5, 1990**

SURVEYOR CERTIFICATION

I hereby certify that the well location shown on this plat was plotted from field notes of actual surveys made by me or under my supervision, and that the same is true and correct to the best of my knowledge and belief.

Date Surveyed  
**FEBRUARY 3, 1990**

Signature of State of  
Professional Surveyor  
*R. Howard Daggett*  
**R. HOWARD DAGGETT**  
Certificate No.  
**9679**  
Registered Professional  
Land Surveyor