

UNITED STATES  
DEPARTMENT OF THE INTERIOR  
BUREAU OF LAND MANAGEMENT

APPLICATION FOR PERMIT TO DRILL, DEEPEN, OR PLUG BACK

1a. TYPE OF WORK DRILL <input checked="" type="checkbox"/> DEEPEN <input type="checkbox"/> PLUG BACK <input type="checkbox"/>				5. LEASE DESIGNATION AND SERIAL NO. NM-012335																									
b. TYPE OF WELL OIL WELL <input type="checkbox"/> GAS WELL <input checked="" type="checkbox"/> OTHER <input type="checkbox"/> SINGLE ZONE <input checked="" type="checkbox"/> MULTIPLE ZONE <input type="checkbox"/>				6. IF INDIAN, ALLOTTEE OR TRIBE NAME																									
2. NAME OF OPERATOR Phillips Petroleum Company				7. UNIT AGREEMENT NAME San Juan 30-5 Unit																									
3. ADDRESS OF OPERATOR 300 W. Arrington, Suite 200, Farmington, N.M. 87401				8. FARM OR LEASE NAME																									
4. LOCATION OF WELL (Report location clearly and in accordance with any State requirements.) At surface Unit N, 1061' FSL & 1540' FWL At proposed prod. zone Unit N, 1061' FSL & 1540' FWL				9. WELL NO. 212																									
14. DISTANCE IN MILES AND DIRECTION FROM NEAREST TOWN OR POST OFFICE* 30 Miles East From Blanco				10. FIELD AND POOL, OR WILDCAT Basin Fruitland Coal Gas																									
15. DISTANCE FROM PROPOSED* LOCATION TO NEAREST PROPERTY OR LEASE LINE, FT. (Also to nearest drig. unit line, if any) 1540' FWL of 30-5 Unit		16. NO. OF ACRES IN LEASE 320 AC		17. NO. OF ACRES ASSIGNED TO THIS WELL 320 AC W/2 of Section																									
18. DISTANCE FROM PROPOSED LOCATION* TO NEAREST WELL, DRILLING, COMPLETED, OR APPLIED FOR, ON THIS LEASE, FT. 412' NE From #63		19. PROPOSED DEPTH 3462' (±)		20. ROTARY OR CABLE TOOLS Rotary																									
21. ELEVATIONS (Show whether DF, RT, GR, etc.) 6593' (GL Unprepared) This action is subject to technical and procedural review pursuant to 43 CFR 3166.9 and proposed changes to the MUD PROGRAM				22. APPROX. DATE WORK WILL START* Upon Approval																									
23. <table border="1"><thead><tr><th>SIZE OF HOLE</th><th>SIZE OF CASING</th><th>WEIGHT PER FOOT</th><th>SETTING DEPTH</th><th colspan="2">GENERAL QUANTITIES OF CEMENT</th></tr></thead><tbody><tr><td>12-1/4"</td><td>9-5/8"</td><td>36#, K-55</td><td>250'</td><td colspan="2">200 sxs, Circ to Surface</td></tr><tr><td>8-1/2"</td><td>7"</td><td>23#, K-55</td><td>3218'</td><td colspan="2">600 sxs, Circ to Surface</td></tr><tr><td>6-1/8"</td><td>5-1/2"</td><td>15.5# or 23#</td><td>3118'-3462'</td><td colspan="2">*</td></tr></tbody></table>						SIZE OF HOLE	SIZE OF CASING	WEIGHT PER FOOT	SETTING DEPTH	GENERAL QUANTITIES OF CEMENT		12-1/4"	9-5/8"	36#, K-55	250'	200 sxs, Circ to Surface		8-1/2"	7"	23#, K-55	3218'	600 sxs, Circ to Surface		6-1/8"	5-1/2"	15.5# or 23#	3118'-3462'	*	
SIZE OF HOLE	SIZE OF CASING	WEIGHT PER FOOT	SETTING DEPTH	GENERAL QUANTITIES OF CEMENT																									
12-1/4"	9-5/8"	36#, K-55	250'	200 sxs, Circ to Surface																									
8-1/2"	7"	23#, K-55	3218'	600 sxs, Circ to Surface																									
6-1/8"	5-1/2"	15.5# or 23#	3118'-3462'	*																									

\*If the coal is cleated a 5-1/2", 23#, P-110 liner will be run in the open hole without being cemented.

\*If the coal is not cleated a 5-1/2", 15.5#, K-55 liner will be run, cemented with sxs cement and the well fractured.

RECEIVED  
APR 23 1990  
OIL CON. DIV.,  
DIST. 3

Mud Program and BOP Equipment: See Attached

IN ABOVE SPACE DESCRIBE PROPOSED PROGRAM: If proposal is to deepen or plug back, give data on present productive zone and proposed new productive zone. If proposal is to drill or deepen directionally, give pertinent data on subsurface locations and measured and true vertical depths. Give blowout preventer program, if any.

24. SIGNED <u>L.M. Sanders</u> TITLE <u>Supv. Regulatory Affairs</u> DATE <u>March 21, 1990</u>		APPROVED AS AMENDED APR 17 1990 AREA MANAGER
(This space for Federal or State office use)		
PERMIT NO. _____	APPROVAL DATE _____	
APPROVED BY _____	TITLE _____	
CONDITIONS OF APPROVAL, IF ANY:		

REVISED

VIC JAC 14  
L 125

Submit to Appropriate  
District Office  
State Lease - 4 copies  
Fee Lease - 3 copies

State of New Mexico  
Energy, Minerals and Natural Resources Department

Form C-102  
Revised 1-1-89

OIL CONSERVATION DIVISION

P.O. Box 2088  
Santa Fe, New Mexico 87504-2088

DISTRICT I  
P.O. Box 1980, Hobbs, NM 88240

DISTRICT II  
P.O. Drawer DD, Artesia, NM 88210

DISTRICT III  
1000 Rio Brazos Rd., Aztec, NM 87410

WELL LOCATION AND ACREAGE DEDICATION PLAT

All Distances must be from the outer boundaries of the section

Operator <b>PHILLIPS PETROLEUM</b>			Lease <b>SAN JUAN 30-5</b>		Well No. <b>212</b>
Unit Letter <b>N</b>	Section <b>31</b>	Township <b>T.30 N.</b>	Range <b>R.5 W.</b>	County <b>RIO ARriba COUNTY</b>	
Actual Footage Location of Well: <b>1061</b> feet from the <b>SOUTH</b> line and <b>1540</b> feet from the <b>WEST</b> line					
Ground level Elev. <b>6593</b>	Producing Formation <b>Fruitland</b>		Pool <b>Basin Fruitland Coal Gas</b>		Dedicated Acreage: <b>320 Acres</b>

- Outline the acreage dedicated to the subject well by colored pencil or hatchure marks on the plat below.
- If more than one lease is dedicated to the well, outline each and identify the ownership thereof (both as to working interest and royalty).
- If more than one lease of different ownership is dedicated to the well, have the interest of all owners been consolidated by communitization, unitization, force-pooling, etc.?  
☒ Yes ☐ No If answer is "yes" type of consolidation **Unitized**  
If answer is "no" list the owners and tract descriptions which have actually been consolidated. (Use reverse side of this form if necessary.)  
No allowable will be assigned to the well until all interests have been consolidated (by communitization, unitization, forced-pooling, or otherwise) or until a non-standard unit, eliminating such interest, has been approved by the Division.

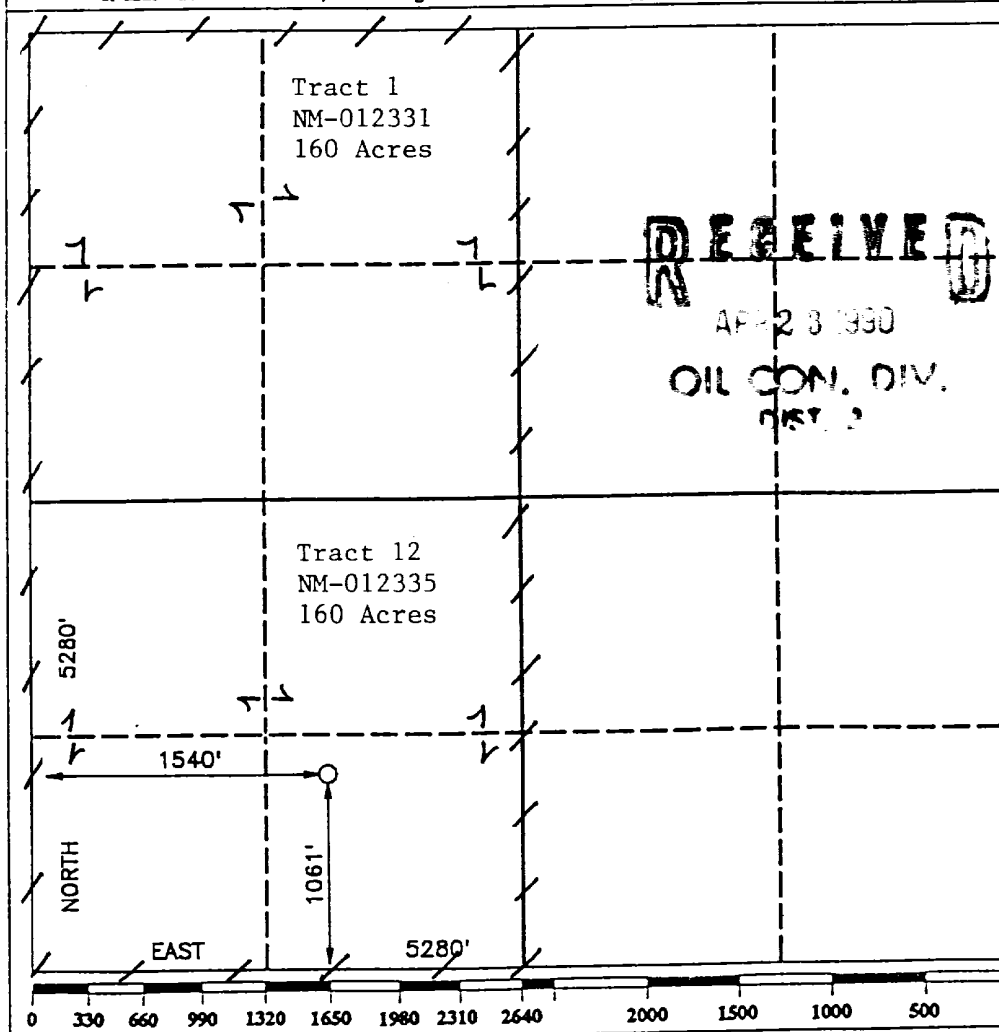

OPERATOR CERTIFICATION

I hereby certify that the information contained herein is true and complete to the best of my knowledge and belief.

Signature  
*L. M. Sanders*  
Printed Name  
**L. M. Sanders**  
Position  
**Supv. Regulatory Affairs**  
Company  
**Phillips Petroleum Co.**  
Date  
**March 21, 1990**

SURVEYOR CERTIFICATION

I hereby certify that the well location shown on this plat was plotted from field notes of actual surveys made by me or under my supervision, and that the same is true and correct to the best of my knowledge and belief.

Date Surveyed  
**FEBRUARY 21, 1990**  
Signature of Professional Surveyor  
*R. Howard Daggett*  
Professional Surveyor  
**8878**  
Certificate No.  
**8878**

Registered Professional  
Land Surveyor

