

UNITED STATES  
DEPARTMENT OF THE INTERIOR  
BUREAU OF LAND MANAGEMENT

APPLICATION FOR PERMIT TO DRILL, DEEEN, OR PLUG BACK

1a. TYPE OF WORK  
 DRILL       DEEEN       PLUG BACK

b. TYPE OF WELL  
 OIL WELL       GAS WELL       OTHER

2. NAME OF OPERATOR  
 Phillips Petroleum Company 17654

3. ADDRESS OF OPERATOR  
 300 W. Arrington, Suite 200, Farmington, N.M. 87401

4. LOCATION OF WELL (Report location clearly and in accordance with any State requirements.)\*  
 At surface Unit M, 1086' FSL & 1015' FWL  
 At proposed prod. zone Unit M, 1086' FSL & 1015' FWL

14. DISTANCE IN MILES AND DIRECTION FROM NEAREST TOWN OR POST OFFICE\*

5. LEASE DESIGNATION AND SERIAL NO.  
 SF-078740

6. IF INDIAN, ALLOTTEE OR TRIBE NAME

7. UNIT AGREEMENT NAME  
 San Juan 30-5 Unit 2458

8. FARM OR LEASE NAME

9. WELL NO.  
 216

10. FIELD AND POOL, OR WILDCAT  
 Basin Fruitland Coal Gas 21629

11. SEC., T., R., M., OR BLK. AND SURVEY OR AREA  
 Sec. 20, T-30-N, R-5-W

12. COUNTY OR PARISH 18. STATE  
 Rio Arriba NM

15. DISTANCE FROM PROPOSED\* LOCATION TO NEAREST PROPERTY OR LEASE LINE, FT. (Also to nearest drig. unit line, if any) 1015' FWL

16. NO. OF ACRES IN LEASE  
~~1400~~ Ac 2560

17. NO. OF ACRES ASSIGNED TO THIS WELL  
 320 Ac W/2 of Section

18. DISTANCE FROM PROPOSED LOCATION\* TO NEAREST WELL, DRILLING, COMPLETED, OR APPLIED FOR, ON THIS LEASE, FT. 125' from #27

19. PROPOSED DEPTH  
 3098'

20. ROTARY OR CABLE TOOLS  
 Rotary

21. ELEVATIONS (Show whether DF, RT, GR, etc.) This action is subject to technical and procedural review pursuant to 43 CFR 3165.3 and appeal pursuant to 43 CFR 3165.4.  
 6275' (GL Unprepared)

22. APPROX. DATE WORK WILL START\*  
 Upon Approval

23. PROPOSED CASING AND CEMENTING PROGRAM DRILLING OPERATIONS AUTHORIZED ARE SUBJECT TO COMPLIANCE WITH ATTACHED "GENERAL REQUIREMENTS"

SIZE OF HOLE	SIZE OF CASING	WEIGHT PER FOOT	SETTING DEPTH	QUANTITY OF CEMENT
12-1/4"	9-5/8"	36#, K-55	250'	250 sxs, Circ to Surface
8-3/4"	7"	23#, K-55	2916'	650 sxs, Circ to Surface
6-1/8"	5-1/2"	15.5# or 23#	2816'-3098'	*

\*If the coal is cleated a 5-1/2", 23#, P-110 liner will be run in the open hole without being cemented.

\*If the coal is not cleated the well will be stimulated and a 5-1/2", 15.5#, J-55 liner will be run without being cemented.

**RECEIVED**  
 JUL 6 1990  
 OIL CON. DIV  
 DIST. ?

Mud Program and BOP Equipment: See Attached

IN ABOVE SPACE DESCRIBE PROPOSED PROGRAM: If proposal is to deepen or plug back, give data on present productive zone and proposed new productive zone. If proposal is to drill or deepen directionally, give pertinent data on subsurface locations and measured and true vertical depths. Give blowout preventer program, if any.

24. SIGNED L.M. Sanders TITLE Supv. Regulatory Affairs DATE 6/1/90

(This space for Federal or State office use)

PERMIT NO. \_\_\_\_\_ APPROVAL DATE JUN 29 1990

APPROVED BY [Signature] TITLE AREA MANAGER

NMOCD

RECEIVED

1953

OFFICE OF THE

SECRETARY

Submit to Appropriate District Office  
 State Lease - 4 copies  
 Fee Lease - 3 copies

State of New Mexico  
 Energy, Minerals and Natural Resources Department

Form C-102  
 Revised 1-1-89

**OIL CONSERVATION DIVISION**

P.O. Box 2088  
 Santa Fe, New Mexico 87504-2088

**DISTRICT I**  
 P.O. Box 1980, Hobbs, NM 88240

**DISTRICT II**  
 P.O. Drawer DD, Artesia, NM 88210

**DISTRICT III**  
 1000 Rio Brazos Rd., Aztec, NM 87410

**WELL LOCATION AND ACREAGE DEDICATION PLAT**  
 All Distances must be from the outer boundaries of the section

Operator <b>PHILLIPS PETROLEUM</b>			Lease <b>SAN JUAN 30-5 UNIT</b>		Well No. <b>216</b>
Unit Letter <b>M</b>	Section <b>20</b>	Township <b>T.30 N.</b>	Range <b>R.5 W.</b>	County <b>RIO ARRIBA COUNTY</b>	
Actual Footage Location of Well: <b>1086</b> feet from the <b>SOUTH</b> line and <b>1015</b> feet from the <b>WEST</b> line					
Ground level Elev. <b>6275</b>	Producing Formation <b>Fruitland</b>		Pool <b>Basin Fruitland Coal</b>	Dedicated Acreage: <b>320</b> Acres	

- Outline the acreage dedicated to the subject well by colored pencil or hachure marks on the plat below.
- If more than one lease is dedicated to the well, outline each and identify the ownership thereof (both as to working interest and royalty).
- If more than one lease of different ownership is dedicated to the well, have the interest of all owners been consolidated by communitization, unitization, force-pooling, etc.?
 

Yes     No    If answer is "yes" type of consolidation Unitization

If answer is "no" list the owners and tract descriptions which have actually been consolidated. (Use reverse side of this form if necessary.)

No allowable will be assigned to the well until all interests have been consolidated (by communitization, unitization, forced-pooling, or otherwise) or until a non-standard unit, eliminating such interest, has been approved by the Division.

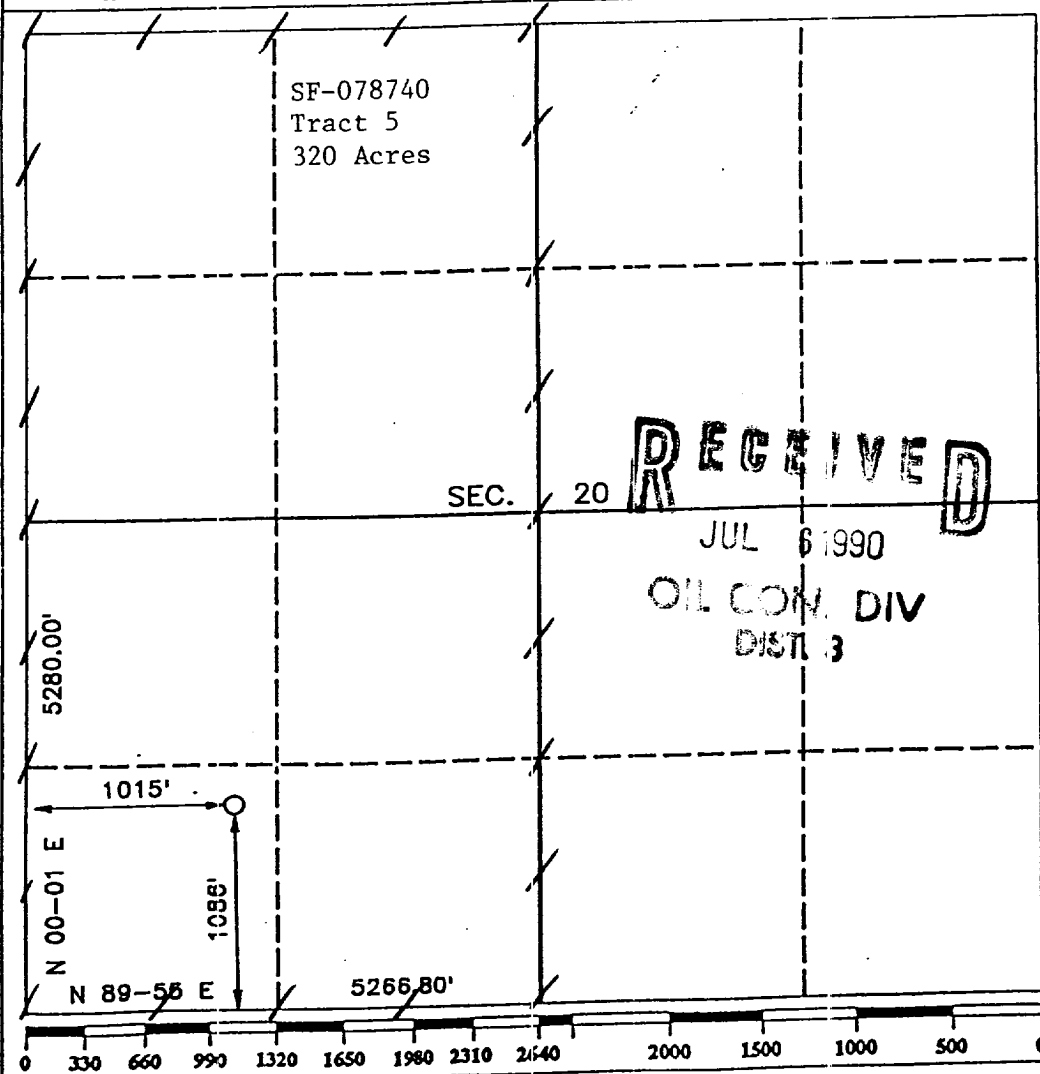

**OPERATOR CERTIFICATION**  
 I hereby certify that the information contained herein is true and complete to the best of my knowledge and belief.

Signature: *L.M. Sanders*  
 Printed Name: **L.M. Sanders**

Position: **Supv. Regulatory Affairs**  
 Company: **Phillips Petroleum Co.**

Date: *6/1/90*

---

**SURVEYOR CERTIFICATION**  
 I hereby certify that the well location shown on this plat was plotted from field notes of actual surveys made by me or under my supervision, and that the same is true and correct to the best of my knowledge and belief.

Date Surveyed: *APR 12 1990*

Signature & Seal of Professional Surveyor: *R. Howard Daggett*  
**R. HOWARD DAGGETT**  
 9879  
 NEW MEXICO PROFESSIONAL LAND SURVEYORS

Certificate No. **9879**

Registered Professional Land Surveyor

