

30-039-24868

UNITED STATES  
DEPARTMENT OF THE INTERIOR  
BUREAU OF LAND MANAGEMENT

APPLICATION FOR PERMIT TO DRILL, DEEPEN, OR PLUG BACK

1a. TYPE OF WORK DRILL	5. LEASE NUMBER SF-078741
1b. TYPE OF WELL GAS	6. IF INDIAN, ALL. OR TRIBE NAME
2. OPERATOR EL PASO NATURAL GAS CO.	7. UNIT AGREEMENT NAME SAN JUAN 30-6 UNIT
3. ADDRESS & PHONE NO. OF OPERATOR P O BOX 4289 FARMINGTON, NM 87499	8. FARM OR LEASE NAME SAN JUAN 30-6 UNIT
4. LOCATION OF WELL 1525' FNL 945' FEL	9. WELL NO. 490
10. FIELD, POOL, OR WILDCAT BASIN FRUITLAND COAL	11. SEC. T. R. M OR BLK. G SEC. 25 T30N R06W NMPM
14. DISTANCE IN MILES FROM NEAREST TOWN 6 MILES OF GOVERNADOR	12. COUNTY RIO ARRIBA
	13. STATE NM
15. DISTANCE FROM PROPOSED LOCATION TO NEAREST PROPERTY OR LEASE LINE. 945'	16. ACRES IN LEASE 2328.080
	17. ACRES ASSIGNED TO WELL E 229.56
18. DISTANCE FROM PROPOSED LOCATION TO NEAREST WELL DR. 200'	19. PROPOSED DEPTH 3593'
20. ROTARY OR CABLE TOOLS ROTARY	
21. ELEVATIONS (DF, FT, GR, ETC.) 6648' GL	22. APPROX. DATE WORK WILL START

23. PROPOSED CASING AND CEMENTING PROGRAM

\*SEE OPERATIONS

RECEIVED

24. AUTHORIZED BY: *[Signature]* AUG 13 1990  
REG. DRILLING ENGR OIL CON. DIV.  
DIST. 3

7/27/90  
DATE

PERMIT NO. \_\_\_\_\_ APPROVAL DATE \_\_\_\_\_  
APPROVED BY \_\_\_\_\_ TITLE \_\_\_\_\_ DATE \_\_\_\_\_

NOTE: THIS FORMAT IS ISSUED IN LIEU OF US BLM FORM 3160-3  
NMOC

30-039-24868

# OIL CONSERVATION DIVISION

P.O. Box 2088

Santa Fe, New Mexico 87504-2088

DISTRICT I  
P.O. Box 1980, Hobbs, NM 88240

DISTRICT II  
P.O. Drawer DD, Artesia, NM 88210

DISTRICT III  
1000 Rio Brazos Rd., Aztec, NM 87410

## WELL LOCATION AND ACREAGE DEDICATION PLAT

All Distances must be from the outer boundaries of the section

Operator <u>El Paso Natural Gas</u>	Lease (SF-078741) <u>San Juan 30-6 Unit</u>	Well No. <u>490</u>
Unit Letter <u>G</u>	Section <u>25</u>	Township <u>30 North</u>
	Range <u>6 West</u>	County <u>NMPM</u>
		<u>Rio Arriba</u>
Actual Footage Location of Well: <u>1525</u> feet from the <u>North</u> line and <u>945</u> feet from the <u>East</u> line		
Ground level Elev. <u>6648'</u>	Producing Formation <u>Fruitland Coal</u>	Pool <u>Basin</u>
		Dedicated Acreage: <u>229.56</u> Acres

1. Outline the acreage dedicated to the subject well by colored pencil or hatchure marks on the plat below.

2. If more than one lease is dedicated to the well, outline each and identify the ownership thereof (both as to working interest and royalty).

3. If more than one lease of different ownership is dedicated to the well, have the interest of all owners been consolidated by communitization, unitization, force-pooling, etc.?

☒ Yes ☐ No If answer is "yes" type of consolidation unitization

If answer is "no" list the owners and tract descriptions which have actually been consolidated. (Use reverse side of this form if necessary.)

No allowable will be assigned to the well until all interests have been consolidated (by communitization, unitization, forced-pooling, or otherwise) or until a non-standard unit, eliminating such interest, has been approved by the Division.

4530.90'

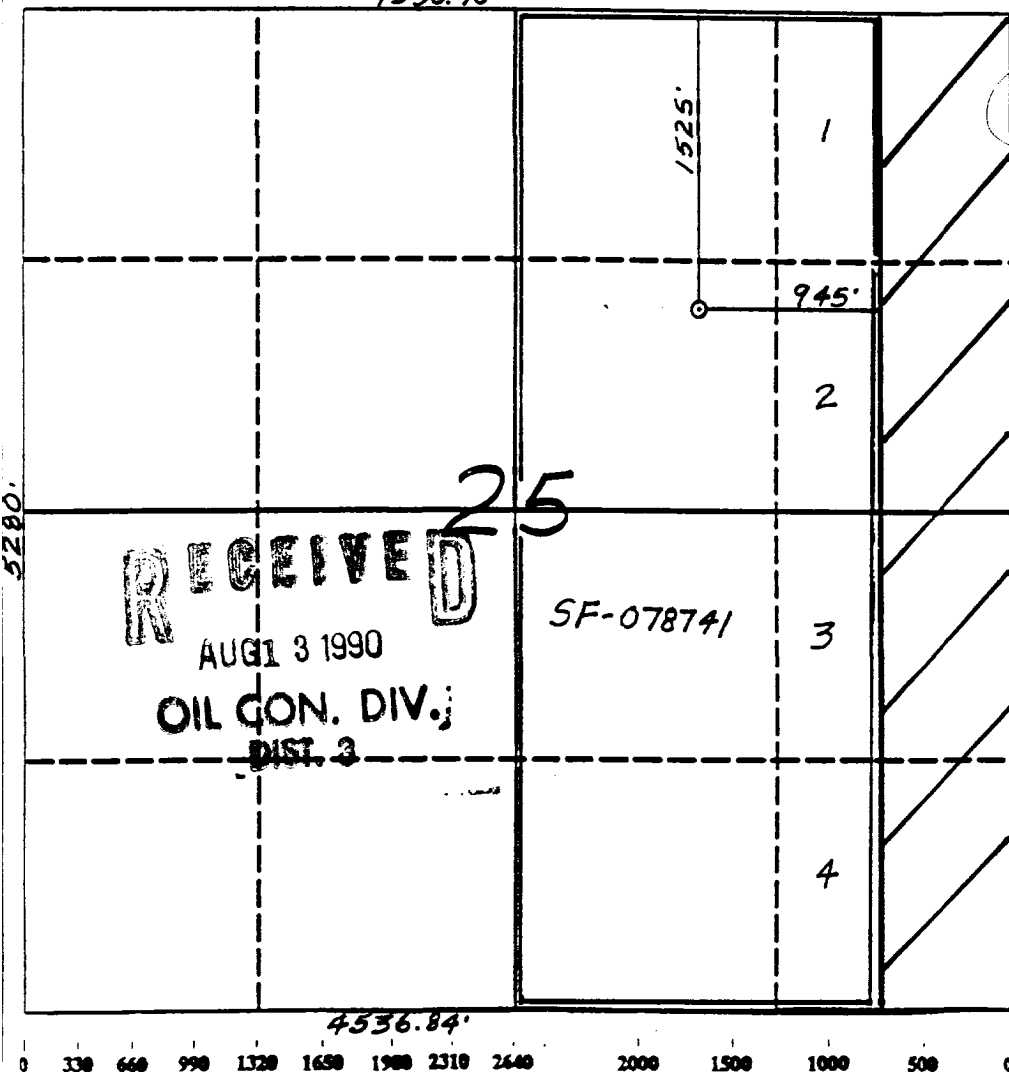

### OPERATOR CERTIFICATION

I hereby certify that the information contained herein is true and complete to the best of my knowledge and belief.

Signature

Peggy Bradfield

Printed Name

Regulatory Affairs

Position

El Paso Natural Gas

Company

7-27-90

Date

### SURVEYOR CERTIFICATION

I hereby certify that the well location shown on this plat was plotted from field notes of actual surveys made by me or under my supervision, and that the same is true and correct to the best of my knowledge and belief.

5-25-90

Date Surveyed

Signature  
Professional Surveyor

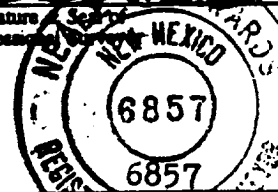

Certificate No.

Neale C. Edwards

Well Name: 490 SAN JUAN 30-6 UNIT 1525'FNL 945'FEL  
Sec. 25 T30N R06W RIO ARRIBA NEW MEXICO  
BASIN FRUITLAND COAL Elevation 6648'GL

Formation tops: Surface- SAN JOSE  
Ojo Alamo- 2735  
Kirtland- 2845  
Fruitland- 3255  
Fruitland Coal Top- 3375 Intermediate TD- 3365  
Fruitland Coal Base- 3476 Total Depth- 3593  
Pictured Cliffs- 3603

Logging Program: Mud logs from intermediate to total depth.

Mud Program:	Interval	Type	Weight	Visc.	Fl. Loss
	0 - 500	Spud	8.4 - 8.9	40-50	no control
	500 - 3365	Non-dispersed	8.4 - 9.1	30-60	no control
	3365 - 3593	Formation Water	8.4		no control

Casing Program:	Hole Size	Depth Interval	Csg. Size	Weight	Grade
	12 1/4"	0 - 500	9 5/8"	32.3#	H-40
	8 3/4"	0 - 3365	7"	20.0#	K-55
	6 1/4"	3315 - 3593	5 1/2"	15.5#	K-55
Tubing Program:		0 - 3593	2 7/8"	6.5#	J-55

Float Equipment: 9 5/8" surface casing - saw tooth guide shoe. Centralizers will be run in accordance with Onshore Order #2.

7" intermediate casing - guide shoe and self-fill insert float valve. Three centralizers run every other joint above shoe. Run insert float one joint above the guide shoe. Two turbolizing type centralizers - one below and one into the base of the Ojo Alamo @ 2845'. Standard centralizers thereafter every fourth joint up to the base of the surface pipe.

5 1/2" production casing - float shoe on bottom and a pre-drilled liner run to the 7" casing with a minimum 50' overlap. Liner hanger is a double slip grip type.

Wellhead Equipment: 9 5/8" x 7" x 2 7/8" x 11" 3000 psi xmas tree assembly.

#### Cementing:

9 5/8" surface casing - cement with 399 sacks of class "B" cement with 1/4# flocele/sack and 3% calcium chloride (470 cu ft. of slurry, 200% excess to circulate to surface). WOC 12 hours. Test casing to 1000 psi for 30 minutes.

7" intermediate casing - lead with 502 sacks of 65/35 class "B" poz with 6% gel, 2% calcium chloride and 1/2 cu ft. Perlite/sack (10.3 gallons of water/sack) tail with 100 sacks of class "B" with 2% calcium chloride. 1088 cu ft. of slurry, 110% excess to circulate to surface. If hole conditions permit, a 600 ft spacer will be run ahead of the cement slurry to avoid mud contamination of the cement. WOC 12 hours. If cement does not circulate to surface, a temperature log will be run after 8 hours to determine TOC.

5 1/2" liner - do not cement.

San Juan 30-6 Unit #490  
T 30N, R 6W

400' New Construction  
11,600' existing BLM roads  
located within Unit  
boundaries  
MAP 1

