

UNITED STATES
DEPARTMENT OF THE INTERIOR
BUREAU OF LAND MANAGEMENT

RECEIVED
BLM

30-039-25424

APPLICATION FOR PERMIT TO DRILL, DEEPEN, OR PLUG BACK

JUN 13 1994 -6 AM 9:40

1a. Type of Work DRILL	RECEIVED JUN 15 1994	5. Lease Number 7470	6. If Indian, All. or Tribe FARMINGTON, NM NM 012223	
1b. Type of Well GAS		7. Unit Agreement Name San Juan 30-6 Unit		
2. Operator MERIDIAN OIL 14538	OIL CON. DIV. DIST. 3		8. Farm or Lease Name 7470 San Juan 30-6 Unit	
3. Address & Phone No. of Operator PO Box 4289, Farmington, NM 87499 (505) 326-9700	9. Well Number 71A		10. Field, Pool, Wildcat 72319 Blanco Mesa Verde/ 71599 Basin Dakota	
4. Location of Well 1850' FSL, 1650' FEL Latitude 37° 48' 37", Longitude 108° 31' 06"	11. Sec., Twn, Rge, Mer. J Sec 13, T-30-N, R-7-W NMPM		12. County Rio Arriba	
14. Distance in Miles from Nearest Town 11 miles to Navajo Dam	13. State NM		15. Distance from Proposed Location to Nearest Property or Lease Line 1650'	
16. Acres in Lease	17. Acres Assigned to Well MV 320 E/2; 320 S/2 DK 320 S/2		18. Distance from Proposed Location to Nearest Well, Drig, Compl, or Applied for on this Lease 1500'	
19. Proposed Depth 7715'	20. Rotary or Cable Tools Rotary		21. Elevations (DF, FT, GR, Etc.) 6228' GR	
23. Proposed Casing and Cementing Program See Operations Plan attached This action is subject to technical and procedural review pursuant to 43 CFR 2186.3 and appeal pursuant to 43 CFR 3186.4	22. Approx. Date Work will Start 2nd quarter 1994		DRILLING OPERATIONS AUTHORIZED ARE SUBJECT TO COMPLIANCE WITH ATTACHED "GENERAL REQUIREMENTS"	
24. Authorized by: <u>Walden</u> Regional Drilling Engineer	Date 6/3/94			

PERMIT NO. _____ APPROVAL DATE _____
APPROVED BY ok TITLE _____ DATE _____

**APPROVED
AS AMENDED**

Archaeological Report to be submitted
Threatened and Endangered Species Report to be submitted
NOTE: This format is issued in lieu of U.S. BLM Form 3160-3

NMOC

JUN 13 1994
Walden
DISTRICT MANAGER

District I
 PO Box 1980, Hobbs, NM 88241-1980
 District II
 PO Drawer DD, Artesia, NM 88211-0719
 District III
 1000 Rio Brazos Rd., Aztec, NM 87410
 District IV
 PO Box 2088, Santa Fe, NM 87504-2088

State of New Mexico
 Energy, Minerals & Natural Resources Department

Form C-102
 Revised February 21, 1994

OIL CONSERVATION DIVISION
 PO Box 2088
 Santa Fe, NM 87504-2088

Submit to Appropriate District Office
 State Lease - 4 Copies
 Fee Lease - 3 Copies

RECEIVED
 JUN -6 AM 9:40
 AMENDED REPORT

WELL LOCATION AND ACREAGE DEDICATION PLAT

¹ API Number 30-039-	² Pool Code 72319/71599	³ Property Name Blanco Mesa Verde/Basin Dakota E/320
⁴ Property Code	⁵ Property Name San Juan 30-6 Unit	⁶ Well Number 71 A
⁷ GRID No. 14538	⁸ Operator Name MERIDIAN OIL INC.	⁹ Elevation 6228'

¹⁰ Surface Location

UL or lot no.	Section	Township	Range	Lot Idn	Feet from the	North/South line	Feet from the	East/West line	County
J	13	30 N	7 W		1850	South	1650	East	R.A.

¹¹ Bottom Hole Location If Different From Surface

UL or lot no.	Section	Township	Range	Lot Idn	Feet from the	North/South line	Feet from the	East/West line	County

¹² Dedicated Acres 320	¹³ Joint or Infill infill	¹⁴ Consolidation Code	¹⁵ Order No.
--------------------------------------	---	----------------------------------	-------------------------

NO ALLOWABLE WILL BE ASSIGNED TO THIS COMPLETION UNTIL ALL INTERESTS HAVE BEEN CONSOLIDATED OR A NON-STANDARD UNIT HAS BEEN APPROVED BY THE DIVISION

<p>16</p> <p>RECEIVED JUN 15 1994 OIL CON. DIV. DIST. 3</p>		<p>17 OPERATOR CERTIFICATION</p> <p>I hereby certify that the information contained herein is true and complete to the best of my knowledge and belief</p> <p><i>Peggy Bradfield</i> Signature Peggy Bradfield Printed Name Regulatory Representative Title 5-27-94 Date</p>
		<p>18 SURVEYOR CERTIFICATION</p> <p>I hereby certify that the well location shown on this plat was plotted from field notes of actual surveys made by me or under my supervision, and that the same is true and correct to the best of my belief.</p> <p>4-7-94 Date of Survey Signature and Seal of Professional Surveyor 6857 Certificate Number</p>

OPERATIONS PLAN

Well Name: San Juan 30-6 Unit #71A
Location: 1850'FSL, 1650'FEL Section 13, T-30-N, R-7-W
 Rio Arriba County, NM
 Latitude 37° 48' 37", Longitude 108° 31' 06"
Formation: Blanco Mesa Verde/Basin Dakota
Elevation: 6228'GL

<u>Formation Tops:</u>	<u>Top</u>	<u>Bottom</u>	<u>Contents</u>
Surface	San Jose	2197'	
Ojo Alamo	2197'	2298'	aquifer
Kirtland	2298'	2836'	
Fruitland	2836'	3176'	gas
Pictured Cliffs	3176'	3376'	gas
Lewis	3376'	3846'	
Intermediate TD	3600'		
Huerfanito Bentonite	3846'		gas
Mesa Verde	3846'	5041'	gas
Massive Cliff House	5041'	5068'	gas
Menefee	5068'	5368'	gas
Point Lookout	5368'	5806'	gas
Mancos	5806'	7361'	
Greenhorn	7361'	7415'	
Graneros	7415'	7585'	
Dakota	7585'	7715'	gas
Total Depth	7715'		

Logging Program:

Openhole Wireline Logging -
 DIL/LDT/CNL/Temp/NGT/GR/CAL/FMS

Mud Program:

<u>Interval</u>	<u>Type</u>	<u>Weight</u>	<u>Vis.</u>	<u>Fluid Loss</u>
0- 300'	Spud	8.4-8.9	40-50	no control
300-3600'	LSND	8.4-9.1	30-60	no control
3600-7715'	Gas	n/a	n/a	n/a

Pit levels will be visually monitored to detect gain or loss of fluid control.

Casing Program:

<u>Hole Size</u>	<u>Depth Interval</u>	<u>Csg. Size</u>	<u>Wt.</u>	<u>Grade</u>
14 3/4"	0' - 300'	10 3/4"	40.5#	K-55
9 7/8"	0' - 3600'	7 5/8"	26.4#	K-55
	75/8" stage tool @ 2800'			
6 3/4"	3450' - 7715'	5 1/2"	15.5#	K-55

Tubing Program:

0' - 5806'	2"	coiled tubing
0' - 7715'	2"	coiled tubing

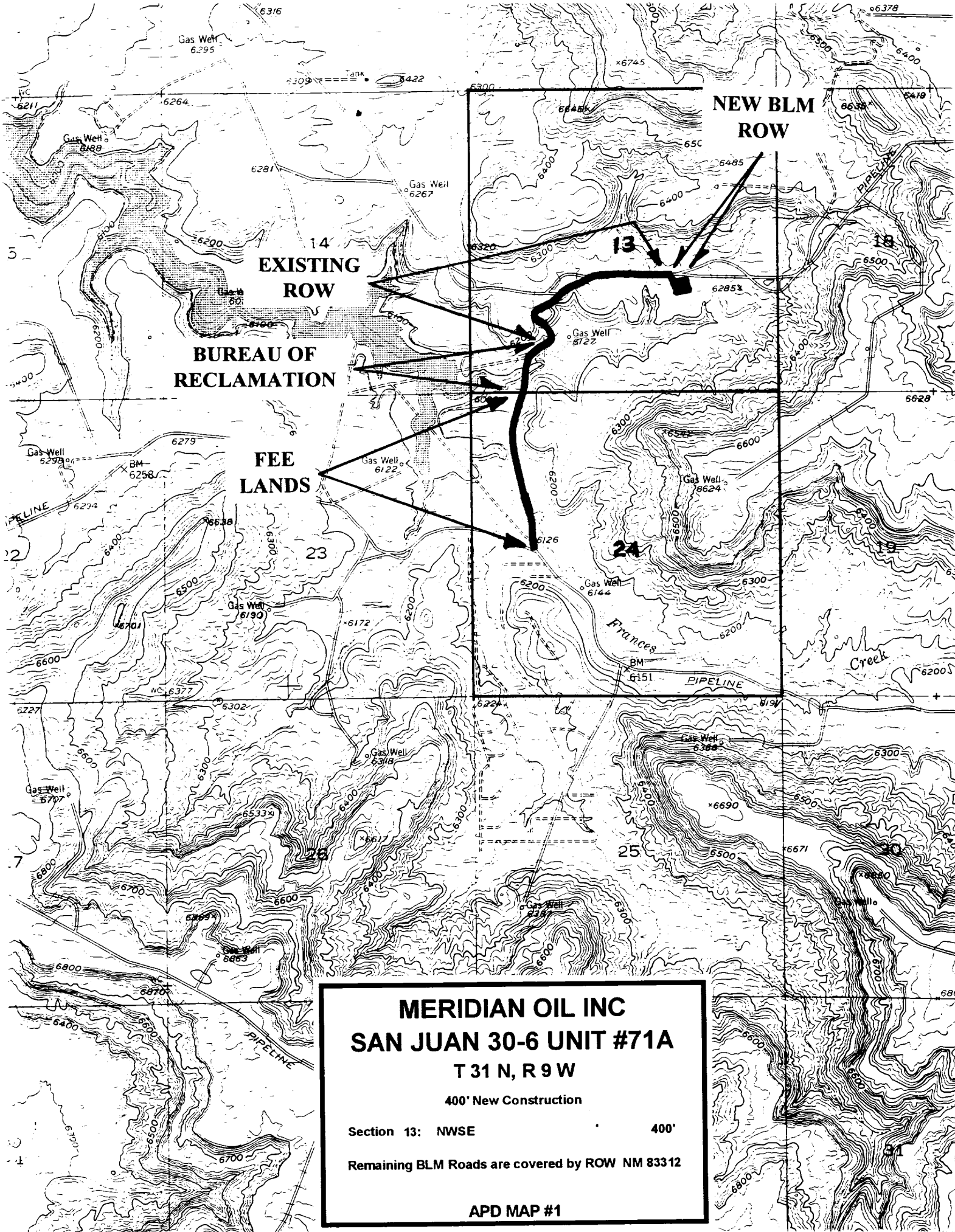

MERIDIAN OIL INC
SAN JUAN 30-6 UNIT #71A
T 31 N, R 9 W
400' New Construction
Section 13: NWSE 400'
Remaining BLM Roads are covered by ROW NM 83312
APD MAP #1