

UNITED STATES
DEPARTMENT OF THE INTERIOR
BUREAU OF LAND MANAGEMENT

APPLICATION FOR PERMIT TO DRILL, DEEPEN, OR PLUG BACK

1a. Type of Work DRILL	5. Lease Number SF-079002 Unit Reporting Number
1b. Type of Well GAS	6. If Indian, All. or Tribe
2. Operator BURLINGTON RESOURCES Oil & Gas Company	7. Unit Agreement Name San Juan 30-6 Unit
3. Address & Phone No. of Operator PO Box 4289, Farmington, NM 87499 (505) 326-9700	8. Farm or Lease Name San Juan 30-6 Unit 9. Well Number 137
4. Location of Well 930' FSL, 1025' FEL Latitude 36° 49.3, Longitude 107° 28.8	10. Field, Pool, Wildcat Gobernador Wildcat Pictured Cliffs ext 11. Sec., Twn, Rge, Mer. (NMPM) Sec. 8, T-30-N, R-6-W API # 30-039- 26335
14. Distance in Miles from Nearest Town 10 miles from Gobernador	12. County Rio Arriba
15. Distance from Proposed Location to Nearest Property or Lease Line 930'	13. State NM
16. Acres in Lease	17. Acres Assigned to Well 160
18. Distance from Proposed Location to Nearest Well, Drig, Compl, or Applied for on this Lease 75'	
19. Proposed Depth 3400'	20. Rotary or Cable Tools Rotary
21. Elevations (DF, FT, GR, Etc.) 6260' GR	22. Approx. Date Work will Start
23. Proposed Casing and Cementing Program See Operations Plan attached	DRILLING OPERATIONS AUTHORIZED ARE SUBJECT TO COMPLIANCE WITH ATTACHED "GENERAL REQUIREMENTS"
24. Authorized by: <u><i>Juan Cal</i></u> Regulatory/Compliance Administrator	<u>1-6-00</u> Date

PERMIT NO. _____ APPROVAL DATE _____
APPROVED BY /s/ Charlie Beecham TITLE _____ DATE _____

Archaeological Report to be submitted

Threatened and Endangered Species Report to be submitted

NOTE: This format is issued in lieu of U.S. BLM Form 3160-3

Title 18 U.S.C. Section 1001, makes it a crime for any person knowingly and willfully to make to any department or agency of the United States any false, fictitious or fraudulent statements or presentations as to any matter within its jurisdiction.

NMOCD

District I
PO Box 1980, Hobbs, NM 88241-1980

District II
PO Drawer DD, Artesia, NM 88211-0719

District III
1000 Rio Brazos Rd., Aztec, NM 87410

District IV
PO Box 2088, Santa Fe, NM 87504-2088

State of New Mexico
Energy, Minerals & Natural Resources Department

OIL CONSERVATION DIVISION
PO Box 2088, Santa Fe, NM 87504-2088

Form C-102
Revised February 21, 1994
Instructions on back
Submit to Appropriate District Office
State Lease - 4 Copies
Fee Lease - 3 Copies

☐ AMENDED REPORT

WELL LOCATION AND ACREAGE DEDICATION PLAT

API Number 30-039- <i>26335</i>	Pool Code <i>77440</i>	Pool Name <i>Gobernador -</i> <i>WC-T30NR6W8</i> Pictured Cliffs <i>ekt</i>
Property Code 7469	Property Name SAN JUAN 30-6 UNIT	
OGRID No. 14538	Operator Name BURLINGTON RESOURCES OIL & GAS COMPANY	Well Number 137
		Elevation 6260'

10 Surface Location

UL or lot no.	Section	Township	Range	Lot Idn	Feet from the	North/South line	Feet from the	East/West line	County
P	8	30N	6W		930	SOUTH	1025	EAST	RIO ARriba

11 Bottom Hole Location If Different From Surface

UL or lot no.	Section	Township	Range	Lot Idn	Feet from the	North/South line	Feet from the	East/West line	County
Dedicated Acres E/320		Joint or Infill		Consolidation Code		Order No. 160 acres for density purposes for the P.C. 320 acres for revenue purposes for the P.C.			

NO ALLOWABLE WILL BE ASSIGNED TO THIS COMPLETION UNTIL ALL INTERESTS HAVE BEEN CONSOLIDATED
OR A NON-STANDARD UNIT HAS BEEN APPROVED BY THE DIVISION

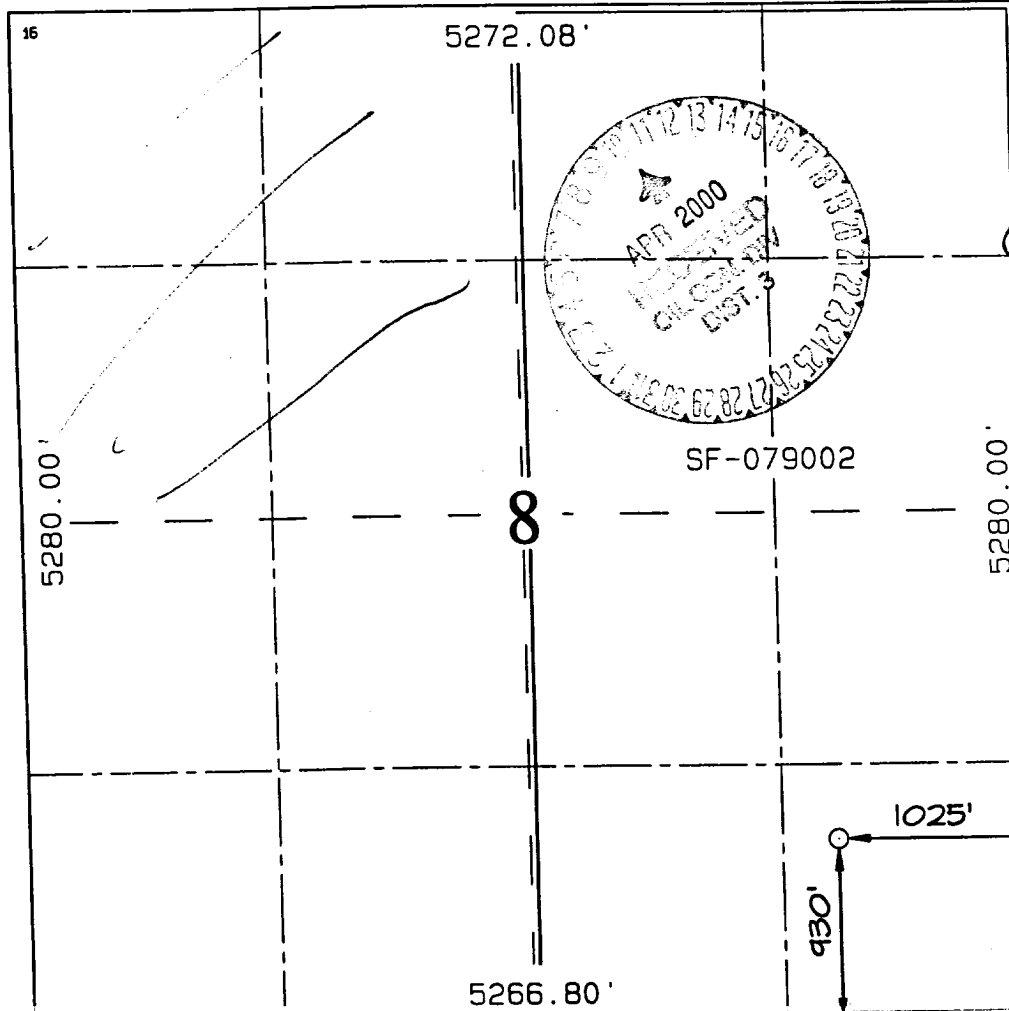

17 OPERATOR CERTIFICATION

I hereby certify that the information contained herein is true and complete to the best of my knowledge and belief.

Peggy Cole
Signature
Peggy Cole
Printed Name
Regulatory Administrator
Title
1-6-00
Date

18 SURVEYOR CERTIFICATION

I hereby certify that the well location shown on this plat was plotted from field notes of actual surveys made by me or under my supervision, and that the same is true and correct to the best of my belief.

DECEMBER 7, 1999

Date of Survey
Signature and Seal of Surveyor

NEALE C. EDWARDS
Signature
NEALE C. EDWARDS
NEW MEXICO
6857
Professional Surveyor
Certificate No. 6857

OPERATIONS PLAN

Well Name: San Juan 30-6 Unit #137
Location: 930' FSL, 1025' FEL, Section 8, T-30-N, R-6-W
Rio Arriba County, New Mexico
Latitude 36° 49.3, Longitude 107° 28.8
Formation: Wildcat Pictured Cliffs
Elevation: 6260' GL

Formation:	Top	Bottom	Contents
Surface	San Jose	2180'	
Ojo Alamo	2180'	2380'	aquifer
Kirtland	2380'	2650'	gas
Fruitland	2650'	3096'	gas
Pictured Cliffs	3096'	3277'	gas
Lewis	3277'		gas
Total Depth	3400'		

Logging Program: 2900' to TD - GR-SP-IND-CNL-CDL-CAL
Surface to TD - GR-SP-IND-CAL

Coring Program: None

Mud Program:

<u>Interval</u>	<u>Type</u>	<u>Weight</u>	<u>Vis.</u>	<u>Fluid Loss</u>
0- 200'	Spud	8.4-9.0	40-50	no control
200-3400'	LSND	8.4-9.0	40-60	no control

Casing Program (as listed, equivalent, or better):

<u>Hole Size</u>	<u>Depth Interval</u>	<u>Csg. Size</u>	<u>Wt.</u>	<u>Grade</u>
12 1/4"	0 - 200'	8 5/8"	24.0#	K-55
7 7/8"	0 - 3400'	4 1/2"	10.5#	K-55

Tubing Program: 2 3/8" 4.7# J-55 to 3400'

Float Equipment: 8 5/8" surface casing - saw tooth guide shoe.
Centralizers will be run in accordance with Onshore Order #2.

4 1/2" production casing - float shoe on bottom. Three centralizers run every other joint above shoe. Seven centralizers run every 3rd joint to the base of the Ojo Alamo @ 2380'. Two turbolizing type centralizers - one below and one into the base of the Ojo Alamo @ 2380'. Standard centralizers thereafter every fourth joint up to the base of the surface pipe.

Wellhead Equipment: 8 5/8" x 4 1/2" 2000 psi screw on independent wellhead.

Cementing:

8 5/8" surface casing - cement with 210 sx Class "B" cement with 1/4# flocele/sx and 3% calcium chloride (248 cu.ft. of slurry, 200% excess to circulate to surface). WOC 8 hrs. Test casing to 600 psi for 30 minutes.

4 1/2" production casing - Lead w/495 sx Class "B" w/3% sodium metasilicate, 1/2 pps cellophane and 7 pps gilsonite. Tail w/90 sx 50/50 Class "B" Poz w/2% gel, 1/2 pps cellophane, 7 pps gilsonite and 2% calcium chloride (1550 cu.ft. of slurry, 100% excess to circulate to surface). WOC 8 hrs. If cement does not circulate to surface, a CBL will be run during completion to determine TOC.

San Juan 30-6 Unit #137

BOP and tests:

Surface to TD - 11" 2000 psi (minimum double gate BOP stack (Reference Figure #1 and #2). Prior to drilling out surface casing, test rams to 600 psi/30 min.

Completion - 6" 2000 psi (minimum) double gate BOP stack (Reference Figure #2). Prior to completion operations, test rams and casing to 2000 psi/15 min.

From surface to TD - choke manifold (Reference Figure #3).

Pipe rams will be actuated to least once each day and blind rams actuated once each trip to test proper functioning. An upper kelly cock valve with handle and drill string safety valves to fit each drill string will be maintained and available on the rig floor.

Additional information:

- * The Pictured Cliffs formation will be completed.
- * Anticipated pore pressure for the Pictured Cliffs is 600 psi.
- * This gas is dedicated.
- * The southeast quarter of Section 8 is dedicated to the Pictured Cliffs.

Redie White
Drilling Engineer

1/11/2000
Date

BOP Configuration 2M psi System

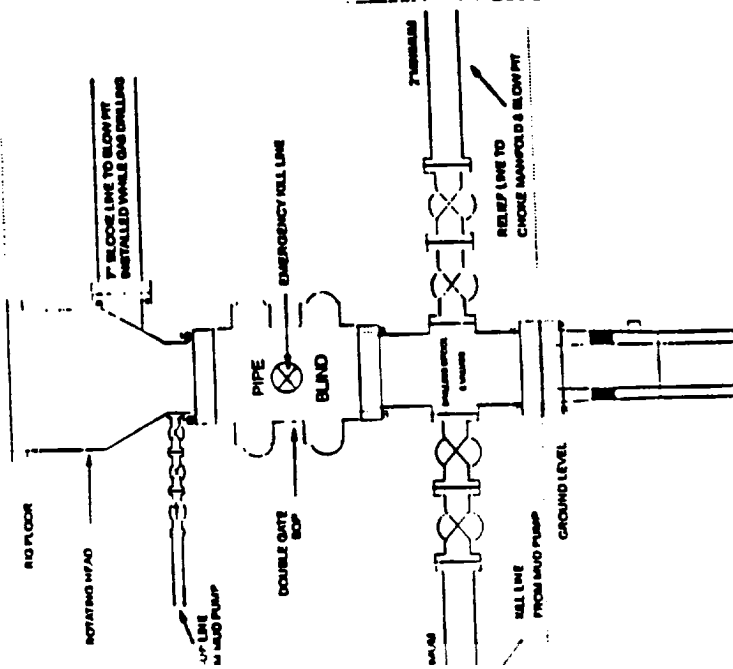

1' Bore, 2000psi minimum working pressure double gate BOP to be equipped with blind and pipe rams. A Schaeffer Type 50 or equivalent rotating head to be installed on the top of the BOP. All equipment is 2000psi working pressure or better.

FIGURE #1

BURLINGTON RESOURCES

BOP Configuration 2M psi System

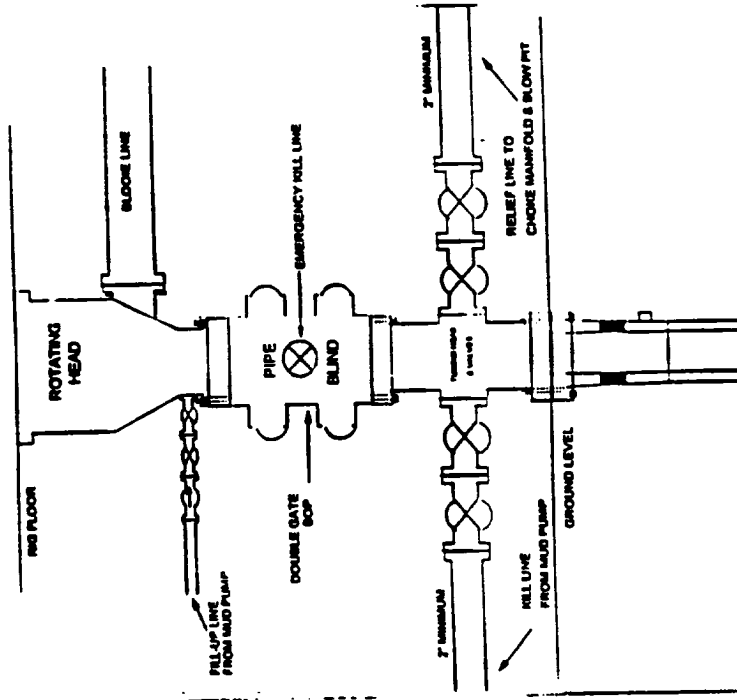

Minimum BOP Installation for Completion operations. 7 1/16" Bore (6" Nominal). 2,000 psi minimum working pressure double gate BOP to be equipped with blind and pipe rams.

FIGURE #2

Choke Manifold Configuration 2M System

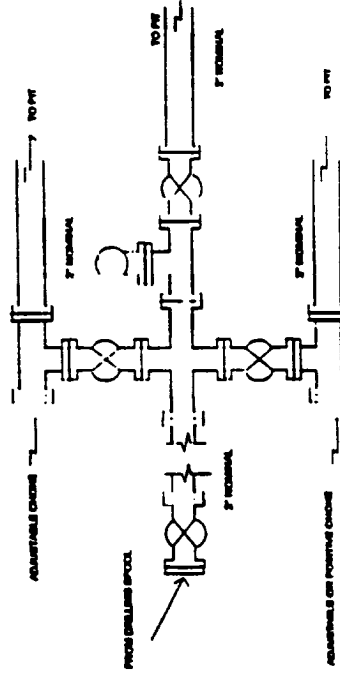

Minimum choke manifold installation from surface to Total Depth. 2" minimum, 2000psi working pressure equipment with two chokes.

Figure #3

BURLINGTON RESOURCES OIL & GAS COMPANY SAN JUAN 30-6 UNIT #137
930' FSL & 1025' FEL, SECTION 8, T30N, R6W, N.M.P.M.
RIO ARriba COUNTY, NEW MEXICO

APD MAP #1

NO NEW CONSTRUCTION
SE/SE SECTION 8, T30N, R6W

