

REVISED
(SUBMIT IN TRIPPLICATE)

UNITED STATES
DEPARTMENT OF THE INTERIOR
GEOLOGICAL SURVEY

Land Office

Lease No. **MN-014378**

Unit

SUNDRY NOTICES AND REPORTS ON WELLS

NOTICE OF INTENTION TO DRILL.....	XX	SUBSEQUENT REPORT OF WATER SHUT-OFF.....	RECEIVED APR 13 1960 U. S. GEOLOGICAL SURVEY FARMINGTON, NEW MEXICO
NOTICE OF INTENTION TO CHANGE PLANS.....		SUBSEQUENT REPORT OF SHOOTING OR ACIDIZING.....	
NOTICE OF INTENTION TO TEST WATER SHUT-OFF.....		SUBSEQUENT REPORT OF ALTERING CASING.....	
NOTICE OF INTENTION TO RE-DRILL OR REPAIR WELL.....		SUBSEQUENT REPORT OF RE-DRILLING OR REPAIR.....	
NOTICE OF INTENTION TO SHOOT OR ACIDIZE.....		SUBSEQUENT REPORT OF ABANDONMENT.....	
NOTICE OF INTENTION TO PULL OR ALTER CASING.....		SUPPLEMENTARY WELL HISTORY.....	
NOTICE OF INTENTION TO ABANDON WELL.....			

(INDICATE ABOVE BY CHECK MARK NATURE OF REPORT, NOTICE, OR OTHER DATA)

Lease No. **163464**H. J. Lee Federal **B****April 11**, 19**60**Well No. **2** is located **1850** ft. from **[N]** line and **2310** ft. from **[E]** line of sec. **23**
NE/4 Sec. 23 **T-29-N** **R-12-W** **NMPN**
 (1/4 Sec. and Sec. No.) (Twp.) (Range) (Meridian)

Wildcat **San Juan** **New Mexico**
 (Field) (County or Subdivision) (State or Territory)
The elevation of the derrick floor above sea level is **5668** ft.

DETAILS OF WORK

(State names of and expected depths to objective sands; show sizes, weights, and lengths of proposed casings; indicate mudlogging jobs, cementing points, and all other important proposed work)

OBJECTIVE FORMATION		SIZE CASING			CASING PROGRAM (approx)	
					Set at	cement
Pictured Cliffs	1678'	13 3/8"	48#	New	300'	300' ex
Ness Verde	2628'	5 1/2"	14#	New	5100'	
Mancos	4423'	5 1/2"	15.5#	New	6410'	315'
Gallup	5460'	* casing to be cemented in two stages with 200 sacks around base of casing and 115 sacks through stage tool set below pictured cliffs formation.				
Greenhorn	6093'					
Dakota	6153'					
Morrison	6403'					
Total Depth	6410'					

**This form 9-331a supersedes one dated April 5, 1960. The casing program has been revised and 320 acres have been assigned to this well.

I understand that this plan of work must receive approval in writing by the Geological Survey before operations may be commenced.

Company **TEXACO Inc.**Address **P. O. Box 3109****Midland, Texas**
 By **J. J. Velten**
J. J. Velten
 Title **Division Civil Engineer**

NEW MEXICO OIL CONSERVATION COMMISSION
WELL LOCATION AND ACREAGE DEDICATION PLAT

FORM C-128
Revised 5/1/57

SEE INSTRUCTIONS FOR COMPLETING THIS FORM ON THE REVERSE SIDE

SECTION A

Operator TEXACO Inc.		Lease H. J. Loe Federal "B"		Well No. 2
Unit Letter G	Section 23	Township 29 North	Range 12 West	County San Juan
Actual Footage Location of Well: 1850 feet from the North line and 2310 feet from the East line Sec. 23				
Ground Level Elev. 5657	Producing Formation Dakota	Pool Wildcat	Dedicated Acreage: 320 Acres	

1. Is the Operator the only owner in the dedicated acreage outlined on the plat below? YES X NO ____ . ("Owner" means the person who has the right to drill into and to produce from any pool and to appropriate the production either for himself or for himself and another. (65-3-29 (e) NMSA 1935 Comp.)
2. If the answer to question one is "no," have the interests of all the owners been consolidated by communitization agreement or otherwise? YES ____ NO ____ . If answer is "yes," Type of Consolidation ____
3. If the answer to question two is "no," list all the owners and their respective interests below:

Owner	Land Description

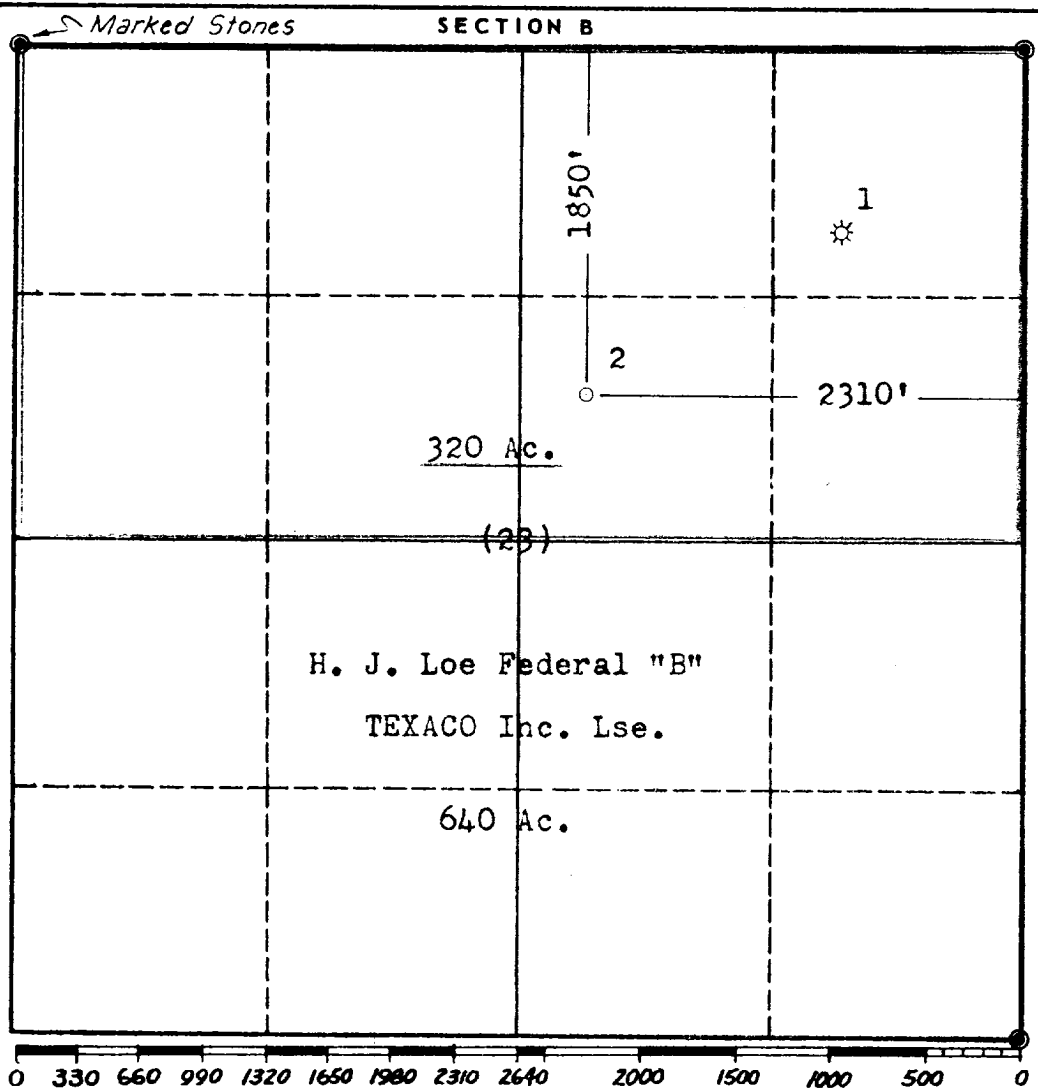
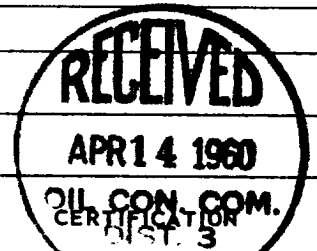

I hereby certify that the information in SECTION A above is true and complete to the best of my knowledge and belief.

Name J. G. Velten
Position Division Civil Engineer
Company TEXACO Inc.
Date 4/8/60

I hereby certify that the well location shown on the plat in SECTION B was plotted from field notes of actual surveys made by me or under my supervision, and that the same is true and correct to the best of my knowledge and belief.

Date Surveyed 4/2/60
Registered Professional Engineer and/or Land Surveyor J. G. Velten
Certificate No. 8174