

(SUBMIT IN TRIPLICATE)

UNITED STATES
DEPARTMENT OF THE INTERIOR
GEOLOGICAL SURVEYLand Office **Santa Fe**
Lease No. **SP-078926**
Unit **Gallegos Canyon Unit**

SUNDRY NOTICES AND REPORTS ON WELLS

NOTICE OF INTENTION TO DRILL	<input checked="" type="checkbox"/>	SUBSEQUENT REPORT OF WATER SHUT-OFF	
NOTICE OF INTENTION TO CHANGE PLANS		SUBSEQUENT REPORT OF SHOOTING OR ACIDIZING	
NOTICE OF INTENTION TO TEST WATER SHUT-OFF		SUBSEQUENT REPORT OF ALTERING CASING	
NOTICE OF INTENTION TO RE-DRILL OR REPAIR WELL		SUBSEQUENT REPORT OF RE-DRILLING OR REPAIR	
NOTICE OF INTENTION TO SHOOT OR ACIDIZE		SUBSEQUENT REPORT OF ABANDONMENT	
NOTICE OF INTENTION TO PULL OR ALTER CASING		SUPPLEMENTARY WELL HISTORY	
NOTICE OF INTENTION TO ABANDON WELL			

(INDICATE ABOVE BY CHECK MARK NATURE OF REPORT, NOTICE, OR OTHER DATA)

Gallegos Canyon Unit

Farmington, New Mexico

April 26, 1961

Well No. **99** is located **550** ft. from **SE** line and **2010** ft. from **W** line of sec. **35**
SE 1/4 SW 1/4 of Section 35 T-29-N R-13-W N.M.P.M.
(1/4 Sec. and Sec. No.) (Twp.) (Range) (Meridian)
Totah Gallup San Juan New Mexico
(Field) (County or Subdivision) (State or Territory)

The elevation of the derrick floor above sea level is _____ ft. (To be reported later)

DETAILS OF WORK

(State names of and expected depths to objective sands; show sizes, weights, and lengths of proposed casings; indicate mudding jobs, cementing points, and all other important proposed work)

We propose to drill the above well to approximately 5900' to test and develop production in Gallup zones. Stimulation will be as indicated upon penetration of Gallup Pay. Rotary tools will be used to total depth. Casing program as follows:

SIZE	DEPTH	CEMENT	REMARKS
8-5/8"	200'	110-160	Heat - Circulate
4-1/2"	5900'	500	Stage tool set 100' below base of Pictured Cliffs formation. First stage cemented with 125 sacks 6 percent gel with 1-1/2 pounds tuf plug per sack followed by 75 sacks neat on bottom. Second stage cemented with 300 sacks 6 percent gel cement.

Copies of location plat attached. Copy of any survey taken will be submitted upon completion of well.

I understand that this plan of work must receive approval in writing by the Geological Survey before operations may be commenced.

Company **Pan American Petroleum Corporation**Address **Box 480****Farmington, New Mexico**Attn: **L. O. Spear, Jr.**

ORIGINAL SIGNED BY

R. M. Bauer, Jr.

By

Title **Senior Petroleum Engineer**

NEW MEXICO OIL CONSERVATION COMMISSION

Well Location and Acreage Dedication Plat

Section A.

Date April 25, 1961

Operator PAN AMERICAN PETROLEUM CORPORATION Lease GALLEGOS CANYON UNIT
 Well No. 99 Unit Letter N Section 35 Township 29 NORTH Range 13 WEST, NMPM
 Located 550 Feet From the SOUTH Line, 2010 Feet From the WEST Line
 County SAN JUAN G. L. Elevation To report later Dedicated Acreage 80 Acres
 Name of Producing Formation Gallup Pool Totah Gallup

1. Is the Operator the only owner in the dedicated acreage outlined on the plat below?
 Yes _____ No X
2. If the answer to question one is "no", have the interests of all the owners been consolidated by communitization agreement or otherwise? Yes X No _____. If answer is "yes", Type of Consolidation, _____
Gallegos Canyon Unit acreage.
3. If the answer to question two is "no", list all the owners and their respective interests below:

Owner

Land Description



Section B.

Note: All distances must be from outer boundaries of section.

This is to certify that the information in Section A above is true and complete to the best of my knowledge and belief.

Pan American Petroleum Corporation

(Operator)

R. M. Bauer, Jr. *RMBauer Jr*

(Representative)

Box 480, Farmington, New Mexico

(Address)

Ref: GLO plat dated 19 April 1881

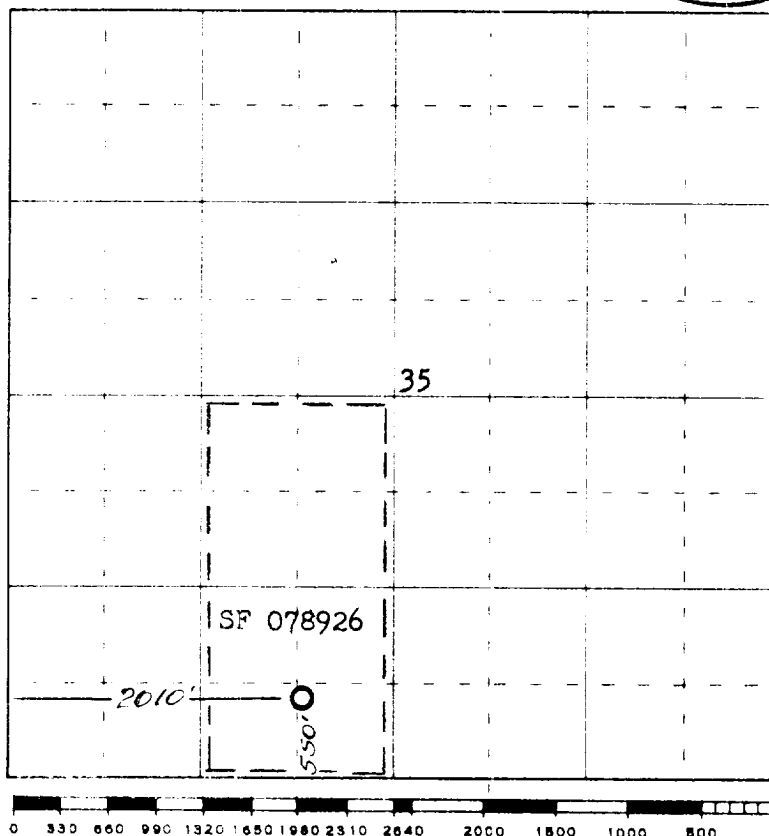

Scale 4 inches equal 1 mile

This is to certify that the above plat was prepared from field notes of actual surveys made by me or under my supervision and that the same are true and correct to the best of my knowledge and belief.

Date Surveyed 22 April 1961

James P. Leese
 Registered Professional Engineer and/or Land Surveyor
 James P. Leese N. Mex. Reg. No. 1463
 San Juan Engineering Company

