

Form 9-581a
(Feb. 1951)

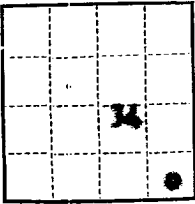

(SUBMIT IN TRIPLICATE)

UNITED STATES
DEPARTMENT OF THE INTERIOR
GEOLOGICAL SURVEY

Land Office Santa Fe
Lease No. 079065
Unit Co. 14-1-1-1

SUNDRY NOTICES AND REPORTS ON WELLS

| | | | |
|--|-------------------------------------|--|--------------------------|
| NOTICE OF INTENTION TO DRILL | <input checked="" type="checkbox"/> | SUBSEQUENT REPORT OF WATER SHUT-OFF | <input type="checkbox"/> |
| NOTICE OF INTENTION TO CHANGE PLANS | <input type="checkbox"/> | SUBSEQUENT REPORT OF SHOOTING OR ACIDIZING | <input type="checkbox"/> |
| NOTICE OF INTENTION TO TEST WATER SHUT-OFF | <input type="checkbox"/> | SUBSEQUENT REPORT OF ALTERING CASING | <input type="checkbox"/> |
| NOTICE OF INTENTION TO RE-DRILL OR REPAIR WELL | <input type="checkbox"/> | SUBSEQUENT REPORT OF RE-DRILLING OR REPAIR | <input type="checkbox"/> |
| NOTICE OF INTENTION TO SHOOT OR ACIDIZE | <input type="checkbox"/> | SUBSEQUENT REPORT OF ABANDONMENT | <input type="checkbox"/> |
| NOTICE OF INTENTION TO PULL OR ALTER CASING | <input type="checkbox"/> | SUPPLEMENTARY WELL HISTORY | <input type="checkbox"/> |
| NOTICE OF INTENTION TO ABANDON WELL | <input type="checkbox"/> | | |

(INDICATE ABOVE BY CHECK MARK NATURE OF REPORT, NOTICE, OR OTHER DATA)

Well No. 1 is located 790 ft. from S line and 790 ft. from E line of sec. 34
34 (Twp.) 13 (Range) 2 (Meridian)
Co. 14-1-1-1 (Field) San Juan County (County or Subdivision) New Mexico (State or Territory)

The elevation of the derrick floor above sea level is _____ ft. to be furnished

DETAILS OF WORK

(State names of and expected depths to objective sands; show sizes, weights, and lengths of proposed casings; indicate mudding jobs, cementing points, and all other important proposed work)

The objective sand is the Flinted Cliffs, estimated at about 1625'.

The proposed casing program: 100' of 6-5/8" cemented to surface
1601' of 4" cemented with 100 sacks

Well will be drilled to top of pay with rotary tools. Pay sand will be drilled with cable tools to a total depth of about 1675' where well will be shot with approximately 150 quarts of nitro glycerine.

I understand that this plan of work must receive approval in writing by the Geological Survey before operations may be commenced.

Company AMCO OIL & GAS COMPANY
Hart Bldg.,
Address Galles 1, Texas

By A. M. Weidert
A. M. Weidert
Title Engineer

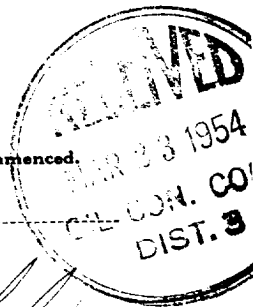

A ZTEC OIL & GAS COMPANY
Company.....~~ASOULTECH OIL & GAS COMPANY~~.....

Lease.....Haygood.....Well No.....1.....

Sec.....34....., T.....29 N....., R.....13 W., N.M.P.M.

Location.....790' from the South line and 790' from
the East line.

Elevation.....

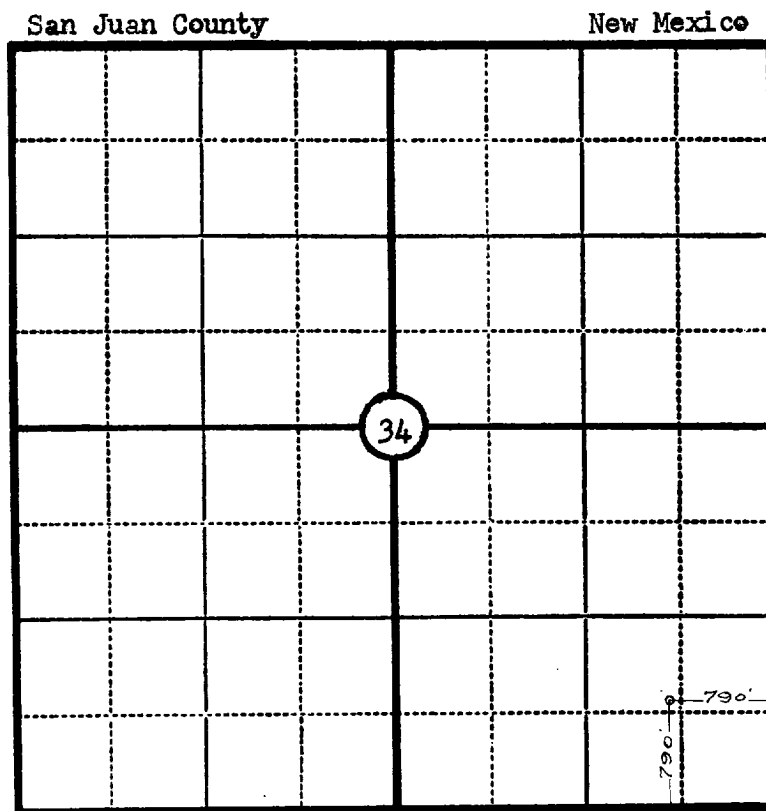

Scale—4 inches equal 1 mile.

This is to certify that the above plat was prepared from field notes of actual surveys made by me or under my supervision and that the same are true and correct to the best of my knowledge and belief.

Seal:

James P. Leese
Registered Professional
Engineer and Land Surveyor.

James P. Leese
N. Mex. Reg. No. 1463

Surveyed26 February....., 1954.....

