

(SUBMIT IN TRIPLICATE)

UNITED STATES  
DEPARTMENT OF THE INTERIOR  
GEOLOGICAL SURVEY

Land Office New Mexico

Lease No. 0702

Unit

SUNDRY NOTICES AND REPORTS ON WELLS

NOTICE OF INTENTION TO DRILL	<input checked="" type="checkbox"/>	SUBSEQUENT REPORT OF WATER SHUT-OFF
NOTICE OF INTENTION TO CHANGE PLANS		SUBSEQUENT REPORT OF SHOOTING OR ACIDIZING
NOTICE OF INTENTION TO TEST WATER SHUT-OFF		SUBSEQUENT REPORT OF ALTERING CASING
NOTICE OF INTENTION TO RE-DRILL OR REPAIR WELL		SUBSEQUENT REPORT OF RE-DRILLING OR REPAIR
NOTICE OF INTENTION TO SHOOT OR ACIDIZE		SUBSEQUENT REPORT OF ABANDONMENT
NOTICE OF INTENTION TO PULL OR ALTER CASING		SUPPLEMENTARY WELL HISTORY
NOTICE OF INTENTION TO ABANDON WELL		

(INDICATE ABOVE BY CHECK MARK NATURE OF REPORT, NOTICE, OR OTHER DATA)

March 12, 1962

Well No. 1-31 is located 1660 ft. from <sup>SW</sup><sub>S</sub> line and 960 ft. from <sup>EX</sup><sub>W</sub> line of sec. 31

SW 31  
(1/4 Sec. and Sec. No.)

29N  
(Twp.)

10W  
(Range)

106W  
(Meridian)

Fulcher Kutz (P.O.)

San Juan  
(County or Subdivision)

New Mexico  
(State or Territory)

Farmington Undesignated

The elevation of the derrick floor above sea level is 5592 ft. GL

DETAILS OF WORK

(State names of and expected depths to objective sands; show sizes, weights, and lengths of proposed casings; indicate mud logging points, and all other important proposed work)

Drill 11" hole to 125' - cement 3 5/8" casing at 125' with 125 sx.  
Circulate cement to surface

Drill 6 3/4" hole to approximately 2000'. Run 4 1/2" casing to TD -  
cement with enough cement to cover Farmington Sand (150 sx.)

Perforate and sand frac either or both the Pictured Cliffs and Farmington sand.

I understand that this plan of work must receive approval in writing by the Geological Survey before operations may be commenced.

Company Consolidated Oil & Gas, Inc.

Address 2112 Tower Building

1700 Broadway

Denver, Colorado

By

Title Chief Engineer

NUMBER OF COPIES RECEIVED	
DISTRIBUTION	
SANTA FE	
F. L. E.	
U. S. G. S.	
LAND OFFICE	
TRANSPORTER	OIL
	GAS
PRODUCTION OFFICE	
OPERATOR	

**NEW MEXICO OIL CONSERVATION COMMISSION**  
**WELL LOCATION AND ACREAGE DEDICATION PLAT**  
 SEE INSTRUCTIONS FOR COMPLETING THIS FORM ON THE REVERSE SIDE

FORM C-128  
 Revised 5/1/57

**SECTION A**

Operator <b>CONSOLIDATED OIL AND GAS, INC.</b>			Lease <b>WAZZ</b>		Well No. <b>2-1-31</b>
Unit Letter <b>L</b>	Section <b>31</b>	Township <b>29 NORTH</b>	Range <b>10 WEST</b>	County <b>SAN JUAN</b>	
Actual Footage Location of Well: <b>1680</b> feet from the <b>SOUTH</b> line and <b>960</b> feet from the <b>WEST</b> line					
Ground Level Elev. <b>5592.0</b>	Producing Formation <b>Pictured Cliffs</b>	Pool <b>Fulcher Kutz</b>		Dedicated Acreage: <b>160</b> Acres	

Ref: GLO plat dated 19 April 1881

1. Is the Operator the only owner in the dedicated acreage outlined on the plat below? YES ☒ NO \_\_\_\_ . ("Owner" means the person who has the right to drill into and to produce from any pool and to appropriate the production either for himself or for himself and another. (65-3-29 (e) NMSA 1935 Comp.)
2. If the answer to question one is "no," have the interests of all the owners been consolidated by communitization agreement or otherwise? YES \_\_\_\_ NO \_\_\_\_ . If answer is "yes," Type of Consolidation \_\_\_\_
3. If the answer to question two is "no," list all the owners and their respective interests below:

Owner	Land Description

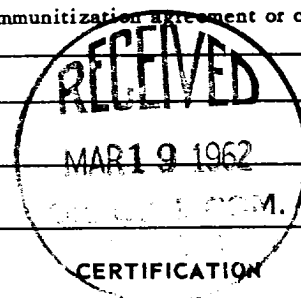

**SECTION B**

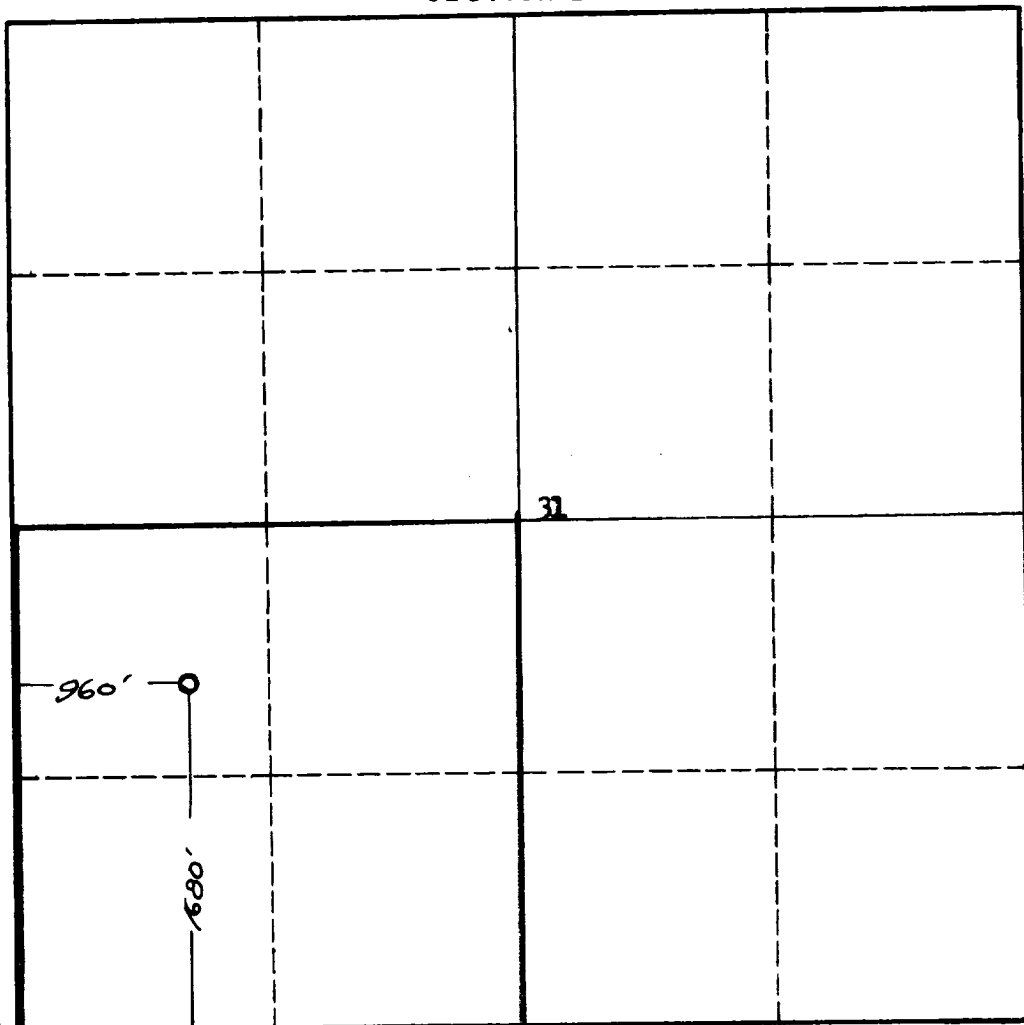

I hereby certify that the information in SECTION A above is true and complete to the best of my knowledge and belief.

Name Seago E. Lano  
 Position  
**Chief Engineer**  
 Company  
**Consolidated Oil & Gas, Inc.**  
 Date  
**March 12, 1962**

I hereby certify that the well location shown on the plat in SECTION B was plotted from field notes of actual surveys made by me or under my supervision, and that the same is true and correct to the best of my knowledge and belief.

Date Surveyed  
**9 March 1962**  
 Registered Professional Engineer and/or Land Surveyor  
James P. Leese  
**James P. Leese**  
 Certificate No. **1463**  
**San Juan Engineering Company**

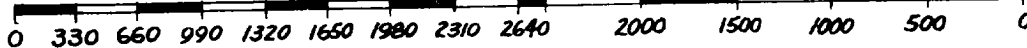

## INSTRUCTIONS FOR COMPLETION OF FORM C-128

1. Operator shall furnish and certify to the information called for in Section A.
2. Operator shall outline the dedicated acreage for *both* oil and gas wells on the plat in Section B.
3. A registered professional engineer or land surveyor registered in the State of New Mexico or approved by the Commission shall show on the plat the location of the well and certify this information in the space provided.
4. All distances shown on the plat must be from the outer boundaries of the Section.
5. If additional space is needed for listing owners and their respective interests as required in question 3 of Section A, please use space below.