



UNITED STATES  
DEPARTMENT OF THE INTERIOR  
GEOLOGICAL SURVEY  
P. O. Box 965  
Farmington, New Mexico

June 24, 1955

Southern Union Gas Company  
Burt Building  
Dallas, Texas

Re: Santa Fe 080724

Gentlemen:

Receipt is acknowledged of your "Notice of Intention to Drill" dated June 21, 1955 covering your well No. 9 Zachry in SE $\frac{1}{4}$  SE $\frac{1}{4}$  sec. 33, T1 29 N., R. 10 W., N. M. P. M., San Juan County, New Mexico, Aztec Pictured Cliffs (ext).

Your proposed work is hereby approved subject to compliance with the provisions of the "Oil and Gas Operating Regulations" revised May 25, 1942, a copy of which will be sent to you on request, and subject to the following conditions:

1. Drilling operations so authorized are subject to the attached sheet for general conditions of approval.
2. Furnish copies of all logs.

Very truly yours,

(Orig. Sgd.) P. T. McGrath

P. T. McGrath  
District Engineer

PTMcGrath:ac

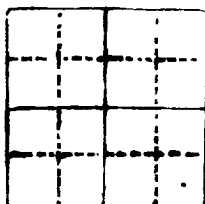

UNITED STATES  
DEPARTMENT OF THE INTERIOR  
GEOLOGICAL SURVEY

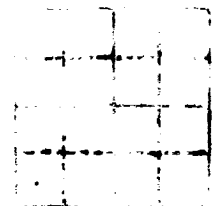

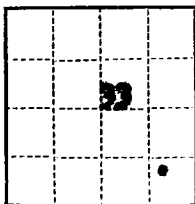

(SUBMIT IN TRIPLICATE)

UNITED STATES  
DEPARTMENT OF THE INTERIOR  
GEOLOGICAL SURVEY

Land Office Santa Fe  
Lease No. 87-80724  
Unit SM Section 33,  
T29N, R10W, E.M.P.M.  
San Juan County, New  
Mexico

SUNDRY NOTICES AND REPORTS ON WELLS

NOTICE OF INTENTION TO DRILL	<input checked="" type="checkbox"/>	SUBSEQUENT REPORT OF WATER SHUT-OFF	
NOTICE OF INTENTION TO CHANGE PLANS		SUBSEQUENT REPORT OF SHOOTING OR ACIDIZING	
NOTICE OF INTENTION TO TEST WATER SHUT-OFF		SUBSEQUENT REPORT OF ALTERING CASING	
NOTICE OF INTENTION TO RE-DRILL OR REPAIR WELL		SUBSEQUENT REPORT OF RE-DRILLING OR REPAIR	
NOTICE OF INTENTION TO SHOOT OR ACIDIZE		SUBSEQUENT REPORT OF ABANDONMENT	
NOTICE OF INTENTION TO PULL OR ALTER CASING		SUPPLEMENTARY WELL HISTORY	
NOTICE OF INTENTION TO ABANDON WELL			

(INDICATE ABOVE BY CHECK MARK NATURE OF REPORT, NOTICE, OR OTHER DATA)

June 21, 1955

Well No. 9 Leachy is located 990 ft. from NE line and 990 ft. from EW line of sec. 33  
SM Section 33 T 29 N R 10 W N. M. P. M.  
(1/4 Sec. and Sec. No.) (Twp.) (Range) (Meridian)  
Astec Pictured Cliffs (Ext) San Juan County New Mexico  
(Field) (County or Subdivision) (State or Territory)

The elevation of the derrick floor above sea level is \_\_\_\_\_ ft. **TO BE DETERMINED**

DETAILS OF WORK

(State names of and expected depths to objective sands; show sizes, weights, and lengths of proposed casings; indicate mudding jobs, cementing points, and all other important proposed work)

Objective sand is the Pictured Cliffs formation anticipated at approximately 2000'.

Proposed Casing Program: 100' 9 5/8" J-55 Cemented to Surface.  
2000' 9 5/8" J-55 Cemented with 100 Sacks.

Rotary tools will be employed from surface to top of Pictured Cliffs formation.

Cable tools will be employed from top of Pictured Cliffs to Total Depth.

The well will be sandoil fraced in an effort to stimulate

Estimated T D 2075'

I understand that this plan of work must receive approval in writing by the Geological Survey before operations may be commenced.

Company SOUTHERN UNION GAS COMPANY

Address BURT BUILDING

DALLAS, TEXAS

By Lawrence J. McNeill

Title Jr. Petroleum Engineer



Company Southern Union Gas Co.

Lease ~~LEASE~~

Well No. ~~49~~

Sec. 33 T. 29 N. R. 10 W. N.W.P.M.

Location 990 feet from south line; 990 feet  
from east line; being in the NW  $\frac{1}{4}$  SE  $\frac{1}{4}$  SE  $\frac{1}{4}$

Elevation:

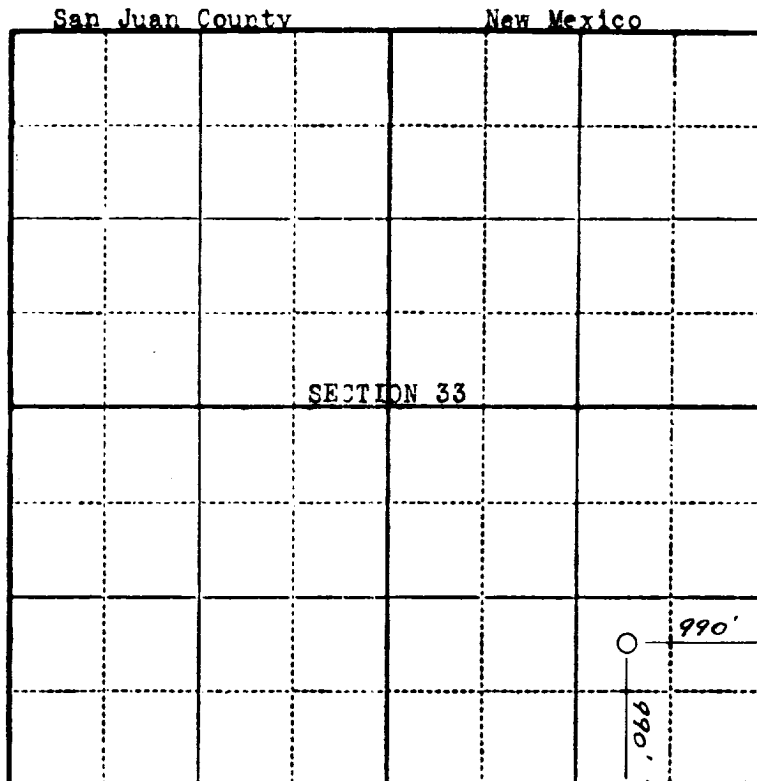

RECEIVED  
JUN 24 1955  
U.S. GEOLOGICAL SURVEY  
FARMINGTON, NEW MEXICO

Scale—4 inches equal 1 mile.

This is to certify that the above plat was prepared from field notes of actual surveys made by me or under my supervision and that the same are true and correct to the best of my knowledge and belief.

*Stephen H. Kinney*  
STEPHEN H. KINNEY  
Registered Professional  
Engineer and Land Surveyor

Surveyed. June 11, 1955

Seal:

