

District I
P.O. Box 1980, Hobbs, NM 88240

District II
P.O. Drawer DD, Artesia, NM 88221

District III
1000 Rio Brazos Rd., Aztec, NM 87410

State of New Mexico
Energy, Minerals and Natural Resources Department

OIL CONSERVATION DIVISION

2040 South Pacheco Street
Santa Fe, New Mexico 87505

SUBMIT 1 COPY TO
APPROPRIATE
DISTRICT OFFICE
AND 1 COPY TO
SANTA FE OFFICE

DEPUTY OIL & GAS INSPECTOR

MAR 28 1997

PIT REMEDIATION AND CLOSURE REPORT

Approved

Operator: PNM Gas Services (Southwest Production)		Telephone: 324-3764	
Address: 603 W. Elm Street Farmington, NM 87401			
Facility or Well Name: Zachry Federal #1			
Location: Unit: L Sec. 34 T. 29 N R. 10 W County San Juan			
Pit Type: Separator <input type="checkbox"/> Dehydrator <input checked="" type="checkbox"/> Other <input type="checkbox"/>			
Land Type: BLM <input checked="" type="checkbox"/> State <input type="checkbox"/> Fee <input type="checkbox"/> Other <input type="checkbox"/>			
Pit Location: Pit dimensions: length 15 width 15 depth 4			
(Attach diagram) Reference: wellhead <input checked="" type="checkbox"/> other <input type="checkbox"/>			
Footage from reference: 101'			
Direction from reference: 40 Degrees <input checked="" type="checkbox"/> East <input type="checkbox"/> West of North <input checked="" type="checkbox"/> South <input type="checkbox"/>			
Depth to Ground Water: (Vertical distance from contaminants to seasonal high water elevation of ground water) Less than 50 feet (20 points) 50 feet to 99 feet (10 points) Greater than 100 feet (0 points) 0			
Wellhead Protection Area: (Less than 200 feet from a private domestic water source, or, less than 1,000 feet from all other water sources) Yes (20 points) No (0 points) 0			
Distance to Surface Water: (Horizontal distance to perennial lakes, ponds, rivers, streams, creeks, irrigation canals and ditches) Less than 200 feet (20 points) 200 feet to 1,000 feet (10 points) Greater than 1,000 feet (0 points) 0			
RANKING SCORE (TOTAL POINTS): 0			

Date Remediation Started:

8/27/96

Date Completed:

8/28/96

Remediation Method:

Excavation

☒

Approx. Cubic Yard

169

(Check all appropriate sections)

Landfarmed

☒

Amount Landfarmed (cubic yds)

169

Other

Remediation Location:

Onsite

☒

Offsite

(i.e., landfarmed onsite, name and location of offsite facility)

Backfill Material Location:

General Description of Remedial Action:

Excavated contaminated to pit size 31'x21'x7' and landfarmed soil onsite within a bermed area at a depth of 6" to 12". Soil was aerated by plowing/disking until soil met regulatory levels.

Ground Water Encountered:

No

☒

Yes

☐

Depth

Final Pit Closure Sampling:

Sample Location

5 pt composite-4 side walls and center of pit bottom

(if multiple samples, attach sample result and diagram of sample locations and depths.)

Sample depth

7'

Sample date

8/28/96

Sample time

9:45:00 AM

Sample Results

Benzene (ppm)

0.0043

Total BTEX (ppm)

5.5851

Field headspace (ppm)

TPH

10.2

Method

8015A

Vertical Extent (ft)

Risk Assessment form attached

Yes

☐

No

☒

Ground Water Sample:

Yes

☐

No

☒

(If yes, attach sample results)

I HEREBY CERTIFY THAT THE INFORMATION ABOVE IS TRUE AND COMPLETE TO THE BEST OF MY KNOWLEDGE AND MY BELIEF

DATE

January 22, 1997

SIGNATURE



PRINTED NAME
AND TITLE

Denver Bearden
Administrator III

zachwy Federal #1

N
↑

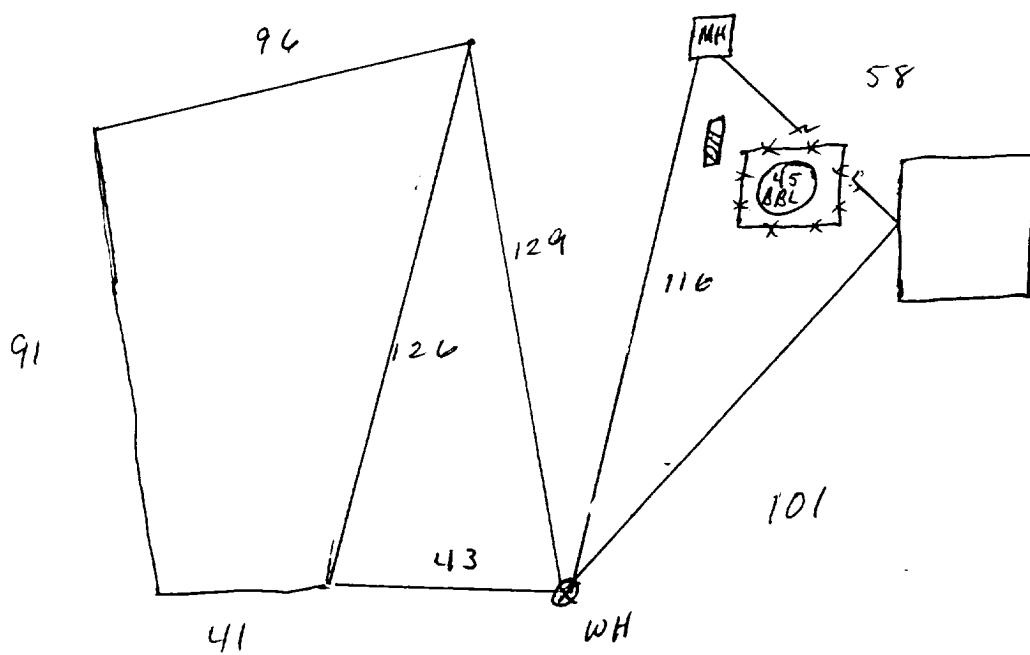

OFF: (505) 325-5667



LAB: (505) 325-1556

Diesel Range Organics

Attn: *Denver Bearden*
Company: *PNM Gas Services*
Address: *603 W. Elm*
City, State: *Farmington, NM 87401*

Date: *3-Sep-96*
COC No.: *4955*
Sample No. *11943*
Job No. *2-1000*

Project Name: *PNM Gas Services - Zachry Federal #1*
Project Location: *9608280945; Pit Excavation Composite Sample*
Sampled by: *RH* Date: *28-Aug-96* Time: *9:45*
Analyzed by: *DC* Date: *3-Sep-96*
Sample Matrix: *Soil*

Laboratory Analysis

<i>Parameter</i>	<i>Result</i>	<i>Unit of Measure</i>	<i>Detection Limit</i>	<i>Unit of Measure</i>
<i>Diesel Range Organics (C10 - C28)</i>	<i>10.2</i>	<i>mg/kg</i>	<i>5.0</i>	<i>mg/kg</i>

Quality Assurance Report

DRO QC No.: 0489-QC

Calibration Check

<i>Parameter</i>	<i>Method Blank</i>	<i>Unit of Measure</i>	<i>True Value</i>	<i>Analyzed Value</i>	<i>% Diff</i>	<i>Limit</i>
<i>Diesel Range (C10 - C28)</i>	<i>< 5.0</i>	<i>ppm</i>	<i>100</i>	<i>106</i>	<i>5.9</i>	<i>15%</i>

Matrix Spike

<i>Parameter</i>	<i>1 - Percent Recovered</i>	<i>2 - Percent Recovered</i>	<i>Limit</i>	<i>%RSD</i>	<i>Limit</i>
<i>Diesel Range (C10-C28)</i>	<i>104</i>	<i>96</i>	<i>(70-130)</i>	<i>5</i>	<i>20%</i>

Method - SW-846 EPA Method 8015A mod. - Nonhalogenated Volatile Hydrocarbons by Gas Chromatography

Approved by: *[Signature]*
Date: *9/3/96*

P.O. BOX 2606 • FARMINGTON, NM 87499

- TECHNOLOGY BLENDING INDUSTRY WITH THE ENVIRONMENT -

OFF: (505) 325-5667



LAB: (505) 325-1556

AROMATIC VOLATILE ORGANICS

Attn: *Denver Bearden*
Company: *PNM Gas Services*
Address: *603 W. Elm*
City, State: *Farmington, NM 87401*

Date: *30-Aug-96*
COC No.: *4955*
Sample No.: *11943*
Job No.: *2-1000*

Project Name: *PNM Gas Services - Zachry Federal #1*
Project Location: *9608280945; Pit Excavation Composite Sample*
Sampled by: *RH* Date: *28-Aug-96* Time: *9:45*
Analyzed by: *DC* Date: *29-Aug-96*
Sample Matrix: *Soil*

Laboratory Analysis

Parameter	Result	Unit of Measure	Detection Limit	Unit of Measure
Benzene	4.3	ug/kg	0.2	ug/kg
Toluene	439.6	ug/kg	0.2	ug/kg
Ethylbenzene	330.5	ug/kg	0.2	ug/kg
m,p-Xylene	4085.6	ug/kg	0.2	ug/kg
o-Xylene	725.0	ug/kg	0.2	ug/kg
	TOTAL	5585.1		ug/kg

Method - SW-846 EPA Method 8020 Aromatic Volatile Organics by Gas Chromatography

Approved by: *DC*
Date: *8/30/96*

P.O. BOX 2606 • FARMINGTON, NM 87499

- TECHNOLOGY BLENDING INDUSTRY WITH THE ENVIRONMENT -

Zachry Federal #1

SRC

Sec. 34, 29N, 10W

10-1-96

LandFarmed: On location

Composite sample # 9610011030

Soil vapor PID reading = 15.6 ppm

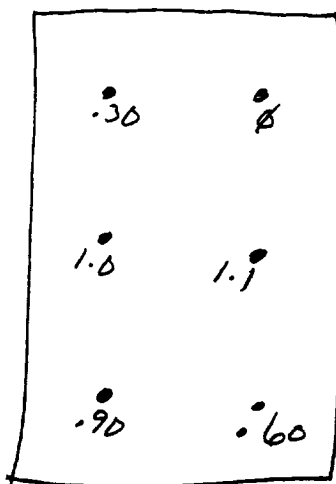

⊗

2"-12" depth

OFF: (505) 325-5667



LAB: (505) 325-1556

Diesel Range Organics

Attn: *Denver Bearden*
Company: *PNM Gas Services*
Address: *603 W. Elm*
City, State: *Farmington, NM 87401*

Date: *4-Oct-96*
COC No.: *5049*
Sample No. *12410*
Job No. *2-1000*

Project Name: ***PNM Gas Services - Zachry Federal #1 Landfarm***
Project Location: ***9610011030; 6pt. Composite, 2"-12" depth***
Sampled by: GC Date: *1-Oct-96* Time: *10:30*
Analyzed by: DC/BV Date: *4-Oct-96*
Sample Matrix: *Soil*

Laboratory Analysis

<i>Parameter</i>	<i>Result</i>	<i>Unit of Measure</i>	<i>Detection Limit</i>	<i>Unit of Measure</i>
<i>Diesel Range Organics (C10 - C28)</i>	<i>34.7</i>	<i>mg/kg</i>	<i>5.0</i>	<i>mg/kg</i>

Quality Assurance Report

DRO QC No.: 0489-QC

Calibration Check

<i>Parameter</i>	<i>Method Blank</i>	<i>Unit of Measure</i>	<i>True Value</i>	<i>Analyzed Value</i>	<i>% Diff</i>	<i>Limit</i>
<i>Diesel Range (C10 - C28)</i>	<i><5.0</i>	<i>ppm</i>	<i>100</i>	<i>110</i>	<i>10.3</i>	<i>15%</i>

Matrix Spike

<i>Parameter</i>	<i>1 - Percent Recovered</i>	<i>2 - Percent Recovered</i>	<i>Limit</i>	<i>%RSD</i>	<i>Limit</i>
<i>Diesel Range (C10-C28)</i>	<i>112</i>	<i>103</i>	<i>(70-130)</i>	<i>6</i>	<i>20%</i>

Method - SW-846 EPA Method 8015A mod. - Nonhalogenated Volatile Hydrocarbons by Gas Chromatography

Approved by: *[Signature]*

Date: *10/4/96*

P.O. BOX 2606 • FARMINGTON, NM 87499

- TECHNOLOGY BLENDING INDUSTRY WITH THE ENVIRONMENT -