

(SUBMIT IN TRIPLICATE)

UNITED STATES
DEPARTMENT OF THE INTERIOR
GEOLOGICAL SURVEY

Land Office Santa Fe
Lease No. SP 078931-B
Unit _____

SUNDRY NOTICES AND REPORTS ON WELLS

NOTICE OF INTENTION TO DRILL	<input checked="" type="checkbox"/>	SUBSEQUENT REPORT OF WATER SHUT-OFF	
NOTICE OF INTENTION TO CHANGE PLANS		SUBSEQUENT REPORT OF SHOOTING OR ACIDIZING	
NOTICE OF INTENTION TO TEST WATER SHUT-OFF		SUBSEQUENT REPORT OF ALTERING CASING	
NOTICE OF INTENTION TO RE-DRILL OR REPAIR WELL		SUBSEQUENT REPORT OF RE-DRILLING OR REPAIR	
NOTICE OF INTENTION TO SHOOT OR ACIDIZE		SUBSEQUENT REPORT OF ABANDONMENT	
NOTICE OF INTENTION TO PULL OR ALTER CASING		SUPPLEMENTARY WELL HISTORY	
NOTICE OF INTENTION TO ABANDON WELL			

(INDICATE ABOVE BY CHECK MARK NATURE OF REPORT, NOTICE, OR OTHER DATA)

November 6, 19 61

Well No. 3 is located 2130 ft. from (N) line and 1850 ft. from (E) line of sec. 31

NE 1/4 Sec. 31 29 N 13 W N.M.P.M.
(1/4 Sec. and Sec. No.) (Twp.) (Range) (Meridian)
Basin Dakota, Cha Cha Gallup San Juan
(Field) (County or Subdivision) (State or Territory)

The elevation of the ground level above sea level is 5866 ft.

DETAILS OF WORK

(State names of and expected depths to objective sands; show sizes, weights, and lengths of proposed casings; indicate mudding jobs, cementing points, and all other important proposed work)

We propose to drill and dual complete subject well as follows:

1. Drill 11" hole to 150'. Run and cement 8-5/8" OD, 24#, J-55, casing set at 150' and cement with sufficient volume to circulate to surface. WOC 12 hours. After WOC 8 hours pressure test casing to 500 pounds for 30 minutes.
2. Drill to TD of approximately 6300 with 7-7/8" bit. Run ES-Induction and Gamma Ray Sonic logs.
3. Run 3-1/2" OD, 14#, J-55 casing through deepest pay and cement with 150 sacks. Set stage collar 50' below base of Pictured Cliff and cement with 50 sacks cement.
4. Remove Release rig, pressure test casing, run tubing, recover load oil, potential well and clean location.

I understand that this plan of work must receive approval in writing by the Geological Survey before operations may be commenced.

Company TENECO CORP., acting by and thru its managing agent, TENNECO OIL COMPANY

Address P. O. Box 1714
Durango, Colorado

By L. B. Plum

Title District Production Superintendent

NUMBER OF COPIES RECEIVED	
DISTRIBUTION	
SANTA FE	
FILE	
U.S.G.S.	
LAND OFFICE	
TRANSPORTER	OIL GAS
PRODUCTION OFFICE	
OPERATOR	

NEW MEXICO OIL CONSERVATION COMMISSION
WELL LOCATION AND ACREAGE DEDICATION PLAT
 SEE INSTRUCTIONS FOR COMPLETING THIS FORM ON THE REVERSE SIDE

FORM C-128
 Revised 5/1/57

SECTION A			
Operator TERNECO OIL COMPANY		Lease CALLOW	
Well No. "B" #3			
Unit Letter G	Section 31	Township 29 North	Range 13 West
County San Juan			
Actual Footage Location of Well: 2130 feet from the North line and 1850 feet from the East line			
Ground Level Elev. 5866' ungraded	Producing Formation Gallup	Pool Cha Cha	Dedicated Acreage: 80 Acres

1. Is the Operator the only owner in the dedicated acreage outlined on the plat below? YES ☒ NO ____ . ("Owner" means the person who has the right to drill into and to produce from any pool and to appropriate the production either for himself or for himself and another. (65-3-29 (e) NMSA 1935 Comp.)
2. If the answer to question one is "no," have the interests of all the owners been consolidated by communitization agreement or otherwise? YES ____ NO ____ . If answer is "yes," Type of Consolidation _____
3. If the answer to question two is "no," list all the owners and their respective interests below:

Owner	Land Description

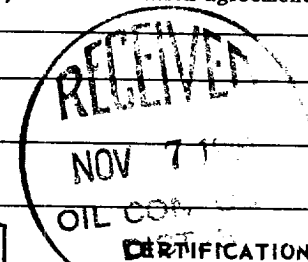

SECTION B

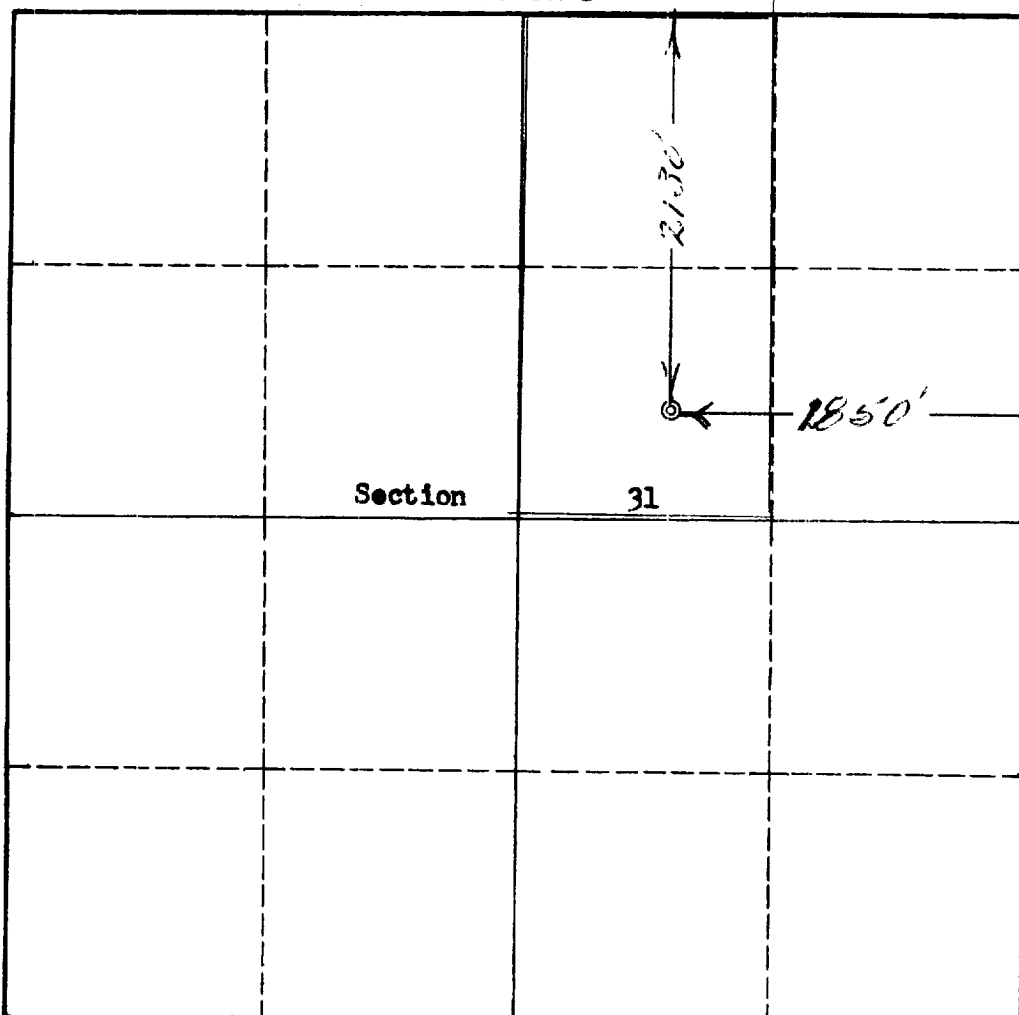

I hereby certify that the information in SECTION A above is true and complete to the best of my knowledge and belief.

Name *L. B. Plumb* **L. B. Plumb**
 Position **Dist. Production Supt.**
 Company **TERNECO CORP., acting by and thru its managing agent, TERNECO OIL COMPANY**
 Date **November 6, 1961**

I hereby certify that the well location shown on the plat in SECTION B was plotted from field notes of actual surveys made by me or under my supervision, and that the same is true and correct to the best of my knowledge and belief.

Date Surveyed **30 October 1961**
 Registered Professional Engineer and/or Land Surveyor
Robert J. Frost
San Juan Engineering Co.
 Certificate No. **PF & LS 2463**

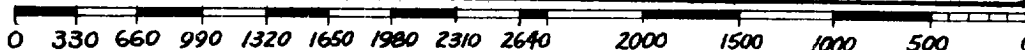

INSTRUCTIONS FOR COMPLETION OF FORM C-128

1. Operator shall furnish and certify to the information called for in Section A.
2. Operator shall outline the dedicated acreage for *both* oil and gas wells on the plat in Section B.
3. A registered professional engineer or land surveyor registered in the State of New Mexico or approved by the Commission shall show on the plat the location of the well and certify this information in the space provided.
4. All distances shown on the plat must be from the outer boundaries of the Section.
5. If additional space is needed for listing owners and their respective interests as required in question 3 of Section A, please use space below.

NUMBER OF COPIES RECEIVED	
DISTRIBUTION	
SANTA FE	
FILE	
U.S.G.S.	
LAND OFFICE	
TRANSPORTER	OIL
	GAS
PRODUCTION OFFICE	
OPERATOR	

NEW MEXICO OIL CONSERVATION COMMISSION
WELL LOCATION AND ACREAGE DEDICATION PLAT
 SEE INSTRUCTIONS FOR COMPLETING THIS FORM ON THE REVERSE SIDE

FORM C-128
 Revised 5/1/57

SECTION A					
Operator TENNECO OIL COMPANY		Lease CALLOWAY		Well No. # 3	
Unit Letter 8	Section 31	Township 29 North	Range 13 West	County San Juan	
Actual Footage Location of Well: feet from the North line and 1850 feet from the East line Ground Level Elev. 5866' ungraded Producing Formation Dakota Pool Basin Dedicated Acreage: 320 Acres					

1. Is the Operator the only owner in the dedicated acreage outlined on the plat below? YES ☒ NO ☐ ("Owner" means the person who has the right to drill into and to produce from any pool and to appropriate the production either for himself or for himself and another. (65-3-29 (e) NMSA 1935 Comp.)
 2. If the answer to question one is "no," have the interests of all the owners been consolidated by communitization agreement or otherwise? YES ☐ NO ☐ . If answer is "yes," Type of Consolidation _____
 3. If the answer to question two is "no," list all the owners and their respective interests below:
- | Owner | Land Description |
|-------|------------------|
| | |
| | |

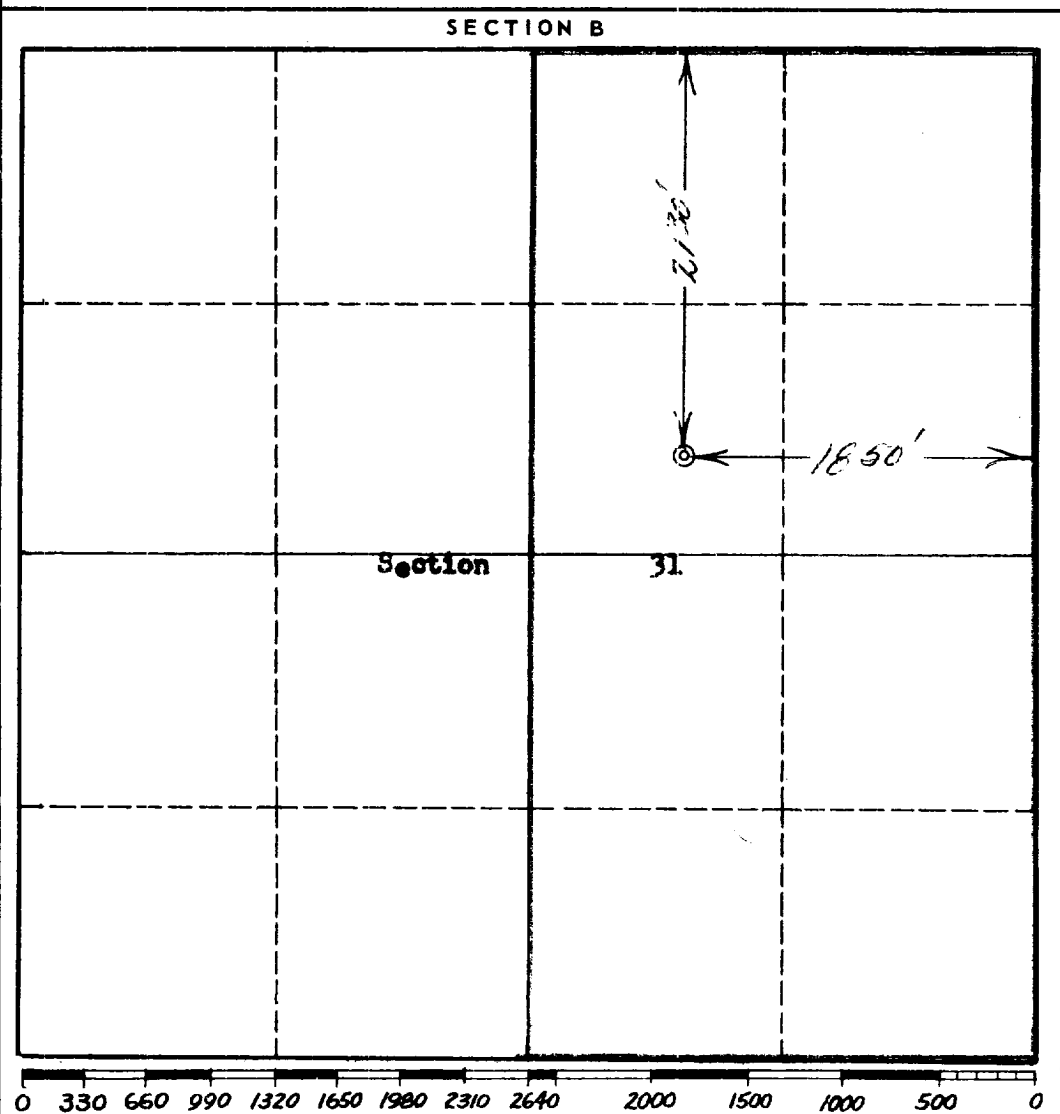
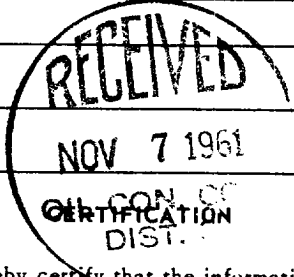

I hereby certify that the information in SECTION A above is true and complete to the best of my knowledge and belief.

Name **L. B. Plumb**
 Position **Dist. Production Supt.**
 Company **TENNECO CORP., acting by and thru its managing agent, TENNECO OIL COMPANY**
November 6, 1961

I hereby certify that the well location shown on the plat in SECTION B was plotted from field notes of actual surveys made by me or under my supervision, and that the same is true and correct to the best of my knowledge and belief.

Date Surveyed **30 October 1961**
 Registered Professional Engineer and/or Land Surveyor
Robert H. Ernst
San Juan Engineering Co.
 Certificate No. _____



INSTRUCTIONS FOR COMPLETION OF FORM C-128

1. Operator shall furnish and certify to the information called for in Section A.
2. Operator shall outline the dedicated acreage for *both* oil and gas wells on the plat in Section B.
3. A registered professional engineer or land surveyor registered in the State of New Mexico or approved by the Commission shall show on the plat the location of the well and certify this information in the space provided.
4. All distances shown on the plat must be from the outer boundaries of the Section.
5. If additional space is needed for listing owners and their respective interests as required in question 3 of Section A, please use space below.