

NEW MEXICO OIL CONSERVATION COMMISSION
Santa Fe, New Mexico

Form C-101
Revised (12/1/55)

NOTICE OF INTENTION TO DRILL

Notice must be given to the District Office of the Oil Conservation Commission and approval obtained before drilling or recompletion begins. If changes in the proposed plan are considered advisable, a copy of this notice showing such changes will be returned to the sender. Submit this notice in QUINTUPPLICATE. One copy will be returned following approval. See additional instructions in Rules and Regulations of the Commission. If State Land submit 6 Copies Attach Form C- 128 in triplicate to first 3 copies of form C-101

Farmington, New Mexico

(Place)

June 17, 1959

(Date)

OIL CONSERVATION COMMISSION
SANTA FE, NEW MEXICO

Gentlemen:

You are hereby notified that it is our intention to commence the Drilling of a well to be known as

Pan American Petroleum Corporation

(Company or Operator)

State of New Mexico "AX"

(Lease)

Well No. 1, in H The well is

located 1810 feet from the North line and 810 feet from the

East

Line of Section 32, T 29N, R 9W, NMPM.

(GIVE LOCATION FROM SECTION LINE) Astec Pictured Cliffs Pool, San Juan County

If State Land the Oil and Gas Lease is No. E-6513 Original

If patented land the owner is

Address

We propose to drill well with drilling equipment as follows: Rotary tools to total depth.

The status of plugging bond is

Drilling Contractor Brannon & Murray Drilling Company
Box 672

Coleman, Texas

We intend to complete this well in the Pictured Cliffs formation at an approximate depth of 2500

CASING PROGRAM

We propose to use the following strings of Casing and to cement them as indicated:

Size of Hole	Size of Casing	Weight per Foot	New or Second Hand	Depth	Backs Cement
12-1/4"	8-5/8"	22.7	New	200'	Circulate
7-7/8"	4-1/2"	9.5	New	2500'	Circulate to surface if possible

If changes in the above plans become advisable we will notify you immediately.

ADDITIONAL INFORMATION (If recompletion give full details of proposed plan of work.)

We propose to drill the above well with rotary tools to an approximate total depth of 2500' to complete in the Pictured Cliffs formation. Stimulation will be as indicated upon reaching total depth. Copies of location plat are attached. Logs will be furnished upon completion of well.

Approved
Except as follows:

Sincerely yours,

Pan American Petroleum Corporation
(Company or Operator)

ORIGINAL SIGNED BY

By R. M. Bauer, Jr.

Position Area Engineer

Send Communications regarding well to

Name Pan American Petroleum Corporation

Address Box 487, Farmington, New Mexico

OIL CONSERVATION COMMISSION

By Jimmy (Name)

NEW MEXICO OIL CONSERVATION COMMISSION

Well Location and Acreage Dedication Plat

Section A.

Date June 15, 1959

Operator PAN AMERICAN PETROLEUM CORPORATION Lease State of New Mexico "AX"
Well No. 1 Unit Letter H Section 32 Township 29 NORTH Range 9 WEST NMPM
Located 1840 Feet From NORTH Line, 810 Feet From EAST Line
County SAN JUAN G. L. Elevation * Dedicated Acreage 160 Acres
Name of Producing Formation PICTURED CLIFFS Pool AZTEC PICTURED CLIFFS

1. Is the Operator the only owner* in the dedicated acreage outlined on the plat below?
Yes X No *TO BE REPORTED LATER.
2. If the answer to question one is "no," have the interests of all the owners been consolidated by communitization agreement or otherwise? Yes No . If answer is "yes,"
Type of Consolidation
3. If the answer to question two is "no," list all the owners and their respective interests below:

Owner

Land Description

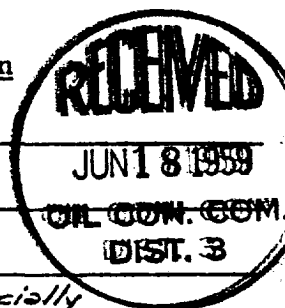

Section. B

Section officially resurveyed 1950

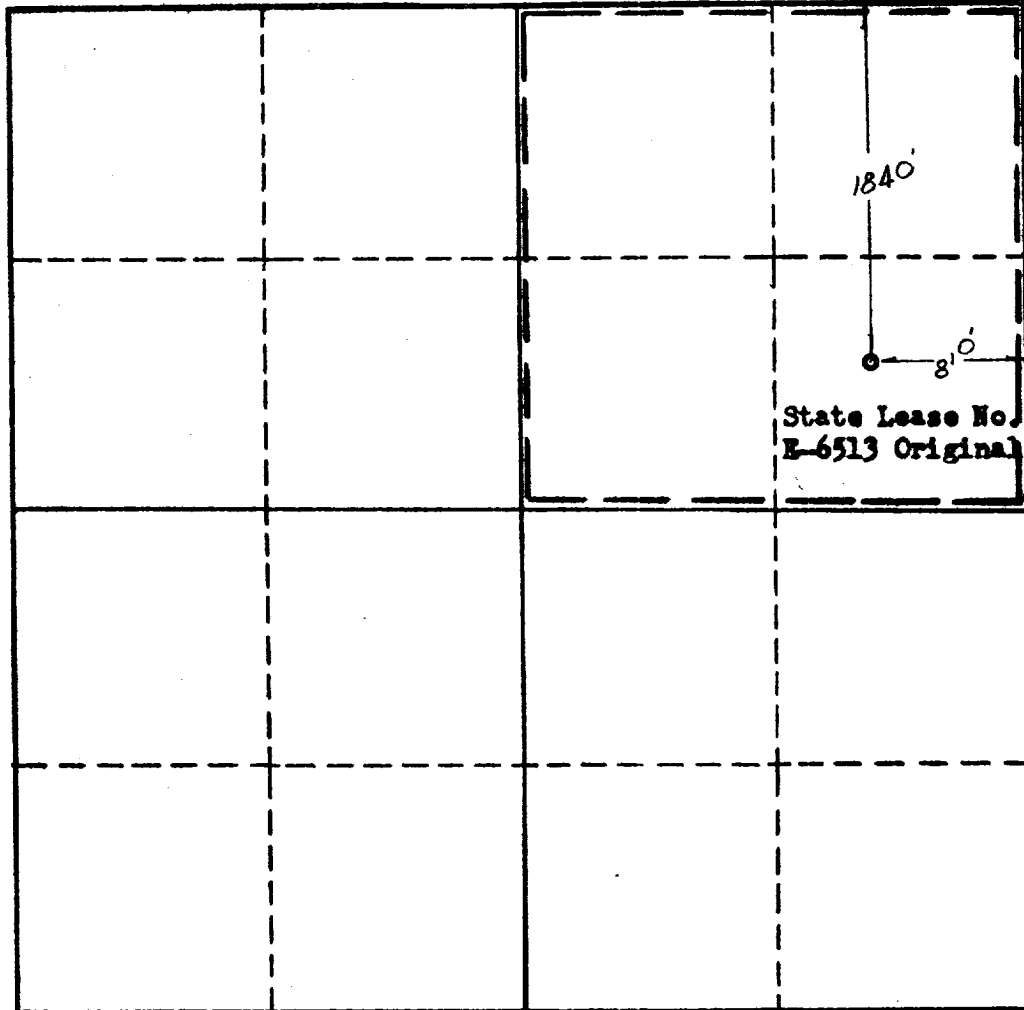

This is to certify that the information in Section A above is true and complete to the best of my knowledge and belief.

PAN AMERICAN PETROLEUM CORPORATION

R. M. BAUER, JR. (Operator)
R. M. BAUER, JR.

(Representative)
BOX 487, FARMINGTON, NEW MEXICO

Address

This is to certify that the well location shown on the plat in Section B was obtained from field notes and surveys and that the same is true to the best of my knowledge and belief.

Date Surveyed

Ernest V. Echohawk
Registered Land Surveyor.

Certificate No. 1545



OIL CONSERVATION COMMISSION

AZTEC DISTRICT OFFICE

No. Copies Received 6

DISTRIBUTION

	NO. FURNISHED	
Operator	<u>1</u>	
Santa Fe	<u>1</u>	
Proration Office		
State Land Office	<u>1</u>	
U. S. G. S.	<u>2</u>	
Transporter		
File	<u>1</u>	<input checked="" type="checkbox"/>