

District I
P.O. Box 1980, Hobbs, NM

District II
P.O. Drawer DD, Artesia, NM 88221

District III
1000 Rio Brazos Rd, Aztec, NM 87410

State of New Mexico
Energy, Minerals and Natural Resources Department

SUBMIT 1 COPY TO
APPROPRIATE
DISTRICT OFFICE
AND 1 COPY TO
SANTA FE OFFICE

OIL CONSERVATION DIVISION

2040 South Pacheco Street
Santa Fe, New Mexico 87505

PIT REMEDIATION AND CLOSURE REPORT

Operator: PNM Gas Services (Amoco) **Telephone:** 324-3764

Address: 603 W. Elm Street Farmington, NM 87401

Facility or Well Name: Florance #1

Location: Unit: A Sec. 35 T. 29 N R. 9 W County San Juan

Pit Type: Separator ☐ Dehydrator ☒ Other ☐

Land Type: BLM ☒ State ☐ Fee ☐ Other ☐

Pit Location: Pit dimensions: length 15 width 15 depth 3

(Attach diagram) Reference: wellhead ☒ other ☐

Footage from reference: 80'

Direction from reference: 90 Degrees ☐ East ☒ North ☐ South ☒ West

Depth to Ground Water:

Less than 50 feet	(20 points)	
50 feet to 99 feet	(10 points)	
Greater than 100 feet	(0 points)	<u>20</u>

(Vertical distance from contaminants to seasonal high water elevation of ground water)

Wellhead Protection Area:

(Less than 20 feet from a private domestic water source, or, less than 1,000 feet from all other water sources)

Yes (20 points)
No (0 points) 0

Distance to Surface Water:

(Horizontal distance to perennial lakes, ponds, rivers, streams, creeks, irrigation canals and ditches)

Less than 200 feet	(20 points)	
200 feet to 1,000 feet	(10 points)	
Greater than 1,000 feet	(0 points)	<u>20</u>

RANKING SCORE (TOTAL POINTS): 40

Date Remediation Started:	<u>8/6/96</u>		Date Completed:	<u>8/7/96</u>	
Remediation Method: (Check all appropriate sections)	Excavation	<u>X</u>	Approx. Cubic Yard	<u>600</u>	
	Landfarmed	<u>X</u>	Amount Landfarmed (cubic yds)	<u>600</u>	
	Other	<u></u>			
Remediation Location: (i.e., landfarmed onsite, name and location of offsite facility)	Onsite	<u>X</u>	Offsite	<u></u>	
Backfill Material Location: <u></u>					
General Description of Remedial Action: Excavated contaminated soil to pit size 29'x31'x18' and landfarmed soil onsite within a bermed area at a depth of 6" to 12". Soil was aerated by plowing/disking until soil met regulatory levels. <u></u> <u></u> <u></u> <u></u> <u></u>					
Ground Water Encountered:	No	<input checked="" type="checkbox"/>	Yes	<input type="checkbox"/>	Depth <u></u>

Final Pit Closure Sampling: (if multiple samples, attach sample result and diagram of sample locations and depths.)	Sample Location	<u>5 pt. composite-4 side walls and center of pit bottom</u>			
	Sample depth	<u>21'</u>			
	Sample date	<u>8/6/96</u>	Sample time	<u>2:30:00 PM</u>	
Sample Results					
	Benzene (ppm)	<u>0.5190</u>			
	Total BTEX (ppm)	<u>4.0584</u>			
	Field headspace (ppm)	<u></u>			
	TPH	<u><</u>	<u>5.0</u>	Method	<u>8015A</u>
Vertical Extent (ft) <u></u>	Risk Assessment form attached		Yes	No	<input checked="" type="checkbox"/>
Ground Water Sample:	Yes	<input type="checkbox"/>	No	<input checked="" type="checkbox"/>	(If yes, attach sample results)

I HEREBY CERTIFY THAT THE INFORMATION ABOVE IS TRUE AND COMPLETE TO THE BEST OF MY KNOWLEDGE AND MY BELIEF

DATE January 22, 1997

SIGNATURE

Denver Bearden

PRINTED NAME Denver Bearden
AND TITLE Administrator III

FLORANCE #1
Sec. 35, 29N, 9W, A
Amoco

August 6, 1996

Pit dimensions at start: 15X15X3

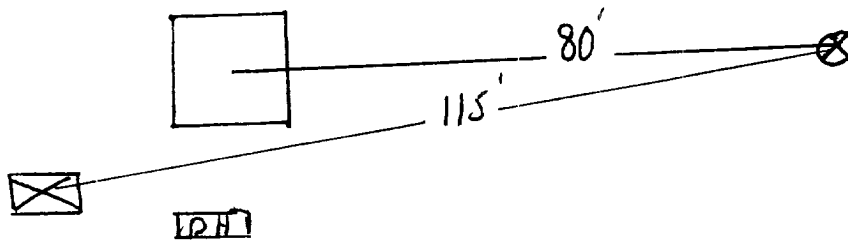

Excavated pit dimensions: 29X31X18

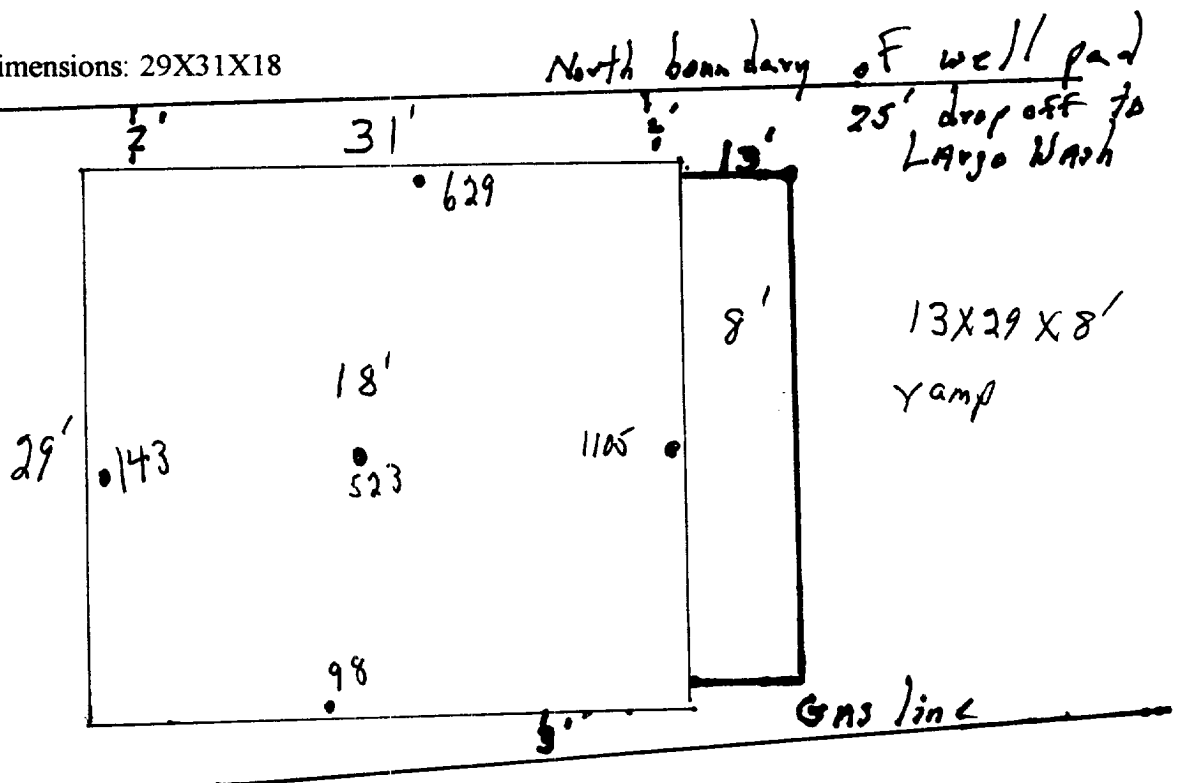

OFF: (505) 325-5667



LAB: (505) 325-1516

Diesel Range Organics

Attn: *Denver Bearden*
 Company: *PNM Gas Services*
 Address: *603 W. Elm*
 City, State: *Farmington, NM 87401*

Date: *7-Aug-96*
 COC No.: *4960*
 Sample No. *11686*
 Job No. *2-1000*

Project Name: *PNM Gas Services - Florance #1*
 Project Location: *9608061430; 5pt. Composite; 4 walls at 18', bottom at 21'*
 Sampled by: *GC* Date: *6-Aug-96* Time: *14:30*
 Analyzed by: *HR* Date: *7-Aug-96*
 Sample Matrix: *Soil*

Laboratory Analysis

<i>Parameter</i>	<i>Result</i>	<i>Unit of Measure</i>	<i>Detection Limit</i>	<i>Unit of Measure</i>
<i>Diesel Range Organics (C10 - C28)</i>	<i><5.0</i>	<i>mg/kg</i>	<i>5.0</i>	<i>mg/kg</i>

Quality Assurance ReportDRO QC No.: *0479-QC****Calibration Check***

<i>Parameter</i>	<i>Method Blank</i>	<i>Unit of Measure</i>	<i>True Value</i>	<i>Analyzed Value</i>	<i>% Diff</i>	<i>Limit</i>
<i>Diesel Range (C10 - C28)</i>	<i><5.0</i>	<i>ppm</i>	<i>2,000</i>	<i>1,810</i>	<i>9.5</i>	<i>15%</i>

Matrix Spike

<i>Parameter</i>	<i>1 - Percent Recovered</i>	<i>2 - Percent Recovered</i>	<i>Limit</i>	<i>%RSD</i>	<i>Limit</i>
<i>Diesel Range (C10-C28)</i>	<i>93</i>	<i>99</i>	<i>(70-130)</i>	<i>5</i>	<i>20%</i>

Method - SW-846 EPA Method 8015A mod. - Nonhalogenated Volatile Hydrocarbons by Gas Chromatography

Approved by:

Date:

P.O. BOX 2606 • FARMINGTON, NM 87499

- TECHNOLOGY BLENDING INDUSTRY WITH THE ENVIRONMENT -

OFF: (505) 325-5667



LAB: (505) 325-1556

AROMATIC VOLATILE ORGANICS

Attn: *Denver Bearden*
Company: *PNM Gas Services*
Address: *603 W. Elm*
City, State: *Farmington, NM 87401*

Date: *7-Aug-96*
COC No.: *4960*
Sample No.: *11686*
Job No.: *2-1000*

Project Name: *PNM Gas Services - Florance #1*
Project Location: *9608061430; 5pt. Composite, 4 Walls @ 18' & Bottom @ 21'*
Sampled by: *GC* Date: *6-Aug-96* Time: *14:30*
Analyzed by: *HR* Date: *7-Aug-96*
Sample Matrix: *Soil*

Laboratory Analysis

Parameter	Result	Unit of Measure	Detection Limit	Unit of Measure
<i>Benzene</i>	<i>519.0</i>	<i>ug/kg</i>	<i>0.2</i>	<i>ug/kg</i>
<i>Toluene</i>	<i>1955.1</i>	<i>ug/kg</i>	<i>0.2</i>	<i>ug/kg</i>
<i>Ethylbenzene</i>	<i>140.1</i>	<i>ug/kg</i>	<i>0.2</i>	<i>ug/kg</i>
<i>m,p-Xylene</i>	<i>1100.2</i>	<i>ug/kg</i>	<i>0.2</i>	<i>ug/kg</i>
<i>o-Xylene</i>	<i>344.0</i>	<i>ug/kg</i>	<i>0.2</i>	<i>ug/kg</i>
	<i>TOTAL</i>	<i>4058.4</i>		<i>ug/kg</i>

Method - SW-846 EPA Method 8020 Aromatic Volatile Organics by Gas Chromatography

Approved by: *[Signature]*
Date: *8/7/96*

P.O. BOX 2606 • FARMINGTON, NM 87499

- TECHNOLOGY BLENDING INDUSTRY WITH THE ENVIRONMENT -

Florence #1
Amoco
Sec. 35, 29N, 9W

9-10-96

Landfarm: On-location

Composite sample # ~~###~~ 9609101410 6pt. comp.
soil vapor headspace PID reading: 3.8 ppm



2"-12" depth
sand

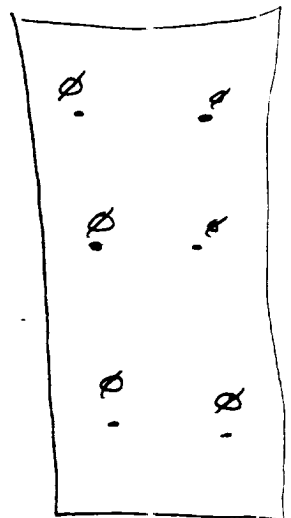

OFF: (505) 325-5667



LAB: (505) 325-1556

Diesel Range Organics

Attn: *Denver Bearden*
Company: *PNM Gas Services*
Address: *603 W. Elm*
City, State: *Farmington, NM 87401*

Date: *12-Sep-96*
COC No.: *5025*
Sample No. *12102*
Job No. *2-1000*

Project Name: *PNM Gas Services - Florance #1 Landfarm*
Project Location: *9609101410; 6pt. Composite, 2"-12" depth*
Sampled by: *GC* Date: *10-Sep-96* Time: *14:10*
Analyzed by: *BV* Date: *12-Sep-96*
Sample Matrix: *Soil*

Laboratory Analysis

<i>Parameter</i>	<i>Result</i>	<i>Unit of Measure</i>	<i>Detection Limit</i>	<i>Unit of Measure</i>
<i>Diesel Range Organics (C10 - C28)</i>	<i><5.0</i>	<i>mg/kg</i>	<i>5.0</i>	<i>mg/kg</i>

Quality Assurance Report

DRO QC No.: 0489-QC

Calibration Check

<i>Parameter</i>	<i>Method Blank</i>	<i>Unit of Measure</i>	<i>True Value</i>	<i>Analyzed Value</i>	<i>% Diff</i>	<i>Limit</i>
<i>Diesel Range (C10 - C28)</i>	<i><5.0</i>	<i>ppm</i>	<i>100</i>	<i>104</i>	<i>3.6</i>	<i>15%</i>

Matrix Spike

<i>Parameter</i>	<i>1 - Percent Recovered</i>	<i>2 - Percent Recovered</i>	<i>Limit</i>	<i>%RSD</i>	<i>Limit</i>
<i>Diesel Range (C10-C28)</i>	<i>96</i>	<i>95</i>	<i>(70-130)</i>	<i>1</i>	<i>20%</i>

Method - SW-846 EPA Method 8015A mod. - Nonhalogenated Volatile Hydrocarbons by Gas Chromatography

Approved by: *[Signature]*
Date: *9/12/96*