

(SUBMIT IN TRIPLICATE)

UNITED STATES  
DEPARTMENT OF THE INTERIOR  
GEOLOGICAL SURVEY

Land Office Santa Fe  
Lease No. SP-078926  
Unit Gallegos Canyon Unit

SUNDRY NOTICES AND REPORTS ON WELLS

NOTICE OF INTENTION TO DRILL.....	<input checked="" type="checkbox"/>	SUBSEQUENT REPORT OF WATER SHUT-OFF.....
NOTICE OF INTENTION TO CHANGE PLANS.....		SUBSEQUENT REPORT OF SHOOTING OR ACIDIZING.....
NOTICE OF INTENTION TO TEST WATER SHUT-OFF.....		SUBSEQUENT REPORT OF ALTERING CASING.....
NOTICE OF INTENTION TO RE-DRILL OR REPAIR WELL.....		SUBSEQUENT REPORT OF RE-DRILLING OR REPAIR.....
NOTICE OF INTENTION TO SHOOT OR ACIDIZE.....		SUBSEQUENT REPORT OF ABANDONMENT.....
NOTICE OF INTENTION TO PULL OR ALTER CASING.....		SUPPLEMENTARY WELL HISTORY.....
NOTICE OF INTENTION TO ABANDON WELL.....		

(INDICATE ABOVE BY CHECK MARK NATURE OF REPORT, NOTICE, OR OTHER DATA)

Gallegos Canyon Unit

Farmington, New Mexico November 10, 1959

Well No. 86 is located 1850 ft. from N line and 990 ft. from E line of sec.

NE/4 of Section 35

T-29-N

R-13-W

N.M.P.M.

Undesignated Dakota

San Juan

New Mexico

(Field)

(County or Subdivision)

(State or Territory)

NOV 12 1959

OIL CON. C  
DIST. 3

The elevation of the derrick floor above sea level is \_\_\_\_\_ ft. (To be reported later.)

DETAILS OF WORK

(State names of and expected depths to objective sands; show sizes, weights, and lengths of proposed casings; indicate mudlogging jobs, cementing points, and all other important proposed work)

We propose to drill the above well to an approximate total depth of 6300' with rotary tools to evaluate Gallup and Dakota prospects. Stimulation and completion will be as indicated upon reaching total depth.

The following casing program is proposed:

SIZE	DEPTH	CEMENT	REMARKS
------	-------	--------	---------

9-5/8"	300'	200 sacks	Heat - circulate.
--------	------	-----------	-------------------

4-1/2"	6300'		
--------	-------	--	--

OR

5-1/2"			
--------	--	--	--

Production casing will be cemented by the 2nd stage method with stage tool set approximately 350' below top of Pictured Cliffs. First stage will consist of sufficient cement to fill 500' above top of Gallup and second stage will consist of sufficient cement to fill 300' above top of Pictured Cliffs.

Copies of location plat are attached. A copy of any survey taken will be submitted upon completion of well.

I understand that this plan of work must receive approval in writing by the Geological Survey before operations may be commenced.

Company Pan American Petroleum Corporation

Address Box 457

Farmington, New Mexico

Attn: L. O. Speer, Jr.

ORIGINAL SIGNED BY  
R. M. Bauer, Jr.

By

Title Area Engineer

## NEW MEXICO OIL CONSERVATION COMMISSION

## Well Location and Acreage Dedication Plat

Section A.

Date **OCTOBER 22, 1959**

Operator **PAN AMERICAN PETROLEUM CORPORATION** Lease **GALLEGOS CANYON UNIT**  
 Well No. **86** Unit Letter **H** Section **35** Township **29 NORTH** Range **13 WEST**, NMPM  
 Located **1850** Feet From **the NORTH** Line, **990** Feet From **the EAST** Line  
 County **SAN JUAN** G. L. Elevation **\*** Dedicated Acreage **320** Acres  
 Name of Producing Formation **Dakota** Pool **Undesignated Dakota**

1. Is the Operator the only owner in the dedicated acreage outlined on the plat below?

Yes ☐ No ☒**\*TO BE REPORTED LATER**2. If the answer to question one is "no", have the interests of all the owners been consolidated by communitization agreement or otherwise? Yes ☒ No ☐ If answer is "yes", Type of Consolidation.**Unitized acreage - Gallegos Canyon Unit**

3. If the answer to question two is "no", list all the owners and their respective interests below:

Owner

Land Description

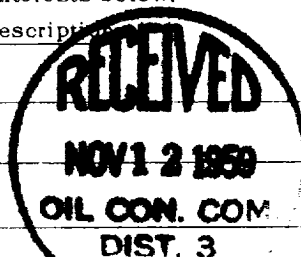

Section B.

Note: All distances must be from outer boundaries of section.

This is to certify that the information  
 in Section A above is true and complete  
 to the best of my knowledge and belief.

PAN AMERICAN PETROLEUM CORPORATION

R. M. BAUER, JR. *RMB*  
(Operator)BOX 487, FARMINGTON, NEW MEXICO  
(Representative)

(Address)

Ref: GLO plat dated 19 April 1881

7TH. STD. PARALLEL NORTH

RESURVEY 1915, Found Brasscap Corners

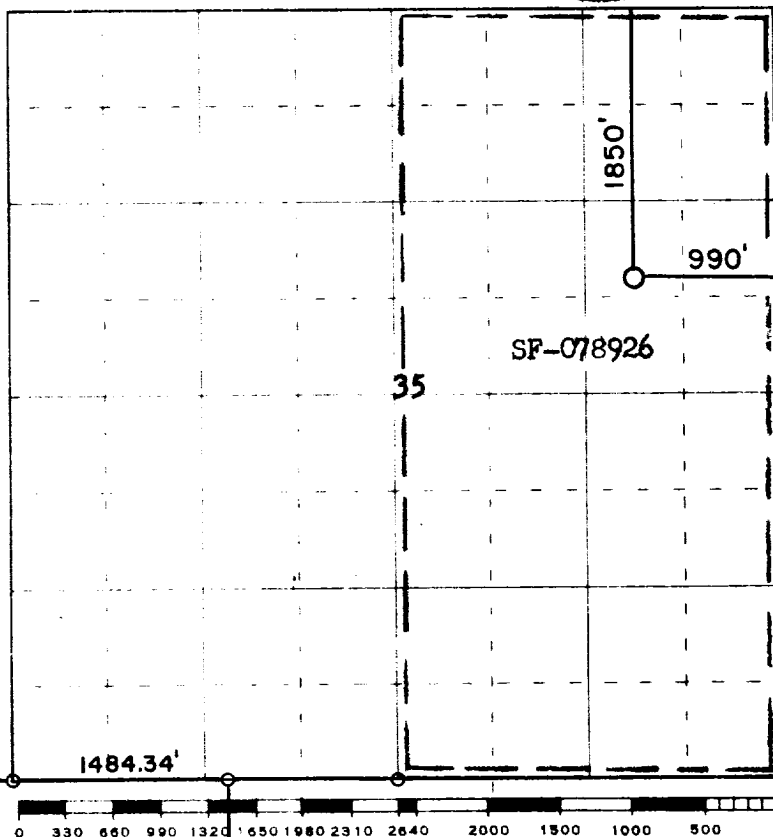

SEC. 11

Scale 4 inches equal 1 mile

SEC. 12

This is to certify that the above plat was prepared from field notes of actual surveys  
 made by me or under my supervision and that the same are true and correct to the best  
 of my knowledge and belief.

Date Surveyed **20 October 1959**

*James P. Leese*  
 Registered Professional Engineer and/or Land Surveyor  
**JAMES P. LEESE N. MEX. REG. No. 1463**

(Seal)

Farmington, New Mexico