

(SUBMIT IN TRIPLICATE)

UNITED STATES
DEPARTMENT OF THE INTERIOR
GEOLOGICAL SURVEY

Land Office Santa Fe
Lease No. SF 078926
Unit Gallagos Canyon Unit

SUNDRY NOTICES AND REPORTS ON WELLS

NOTICE OF INTENTION TO DRILL	<input checked="" type="checkbox"/>	SUBSEQUENT REPORT OF WATER SHUT-OFF	
NOTICE OF INTENTION TO CHANGE PLANS		SUBSEQUENT REPORT OF SHOOTING OR ACIDIZING	
NOTICE OF INTENTION TO TEST WATER SHUT-OFF		SUBSEQUENT REPORT OF ALTERING CASING	
NOTICE OF INTENTION TO RE-DRILL OR REPAIR WELL		SUBSEQUENT REPORT OF RE-DRILLING OR REPAIR	
NOTICE OF INTENTION TO SHOOT OR ACIDIZE		SUBSEQUENT REPORT OF ABANDONMENT	
NOTICE OF INTENTION TO PULL OR ALTER CASING		SUPPLEMENTARY WELL HISTORY	
NOTICE OF INTENTION TO ABANDON WELL			

(INDICATE ABOVE BY CHECK MARK NATURE OF REPORT, NOTICE, OR OTHER DATA)

Gallagos Canyon Unit Farmington, New Mexico April 13, 1960

Well No. 87 is located 1650 ft. from N line and 1850 ft. from W line of sec. 35

SE 1/4 NW 1/4 Section 35
(1/4 Sec. and Sec. No.)

T-29-N
(Twp.)

R-13-W
(Range)

N.M.P.M.
(Meridian)

Total Gallup
(Field)

San Juan
(County or Subdivision)

New Mexico
(State or Territory)

RECEIVED

APR 18 1960

The elevation of the derrick floor above sea level is _____ ft. (To be reported later)

DETAILS OF WORK

(State names of and expected depths to objective sands; show sizes, weights, and lengths of proposed casings; indicate mudding jobs, cementing points, and all other important proposed work)

We propose to drill Gallagos Canyon Unit Well #87 with rotary tools to an approximate total depth of 5700' to test and develop productive Gallup zones. Stimulation will be as indicated upon penetration of Gallup pay. Casing program will be as follows:

Size	Depth	Cement	Remarks
8-5/8"	200'	160 sacks	Nest Circulate
4-1/2"	5700'	700 sacks	Production casing will be cemented by 2-stage process. 1st stage will be to fill 500' above top of Gallup. Second stage will cover shallow Pictured Cliffs gas zone.

Copies of location plats are attached. A copy of any survey taken will be submitted upon completion of well.

I understand that this plan of work must receive approval in writing by the Geological Survey before operations may be commenced.

Company Pan American Petroleum Corporation

Address Box 487

Farmington, New Mexico

ATTN: L. J. Spear, Jr.

ORIGINAL SIGNED BY
R. M. Bauer, Jr.

By _____

Title Area Engineer



NEW MEXICO OIL CONSERVATION COMMISSION

Well Location and Acreage Dedication Plat

Section A.

Date APRIL 13, 1960

Operator PAN AMERICAN PETROLEUM CORPORATION Lease GALLEGOS CANYON GAS UNIT
 Well No. 87 Unit Letter F Section 35 Township 29 NORTH Range 13 WEST, NMPM
 Located 1650 Feet From NORTH Line, 1850 Feet From the WEST Line
 County SAN JUAN G. L. Elevation * Dedicated Acreage 40 Acres
 Name of Producing Formation GALLUP Pool TOTAH GALLUP

1. Is the Operator the only owner in the dedicated acreage outlined on the plat below?
 Yes No X *To be reported later.
2. If the answer to question one is "no", have the interests of all the owners been consolidated by communitization agreement or otherwise? Yes X No If answer is "yes", Type of Consolidation, Gallegos Canyon Unit acreage
3. If the answer to question two is "no", list all the owners and their respective interests below:

Owner

Land Description

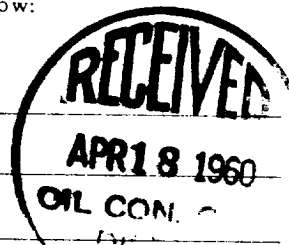

Section B.

REF: U.S.G.L.O. PLATS DATED APRIL 19, 1881 AND JULY 15, 1915.
 Note: All distances must be from outer boundaries of section.

This is to certify that the information
 in Section A above is true and complete
 to the best of my knowledge and belief.

PAN AMERICAN PETROLEUM CORPORATION
 (Operator)
R.M. BAUER, JR. *RMBauer Jr.*
 (Representative)
BOX 487, FARMINGTON, NEW MEXICO
 (Address)

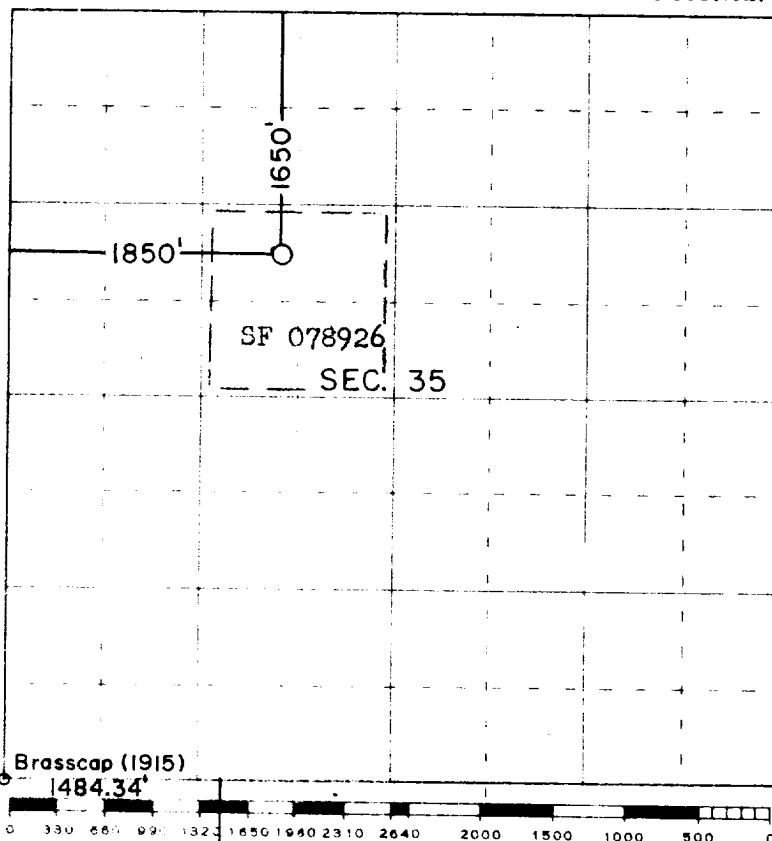

SEC. 34

7 TH. STD. PARALLEL NORTH

SEC. 11

Scale 4 inches equal 1 mile SEC. 12



(Seal)

Farmington, New Mexico

This is to certify that the above plat was prepared from field notes of actual surveys made by me or under my supervision and that the same are true and correct to the best of my knowledge and belief.

Date Surveyed 9 APRIL 1960

James P. Leese
 Registered Professional Engineer and/or Land Surveyor
James P. Leese N. Mex. Reg. No. 1463