

2			
34			

(SUBMIT IN TRIPLICATE)

UNITED STATES  
DEPARTMENT OF THE INTERIOR  
GEOLOGICAL SURVEY

Land Office Santa Fe  
Lease No. F 000724  
Unit Block 34, T29N, R10W, S.M.P.M. Meridian, San Juan County, New Mexico

SUNDRY NOTICES AND REPORTS ON WELLS

NOTICE OF INTENTION TO DRILL	<input checked="" type="checkbox"/>	SUBSEQUENT REPORT OF WATER SHUT-OFF	
NOTICE OF INTENTION TO CHANGE PLANS		SUBSEQUENT REPORT OF SHOOTING OR ACIDIZING	
NOTICE OF INTENTION TO TEST WATER SHUT-OFF		SUBSEQUENT REPORT OF ALTERING CASING	
NOTICE OF INTENTION TO RE-DRILL OR REPAIR WELL		SUBSEQUENT REPORT OF RE-DRILLING OR REPAIR	
NOTICE OF INTENTION TO SHOOT OR ACIDIZE		SUBSEQUENT REPORT OF ABANDONMENT	
NOTICE OF INTENTION TO PULL OR ALTER CASING		SUPPLEMENTARY WELL HISTORY	
NOTICE OF INTENTION TO ABANDON WELL			

(INDICATE ABOVE BY CHECK MARK NATURE OF REPORT, NOTICE, OR OTHER DATA)

June 21, 1955

Well No. 10 Zachary is located 750 ft. from N line and 950 ft. from W line of sec. 34

T29N (Twp.) R10W (Range) S.M.P.M. (Meridian)  
Block 34 (Field) SAN JUAN COUNTY (County or Subdivision) NEW MEXICO (State or Territory)

The elevation of the derrick floor above sea level is 7000 ft. TO BE DETERMINED.

DETAILS OF WORK

(State names of and expected depths to objective sands; show sizes, weights, and lengths of proposed casings; indicate mudding jobs, cementing points, and all other important proposed work)

Objective and in the colored Gliffs formation anticipated at an approximately 2000'.

Proposed casing program: 1 1/2" 5/8" J-55 cement to surface.  
2000' 5/8" J-55 cemented with 100 sacks.

Rotary tools will be employed from surface to top of colored Gliffs.  
able tool will be employed from surface to top of colored Gliffs.

The well will be cased all from red in an effort to stimulate production.

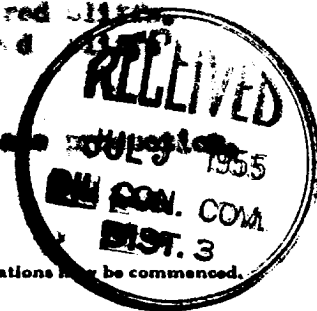

I understand that this plan of work must receive approval in writing by the Geological Survey before operations may be commenced.

Company SUNSHINE OIL & GAS COMPANY

Address PO BOX 100

SANTA FE, N.M.

By Lenwood S. Muesnick

Title S. Petroleum Engineer

Company Southern Union Gas Co

Lease **BACHRY**

Well No. **10**

Sec. 34 T. 29 N R. 10 W N.M.P.M.

Location 990 feet from north line; 990 feet from west line; being in the  $SE\frac{1}{4}NW\frac{1}{4}NW\frac{1}{4}$

Elevation:

San Juan County

New Mexico

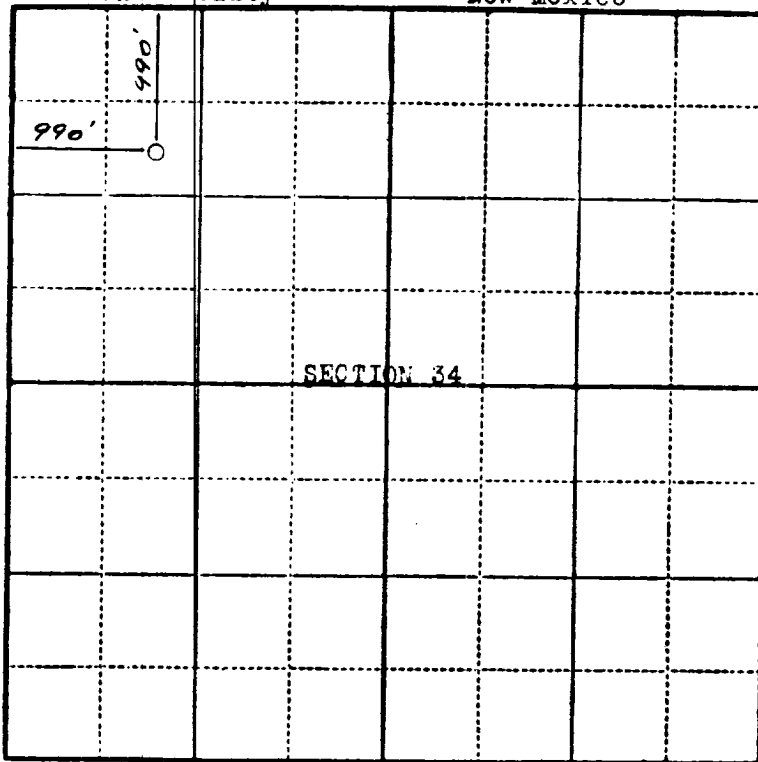

RECEIVED  
JUL 5 1955  
OIL CON. COM.  
DIST. 3

Scale—4 inches equal 1 mile.

This is to certify that the above plat was prepared from field notes of actual surveys made by me or under my supervision and that the same are true and correct to the best of my knowledge and belief.

*Stephen H. Kinney*

STEPHEN H. KINNEY  
Registered Professional  
Engineer and Land Surveyor

Surveyed June 10, 19 55

Seal:

