

NUMBER OF COPIES RECEIVED	
DISTRIBUTION	
SANTA FE	
FILE	
U.S.S.	
LAND OFFICE	
TRANSPORTER	OIL GAS
PRODUCTION OFFICE	
OPERATOR	

NEW MEXICO OIL CONSERVATION COMMISSION

FORM C-128
Revised 5/1/57

WELL LOCATION AND ACREAGE DEDICATION PLAT

SEE INSTRUCTIONS FOR COMPLETING THIS FORM ON THE REVERSE SIDE

SECTION A

Operator Amerada Petroleum Corporation		Lease Navajo Tract #20		Well No. 1
Unit Letter D	Section 31	Township 29N	Range 17W	County San Juan
Actual Footage Location of Well: 660' feet from the North line and 660' feet from the West line				
Ground Level Elev. 5231'	Producing Formation Devonian	Pool Pajarito Area-Wildcat	Dedicated Acreage: 40 Acres	

1. Is the Operator the only owner in the dedicated acreage outlined on the plat below? YES ☒ NO ☐ . ("Owner" means the person who has the right to drill into and to produce from any pool and to appropriate the production either for himself or for himself and another. (65-3-29 (e) NMSA 1935 Comp.)
2. If the answer to question one is "no," have the interests of all the owners been consolidated by communitization agreement or otherwise? YES ☐ NO ☐ . If answer is "yes," Type of Consolidation _____
3. If the answer to question two is "no," list all the owners and their respective interests below:

Owner	Land Description

SECTION B

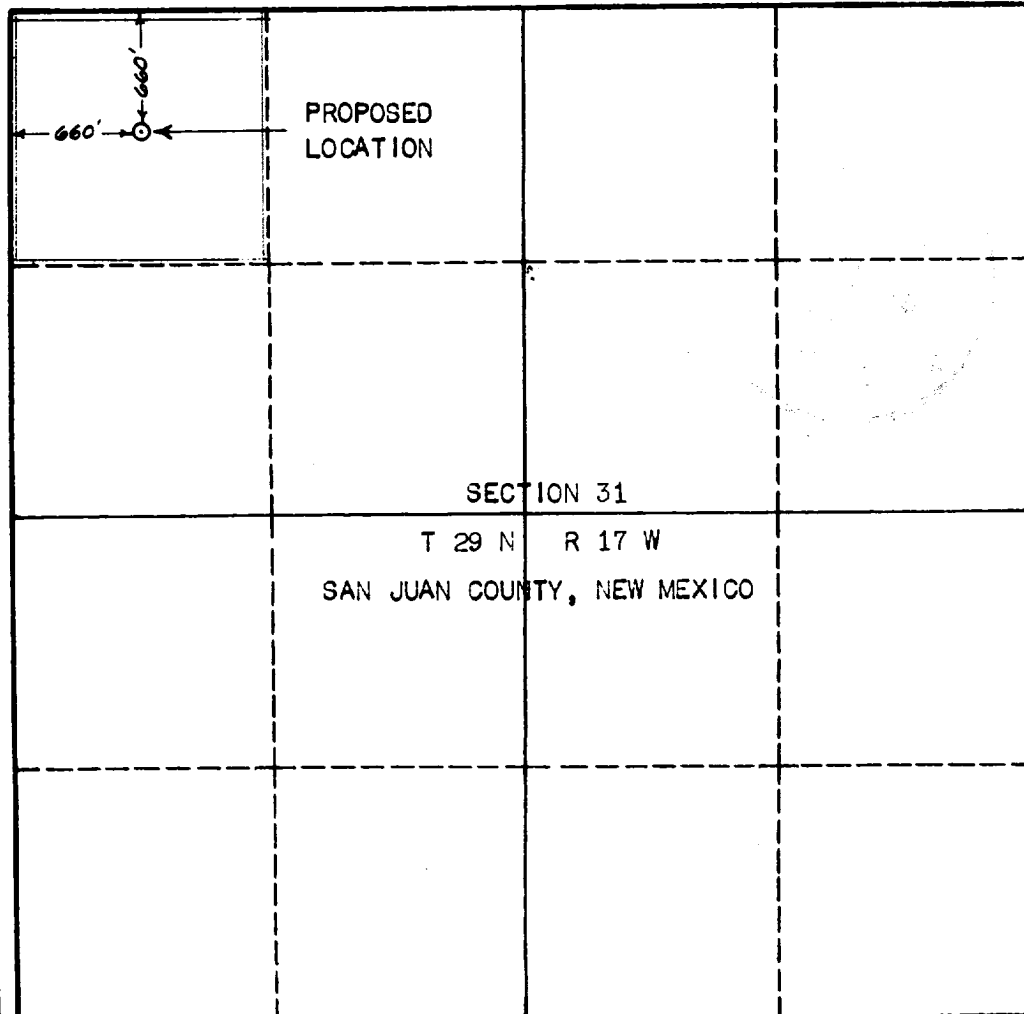

CERTIFICATION

I hereby certify that the information in SECTION A above is true and complete to the best of my knowledge and belief.

Name	L.A. Pettyjohn
Position	District Field Clerk
Company	Amerada Petroleum Corp.
Date	February 18, 1963

I hereby certify that the well location shown on the plat in SECTION B was plotted from field notes of actual surveys made by me or under my supervision, and that the same is true and correct to the best of my knowledge and belief.

Date Surveyed	FEBRUARY 4, 1963
Registered Professional Engineer and/or Land Surveyor	Thomas M. Clark
Certificate No.	#3189

0 330 660 990 1320 1650 1980 2310 2640 2000 1500 1000 500 0