

LTR



Job separation sheet

(SUBMIT IN TRIPLICATE)

UNITED STATES
DEPARTMENT OF THE INTERIOR
GEOLOGICAL SURVEY

Indian Agency Navajo Indian
Allottee John H.
Lease No. 1-25-010-2101

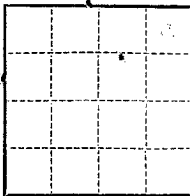

SUNDRY NOTICES AND REPORTS ON WELLS

NOTICE OF INTENTION TO DRILL	SUBSEQUENT REPORT OF WATER SHUT-OFF
NOTICE OF INTENTION TO CHANGE PLANS	SUBSEQUENT REPORT OF SHOOTING OR ACIDIZING
NOTICE OF INTENTION TO TEST WATER SHUT-OFF	SUBSEQUENT REPORT OF ALTERING CASING
NOTICE OF INTENTION TO REDRILL OR REPAIR WELL	SUBSEQUENT REPORT OF REDRILLING OR REPAIR
NOTICE OF INTENTION TO SHOOT OR ACIDIZE	SUBSEQUENT REPORT OF ABANDONMENT
NOTICE OF INTENTION TO PULL OR ALTER CASING	SUPPLEMENTARY WELL HISTORY
NOTICE OF INTENTION TO ABANDON WELL	

(INDICATE ABOVE BY CHECK MARK NATURE OF REPORT, NOTICE, OR OTHER DATA)

Well No. 7 is located 500 ft. from [N] line and 400 ft. from [E] line of sec. 34
27 10 7
(1/4 Sec. and Sec. No.) (Twp.) (Range) (Meridian)
27 10 7
(Field) (County or Subdivision) (State or Territory)

The elevation of the derrick floor above sea level is 700 ft.

DETAILS OF WORK

(State names of and expected depths to objective sands; show sizes, weights, and lengths of proposed casings; indicate mudding jobs, cementing points, and all other important proposed work)

It is intended to drill a well through the lower Gallup formation using rotary tool, and circulation. Possible productive intervals will be perforated and acid fracturing. Total estimated depth 1200'.

Casing program:

9-5/8" at 100' with 100 lb. casing cement circulated to surface.

5-1/2" at 1200' with 200 lb. casing cement.

The 5-1/2" casing will be cemented in the well.

5-1/2" casing section to Navajo Indian Agency 1-25-010-2101

I understand that this plan of work must receive approval in writing by the Geological Survey before operations may be commenced.

Company Navajo Natural Gas Company
Address 2001 N. Main St. Apt. 101, Flagstaff, Arizona
Alkal
By Joseph E. Kregar
Title Regional Engineer

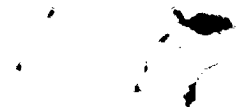

1. The first

2. The second

3. The third

4. The fourth

5. The fifth

6. The sixth

7. The seventh

8. The eighth

9. The ninth

10. The tenth

11. The eleventh

12. The twelfth

13. The thirteenth

14. The fourteenth

15. The fifteenth

NEW MEXICO OIL CONSERVATION COMMISSION

Well Location and Acreage Dedication Plat

SECTION A.

Operator **EL PASO NATURAL GAS PRODUCTS CO.** Lease **Ojo Amarillo** Date **March 9, 1961**
Navajo Tribal Council
14-20-603-2168
 Well No. **7** Unit Letter **A** Section **34** Township **29N** Range **14W** NMPM
 Located **560** Feet From **North** Line, **560** Feet From **East** Line
 County **San Juan** G. L. Elevation **5781'** Dedicated Acreage **00.00** Acres
 Name of Producing Formation **Lower Gallup** Pool **Chc Chc Gallup**

1. Is the Operator the only owner* in the dedicated acreage outlined on the plat below? Yes ☒ No
2. If the answer to question One is "No," have the interests of all the owners been consolidated by communitization agreement or otherwise? Yes _____ No _____. If answer is "Yes," Type of Consolidation _____
3. If the answer to question Two is "No," list all the owners and their respective interests below

OWNER

LAND DESCRIPTION

SECTION B.

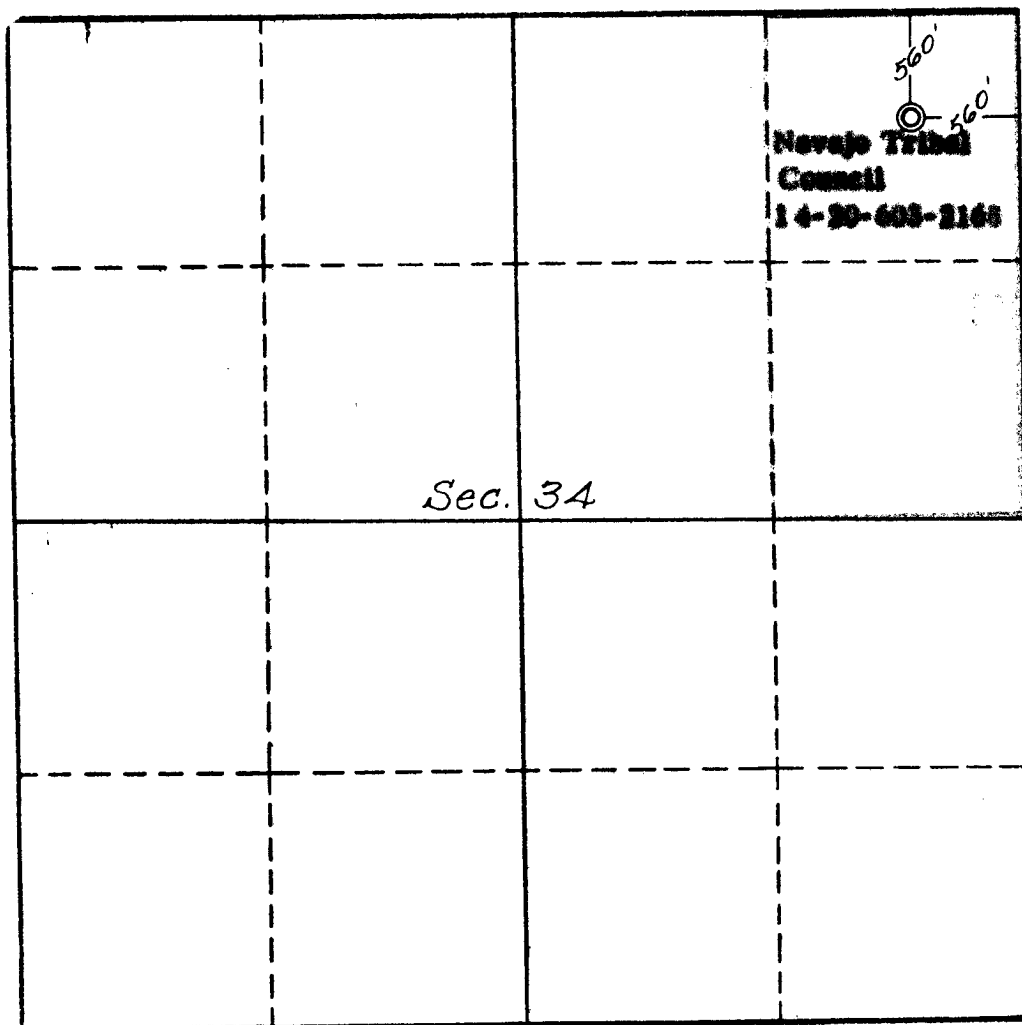

This is to certify that the information in Section A above is true and complete to the best of my knowledge and belief.

El Paso Natural Gas Products Co.
 (OPERATOR)

W. L. WILSON
 (REPRESENTATIVE)

Box 1560, Farmington, New Mexico

This is to certify that the well location shown on the plat in Section B was plotted from a true copy of actual survey and that the same is true and correct to the best of my knowledge and belief.

Date Surveyed **3-2-3-61**

Four States Engineering Co.
 FARMINGTON, NEW MEXICO

E. L. Potter
 REGISTERED ENGINEER OR
 LAND SURVEYOR

Certificate No. **3084**