

Santa Fe

(SUBMIT IN TRIPLICATE)

Land Office

080246

Lease No.

Unit

UNITED STATES
DEPARTMENT OF THE INTERIOR
GEOLOGICAL SURVEY

SUNDRY NOTICES AND REPORTS ON WELLS

NOTICE OF INTENTION TO DRILL	<input checked="" type="checkbox"/>	SUBSEQUENT REPORT OF WATER SHUT-OFF	
NOTICE OF INTENTION TO CHANGE PLANS		SUBSEQUENT REPORT OF SHOOTING OR ACIDIZING	
NOTICE OF INTENTION TO TEST WATER SHUT-OFF		SUBSEQUENT REPORT OF ALTERING CASING	
NOTICE OF INTENTION TO RE-DRILL OR REPAIR WELL		SUBSEQUENT REPORT OF REDRILLING OR REPAIR	
NOTICE OF INTENTION TO SHOOT OR ACIDIZE		SUBSEQUENT REPORT OF ABANDONMENT	
NOTICE OF INTENTION TO PULL OR ALTER CASING		SUPPLEMENTARY WELL HISTORY	
NOTICE OF INTENTION TO ABANDON WELL			

(INDICATE ABOVE BY CHECK MARK NATURE OF REPORT, NOTICE, OR OTHER DATA)

May 3, 1951

Well No. 3-42 is located 953 ft. from N line and 853 ft. from E line of sec. 27S. 1/4 Sec. 27
(1/4 Sec. and Sec. No.)T29N, R9W
(Twp.) (Range)W10E
(Meridian)Wilcox
(Field)San Juan
(County or Subdivision)New Mexico
(State or Territory)

The elevation of the derrick floor above sea level is _____ ft.

(Will be furnished later)

DETAILS OF WORK

(State names of and expected depths to objective sands; show sizes, weights, and lengths of proposed casings; indicate mudding jobs, cementing points, and all other important proposed work)

We propose to drill with rotary tools to the Cliffhouse sand and set 7" casing, rotary will then drill through the Mesa Verde section for gas completion. At Total Depth rotary will be replaced with cable tools for completion, well will then be shot with nitro. in Point Lookout and possibly Cliffhouse sands.

Casing Program:

250' of 10 3/4" 49.50# casing.....circulate cement and surface
4500' of 7 " 20 # casing.....200 sacks cement
5200' of 2 " tubing

(Designated Drilling Unit East 1/2 section 27)

I understand that this plan of work must receive approval in writing by the Geological Survey before operations may be commenced.

Company Blanco Gas CompanyAddress 305 W. MainFarmington, New Mexico

By

Title

Company Blanco Gas CompanyLease Florance-Federal3
Well No. 42Sec. 27 T. 29 N., R. 9 W., N.M.P.M.Location 953' North & 853' East of S W Corner
of Section 27.

San Juan County

New Mexico

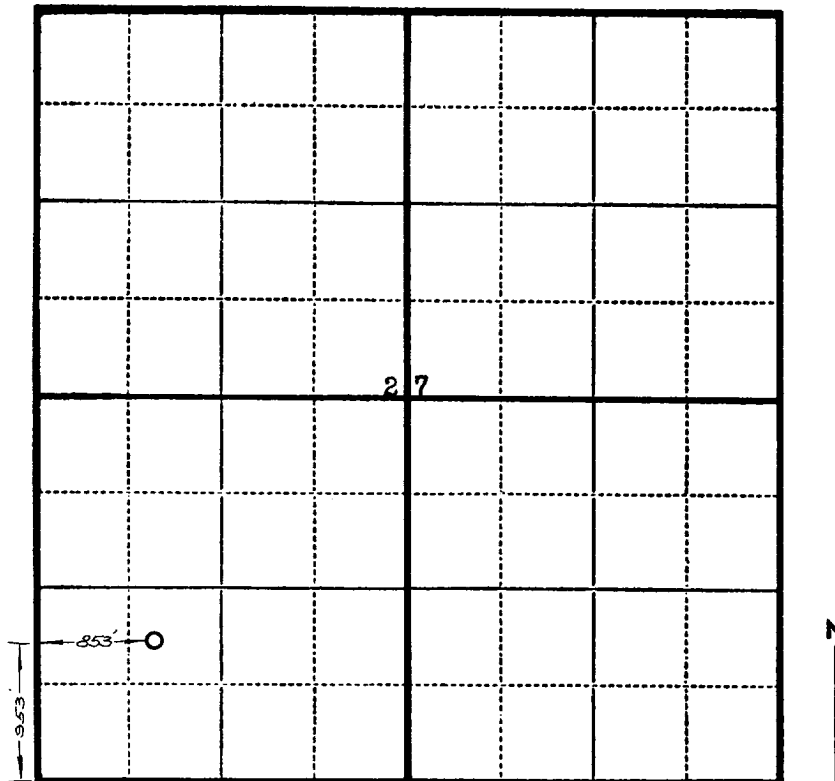

Scale—4 inches equals 1 mile.

This is to certify that the above plat was prepared from field notes of actual surveys made by me or under my supervision and that the same are true and correct to the best of my knowledge and belief.

Seal:

Registered Professional
Engineer and Land Surveyor.

Charles J. Finklea
N. Mex. Reg. No. 1302

Surveyed May 2, 1951