

NEW MEXICO  
OIL CONSERVATION COMMISSION

Well Location Plat

Company P.E. Jackson  
Lease Jackson-Sullivan Well No. 1 Sec. 25 T. 29N R. 11E NMPM  
Located 1600 Feet From 0 Line, 1650 Feet From 0 Line  
San Juan County, New Mexico. Elevation. 9599

(Note: All distances must be from outer boundaries of Section)

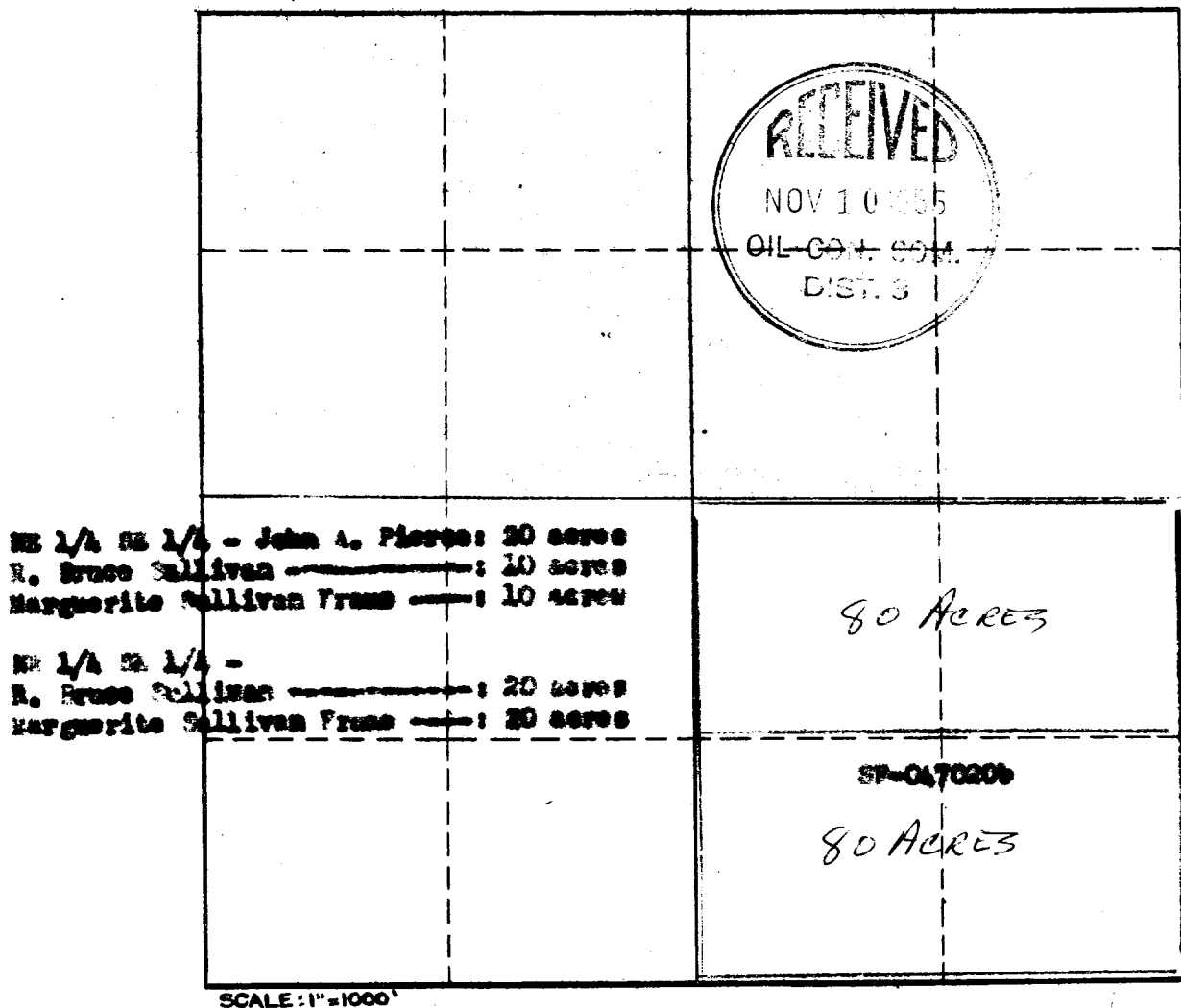

This is to certify that the above plat was prepared from field notes of actual surveys made by me or under my supervision and that the same are true and correct to the best of my knowledge and belief.

S E A L

Date Surveyed October 25, 1955

P.E. Jackson  
Registered Professional  
Engineer and Land Surveyor