

NEW MEXICO OIL CONSERVATION COMMISSION
Santa Fe, New Mexico

Form C-101
Revised (12/1/55)

NOTICE OF INTENTION TO DRILL

Notice must be given to the District Office of the Oil Conservation Commission and approval obtained before drilling or recompletion begins. If changes in the proposed plan are considered advisable, a copy of this notice showing such changes will be returned to the sender. Submit this notice in QUINTUPLICATE. One copy will be returned following approval. See additional instructions in Rules and Regulations of the Commission.

If State Land submit 6 Copies Attach Form C-128 in triplicate to first 3 copies of form C-101

Farmington, New Mexico

August 8, 1962

OIL CONSERVATION COMMISSION
SANTA FE, NEW MEXICO

Verbal approval received from A. R. Kendrick
on August 8, 1962

Gentlemen:

You are hereby notified that it is our intention to commence the Drilling of a well to be known as
Pan American Petroleum Corporation

Abrams Gas Unit "E"

(Company or Operator)

Well No. **1**

I

located **1790** feet from the **South** line and **890** feet from the

East

Line of Section **30**, T. **29N**, R. **10W**, NMPM.

(GIVE LOCATION FROM SECTION LINE)

Basin Dakota

San Juan

Pool, County

If State Land the Oil and Gas Lease is No. **See Attached List**

If patented land the owner is

Address

We propose to drill well with drilling equipment as follows: **Rotary tools to total depth**

The status of plugging bond is **state wide**

Drilling Contractor **Brinkerhoff Drilling Company**
870 Denver Club Building
Denver 2, Colorado

We intend to complete this well in the **Dakota**
6600' formation at an approximate depth of feet.

CASING PROGRAM

We propose to use the following strings of Casing and to cement them as indicated:

Size of Hole	Size of Casing	Weight per Foot	New or Second Hand	Depth	Sacks Cement
12-1/4	8-5/8	22.7	New	500	300 (circulate)
7-7/8	4-1/2	10.5	New	6600	850 (see below)

If changes in the above plans become advisable we will notify you immediately.

ADDITIONAL INFORMATION (If recompletion give full details of proposed plan of work.)

4-1/2" casing will be cemented by 2-stage method with 2-stage tool set 100' below the Pictured Cliffs. First stage will consist of sufficient cement to fill 500' above top of Gallup (250 sacks 4% gel followed by 100 sacks neat). Second stage to be cemented with 500 sacks 4% gel to circulate to surface.

Approved **S-10**, 19 **62**
Except as follows:

Sincerely yours,

Pan American Petroleum Corporation

By **L. O. Speer, Jr.** **F. A. BELLINGWORTH**

Petroleum Engineer

Position

Send Communications regarding well to

Name **Pan American Petroleum Corporation**

Address **Box 480, Farmington, New Mexico**

Attn: **L. O. Speer, Jr.**

OIL CONSERVATION COMMISSION

By

- 1/4 - Rhoda Adelle Abrams (husband W. Boyd Abrams
218 S. Church Street
Artec, New Mexico
- 1/4 - Zelda Mae Abrams Pomeroy
307 W. Dodd
Farmington, New Mexico
- 1/4 - Aimee Teague Beach (husband Merle L. Beach)
c/o Alfred E. Rogers, Jr.
2303 N. 7th Street
Las Vegas, New Mexico
- 1/4 - Betty Teague Rogers (husband Alfred E. Rogers, Jr.)
2303 N. 7th Street
Las Vegas, New Mexico

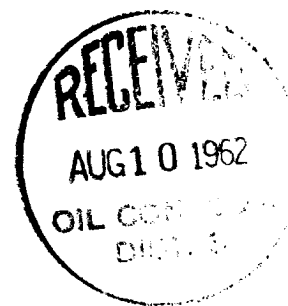

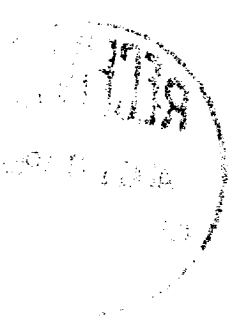

Well Location and Acreage Dedication Plat

Section A.

Date August 8, 1962

Operator PAN AMERICAN PETROLEUM CORPORATION Lease Abrams Gas Unit "E"
 Well No. 1 Unit Letter I Section 30 Township 29 NORTH Range 10 WEST, NMPM
 Located 1790 Feet From the SOUTH Line 890 Feet From the EAST Line
 County SAN JUAN G. L. Elevation To report later Dedicated Acreage 5 3/8 .80 ~~300~~ Acres
 Name of Producing Formation Dakota Pool Basin Dakota

1. Is the Operator the only owner in the dedicated acreage outlined on the plat below?

Yes _____ No X

2. If the answer to question one is "no", have the interests of all the owners been consolidated by community agreement or otherwise? Yes X No _____ If answer is "yes", Type of Consolidation.
Compulsory Pooling by Order No. R-2294 of July 27, 1962 (Case 2603)

3. If the answer to question two is "no", list all the owners and their respective interests below:

Owner

Land Description

NOTE: Pan American Petroleum Corporation holds leases on the E/2 of SE/4, SW/4 of SW/4, and the west 15 acres of the NE/4 of SW/4. Redfern and Herd, Inc., holds leases on the NE/4 of SW/4 and the remaining 25 acres of the NE/4 of SW/4. Skelly Oil Company holds leases on the SW/4 of SE/4 and SE/4 of SW/4. Lease ownership of the NW/4 of SW/4 is in dispute.

Section B.

Note: All distances must be from outer boundaries of section.

This is to certify that the information in Section A above is true and complete to the best of my knowledge and belief.

Pan American Petr. Corp.

ORIGINAL SIGNED BY
F. H. Hollingsworth
 (Representative)

Box 480, Farmington, New Mex.
 (Address)

Ref: GLO plat dated 19 April 1881

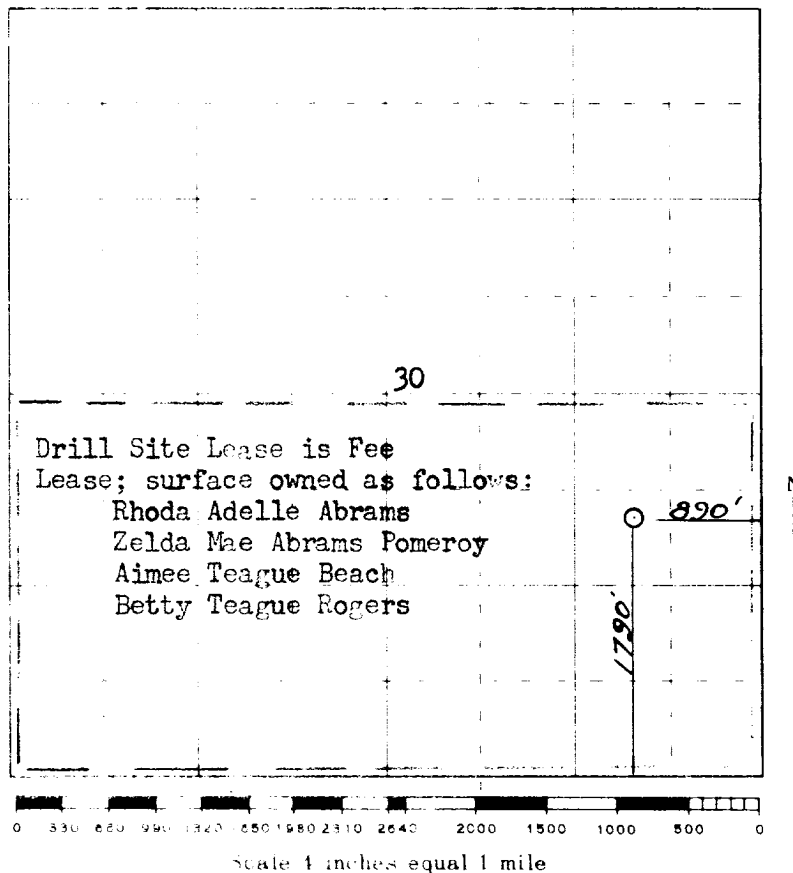

This is to certify that the above plat was prepared from field notes of actual surveys made by me or under my supervision and that the same are true and correct to the best of my knowledge and belief.

(Seal)

Farmington, New Mexico

Date Surveyed 10 May 1962

James P. Leese
 Registered Professional Engineer and/or Land Surveyor
 James P. Leese, N. Mex., Reg. No. 1463

