

Well Location and Average Dedication Plat

71599

Section A.

Date August 8, 1962

Operator PAN AMERICAN PETROLEUM CORPORATION Lease Abrams Gas Unit "E"
 Well No. 1 Unit Letter I Section 30 Township 29 NORTH Range 10 WEST, NMPM
 Located 1790 Feet From the SOUTH Line, 890 Feet From the EAST Line
 County SAN JUAN G. L. Elevation To report later Dedicated Acreage 5 3/8 .80
 Name of Producing Formation Dakota Pool Basin Dakota

1. Is the Operator the only owner in the dedicated acreage outlined on the plat below?

Yes _____ No X

2. If the answer to question one is "no", have the interests of all the owners been consolidated by community agreement or otherwise? Yes X No _____ If answer "Yes", Type of Consolidation.

Compulsory Pooling by Order No. R-2294 of July 27, 1962 (Case 2603)

3. If the answer to question two is "no", list all the owners and their respective interests below:

Owner

Land Description

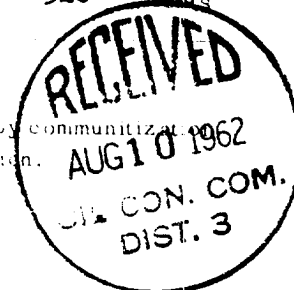

NOTE: Pan American Petroleum Corporation holds leases on the E/2 of SE/4, SW/4 of SW/4, and the west 15 acres of the NE/4 of SW/4. Redfern and Herd, Inc., holds leases on the NE/4 of SW/4 and the remaining 25 acres of the NE/4 of SW/4. Skelly Oil Company holds leases on the SW/4 of SE/4 and SE/4 of SW/4. Lease ownership of the NW/4 of SW/4 is in dispute.

Section B.

Note: All distances must be from outer boundaries of section.

This is to certify that the information in Section A above is true and complete to the best of my knowledge and belief.

Pan American Petr. Corp.

ORIGINAL SIGNED BY
F. H. Hollingsworth
 (Representative)

Box 480, Farmington, New Mex.
 (Address)

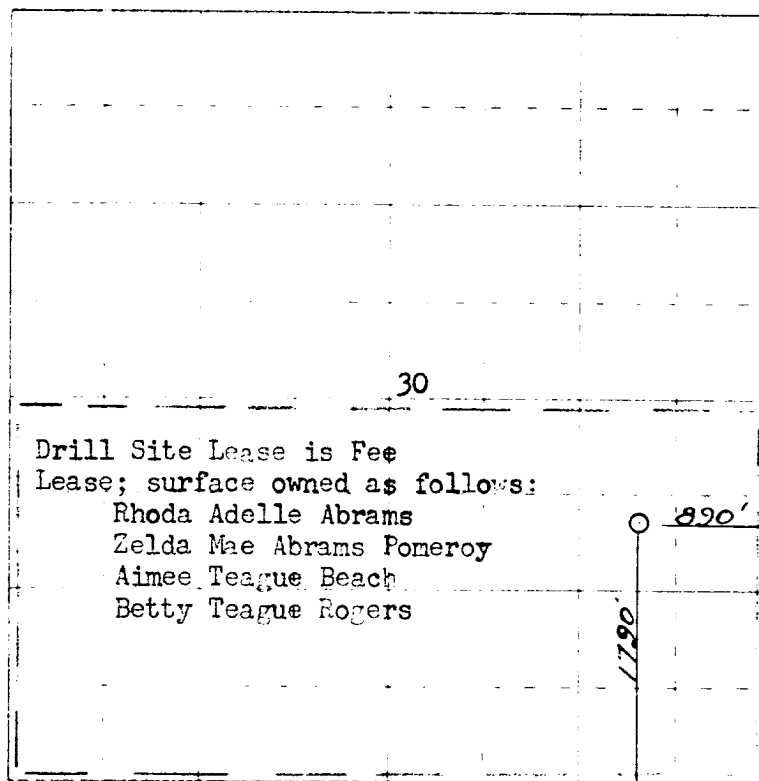

Drill Site Lease is Fee
 Lease; surface owned as follows:
 Rhoda Adelle Abrams
 Zelda Mae Abrams Pomeroy
 Aimee Teague Beach
 Betty Teague Rogers

Ref: GLO plat dated 19 April 1881

0 330 660 990 1320 1650 1980 2310 2540 2000 1500 1000 500 0

Scale 4 inches equal 1 mile

This is to certify that the above plat was prepared from field notes of actual surveys made by me or under my supervision and that the same are true and correct to the best of my knowledge and belief.

Date Surveyed 10 May 1962

James P. Leese
 Registered Professional Engineer and/or Land Surveyor
 James P. Leese N. Mex. Reg. No. 1463
 San Juan Engineering Company

(Seal)

Farmington, New Mexico