

File Copy

OIL CONSERVATION COMMISSION
1000 Rio Brazos Rd.
Aztec, New Mexico

OIL CONSERVATION COMMISSION
BOX 871
SANTA FE, NEW MEXICO

DATE 11-9-59

RE: Proposed NSP _____

Proposed NSL _____

Proposed NFO _____

Proposed DC ✓

Gentlemen:

I have examined the application dated 11-6-59
for the San Juan Thomas Gas Unit D#1 I-29-29-10
Operator Lease and Well No. S-T-R

and my recommendations are as follows:

Approve

Yours very truly,
Ernest C. Lunsford
OIL CONSERVATION COMMISSION

PAN AMERICAN PETROLEUM CORPORATION

Box 487, Farmington, New Mexico
November 6, 1959

File: B-2355-400.1

Subject: Application for Dual Completion
Abrams Gas Unit "D" No. 1
Astec Pictured Cliffs and
Fruitland Fields
San Juan County, New Mexico

Mr. A. L. Porter (2)
New Mexico Oil Conservation Commission
P. O. Box 1901
Santa Fe, New Mexico

Dear Sir:

In accordance with the provisions of Rule No. 112-A, Multiple Completions, as amended by Order No. R-1214, dated July 3, 1958, Pan American Petroleum Corporation respectfully requests administrative approval to dually complete the Abrams Gas Unit "D" No. 1 in the Pictured Cliffs and Fruitland gas zones located in Unit 1, Section 29, T-29-N, R-10-W, San Juan County, New Mexico. Abrams Gas Unit "D" No. 1 is located approximately one mile southeast of the Paul Case-Sullivan No. 5 which was approved for dual completion in the same zones by Order No. DC-734 dated March 8, 1958.

As specified in Rule 112-A, we are submitting in quadruplicate an Application for Dual Completion, a Diagrammatic Sketch of Dual Completion, a plat showing the location of the Abrams Gas Unit "D" No. 1 with respect to offsetting wells, including the names and addresses of offset operators. Also submitted is one copy of the electric log which has been posted with the required completion data.

Also being submitted in quadruplicate is a Packer Leakage Test which was completed successfully on November 2, 1959. Included with the Packer Leakage Test is the required packer setting affidavit.

By registered letter, offset operators are being furnished a copy of this letter and a copy of the Dual Completion Application.

Very truly yours,

PAN AMERICAN PETROLEUM CORPORATION

L. O. Speer, Jr.

L. O. Speer, Jr.
Area Superintendent

REB:hh

cc: Mr. E. C. Arnold (2)

Horace McKay, Albuquerque, N. M.
Francis L. Harvey, Wichita Falls, Tex.

COPY

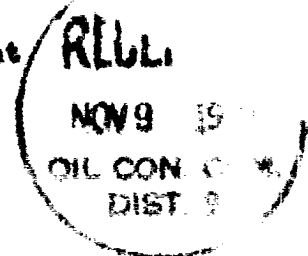

00794 re. [redacted] file # [redacted]
8361 6 [redacted]

1998, 1999, 2000, 2001, 2002, 2003, 2004, 2005, 2006, 2007, 2008, 2009, 2010, 2011, 2012, 2013, 2014, 2015, 2016, 2017, 2018, 2019, 2020, 2021, 2022, 2023, 2024, 2025, 2026, 2027, 2028, 2029, 2030, 2031, 2032, 2033, 2034, 2035, 2036, 2037, 2038, 2039, 2040, 2041, 2042, 2043, 2044, 2045, 2046, 2047, 2048, 2049, 2050, 2051, 2052, 2053, 2054, 2055, 2056, 2057, 2058, 2059, 2060, 2061, 2062, 2063, 2064, 2065, 2066, 2067, 2068, 2069, 2070, 2071, 2072, 2073, 2074, 2075, 2076, 2077, 2078, 2079, 2080, 2081, 2082, 2083, 2084, 2085, 2086, 2087, 2088, 2089, 2090, 2091, 2092, 2093, 2094, 2095, 2096, 2097, 2098, 2099, 2100, 2101, 2102, 2103, 2104, 2105, 2106, 2107, 2108, 2109, 2110, 2111, 2112, 2113, 2114, 2115, 2116, 2117, 2118, 2119, 2120, 2121, 2122, 2123, 2124, 2125, 2126, 2127, 2128, 2129, 2130, 2131, 2132, 2133, 2134, 2135, 2136, 2137, 2138, 2139, 2140, 2141, 2142, 2143, 2144, 2145, 2146, 2147, 2148, 2149, 2150, 2151, 2152, 2153, 2154, 2155, 2156, 2157, 2158, 2159, 2160, 2161, 2162, 2163, 2164, 2165, 2166, 2167, 2168, 2169, 2170, 2171, 2172, 2173, 2174, 2175, 2176, 2177, 2178, 2179, 2180, 2181, 2182, 2183, 2184, 2185, 2186, 2187, 2188, 2189, 2190, 2191, 2192, 2193, 2194, 2195, 2196, 2197, 2198, 2199, 2200, 2201, 2202, 2203, 2204, 2205, 2206, 2207, 2208, 2209, 2210, 2211, 2212, 2213, 2214, 2215, 2216, 2217, 2218, 2219, 2220, 2221, 2222, 2223, 2224, 2225, 2226, 2227, 2228, 2229, 2230, 2231, 2232, 2233, 2234, 2235, 2236, 2237, 2238, 2239, 2240, 2241, 2242, 2243, 2244, 2245, 2246, 2247, 2248, 2249, 2250, 2251, 2252, 2253, 2254, 2255, 2256, 2257, 2258, 2259, 2260, 2261, 2262, 2263, 2264, 2265, 2266, 2267, 2268, 2269, 2270, 2271, 2272, 2273, 2274, 2275, 2276, 2277, 2278, 2279, 2280, 2281, 2282, 2283, 2284, 2285, 2286, 2287, 2288, 2289, 2290, 2291, 2292, 2293, 2294, 2295, 2296, 2297, 2298, 2299, 2300, 2301, 2302, 2303, 2304, 2305, 2306, 2307, 2308, 2309, 2310, 2311, 2312, 2313, 2314, 2315, 2316, 2317, 2318, 2319, 2320, 2321, 2322, 2323, 2324, 2325, 2326, 2327, 2328, 2329, 2330, 2331, 2332, 2333, 2334, 2335, 2336, 2337, 2338, 2339, 2340, 2341, 2342, 2343, 2344, 2345, 2346, 2347, 2348, 2349, 2350, 2351, 2352, 2353, 2354, 2355, 2356, 2357, 2358, 2359, 2360, 2361, 2362, 2363, 2364, 2365, 2366, 2367, 2368, 2369, 2370, 2371, 2372, 2373, 2374, 2375, 2376, 2377, 2378, 2379, 2380, 2381, 2382, 2383, 2384, 2385, 2386, 2387, 2388, 2389, 2390, 2391, 2392, 2393, 2394, 2395, 2396, 2397, 2398, 2399, 2400, 2401, 2402, 2403, 2404, 2405, 2406, 2407, 2408, 2409, 2410, 2411, 2412, 2413, 2414, 2415, 2416, 2417, 2418, 2419, 2420, 2421, 2422, 2423, 2424, 2425, 2426, 2427, 2428, 2429, 2430, 2431, 2432, 2433, 2434, 2435, 2436, 2437, 2438, 2439, 2440, 2441, 2442, 2443, 2444, 2445, 2446, 2447, 2448, 2449, 2450, 2451, 2452, 2453, 2454, 2455, 2456, 2457, 2458, 2459, 2460, 2461, 2462, 2463, 2464, 2465, 2466, 2467, 2468, 2469, 2470, 2471, 2472, 2473, 2474, 2475, 2476, 2477, 2478, 2479, 2480, 2481, 2482, 2483, 2484, 2485, 2486, 2487, 2488, 2489, 2490, 2491, 2492, 2493, 2494, 2495, 2496, 2497, 2498, 2499, 2500, 2501, 2502, 2503, 2504, 2505, 2506, 2507, 2508, 2509, 2510, 2511, 2512, 2513, 2514, 2515, 2516, 2517, 2518, 2519, 2520, 2521, 2522, 2523, 2524, 2525, 2526, 2527, 2528, 2529, 2530, 2531, 2532, 2533, 2534, 2535, 2536, 2537, 2538, 2539, 2540, 2541, 2542, 2543, 2544, 2545, 2546, 2547, 2548, 2549, 2550, 2551, 2552, 2553, 2554, 2555, 2556, 2557, 2558, 2559, 2560, 2561, 2562, 2563, 2564, 2565, 2566, 2567, 2568, 2569, 2570, 2571, 2572, 2573, 2574, 2575, 2576, 2577, 2578, 2579, 2580, 2581, 2582, 2583, 2584, 2585, 2586, 2587, 2588, 2589, 2590, 2591, 2592, 2593, 2594, 2595, 2596, 2597, 2598, 2599, 2600, 2601, 2602, 2603, 2604, 2605, 2606, 2607, 2608, 2609, 2610, 2611, 2612, 2613, 2614, 2615, 2616, 2617, 2618, 2619, 2620, 2621, 2622, 2623, 2624, 2625, 2626, 2627, 2628, 2629, 2630, 2631, 2632, 2633, 2634, 2635, 2636, 2637, 2638, 2639, 2640, 2641, 2642, 2643, 2644, 2645, 2646, 2647, 2648, 2649, 2650, 2651, 2652, 2653, 2654, 2655, 2656, 2657, 2658, 2659, 2660, 2661, 2662, 2663, 2664, 2665, 2666, 2667, 2668, 2669, 2670, 2671, 2672, 2673, 2674, 2675, 2676, 2677, 2678, 2679, 26

1. The first step is to identify the problem.
 2. The second step is to define the problem.
 3. The third step is to analyze the problem.
 4. The fourth step is to develop a solution.
 5. The fifth step is to implement the solution.
 6. The sixth step is to evaluate the solution.
 7. The seventh step is to monitor the solution.
 8. The eighth step is to maintain the solution.
 9. The ninth step is to improve the solution.
 10. The tenth step is to document the solution.

(1) netre .1 .1 .1 .1
 atestireod volstavreod lre coice lre
 (111 net .1 .1 .1 .1
 coice net .1 .1 .1 .1

1334

of the last base-tiling No. 3 which was approved for final completion in the same zone by Order No. 100-100 dated March 8, 1953.

As needed in this case, we are submitting in consideration an application for a permit to install a new power line, a schematic diagram of the proposed line, and a map showing the location of the proposed line. I will respond to the comments of the Commission and the public as needed. Also submitted is one set of the electrical code for the proposed line and the proposed line. The proposed line is one set of the electrical code for the proposed line and the proposed line.

The above information was obtained from a review of the files of the Federal Bureau of Investigation, Department of Justice, and the Central Intelligence Agency, Office of Security.

WFOC - Bureau of Customs and Border Protection, United States Department of Homeland Security
 1000 17th Street, NW
 Washington, DC 20535-0001
 Tel: 202-325-8000
 Fax: 202-325-8001
 Email: wfof@ice.dhs.gov

REPORT OF THE

1011-0000 ALL-STATE INSURANCE CO.

INSTRUCTIONS FOR

108-210-200

(2) SECRET 10 11 12 13 14 15 16 17 18 19 20 21 22 23 24 25 26 27 28 29 30 31 32 33 34 35 36 37 38 39 40 41 42 43 44 45 46 47 48 49 50 51 52 53 54 55 56 57 58 59 60 61 62 63 64 65 66 67 68 69 70 71 72 73 74 75 76 77 78 79 80 81 82 83 84 85 86 87 88 89 90 91 92 93 94 95 96 97 98 99 100



NOV 8 1968
OIL CO. INC.
DIST. 3

NEW MEXICO OIL CONSERVATION COMMISSION

SANTA FE, NEW MEXICO

7-3-58

APPLICATION FOR DUAL COMPLETION

Field Name Astec Pictured Cliffs		County San Juan		Date 11-6-59
Operator Pan American Petroleum Corporation		Lease Abrams Gas Unit "D"		Well No. 1
Location of Well I	Unit I	Section 29	Township 29N	Range 10W

1. Has the New Mexico Oil Conservation Commission heretofore authorized the dual completion of a well in these same pools or in the same zones within one mile of the subject well? YES ☒ NO ☐
2. If answer is yes, identify one such instance: Order No. **DC-734**; Operator, Lease, and Well No.: **Paul Case-Sullivan No. 5**

3. The following facts are submitted:	Upper Zone	Lower Zone
a. Name of reservoir	Astec Fruitland	Astec Pictured Cliffs
b. Top and Bottom of Pay Section (Perforations)	1616-1666	1813-1836
c. Type of product or (Oil or Gas)	Gas	Gas
d. Method of Production (Flowing or Artificial Lift)	Flowing	Flowing

4. The following are attached. (Please mark YES or NO)

- ☒ a. Diagrammatic Sketch of the Dual Completion, showing all casing strings, including size and setting, top of cement, perforated intervals, tubing strings, including diameters and setting depth, location and type of packers and side door chokes, and such other information as may be pertinent.
- ☒ b. Plat showing the location of all wells on applicant's lease, all offset wells on offset leases, and the names and addresses of operators of all leases offsetting applicant's lease.
- ☒ c. Waivers consenting to such dual completion from each offset operator, or in lieu thereof, evidence that said offset operators have been furnished copies of the application.*
- ☒ d. Electrical log of the well or other acceptable log with tops and bottoms of producing zones and intervals of perforation indicated thereon. (If such log is not available at the time application is filed, it shall be submitted as provided by Rule 112-A.)

5. List all offset operators to the lease on which this well is located together with their correct mailing address.

Horace McKay, 800 Loma Linda, Albuquerque, New Mexico

Francis L. Harvey, Box 990, Wichita Falls, Texas

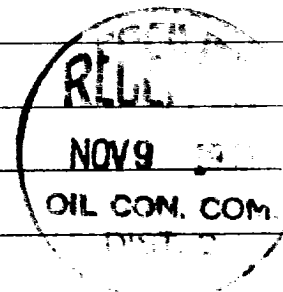

6. Were all operators listed in Item 5 above notified and furnished a copy of this application? YES ☒ NO ☐. If answer is yes, give date of such notification **Registered Letter 11-6-59**.

CERTIFICATE: I, the undersigned, state that I am the **Area Foreman** of the **Pan American Petroleum Corporation** (company), and that I am authorized by said company to make this report; and that this report was prepared under my supervision and direction and that the facts stated therein are true, correct and complete to the best of my knowledge.

J. R. Stockton

Signature

* Should waivers from all offset operators not accompany an application for administrative approval, the New Mexico Oil Conservation Commission will hold the application for a period of twenty (20) days from date of receipt at the Commission's Santa Fe office. If, after said twenty-day period, no protest nor request for hearing is received by the Santa Fe office, the application will then be processed.

NOTE: If the proposed dual completion will result in an unorthodox well location and/or non-standard proration unit in either or both of the producing zones, then separate application for approval of the same should be filed simultaneously with this application.

STATE OF NEW MEXICO }
COUNTY OF SAN JUAN }

I, Mack Mahaffey, being first duly sworn upon my oath depose and says as follows:

I am an employee of Baker Oil Tools, Inc., and that on October 12, 1959, I was called to the location of the Pan American Petroleum Corporation's Abrams Gas Unit "D" No. 1, Well located in the Unit I of Section 29, Township 29N, Range 10W, N. M. P. M. for the purpose of installing a production packer. Under my direct supervision a Baker Model D production packer was set at 1780 feet. The production packer was properly set in accordance with the usual practices and customs of the industry.

Mack Mahaffey

Baker Oil Tools, Inc.

Subscribed and sworn to before me, a Notary Public in and for San Juan County, New Mexico, the 5th day of November, 19 59.

Augusta H. Hall
Notary Public in and for San Juan
County, New Mexico

My Commission Expires Oct. 29, 1962

My commission expires

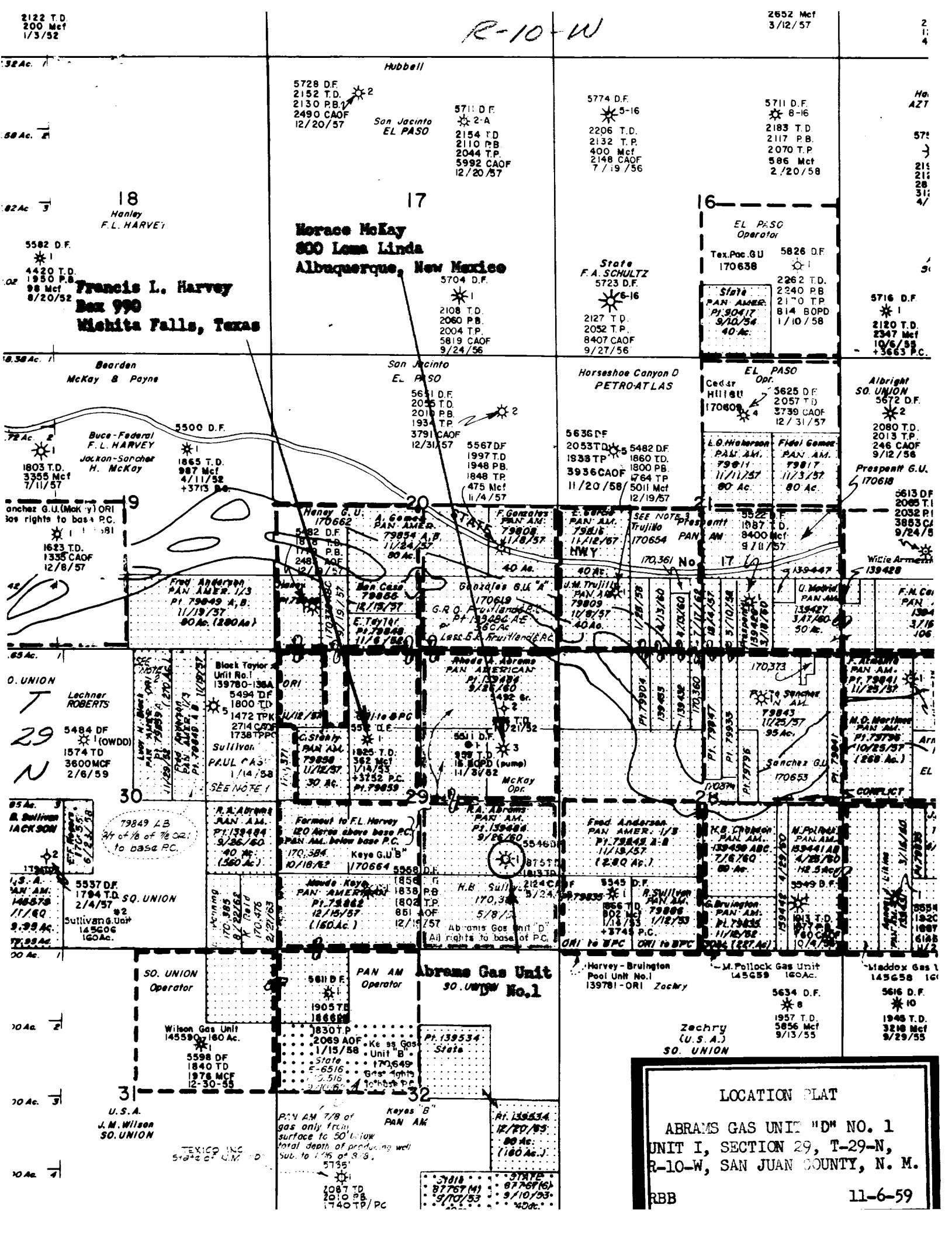

Reference Point: RDB Elev. 5548

13'

Ground Level Elev. 5535

8-5/8" 24# Surface Casing set at 208'

Cement circulated
to surface.

Fruitland Perforations: 2 JSPF
1616-1626 & 1642-1666.

1-1/4" 2.3# Tubing set at
1658'

Baker Model "D" Permanent Production
Packer set at 1780

Pictured Cliffs Perforations:
4 JSPF 1813-1836.

1-1/2" 2.9# Tubing set at 1812'

5-1/2" 15# Casing set at 1875
w/500 sx

PBD 1850

TD 1875

PAN AMERICAN PETROLEUM CORPORATION

SCALE

RBB

11-6-59

DRG.
No.

Abrams Gas Unit "D" No. 1 - Diagrammatic Sketch of Dual Completion